



Public Works Department  
Maintenance Operations Division

# CITY OF CULVER CITY

9505 West Jefferson Boulevard, Culver City, California 90232



File 888

## Request for Parkway Tree Removal

(Pursuant to Culver City Municipal Code Section 9.08.210: See reverse side of this form)

Applicant: Richard Slechta

Telephone 310-699-8238

(Name)  
4381 Motor Ave. Culver City, CA 90232

(Address)

Request for removal of 2 tree(s)

Location: ☒ In front of, and/or Left & right side of driveway apron  
☐ On side of property located at \_\_\_\_\_  
(Street Address)

Reason for removal:

(Criteria set forth in Culver City Municipal Code Section 9.08.210.C must be satisfied. See reverse side of this form.)

**We have 2 large Ficus trees that have aggressive root growth throughout the front yard of our new home construction. In less than a year from installing new landscaping, we have shallow ficus roots 1.5" in diameter that were not present when we installed the landscaping in March 2019. This presents property damage risk for near and mid term to foundation, driveway and hard-scaping. We are willing to pay for removal of trees, replacement with 2 new oak trees as outlined in Urban Forest Master Plan and repair to damaged concrete sidewalk.**

☒ Supporting documentation is attached.

☐ Request for removal (subject to availability of City resources and funds), OR

☒ Request for priority removal at applicant's expense.

### PROCEDURE FOR TREE REMOVAL:

If applicant's request for tree removal is granted, removal of aforementioned tree(s) will be accommodated on a priority basis subject to availability of City resources and funds. Applicant has the option to be granted priority removal if they agree to pay for the removal at their expense. Applicant will be presented with a quote from City's tree trimming contractor prior to removal. Upon authorization of quote and payment by applicant, tree(s) will be removed by City's tree trimming contractor as their schedule permits.

### FILING FEE:

The applicant shall post a non-refundable filing fee in the amount of \$75 along with this request form.

### DECISION AND APPEAL:

The decision of the Public Works Director is final, unless appealed by the Applicant, a member of the City Council or an Interested Person. Appeals shall be submitted in writing and filed with the City Clerk within 10 days after the decision date identified in the notice of decision. (See CCMC Section 9.08.210.E and F for more information.)

Date May 19, 2020

Signature \_\_\_\_\_

(Applicant)

### FOR CITY USE

Species of tree(s) to be removed: Ficus Minocarpa nitida

Tree(s) to be removed: 22/25 inches 25-30 feet 5-6 feet  
(Approx. diameter) (Approx. height) (Parkway width)

Permission is hereby: ☐ Granted for removal (subject to availability of City resources and funds)  
☒ Granted for priority removal at applicant's expense  
☒ Denied

Date 11/19/2020

Signature \_\_\_\_\_

White: Property Owner/Applicant

Yellow: Public Works Director

Pink: Maintenance Operations Division

Revised 1/30/14

Minor damage to sidewalk can be repaired and mitigated with root pruning. Trees are both healthy and have moderate hazard ratings.



# A Photographic Guide to the Evaluation of Hazard Trees in Urban Areas

## TREE HAZARD EVALUATION FORM 2nd Edition

Site/Address: 4381 Motor Ave.  
Map/Location: tract 17273 lot 13 block 4300  
Owner: public ☒ private ☐ unknown ☐ other ☐  
Date: 9/22/2020 Inspector: David Talavera  
Date of last inspection: 9/22/2020

### HAZARD RATING:

$\frac{1}{\text{Failure Potential}}$	+	$\frac{1}{\text{Size of part}}$	+	$\frac{3}{\text{Target Rating}}$	=	$\frac{5}{\text{Hazard Rating}}$
						Immediate action needed
						X Needs further inspection
						Dead tree

### TREE CHARACTERISTICS

Tree #: 1 Species: Ficus Microcarpa nitida  
DBH: 25" # of trunks: 1 Height: 25'-30' Spread: 30'  
Form: ☒ generally symmetric ☐ minor asymmetry ☐ major asymmetry ☐ stump sprout ☐ stag-headed  
Crown class: ☒ dominant ☐ co-dominant ☐ intermediate ☐ suppressed  
Live crown ratio: 95 % Age class: ☐ young ☒ semi-mature ☐ mature ☐ over-mature/senescent  
Pruning history: ☒ crown cleaned ☒ excessively thinned ☐ topped ☐ crown raised ☐ pollarded ☐ crown reduced ☐ flush cuts ☐ cabled/braced  
☐ none ☐ multiple pruning events Approx. dates: \_\_\_\_\_  
Special Value: ☐ specimen ☐ heritage/historic ☐ wildlife ☐ unusual ☒ street tree ☐ screen ☐ shade ☐ indigenous ☐ protected by gov. agency

### TREE HEALTH

Foliage color: ☐ normal ☒ chlorotic ☐ necrotic Epiconomics? Y ☒ N  
Foliage density: ☐ normal ☒ sparse Leaf size: ☒ normal ☐ small  
Annual shoot growth: ☐ excellent ☒ average ☐ poor Twig Dieback? Y ☒ N  
Woundwood development: ☐ excellent ☒ average ☐ poor ☐ none  
Vigor class: ☐ excellent ☒ average ☐ fair ☐ poor  
Major pests/diseases: None  
Growth obstructions:  
☐ stakes ☐ wire/ties ☐ signs ☐ cables  
☐ curb/pavement ☐ guards  
☐ other Parkway 7'

### SITE CONDITIONS

Site Character: ☒ residence ☐ commercial ☐ industrial ☐ park ☐ open space ☐ natural ☐ woodland/forest  
Landscape type: ☒ parkway ☐ raised bed ☐ container ☐ mound ☐ lawn ☐ shrub border ☐ wind break  
Irrigation: ☒ none ☐ adequate ☐ inadequate ☐ excessive ☐ trunk wetted  
Recent site disturbance? ☒ N ☐ construction ☐ soil disturbance ☐ grade change ☐ line clearing ☐ site clearing  
% dripline paved: 0% 10-25% 25-50% 50-75% 75-100% Pavement lifted? Y N  
% dripline w/ fill soil: 0% 10-25% 25-50% 50-75% 75-100%  
% dripline grade lowered: 0% 10-25% 25-50% 50-75% 75-100%  
Soil problems: ☐ drainage ☐ shallow ☒ compacted ☐ droughty ☐ saline ☐ alkaline ☐ acidic ☐ small volume ☐ disease center ☐ history of fail  
☐ clay ☐ expansive ☐ slope \_\_\_\_\_° aspect: \_\_\_\_\_  
Obstructions: ☐ lights ☐ signage ☐ line-of-sight ☐ view ☐ overhead lines ☐ underground utilities ☐ traffic ☐ adjacent veg. ☐ None  
Exposure to wind: ☒ single tree ☐ below canopy ☐ above canopy ☐ recently exposed ☐ windward, canopy edge ☐ area prone to windthrow  
Prevailing wind direction: N/E Occurrence of snow/ice storms ☒ never ☐ seldom ☐ regularly

### TARGET

Use Under Tree: ☐ building ☒ parking ☐ traffic ☒ pedestrian ☐ recreation ☒ landscape ☐ hardscape ☐ small features ☐ utility lines  
Can target be moved? Y ☒ N Can use be restricted? Y ☒ N  
Occupancy: ☐ occasional use ☒ intermittent use ☐ frequent use ☐ constant use

The International Society of Arboriculture assumes no responsibility for conclusions or recommendations derived from use of this form.

# TREE DEFECTS Tree # 1

## ROOT DEFECTS:

Suspect root rot: Y N Mushroom/conk/bracket present: Y N ID: \_\_\_\_\_

Exposed roots: ☐ severe ☒ moderate ☐ low Undersized: ☐ severe ☐ moderate ☐ low

Root pruned: 2' distance from trunk Root area affected: 50 % Buttress wounded: Y N When: \_\_\_\_\_

Restricted root area: ☒ severe ☐ moderate ☐ low Potential for root failure: ☐ severe ☐ moderate ☒ low

LEAN: 0 deg. from vertical ☒ natural ☐ unnatural ☐ self-corrected Soil heaving: Y N

Decay in plane of lean: Y N Roots broken: Y N Soil cracking: Y N

Compounding factors: None Lean severity: ☐ severe ☐ moderate ☐ low

CROWN DEFECTS: Indicate presence of individual defects and rate their severity (s = severe, m = moderate, l = low) N = Negative

DEFECT	ROOT CROWN	TRUNK	SCAFFOLDS	BRANCHES
Poor taper				L
Bow, sweep				L
Codominants/forks			L	
Multiple attachments			L	M
Included bark	N			
Excessive end weight			N	
Cracks/splits			N	
Hangers			N	N
Girdling	N			
Wounds/seam	M			
Decay	N		N	
Cavity	N	N	N	N
Conks/mushrooms/bracket	N	N	N	N
Bleeding/sap flow	N	N	N	N
Loose/cracked bark	N	N	N	N
Nesting hole/bee hive	N		N	N
Deadwood/stubs	M		N	
Borers/termites/ants			N	N
Cankers/galls/burrs			N	
Previous failure				N

## HAZARD RATING

Tree part most likely to fail: Small branches

Inspection period: 1 annual biannual other \_\_\_\_\_

Failure Potential + Size of Part + Target Rating = Hazard Rating

1 + 1 + 3 = 5

Failure potential: 1 - low; 2 - medium; 3 - high; 4 - severe

Size of part: 1 - <6" (15 cm); 2 - 6-18" (15-45 cm);  
3 - 18-30" (45-75 cm); 4 - >30" (75 cm)

Target rating: 1 - occasional use; 2 intermittent use;  
3 - frequent use; 4 - constant use

## HAZARD ABATEMENT

Prune: ☒ remove defective part ☐ reduce end weight ☒ crown clean ☐ thin ☐ raise canopy ☐ crown reduce ☐ restructure ☐ shape

Cable/Brace: \_\_\_\_\_ Inspect further: ☐ root crown ☐ decay ☐ aerial ☐ monitor

Remove tree: Y N Replace? Y N Move target: Y N Other: \_\_\_\_\_

Effect on adjacent trees: ☒ none ☐ evaluate

Notification: ☒ owner ☐ manager ☒ governing agency Date: 9/22/202

## COMMENTS

Medium size tree NO hazard at this moment  
Full recovery from ficus disease  
root pruning on the past full recovery  
Sidewalk lifted and is OK to repair if is necessary  
tree branches clear from traffic  
only 25 % of canopy on top of the private landscape no berries at this time  
Recommendation : preserve the tree and manage the inconveniences



# A Photographic Guide to the Evaluation of Hazard Trees in Urban Areas

## **TREE HAZARD EVALUATION FORM** 2nd Edition

Site/Address: 43 81 Motor Tree #2  
Map/Location: Trast 17273 Lot 13 Block 43000  
Owner: public ☒ private ☐ unknown ☐ other ☐  
Date: 9/22/2020 Inspector: David Talavera  
Date of last inspection: 9/22/2020

### HAZARD RATING:

1	+	1	+	3	=	5
Failure Potential		Size of part		Target Rating		Hazard Rating
						Immediate action needed
						X Needs further inspection
						Dead tree

### TREE CHARACTERISTICS

Tree #: 2 Species: Ficus Microcarpa nitida  
DBH: 22" # of trunks: 1 Height: 25'-30' Spread: 25'  
Form: ☐ generally symmetric ☒ minor asymmetry ☐ major asymmetry ☐ stump sprout ☐ stag-headed  
Crown class: ☒ dominant ☐ co-dominant ☐ intermediate ☐ suppressed  
Live crown ratio: 80 % Age class: ☐ young ☐ semi-mature ☒ mature ☐ over-mature/senescent  
Pruning history: ☒ crown cleaned ☒ excessively thinned ☐ topped ☐ crown raised ☐ pollarded ☒ crown reduced ☐ flush cuts ☐ cabled/braced  
☐ none ☐ multiple pruning events Approx. dates: \_\_\_\_\_  
Special Value: ☐ specimen ☐ heritage/historic ☐ wildlife ☐ unusual ☒ street tree ☐ screen ☐ shade ☐ indigenous ☐ protected by gov. agency

### TREE HEALTH

Foliage color: ☐ normal ☒ chlorotic ☐ necrotic Epicormics? Y N  
Foliage density: ☐ normal ☒ sparse Leaf size: ☐ normal ☒ small  
Annual shoot growth: ☐ excellent ☐ average ☐ poor Twig Dieback? Y N  
Woundwood development: ☐ excellent ☐ average ☐ poor ☐ none  
Vigor class: ☐ excellent ☐ average ☐ fair ☐ poor  
Major pests/diseases: 80% recovery from ficus disease  
Growth obstructions: ☐ stakes ☐ wire/ties ☐ signs ☐ cables  
☐ curb/pavement ☐ guards  
☐ other \_\_\_\_\_

### SITE CONDITIONS

Site Character: ☒ residence ☐ commercial ☐ industrial ☐ park ☐ open space ☐ natural ☐ woodland/forest  
Landscape type: ☒ parkway ☐ raised bed ☐ container ☐ mound ☐ lawn ☐ shrub border ☐ wind break  
Irrigation: ☒ none ☐ adequate ☐ inadequate ☐ excessive ☐ trunk wattled  
Recent site disturbance? ☒ Y ☐ N ☐ construction ☒ soil disturbance ☐ grade change ☐ line clearing ☐ site clearing  
% dripline paved: 0% 10-25% 25-50% 50-75% 75-100% Pavement lifted? Y ☒ N  
% dripline w/ fill soil: 0% 10-25% 25-50% 50-75% 75-100%  
% dripline grade lowered: 0% 10-25% 25-50% 50-75% 75-100%  
Soil problems: ☐ drainage ☐ shallow ☒ compacted ☒ droughty ☐ saline ☐ alkaline ☐ acidic ☐ small volume ☐ disease center ☐ history of fall  
☐ clay ☐ expansive ☐ slope \_\_\_\_\_° aspect: \_\_\_\_\_  
Obstructions: ☐ lights ☐ signage ☐ line-of-sight ☐ view ☐ overhead lines ☐ underground utilities ☐ traffic ☐ adjacent veg. ☒ none  
Exposure to wind: ☐ single tree ☐ below canopy ☐ above canopy ☐ recently exposed ☐ windward, canopy edge ☐ area prone to windthrow  
Prevailing wind direction: N/E Occurrence of snow/ice storms ☒ never ☐ seldom ☐ regularly

### TARGET

Use Under Tree: ☐ building ☒ parking ☒ traffic ☒ pedestrian ☐ recreation ☒ landscape ☐ hardscape ☐ small features ☐ utility lines  
Can target be moved? Y ☒ N Can use be restricted? Y ☒ N  
Occupancy: ☐ occasional use ☒ intermittent use ☐ frequent use ☐ constant use

The International Society of Arboriculture assumes no responsibility for conclusions or recommendations derived from use of this form.



# **TREE DEFECTS**

TREE # 2

## **ROOT DEFECTS:**

Suspect root rot: Y ☒ N ☐ Mushroom/conk/bracket present: Y ☒ N ☐ ID: \_\_\_\_\_

Exposed roots: ☐ severe ☒ moderate ☐ low Undermined: ☐ severe ☐ moderate ☐ low

Root pruned: 0 distance from trunk Root area affected: 0 % Buttress wounded: Y ☒ N ☐ When: \_\_\_\_\_

Restricted root area: ☐ severe ☒ moderate ☐ low Potential for root failure: ☐ severe ☐ moderate ☐ low

LEAN: 0 deg. from vertical ☒ natural ☐ unnatural ☐ self-corrected Soil heaving: Y ☒ N ☐

Decay in plane of lean: Y ☒ N ☐ Roots broken: Y ☒ N ☐ Soil cracking: Y ☒ N ☐

Compounding factors: none Lean severity: ☐ severe ☐ moderate ☐ low

**CROWN DEFECTS:** Indicate presence of individual defects and rate their severity (s = severe, m = moderate, l = low) N = Negative

DEFECT	ROOT CROWN	TRUNK	SCAFFOLDS	BRANCHES
Poor taper			L	L
Bow, sweep				L
Codominants/forks			M	
Multiple attachments				M
Included bark		N	N	
Excessive end weight			L	L
Cracks/splits		N	N	
Hangers			N	N
Girdling	N			
Wounds/seam	N		M	
Decay	N		N	
Cavity	N	N	N	
Conks/mushrooms/bracket	N		N	
Bleeding/sap flow	N		N	N
Loose/cracked bark	N		N	N
Nesting hole/bee hive	N		N	
Deadwood/stubs	N		N	
Borers/termites/ants	N		N	
Cankers/galls/burrs	N		N	N
Previous failure	N		N	N

## **HAZARD RATING**

Tree part most likely to fail: Small branches

Inspection period: 1 annual biannual other

Failure Potential + Size of Part + Target Rating = Hazard Rating

1 + 1 + 3 = 5

Failure potential: 1 - low; 2 - medium; 3 - high; 4 - severe

Size of part: 1 - <6" (15 cm); 2 - 6-18" (15-45 cm);  
3 - 18-30" (45-75 cm); 4 - >30" (75 cm)

Target rating: 1 - occasional use; 2 intermittent use;  
3 - frequent use; 4 - constant use

## **HAZARD ABATEMENT**

Prune: ☒ remove defective part ☒ reduce end weight ☒ crown clean ☐ thin ☐ raise canopy ☐ crown reduce ☐ restructure ☐ shape

Cable/Brace: \_\_\_\_\_ Inspect further: ☐ root crown ☐ decay ☐ aerial ☐ monitor

Remove tree: Y ☒ N ☐ Replace? Y ☒ N ☐ Move target: Y ☒ N ☐ Other: \_\_\_\_\_

Effect on adjacent trees: ☒ none ☐ evaluate

Notification: ☒ owner ☐ manager ☒ governing agency Date: 9/22/2020

## **COMMENTS**

Minor sidewalk damage  
clear from traffic

Only 10% of canopy on private landscape No berries at this time

85% tree recovery from ficus disease No root pruning on the past feasible for root pruning if is necessary

Recommendation : preserve the tree and manage possible inconveniences

New Landscaping: March, 2019  
Yellow area:  
Removed existing 6"-8"  
old clay soil  
and replaced with  
topsoil blend

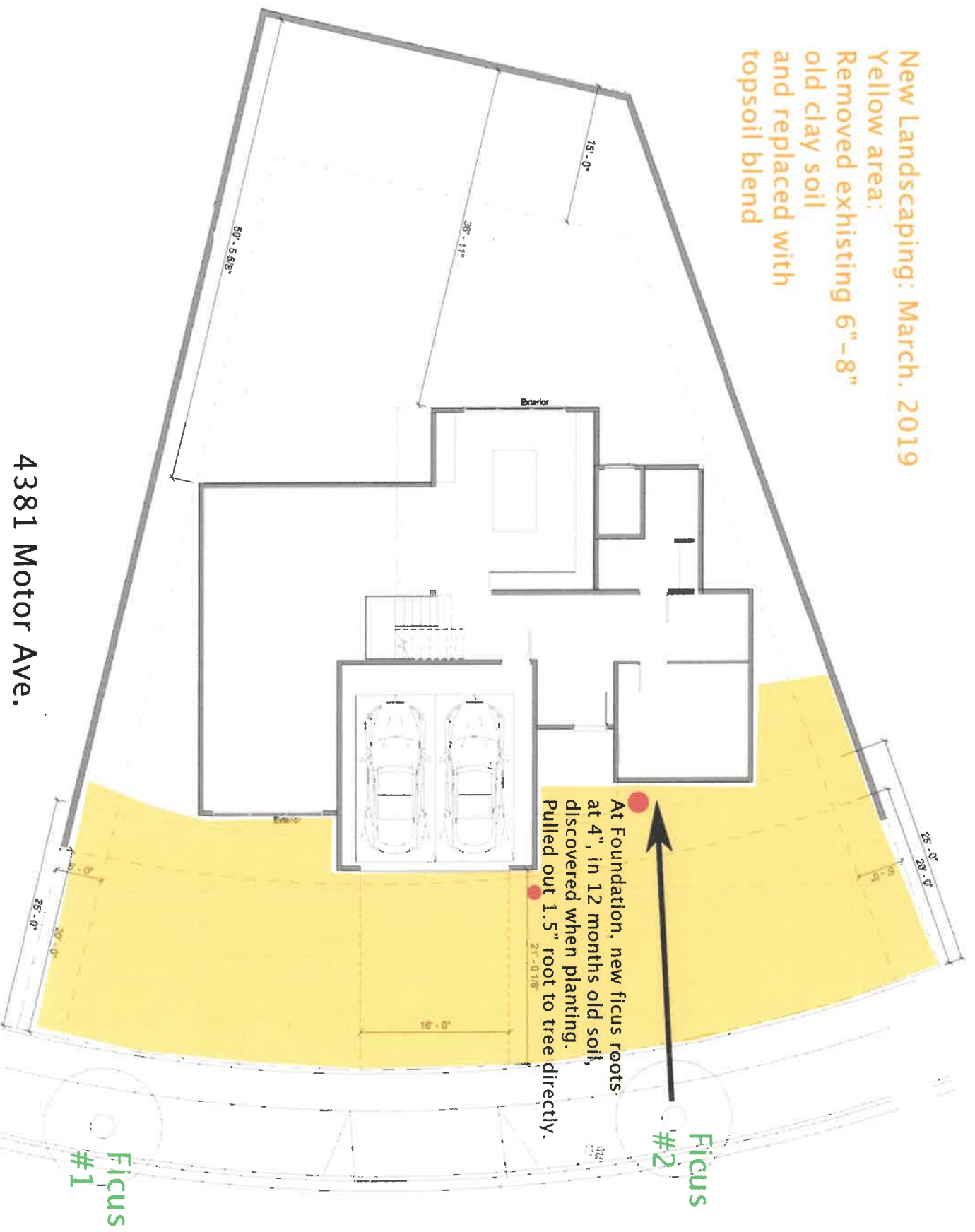

4381 Motor Ave.

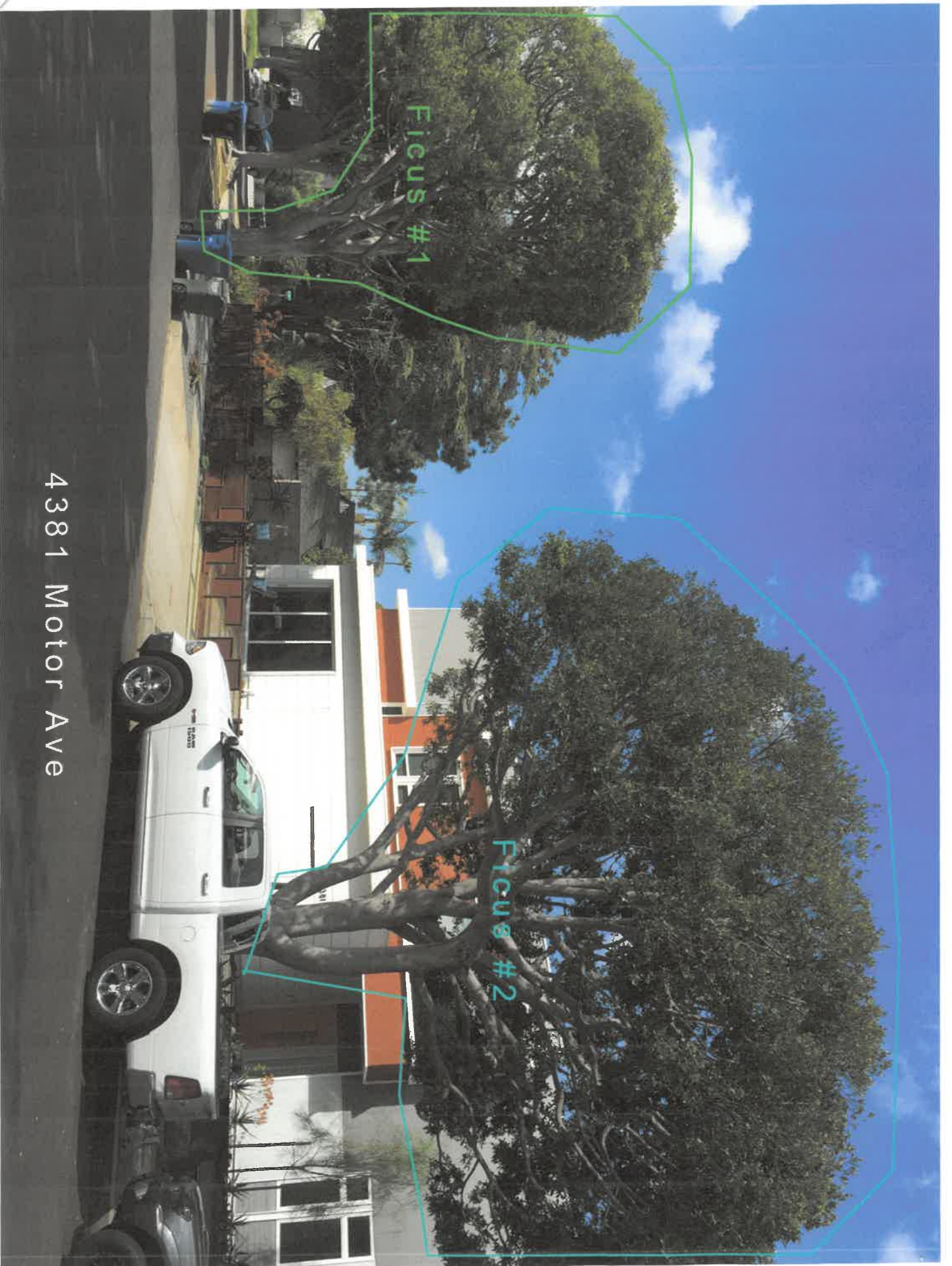

4381 Motor Ave



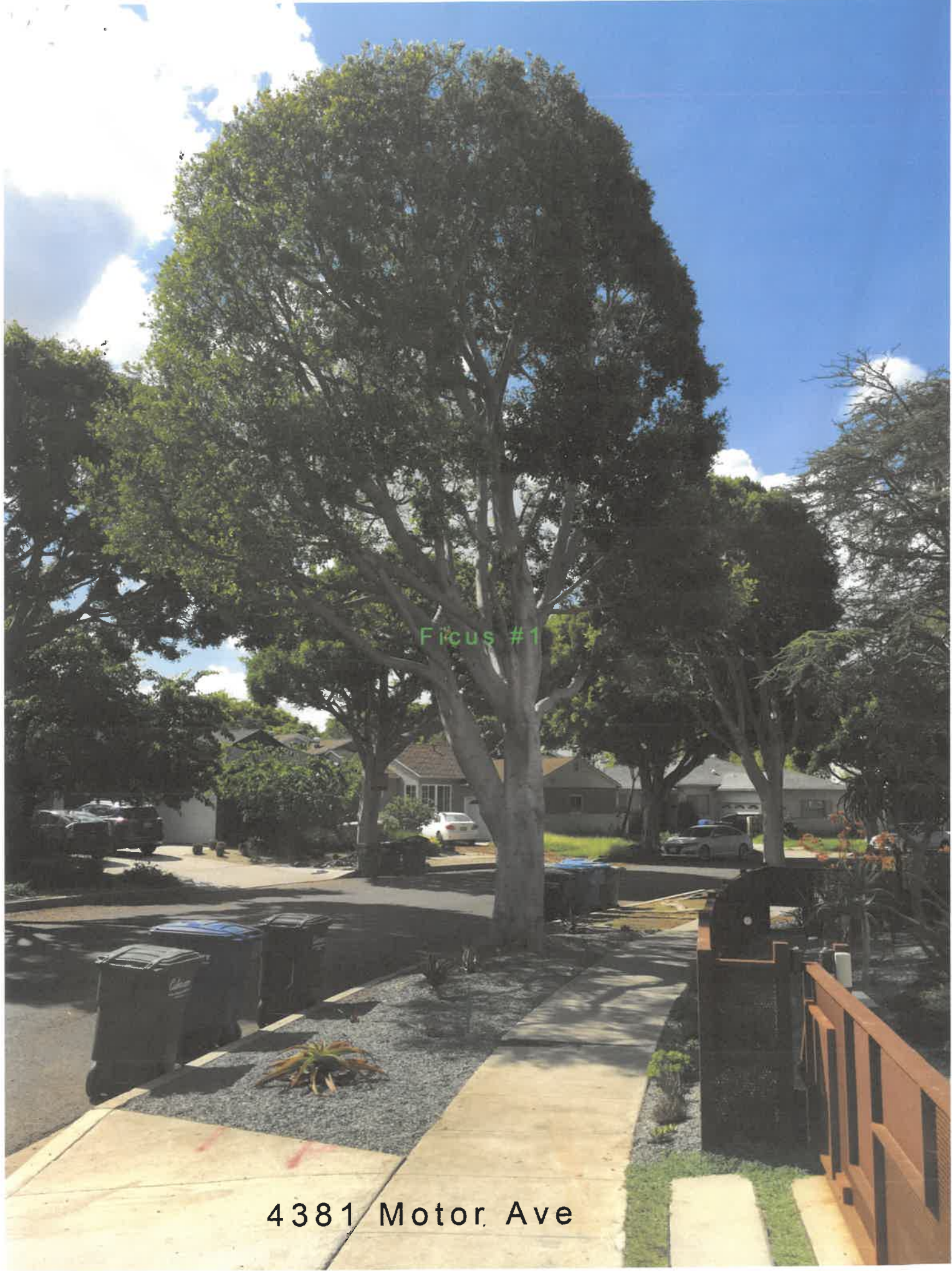

Ficus #1

4381 Motor Ave



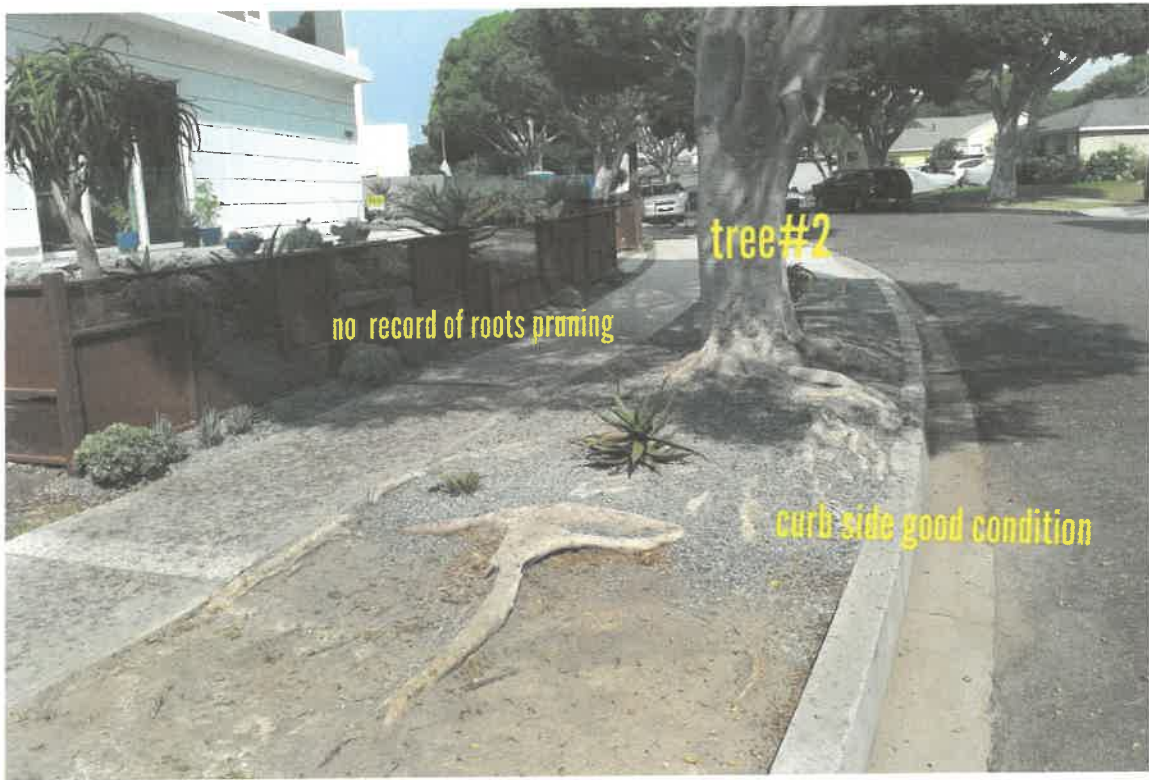





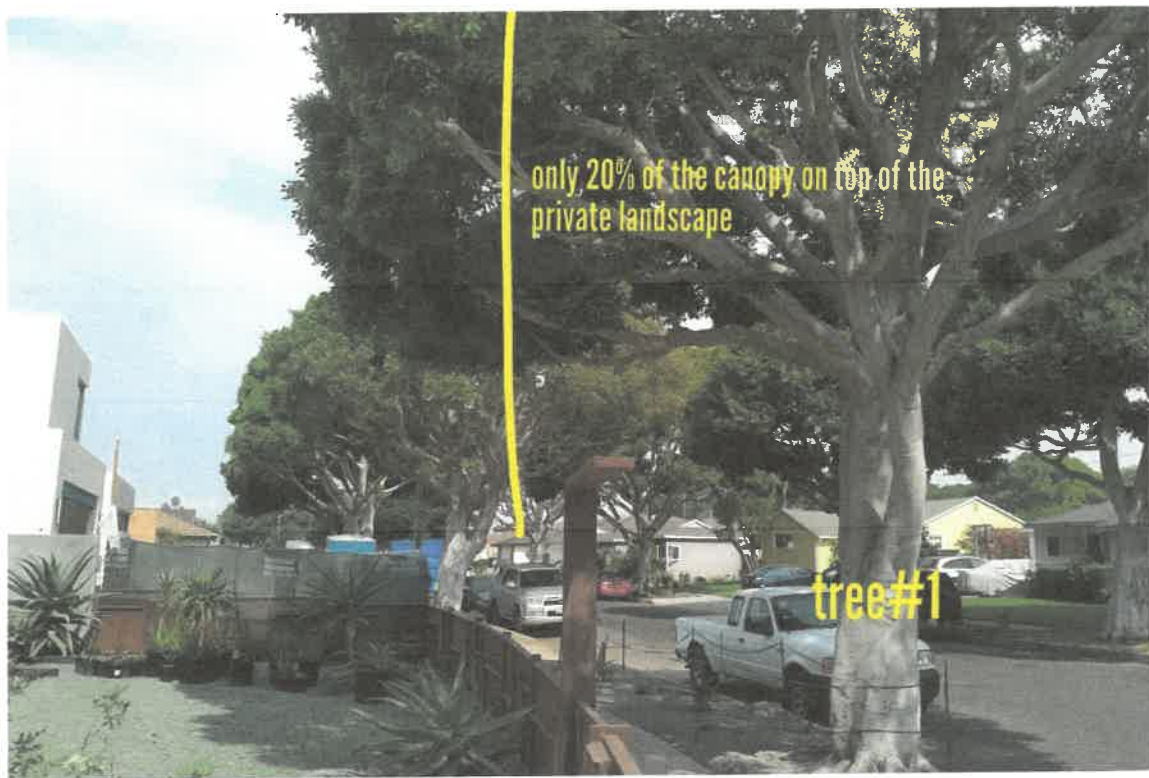



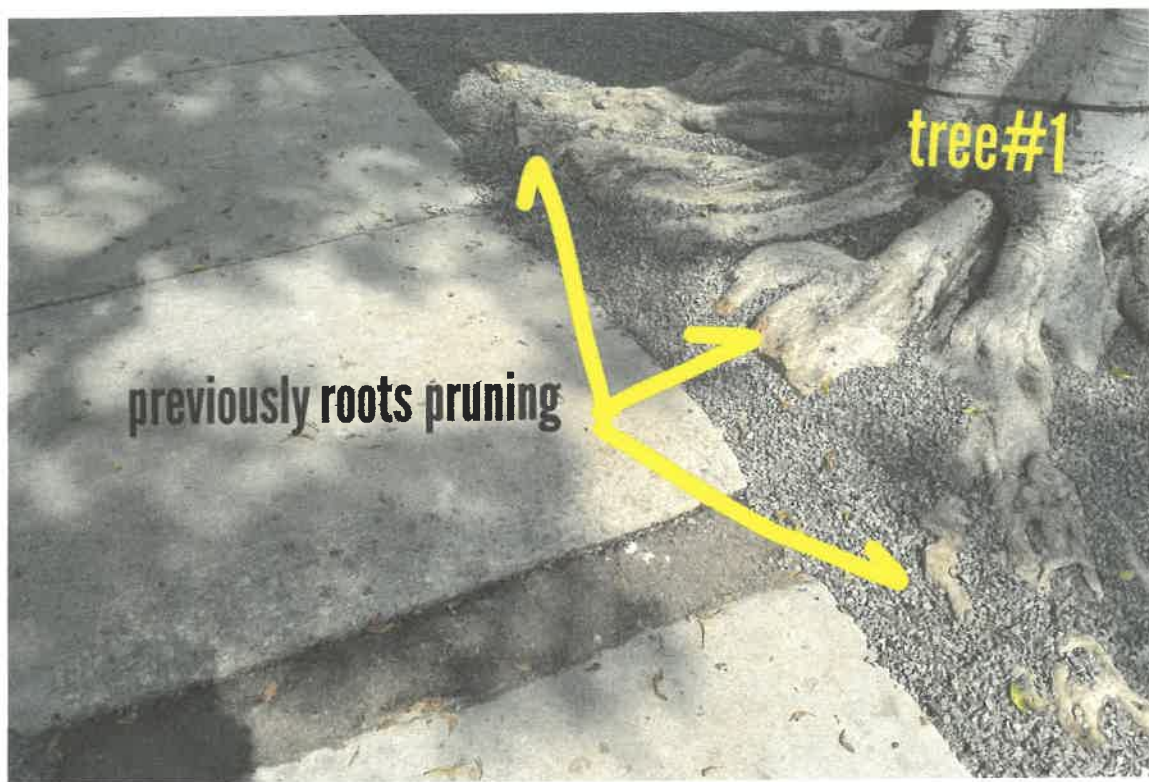





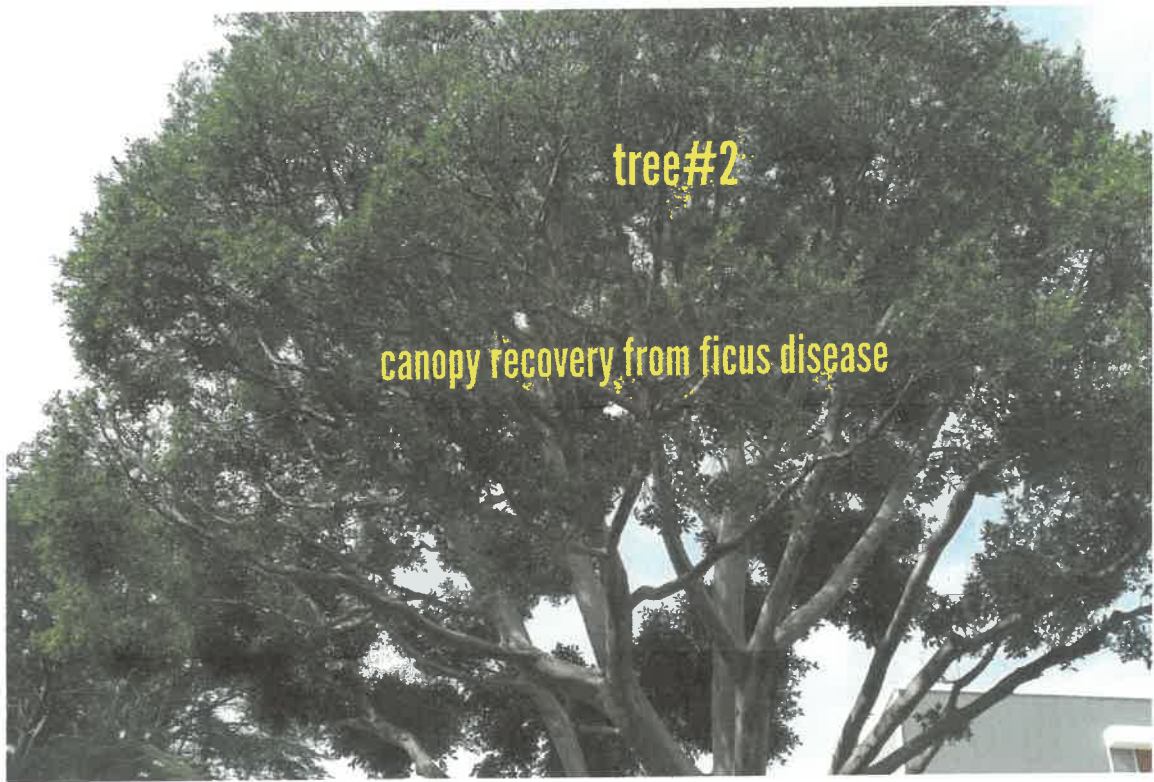

tree#2

canopy recovery from ficus disease



good tree branches attachment

tree#2



