

CONSTRUCTION NOTES (B-PERMITS):

1. THE B-PERMITTEE SHALL BE RESPONSIBLE FOR LABOR AND MATERIAL INVOLVED IN THE REMOVAL, MARKOUT, AND INSTALLATION OF ALL STRIPING, PAVEMENT MARKINGS, CURB MARKINGS, AND SIGNS SHOWN HEREON. REMOVAL OF MARKINGS SHALL BE PERFORMED BEFORE MARKOUT AND INSTALLATION OF NEW STRIPING, AND SHALL BE BY WET SANDBLASTING/GRINDING IN ACCORDANCE WITH LADOT SPECIFICATION NO. 76-016-10. MARKOUT SHALL BE BY HEAVY PAINT BRUSH MARKINGS OR SPRAY PAINT OVER A PULLED ROPE IN THE RESPECTIVE WHITE OR YELLOW COLORS OF THE PROPOSED STRIPING. STRIPING AND PAVEMENT MARKINGS SHALL BE IN HOT APPLIED ALKYD THERMOPLASTIC IN ACCORDANCE WITH LADOT SPECIFICATIONS NOS. 51-005-10 AND 76-012-15.
2. THE INSTALLATION OF THERMOPLASTIC STRIPING MAY PROCEED ONLY AFTER INSPECTION AND APPROVAL OF MARKOUT BY LADOT. THE CONTRACTOR SHALL CORRECT ALL ERRORS IN MARKOUT REQUESTED BY LADOT. UPON APPROVAL OF MARKOUT, THE CONTRACTOR SHALL FULLY INSTALL THE THERMOPLASTIC STRIPING, PAVEMENT MARKINGS, (CURB MARKINGS, AND SIGNS - AS APPLICABLE) WITHIN THE FOLLOWING THREE (3) WORKING DAYS. THE CONTRACTOR SHALL CONTACT CITY WIDE INVESTIGATION OFFICE AT (213) 928-9612 AT THE FOLLOWING POINTS IN TIME AND FOR THE FOLLOWING PURPOSES:
 - A. TEN (10) WORKING DAYS IN ADVANCE OF MARKOUT.
 - B. UPON COMPLETION OF MARKOUT (INCLUDING ANY MARKOUT CORRECTIONS) FOR INSPECTION AND APPROVAL.
 - C. UPON COMPLETION OF THERMOPLASTIC STRIPING (INCLUDING ANY THERMOPLASTIC STRIPING CORRECTIONS) FOR INSPECTION AND FINAL STRIPING APPROVAL.

3. DURING ALL PHASES OF CONSTRUCTION, TEMPORARY RAISED OVERLAY PAVEMENT MARKERS SHALL BE MAINTAINED ADJACENT TO ANY TEMPORARY CENTERLINE, MARKOUT CENTERLINE, OR SCAR OF A SANDBLASTED CENTERLINE, AS APPLICABLE, AS PER LADOT STANDARD PLAN NO. S-453.0.
4. THE FIELD CONDITIONS SHOWN AS EXISTING ON THIS PLAN MAY CHANGE BETWEEN THE PLAN APPROVAL DATE AND THE IMPLEMENTATION DATE. THE CONTRACTOR MAY BE REQUIRED TO INSTALL OR REMOVE STRIPING, PAVEMENT MARKINGS, CURB MARKINGS, SIGNS OR OTHER TRAFFIC CONTROL DEVICES BEYOND THOSE INDICATED ON THIS PLAN, IN ORDER TO FACILITATE THESE CHANGES IN FIELD CONDITIONS AND/OR TO BE IN COMPLIANCE WITH LADOT STANDARDS AND SPECIFICATIONS.
5. IF THIS PLAN HAS NOT BEEN INSTALLED WITHIN TWO (2) YEARS OF THE APPROVAL DATE, IT SHALL BE RESUBMITTED TO LADOT PUBLIC IMPROVEMENTS SECTION FOR RE-APPROVAL PRIOR TO PROCEEDING TO CONSTRUCTION.
6. INSTALL PEDESTRIAN BARRICADE PER S-454.2.

LEGEND

1. EXISTING STRIPING & MARKINGS TO REMAIN
2. EXISTING STRIPING & MARKINGS TO BE REMOVED
3. PROPOSED STRIPING & MARKINGS
4. EXISTING SIGNS
5. PROPOSED SIGNS
6. SIGNALIZED INTERSECTION
7. EXISTING RED CURB
8. PROPOSED RED CURB

NOTES

1. LENGTH OF DESIGN : 700'±
2. 6" x 4' WHITE STRIPE WITH 8' GAP (TYPICAL)
3. PAINT REMOVAL REQUIRED.

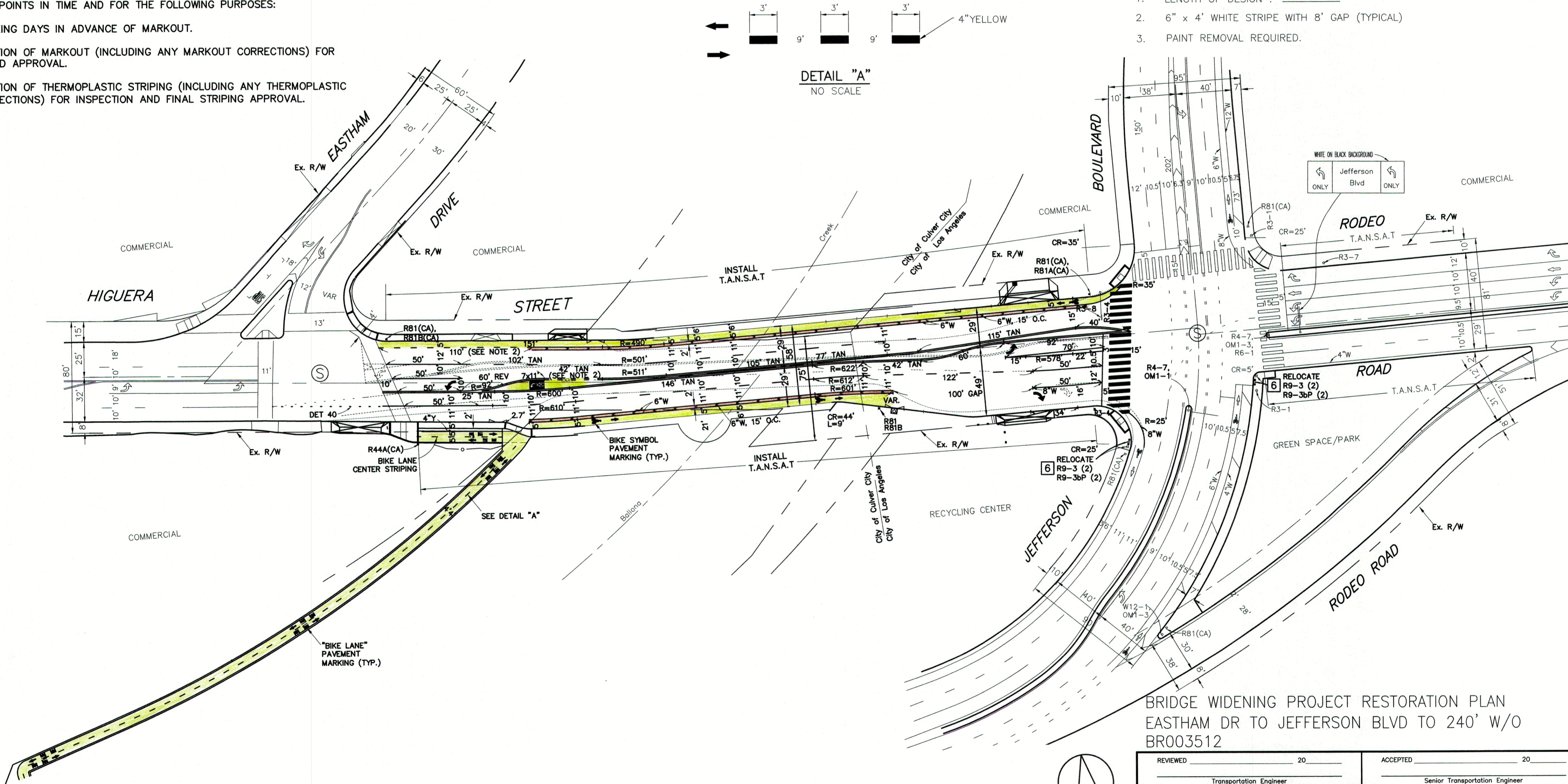

DETAIL "A"
NO SCALE

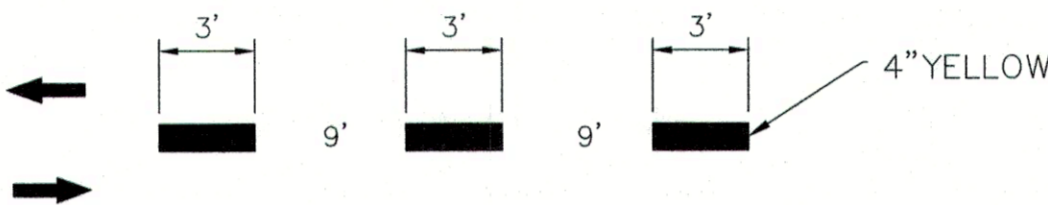

SCALE: 1"=40'

PLANS PREPARED BY:
PSOMAS
555 South Flower Street, Suite 4300
Los Angeles, CA 90071
(213) 223-1400 Fax (213) 223-1444

ARIEF NAFTALI, P.E., T.E.

11/24/2018
DATE



1"=20'
ORIGINAL MAP SCALE
1"=40'
20 40 60 80 100 120 140 160 180 200 FEET

CULVER CITY PUBLIC
WORKS DEPARTMENT

ACCEPTED BY :
SAMMY ROMO, P.E.
ASSOCIATE ENGINEER

DATE:

REVIEWED _____ 20_____
Transportation Engineer

ACCEPTED _____ 20_____
Senior Transportation Engineer

INSTALLATION DATES

MARKOUT BEGAN:

MARKOUT COMPLETED:

STRIPING COMPLETED:

References:

A-6241,
FIELD CHECK 02-03-15

Thomas Guide

672, JI

District

Hollywood-
Wilshire

PROJECT NO.

BR003512

DRAWING NO.

A-6576

1

1

CITY OF LOS ANGELES
DEPARTMENT OF TRANSPORTATION
SELETA J. REYNOLDS, GENERAL MANAGER

HIGUERA STREET
EASTHAM DR TO JEFFERSON BLVD

PROJECT NO.

BR003512

DRAWING NO.

A-6576

1

1

SCALES

HORIZ. 1"=

VERT. 1"=

SHEET 9

OF 43

INDEX NUMBER

OM1-1 (YELLOW)	STOP R1-1
SPEED LIMIT 35 R2-1	R3-1
R3-2	R3-4
ONLY R3-5	R3-7
ONLY R3-8	R3-18
ONE WAY R4-7	R6-1
NO PEDESTRIAN CROSSING R9-3	R9-3A
USE CROSSWALK R9-3B(L)	USE CROSSWALK R9-3B(R)
NO TURN ON RED R10-11	ROAD CLOSED R11-2
NO MOTOR VEHICLES EXCEEDING 20 MPH R44A(CA)	BIKE LANE R81(CA)
BEGIN R81A(CA)	END R81B(CA)
SW44(CA)	W3-1
W4-1	W4-7
W12-1	
DATE	DATE
BY	BY
SUPERVISOR	SUPERVISOR
DISTRICT	DISTRICT
SIGNALS	SIGNALS
DATE	DATE
BY	BY
BASE	BASE
CHECK	CHECK
DESIGN	DESIGN
NO	NO
REVISION DESCRIPTION	REVISION DESCRIPTION
T.E./S.R. T.E.	T.E./S.R. T.E.