

RESOLUTION NO. 2018-R _____

A RESOLUTION OF THE CITY COUNCIL OF THE CITY OF
CULVER CITY, CALIFORNIA, APPROVING AN
ENCROACHMENT AGREEMENT WITH FIRELINE
NETWORK SOLUTIONS.

WHEREAS, Fireline Network Solutions, Inc. (dba: Fireline Broadband) has
applied for a permit to encroach upon Culver City's public rights-of-way in order to install
conduit, fiber optic cable and related appurtenances, as described in the Rights-of-Way
Users Questionnaire dated April 11, 2018 and in the related encroachment agreement;

WHEREAS, Fireline Network Solutions, Inc. is a telecommunications company
duly authorized to provide telecommunication services by the California Public Utilities
Commission;

WHEREAS, the City of Culver City is authorized to regulate the time, place
and manner of the placement of telecommunication facilities in its public rights-of-way;

WHEREAS, Section 11.20.025(D) of the Culver City Municipal Code provides
that encroachment permits are subject to approval by the City Council.

NOW, THEREFORE, the City Council of the City of Culver City, California,
DOES HEREBY RESOLVE, as follows:

1. The Fireline Network Solutions, Inc. application for its project,
designated with a Project Name of 965-DH014-B01-CUL and depicted in the attached
Exhibit A, is hereby approved.

2. The City Manager or his/her designee is authorized to execute the

...

...

...

1 related encroachment agreement on behalf of the City of Culver City.

2 APPROVED and ADOPTED this _____ day of _____ 2018.

3
4
5 THOMAS AUJERO SMALL, MAYOR
6 City of Culver City, California

7
8 ATTEST:

APPROVED AS TO FORM:

9
10
11 JEREMY GREEN, City Clerk

12 A18-00241

13
14
15
16
17
18
19
20
21
22
23
24
25
26
27
28

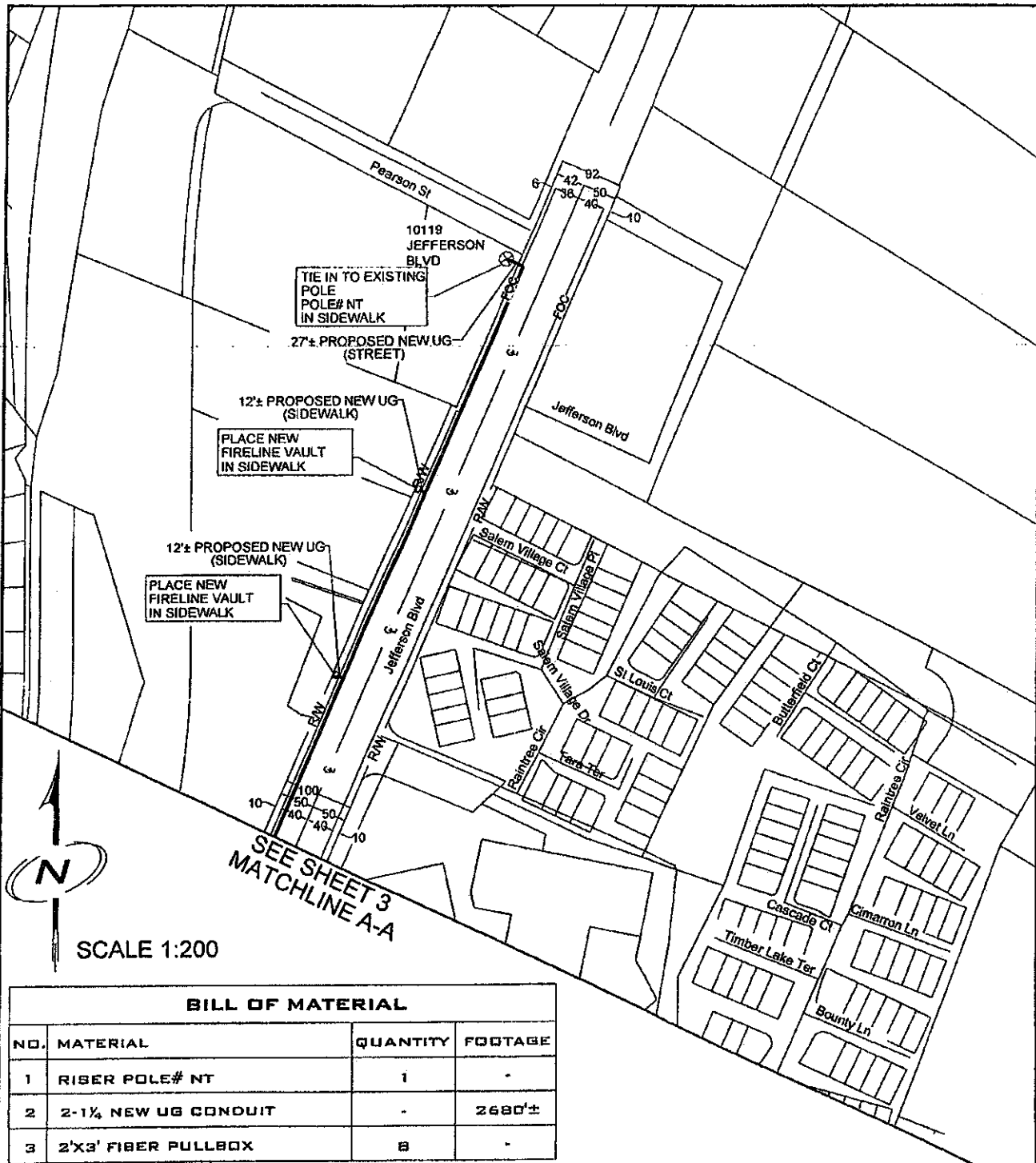
CAROL A. SCHWAB,
City Attorney



BILL OF MATERIAL

NO.	MATERIAL	QUANTITY	FOOTAGE
1	RISER POLE# NT	1	-
2	2-1¼ NEW UG CONDUIT	-	2680'±
3	2'X3' FIBER PULLBOX	8	-

FIRELINE
BROADBAND

DESIGNED BY.....

KB
ENGINEERING

290 CORPORATE TERRACE CIRCLE
STE. 200, COVINA, CA 91724

WWW.KBENG.NET

TEL 951-808-9501
FAX 951-808-9518

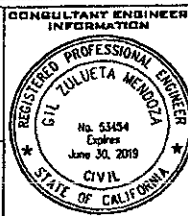

PROJECT NO. _____
PLAN NO. _____



PROJECT NAME:
965-OHD 14-S01-CUL
LOCATION:
W JEFFERSON BLVD FROM PEARSON ST TO JORDAN WAY

PROJECT DESCRIPTION:
PROPOSED ROUTE WILL START AT THE SOUTH EAST CORNER OF PEARSON ST RIBERING DOWN TO EXISTING POLE. THE ROUTE WILL THEN TRAVEL SOUTH ON W JEFFERSON BLVD TO JORDAN WAY. THE PATH WILL BE SERVING 8 LOCATIONS WHICH IN THESE LOCATIONS, FIRELINE WILL BE PROPOSING VAULTS IN THE SIDEWALK/PARKWAY. THE PROPOSED ROUTE WILL BE APPROXIMATELY 2,680'±.

SYSTEM EXHIBIT

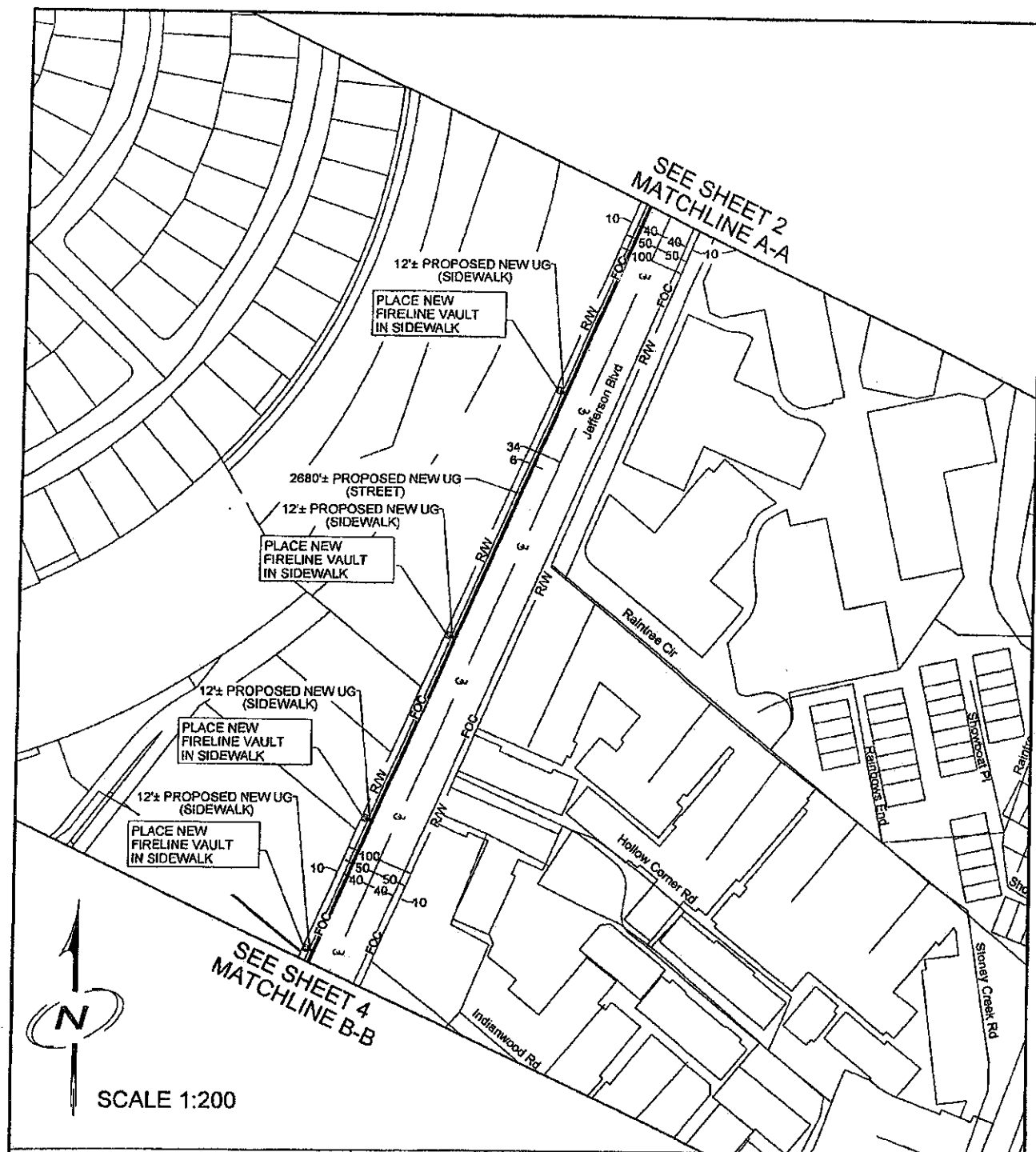
SHEET NO.
2 OF 4



 <p>DESIGNED BY.....</p>  <p>290 CORPORATE TERRACE CIRCLE STE. 200, CORONA, CA 92879 WWW.KBENG.NET TEL. 951-808-9501 FAX. 951-808-9518</p>	<p>CONSULTANT ENGINEER INFORMATION</p>  <p>PROJECT NO. _____ PLAN NO. _____</p>	<p>PROJECT NAME: 955-DH014-801-00L</p> <p>LOCATION: W JEFFERSON BLVD FROM PEARSON ST TO JORDAN WAY</p> <p>PROJECT DESCRIPTION: PROPOSED ROUTE WILL START AT THE SOUTH EAST CORNER OF PEARSON ST RISING DOWN TO EXISTING POLE. THE ROUTE WILL THEN TRAVEL SOUTH ON W JEFFERSON BLVD TO JORDAN WAY. THE PATH WILL BE SERVING 8 LOCATIONS WHICH IN THESE LOCATIONS, FIRELINE WILL BE PROPOSING VAULTS IN THE SIDEWALK/PARKWAY. THE PROPOSED ROUTE WILL BE APPROXIMATELY 2,680±.</p> <p>SYSTEM EXHIBIT</p> <p>SHEET NO. 3 OF 4</p>
--	--	--

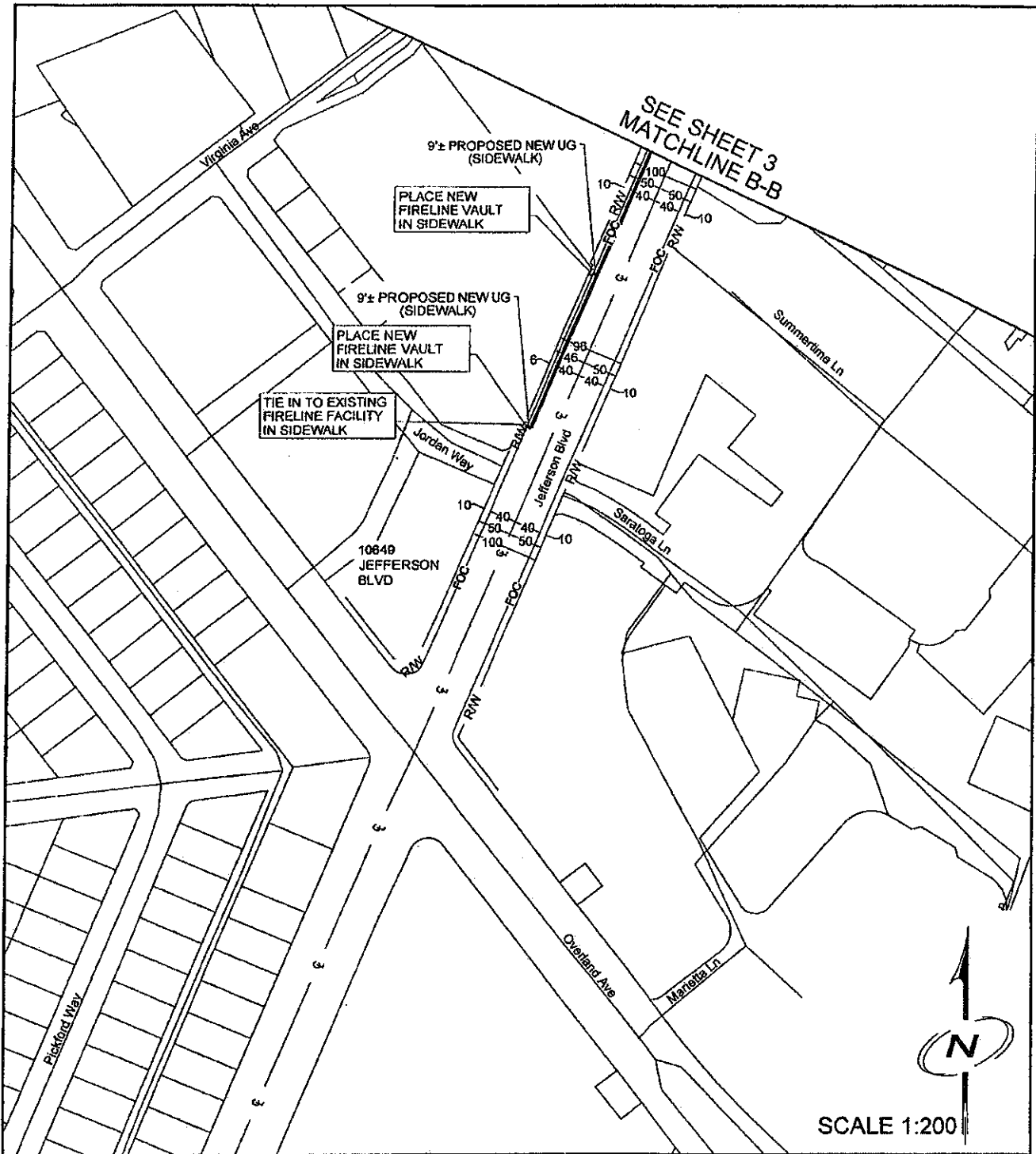

<p>FIRELINE BROADBAND</p> <p>DESIGNED BY.....</p> <p>KB ENGINEERING</p> <p>290 CORPORATE TERRACE, SUITE 200, OAKLAND, CA 94612</p> <p>WWW.KBENG.NET</p> <p>TEL. 951-808-9501</p> <p>FAX. 951-808-9518</p>	<p>CONSULTANT ENGINEER INFORMATION</p> <p>REGISTERED PROFESSIONAL ENGINEER</p> <p>GIL ZALUETA MENDOZA</p> <p>No. 53454</p> <p>Expires June 30, 2019</p> <p>CIVIL</p> <p>STATE OF CALIFORNIA</p> <p>PROJECT NO. _____</p> <p>PLAN NO. _____</p>	<p>PROJECT NAME: 965-DHD14-001-CUL</p> <p>LOCATION: W JEFFERSON BLVD FROM PEARSON ST TO JORDAN WAY</p> <p>PROJECT DESCRIPTION: PROPOSED ROUTE WILL START AT THE SOUTH EAST CORNER OF PEARSON ST RISING DOWN TO EXISTING POLE. THE ROUTE WILL THEN TRAVEL SOUTH ON W JEFFERSON BLVD TO JORDAN WAY. THE PATH WILL BE SERVICING 8 LOCATIONS WHICH IN THESE LOCATIONS, FIRELINE WILL BE PROPOSING VAULTS IN THE SIDEWALK/PARKWAY. THE PROPOSED ROUTE WILL BE APPROXIMATELY 2,680'±.</p> <p>SYSTEM EXHIBIT</p> <p>SHEET NO. 4 OF 4</p>
---	--	--