

RESOLUTION NO. 2018-R _____

A RESOLUTION OF THE CITY COUNCIL OF THE CITY OF
CULVER CITY, CALIFORNIA, APPROVING AN
ENCROACHMENT AGREEMENT WITH CROWN CASTLE.

WHEREAS, Crown Castle has applied for a permit to encroach upon Culver
City's public rights-of-way in order to install conduit, fiber optic cable and related
appurtenances, as described in the Rights-of-Way Users Questionnaire dated March 15,
2018 and in the related encroachment agreement;

WHEREAS, Crown Castle is a telecommunications company duly authorized
to provide telecommunication services by the California Public Utilities Commission;

WHEREAS, the City of Culver City is authorized to regulate the time, place
and manner of the placement of telecommunication facilities in its public rights-of-way;

WHEREAS, Section 11.20.025(D) of the Culver City Municipal Code provides
that encroachment permits are subject to approval by the City Council.

NOW, THEREFORE, the City Council of the City of Culver City, California,
DOES HEREBY RESOLVE, as follows:

1. The Crown Castle application for its project, designated with a Project
Name of SO6596 and depicted in the attached Exhibit A and Exhibit B, is hereby approved.

2. The City Manager or his/her designee is authorized to execute the

///

///

///

///

///

1 related encroachment agreement on behalf of the City of Culver City.

2 APPROVED and ADOPTED this _____ day of _____ 2018.

3
4
5 THOMAS AUJERO SMALL, MAYOR
6 City of Culver City, California

7
8 ATTEST:

APPROVED AS TO FORM:

9
10
11 JEREMY GREEN, City Clerk

for CAROL A. SCHWAB,
City Attorney

12 A18-00172

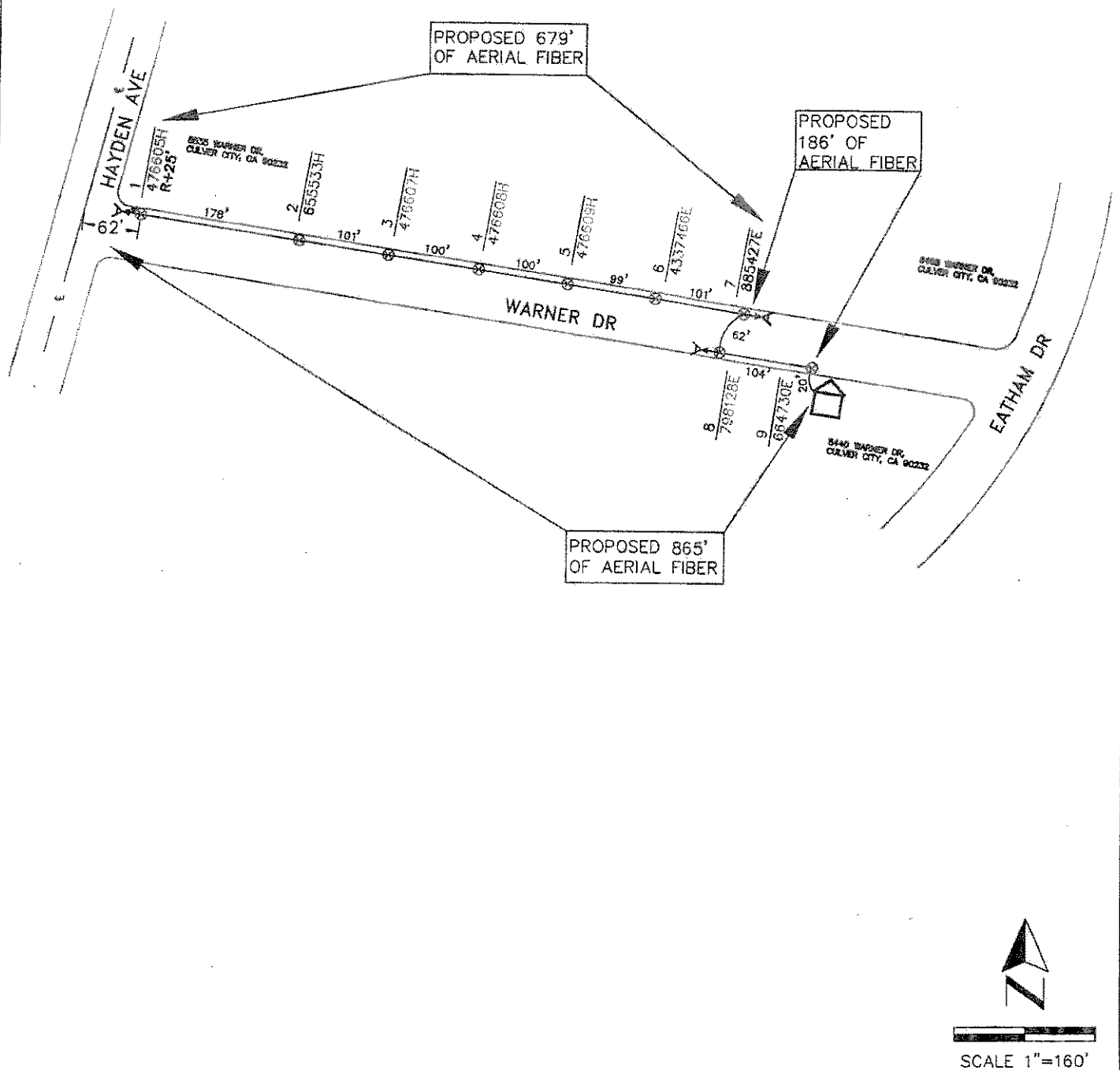



BILL OF MATERIALS				LEGEND	
NO.	MATERIAL	QTY	FOOTAGE	⊗ EXISTING UTILITY POLE	
1	FIBER OPTIC CABLE	1	865'		
 CROWN CASTLE 200 SPECTRUM CENTER DR. STE. 1800 IRVINE, CA 92618 www.crowncastle.com				PROJECT ADDRESS: WARNER DR AND HAYDEN AVE, CULVER CITY, CA	
 SUPDESIGN GROUP, LLC 722 GENEVIEVE ST., SUITE 1 SOLANA BEACH, CA 92075 www.supdesignllc.com				SYSTEM EXHIBIT A	PROJECT #: S06596-8440 WARNER DR

Exhibit A of Resolution No 2018-R

PROPOSED 55' OF 3-1 $\frac{1}{4}$ " HDPE CONDUIT
FROM EXISTING CONDUIT TO VAULT

PROPOSED WILCON 2' X 3' VAULT

PROPOSED 3' X 5' BORE PIT

PROPOSED 5' DIRT TRENCH

PROPOSED 3' X 5' BORE PIT

RISER AT EXISTING UTILITY POLE #NT

PROPOSED REMOVAL & REPLACEMENT
5' X 6' SIDEWALK PANEL

PROPOSED REMOVAL & REPLACEMENT
5' X 5' SIDEWALK PANEL

DIRECTIONAL BORE

SCALE 1"=40'

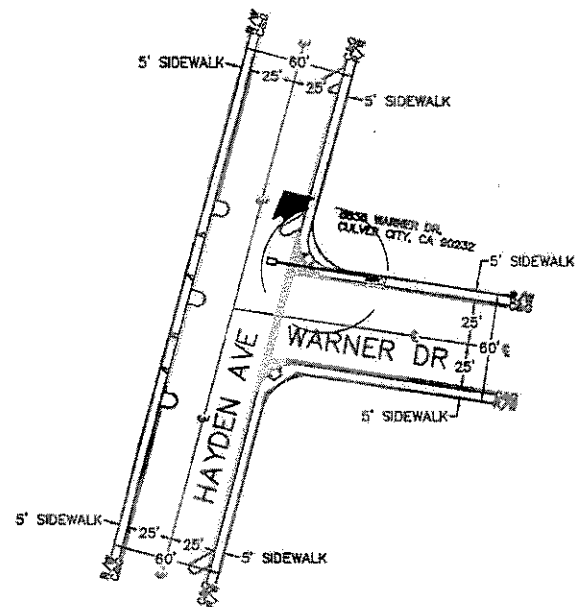
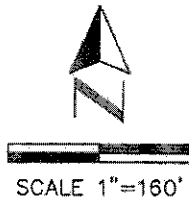

LEGEND

PROPOSED IMPROVEMENTS:

HANDHOLE / VAULT (PVT)

3' X 5' BORE PIT

SIDEWALK (PCC) REMOVAL & REPLACEMENT

DIRECTIONAL BORE AND FIBER CONDUIT (PVT)

DIRT TRENCH AND CONDUIT(S)(PVT)

EXISTING IMPROVEMENTS:

EXISTING UTILITY POLE

SYMBOL



SYMBOL



BILL OF MATERIALS

NO.	MATERIAL	QTY	FOOTAGE
1	CONDUIT (PVT) 1-1/4" PVC	3	180
2	PLACE NEW 2' X 3' VAULT (PVT)	1	
3	TOTAL BORE PIT	2	
4	TOTAL SIDEWALK (PCC) REMOVE & REPLACE	2	55 SF

CROWN CASTLE
200 SPECTRUM CENTER DR. STE. 1800
IRVINE, CA 92618
www.crownncastle.com



SUPDESIGN GROUP, LLC
722 GENEVIEVE ST. SUITE T
SOLANA BEACH, CA 92075
www.supdesignllc.com

PROJECT ADDRESS:

WARNER DR AND HAYDEN AVE,
CULVER CITY, CA

SYSTEM EXHIBIT B

PROJECT #: S06596-8440 WARNER DR