

# Culver City Centennial Garden

**swa**

**August 30, 2017**

**Gerdo**

**Tina**

**Roman**

**Doug**



# OUR CULVER CITY

VENICE BOULEVARD

MEDIA  
PARK

CULVER BOULEVARD

CITY  
HALL

9300  
CULVER

THE  
CULVER  
STUDIOS

WASHINGTON BOULEVARD



**WE  
LISTEN.**





the very best thing about living in  
Silver City is ...

Lorem ipsum

Proximity  
sidewalk cafés

PARK DOUGLAS (theater)

- Location in the L.A. area.  
- proximity to rail + airport.  
- lively downtown.

- COOL HAUS ICE CREAM

- NOT TOURISTY

- Unique stores/cafés ... reminds me of Brooklyn NY

- ARTISTIC

- RAW, NATURAL still ~~modern~~ CONTEMPORARY  
- EDGE

## A CENTENNIAL GARDEN FOR...

- A SAFE PLACE TO TAKE MY FAMILY
- CELEBRATE CULTURE AND HERITAGE OF THE CITY
- ENGAGE WITH NEIGHBORHOOD
- ART, MUSIC
- CONNECTING ART-HISTORY-PEOPLE
- FESTIVALS
- SOCIAL GATHERINGS
- MAGICAL
- PUPPIES+DOGS+KITTIES!
- COMMUNITY GATHERING
- GARDEN OF MUSIC (SOUND AND MATERIAL)
- CLEAN AIR
- MUSIC BOWL
- PARK SEATING/PICNIC W/ LOTS OF SHADES
- EXERCISING AND BE HEALTHY
- COLOR!! FLOWERS, ETC
- SAFE PLACE TO HANGOUT MEET AND GREET
- NETWORKING, TO TAKE YOUR FAMILY
- SAFE PLACE FOR THE ELDERLY AND ACTIVITIES
- SAFE PLACE TO WALK AT NIGHT
- MEDITATION
- OUTDOOR SCREENING
- PEOPLE WATCHING





**FAMILIES LOVE  
CULVER CITY**



# DESIGN LOVES CULVER CITY







# SUSTAINABILITY LOVES CULVER CITY



**SCREENLAND  
LOVES  
CULVER CITY**



**WHAT DOES A  
CENTENNIAL GARDEN  
LOOK LIKE?**

**WHAT IS OUR INSPIRATION?**





MUSIC.  
LOVES.  
CULVER.







**CAPTURE  
CREATIVITY**

**CAPTURE  
CREATE  
COMMUNITY**

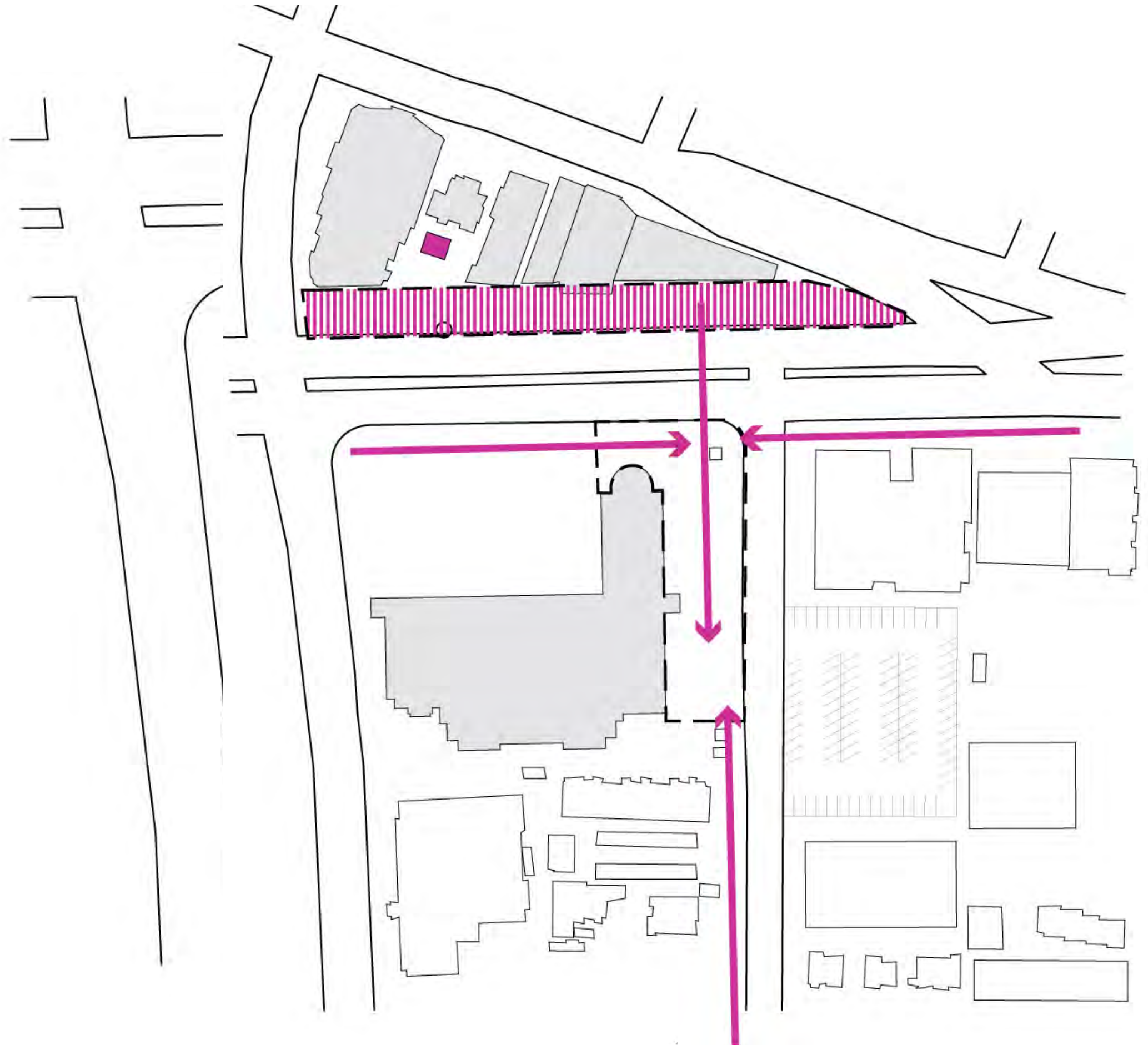



**RE-DEFINE  
THE EDGE**

**CAPTURE  
CREATE  
COMMUNITY**

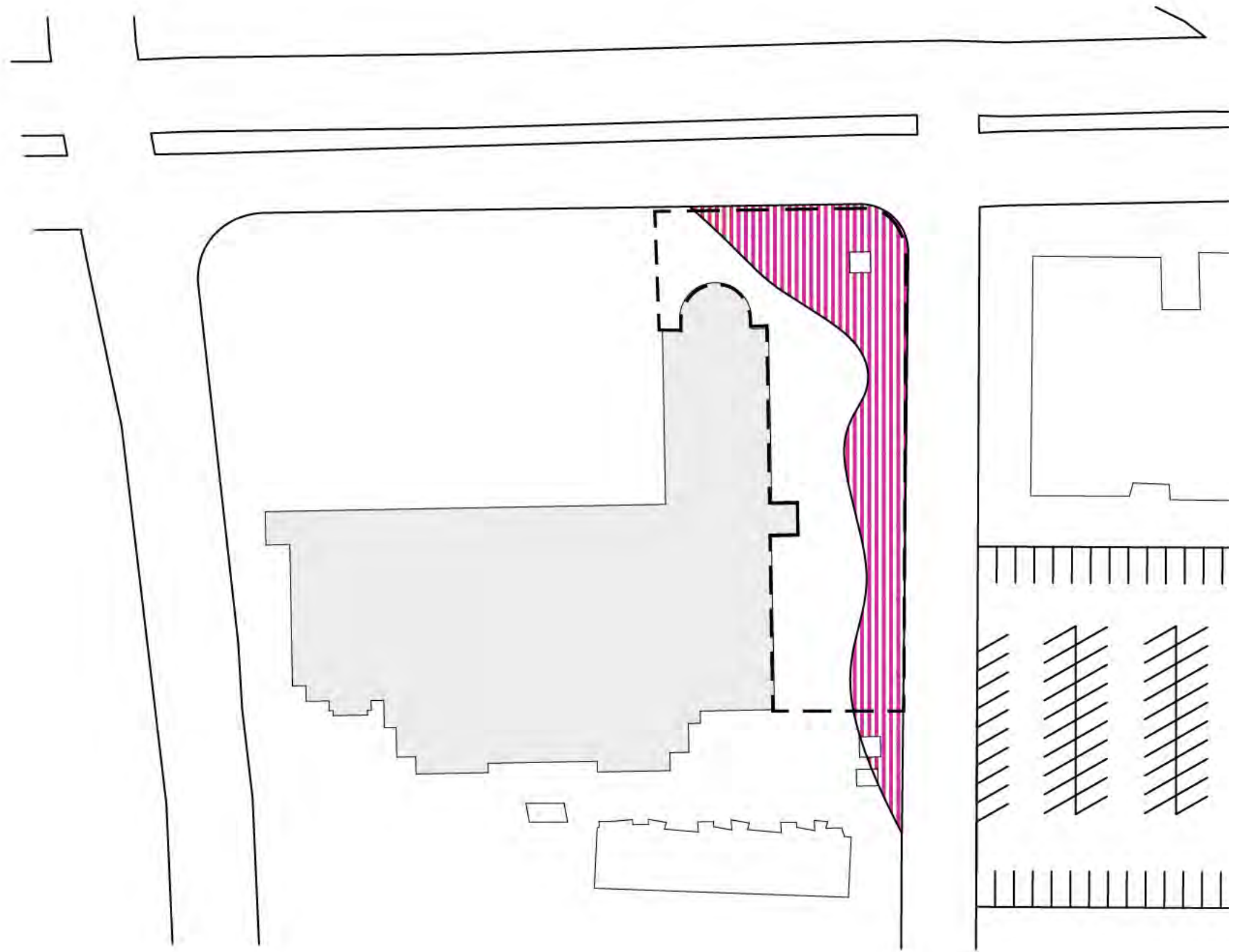

**EXTEND  
STREET TREES  
INTO SITE**

**CAPTURE  
CREATE  
COMMUNITY**

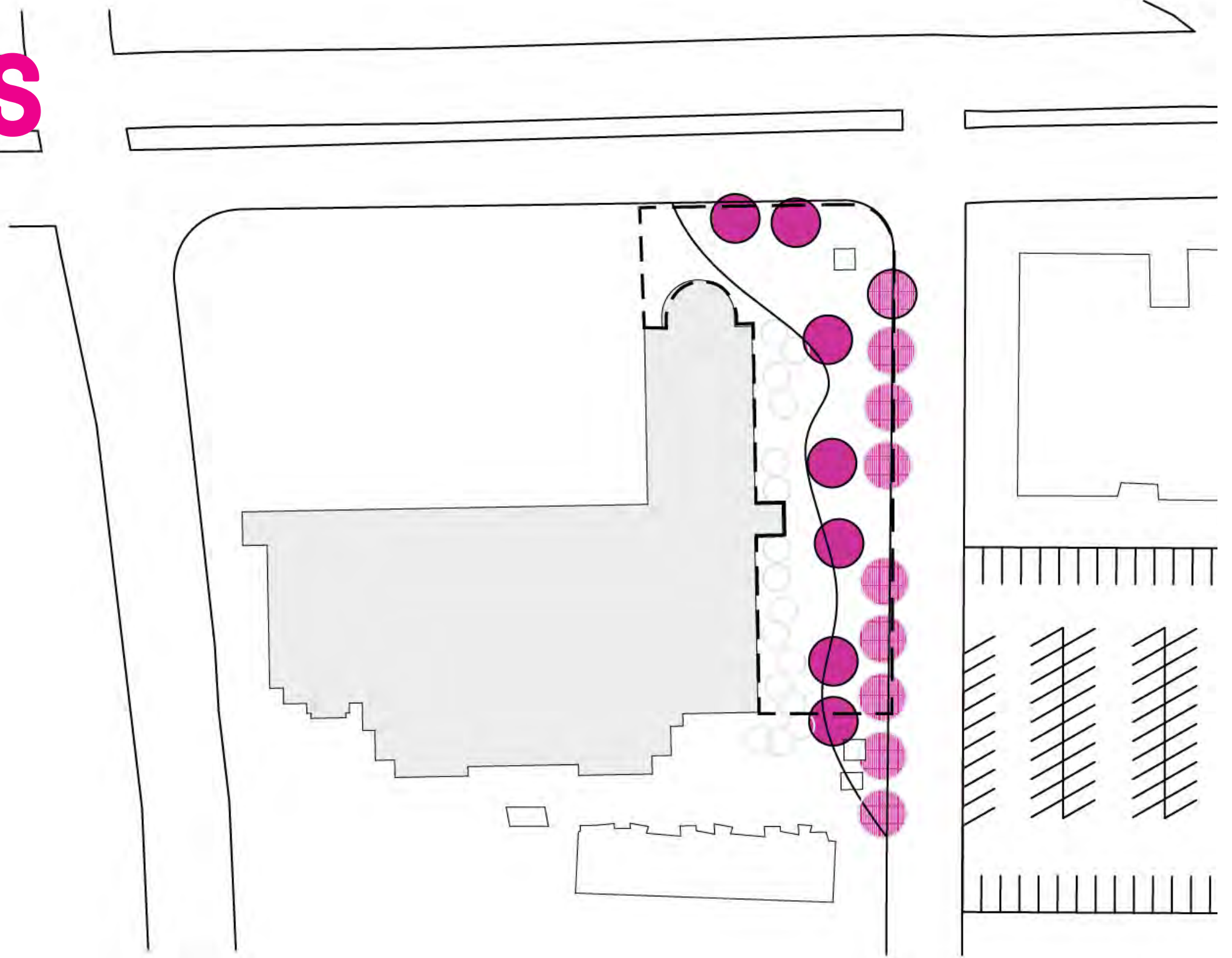

**CREATE  
ACTIVITY &  
PROGRAMS**

**CAPTURE  
CREATE  
COMMUNITY**







# WHAT WE HAVE NOW

**HEDGE BARRIER**

**HIGH WATER  
USE LAWN**

**LACK OF  
PROGRAMMABLE SPACE**

**OUTDATED PLANTING**



**ENHANCE**

**PRESERVE**

**ACTIVATE**

DUQUESNE AVENUE

LAFAYETTE PLACE



# CULVER BOULEVARD

ENHANCE LANDSCAPE WITH DROUGHT TOLERANT PLANTING

UPDATE WATER FEATURE AND PALM PLANTERS

UPDATE LIGHTING, SEATING AND FURNISHING ELEMENTS

PRESERVE AND ENHANCE CULTURAL ELEMENTS

ENHANCE LANDSCAPE WITH DROUGHT TOLERANT PLANTING

SPACE FOR FUTURE ART WORK

DUQUESNE AVENUE

INTERACTIVE MUSICAL SCULPTURE - AMPLIFIERS

PLAYFUL FUN PAVING AND SEATING

EXTEND TREES INTO PLAZA SPACE

INTERACTIVE MUSICAL SCULPTURE - CHIMES

LAFAYETTE PLACE

FOOD TRUCKS

INTERACTIVE MUSICAL SCULPTURE - DRUMS

SCULPTURAL PLANTS

ACTIVE OPEN PLAY AREA



# SCULPTURE AS PERFORMANCE

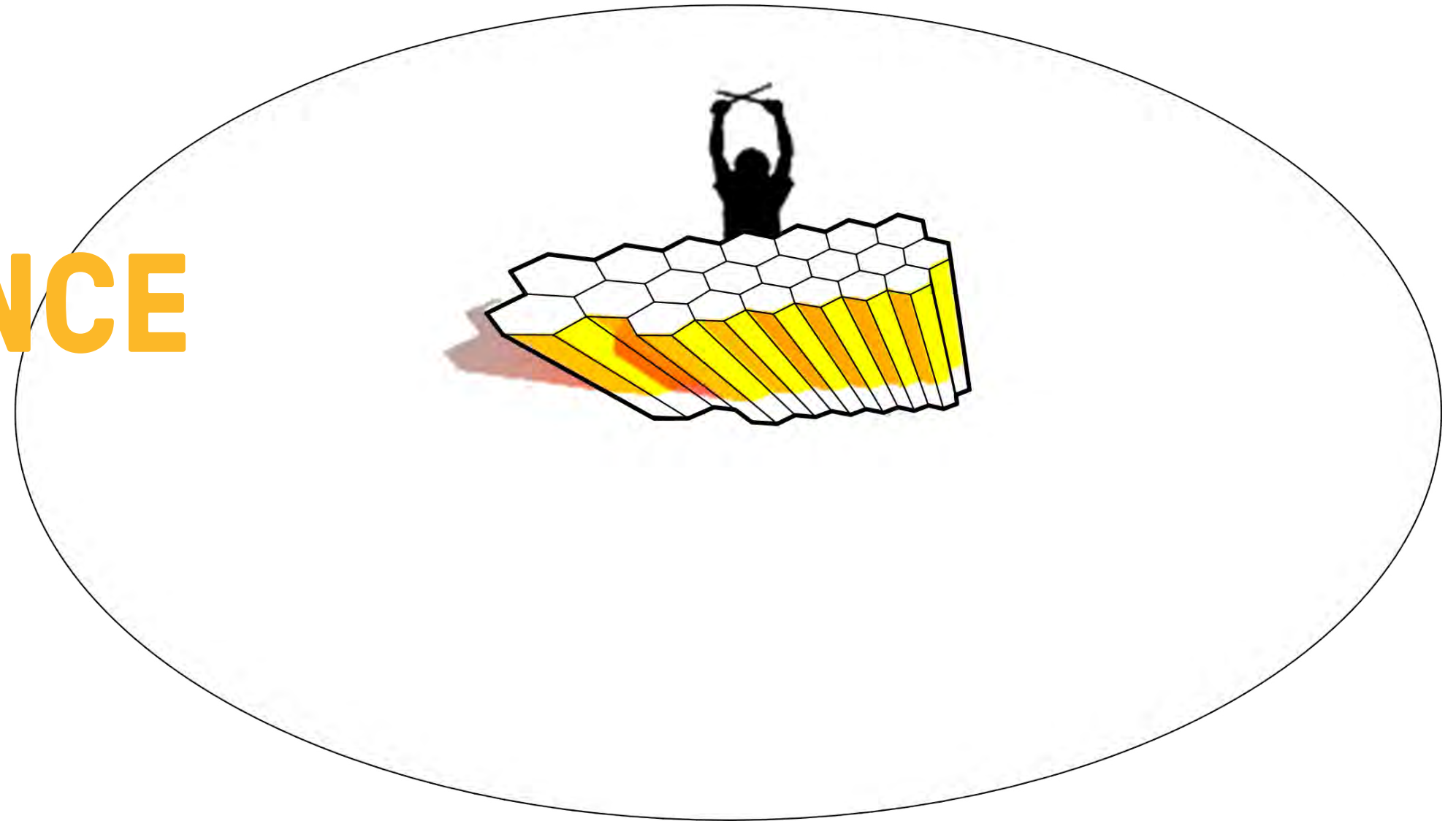

swa



# SCULPTURE AS PLAY

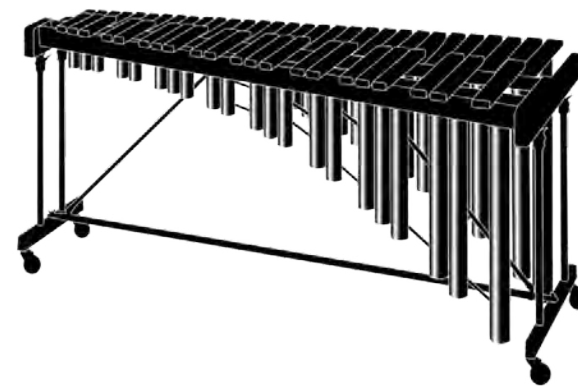
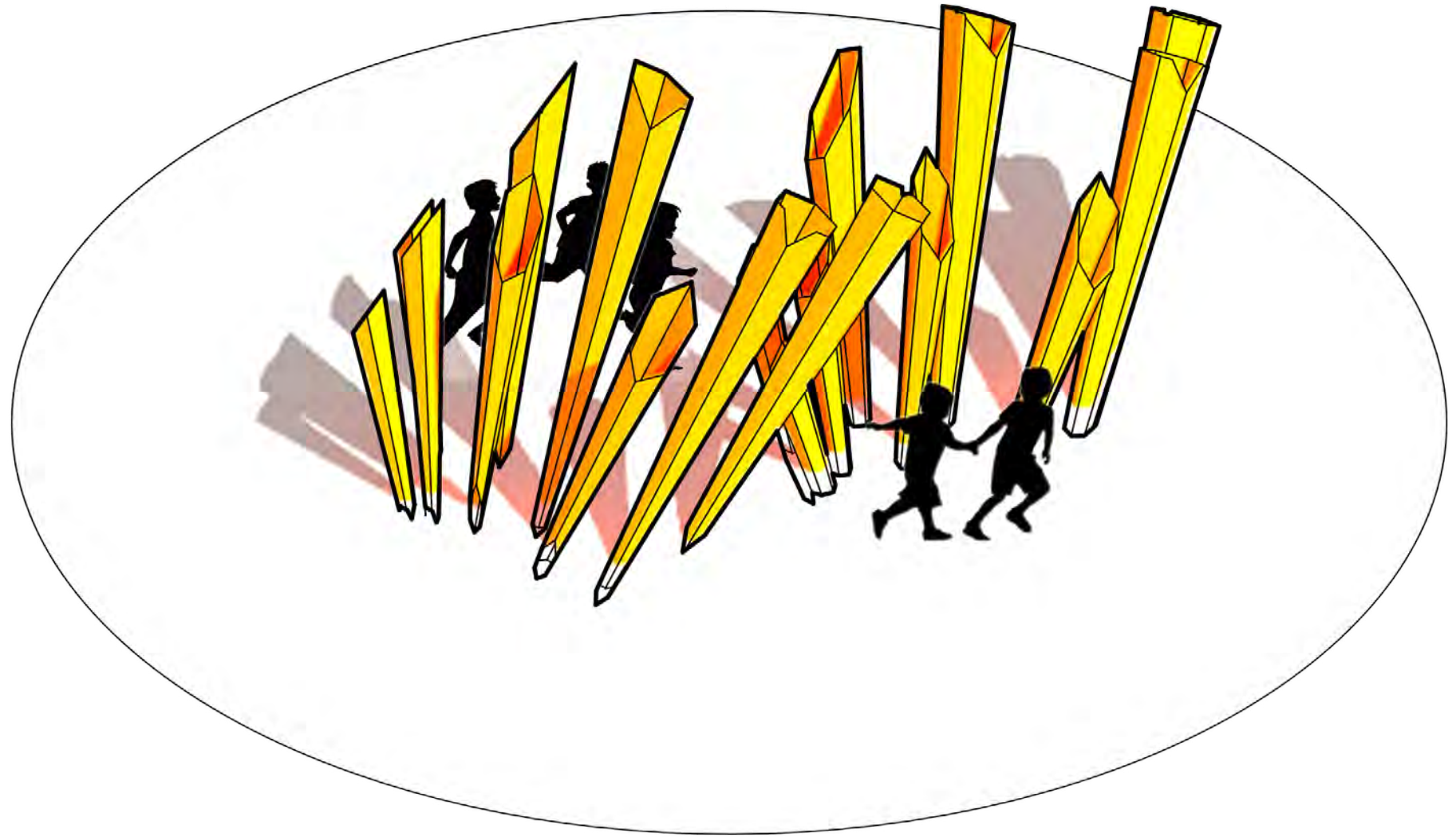

swa



# SCULPTURE AS STAGE

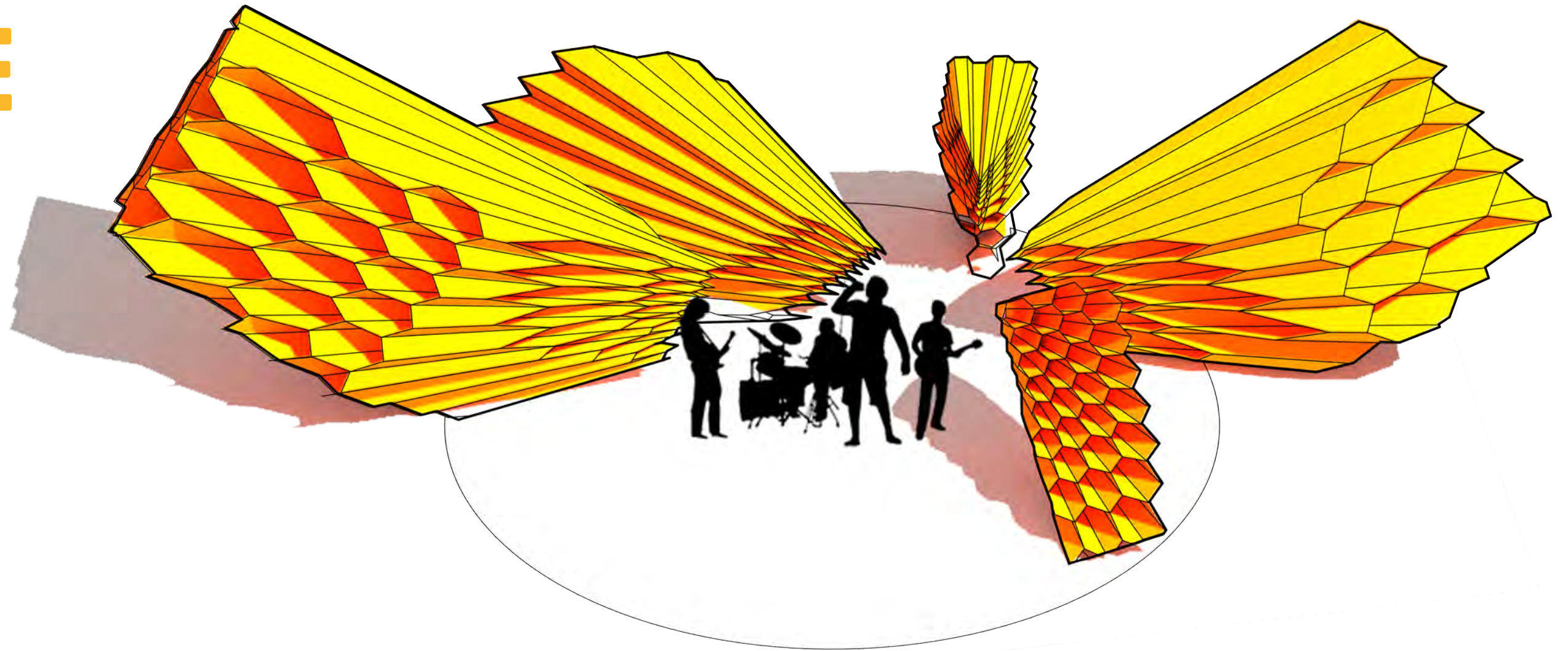



# SCULPTURE AS SOUND

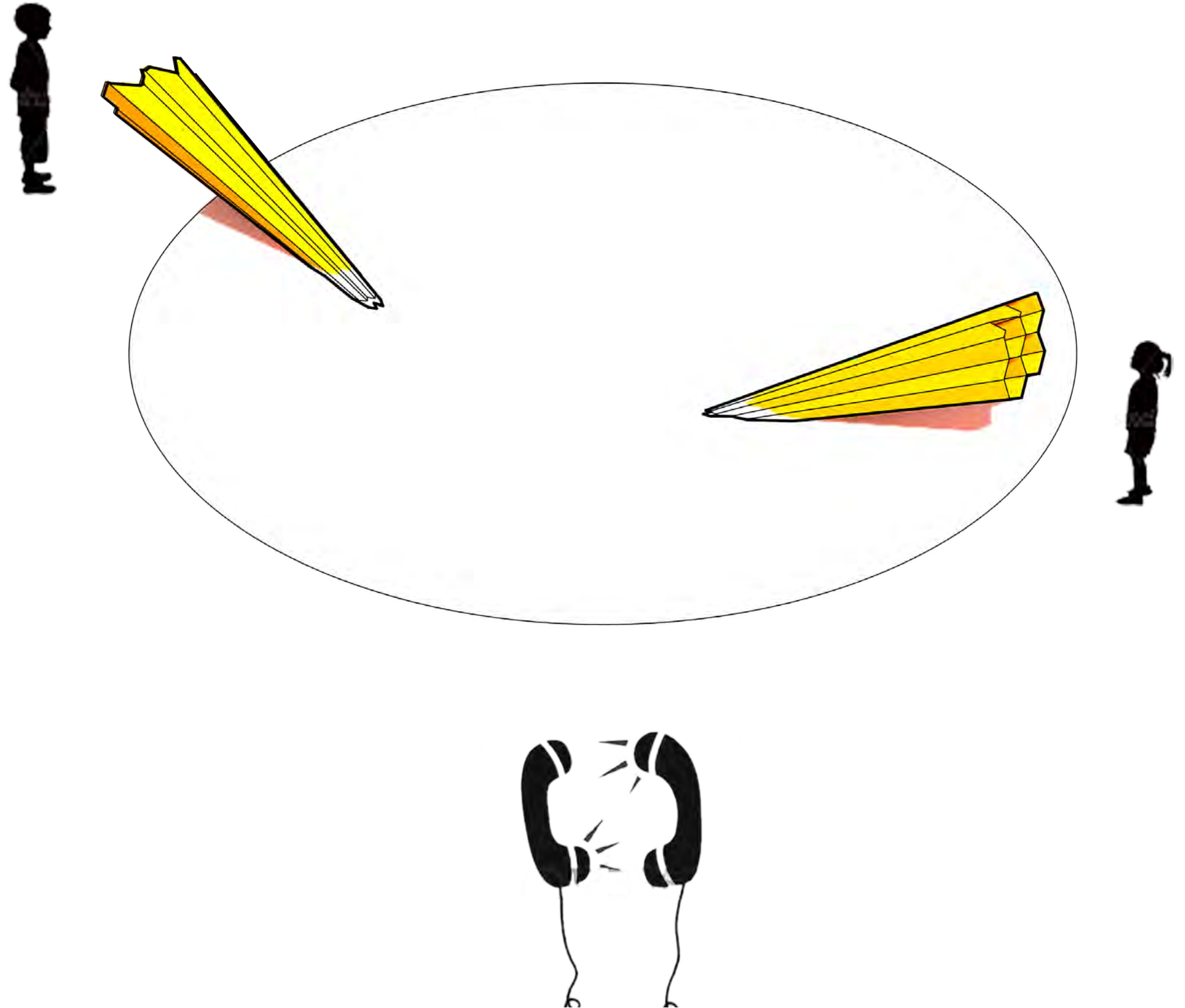



# PLANTS AS PLAY



swa



# PLANTS AS PERFORMANCE



swa





1915

Ince/  
Triangle Studio

1918

Culver Studio

1939

The Wizard of Oz;  
Gone With The Wind

1990

Sony Picture Studio

2003

MPR West moves to Culver City

1917

Culver City is incorporated

1924











# ENHANCE AND PRESERVE

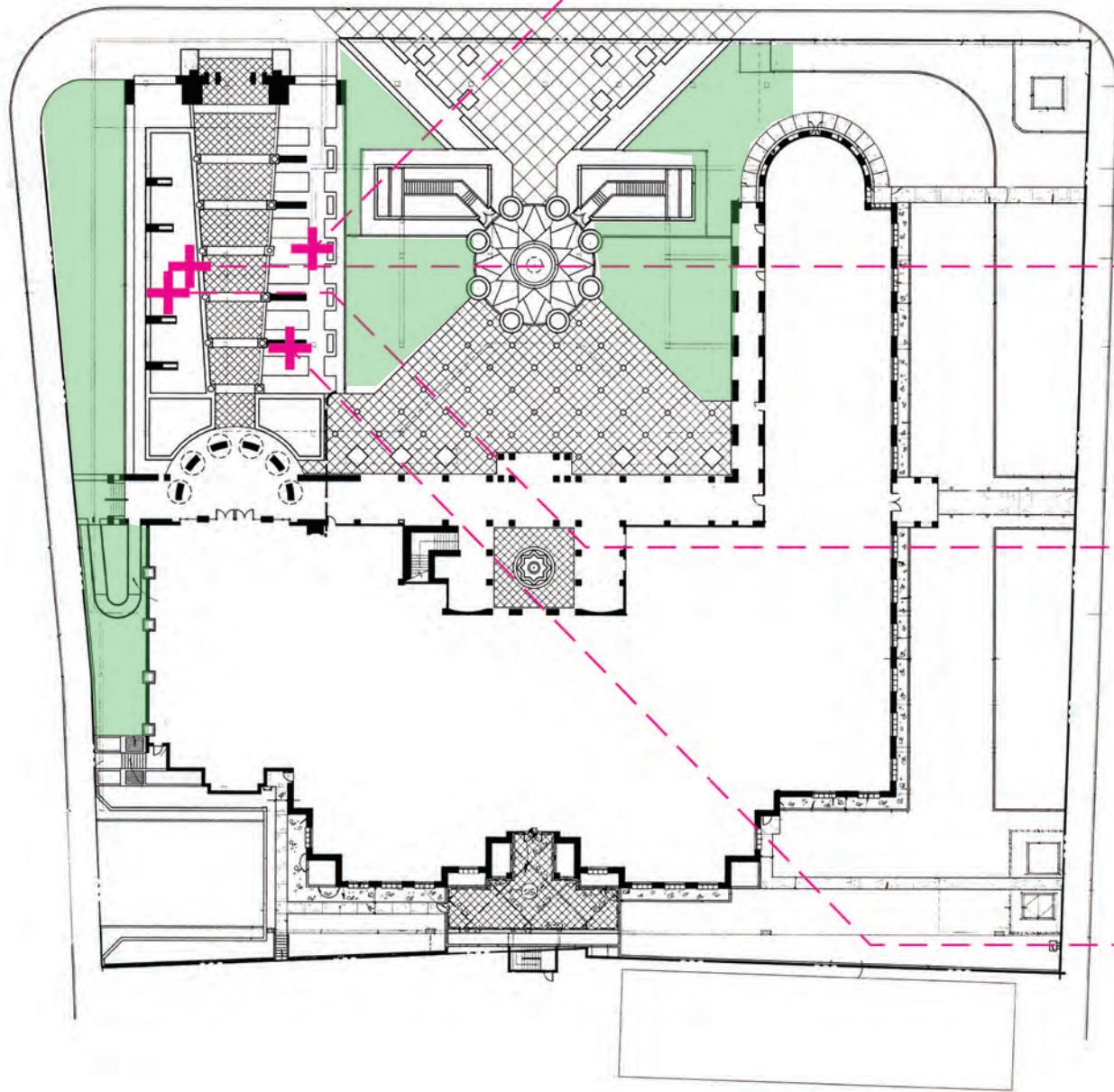



PRESERVE





# PRESERVE

ENHANCE PLANTING

UPDATE FURNISHINGS

UPDATE LIGHTING

REPURPOSE  
WATER FEATURE

MUSIC INSPIRED  
PLANTING





# ENHANCE





# ENHANCE

PLAYFUL PLANTING

FUTURE SCULPTURE  
LOCATION

EXISTING LANDSCAPE

DROUGHT TOLERANT  
PLANTING

DROUGHT TOLERANT  
PLANTING





**AMBITION &  
GREAT DESIGN**





# SAN JACINTO PLAZA

INTEGRATING HISTORY





# PALISADES PARK

**NATIVE FLORA**



# MILTON STREET



ACTIVE RECREATION





# CULVER STUDIOS

HEART OF SCREENLAND



CULVER

TOWN PLAZA



# THANK YOU!

