

Culver City Hall Landscaping Replacement and Centennial Garden Project



Request for Proposal
Phase Two

wHLY



Table of Contents

Executive Summary	4
Questionnaire	30
Attachments	50

why Los Angeles
9520 Jefferson Blvd. Studio C
Culver City, CA 90232

Kulapat Yantrasast, Founder and Creative Director
kulapat@why-site.com

Mark Thomann, Director , why Grounds
(646) 682-9280
(m) 917.208.2263
mark@why-site.com

Executive Summary

We believe that great projects begin by asking “why?”

We seek to reveal the essence and undiscovered meaning of a project. We are fueled by a spirit of collaboration with designers, cultural influencers, and civic leaders. Our belief is that art is connected to nature and nature is connected to people.

All of us at wHY are honored to present this response to Culver City’s Request for Proposals for the City Hall Landscaping and Centennial Garden Project. wHY has been proud to call Culver City home since our founding in 2004, sharing that home with a peerless community of creative thinkers and doers.

Specifically, we look forward to this opportunity to reimagine Culver City Hall’s public space as a vibrant and vital contributor to civic life for another century – the high quality public space one expects for this great City.

We believe that great projects begin by asking “why?”.

We seek to reveal the essence and undiscovered meaning of a project. We are fueled by a spirit of collaboration with designers, cultural influencers, and civic leaders. Our belief is that art is connected to nature and nature is connected to people.

We are excited to approach this project for its challenges and possibilities. Should we be fortunate enough to move on to the next round we will throw our highest levels of creativity and commitment to the effort.

We will assemble a cross section of individuals thought of as leaders and creative influencers, including writers, journalists, actors, artists, and activists who are passionate about Culver City and participating in the conversation for the future of the Culver City Centennial Garden.

They will be joining the team in a collaborative visioning process to provoke and stimulate our thinking and to cultivate imaginative approaches for the design and program of the Culver City Centennial Garden.

wHY believes creative advisers will give a voice to the community during the process, embedding a strong sense of place and meaning to the project.

wHY’s principal and creative director Kulapat Yantrasast and project director Mark Thomann have both overseen the completion of numerous large and complex projects. The experience gained in

balancing the management of both creative development and consultant teams is evident in such projects as the Pomona Studio Art Hall and Bilbao’s Campa de los Ingleses Park.

wHY’s four workshop directors will contribute to the creative development of this project. Workshop leaders are empowered to generate ideas and participate directly in making decisions with clients and stakeholders. This unique approach is instrumental in realizing wHY’s diverse and transformational project.

Our in-house project management protocols, honed through more than a decade of leading complex projects, ensure a clear line of communication regarding logistics, decisions and implementation. Working with our clients and consultants, we develop thorough lists that identify benchmarks, checkpoints and deadlines for each phase.

A crucial element is schedule management is a thorough understanding of the existing conditions. The study of existing conditions is necessary to avoid any unrealistic design development and to conceptualize a design strategy and phasing plan based on real time research and feedback loops.

Demonstrating a commitment to this project, as well as recognizing the critical importance it serves for Culver City, we plan to work closely together with our consultant team to deepen our knowledge of the site.

This opportunity comes at a great time for our firm. We work with our clients and local firms to connect with regional perspectives and customs and to support local economies and talent. Establishing these connections has been a critical component of creating successful projects for our clients. These varied endeavours involved wHY visiting, getting to know people, understanding the inside scoop, orchestrating the planning and design process with consultants, and managing the diverse stakeholders to develop a shared vision.

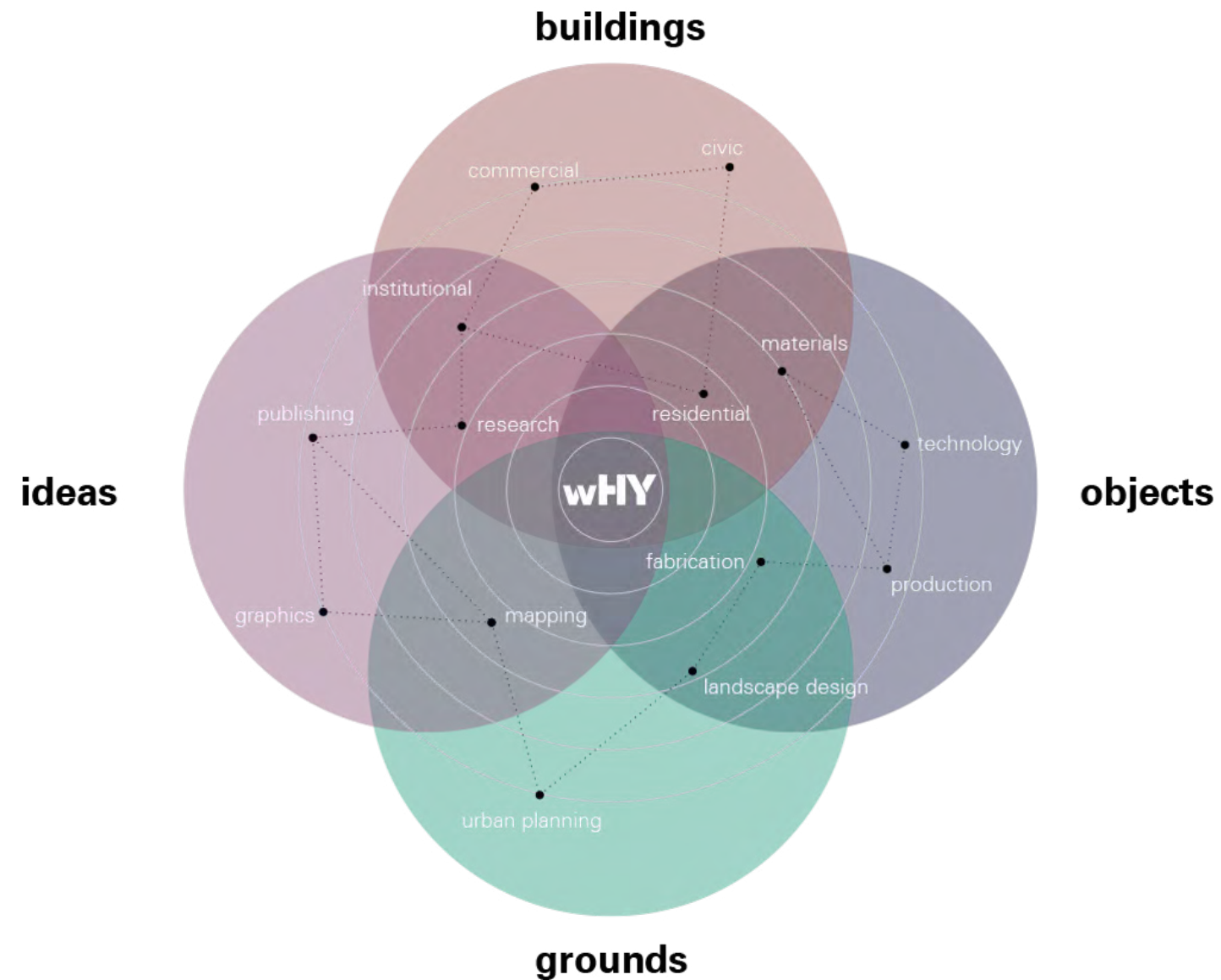

The ecology of disciplines is our solution to address the future of culture, the future of design; collaboration and trans-disciplinary practice.

Internally, our 4 workshop model embraces a variety of disciplines, calling on experts in arts and culture to enhance the whole.

Asking questions first, the Ideas Workshop lays the groundwork for Buildings and Grounds. The Objects Workshop creates small-scale works and installations that compliment the larger mission.



why

CREATIVE DIRECTORS / TEAM LEAD



Kulapat Yantrasast
Architecture
Creative Director



Mark Thomann
Landscape Architecture
Director, Project Lead



Gregory Fischer
Ideas & Design
Director



Kira Appelhans
Landscape
Architecture

In conjunction with Culver City's Centennial Celebration, the City is launching the redesign of the public spaces at the site of City Hall. This represents about 50,000sf of very underutilized, defensively designed landscape that could otherwise be making daily positive contributions to civic life in CC. Culver City is very much a city founded on business opportunity, family, and the arts. We think the new incarnation of the plaza at City Hall should reflect and support that identity.

For projects like this, we like to look outside the direct stakeholders to create a board of 'Creative Influencers.' These boards are typically made up of a diverse group of creative thinkers who are highly regarded in their fields which are - at least in tangential ways - related to the project. This board serves many purposes:

- Enables the team and stakeholders to take a broader view at the opportunities at hand
- Can bring opportunities and connections to the table that wouldn't otherwise have been considered
- Helps reframe the problem

- Leaves stakeholders with a greater feeling of ownership – that the project is of them, and they were heard, even if they were not directly involved
- Creates opportunities to fortify projects by uniting stakeholders with other agencies who have similar causes
- Shares lessons learned – enables shared wisdom so our cultural and civic endeavors can move ahead more efficiently

We have put forward an initial list of individuals, however we typically fine-tune this list at the very inception of the project. These individuals contribute to the project at a high level, and are not public-facing unless mutually agreed by both client and advisor.

There is no typical time commitment – everyone's contribution varies by what they are comfortable with. It runs the gamut from a phone conversation to an intimate hour or so conversation with our team and another advisor, to sitting in on strategy meetings with the client, to helping make other fruitful connections. Typically this is unpaid but in the past we have made donations in the name of folks who have clearly gone over and above.

CONSULTANT TEAM / EXPERTS



Josiah Cain
Sherwood Design
Engineers
Director of Innovation



Jimmy Galvez
Sherwood Design
Engineers
Project Manager



Robert Perry
Horticulturalist,
Professor Emeritus at California
State Polytechnic University

CREATIVE INFLUENCERS



Joy Gorman Wettels,
Producer at Anonymous
Content focused on socially
impactful positive content



Joseph Miller
Principal, Runyon Group;
Founder, The Platform,
Culver City



Alan Schulman
Co-Owner, Akasha and
AR Cucina Restaurants,
Culver City



Josh Kun
MacArthur Fellow and USC
Professor of arts and politics of
cultural connection



Vijay Gupta
Philharmonic Violinist and
founder of the non-profit Street
Symphony



Elsa Longhauser
Executive Director
of the Institute for
Contemporary Art, LA



Gary Mandell
Producer
Culver City's Boulevard Music
Summer Festival



Sabra Williams
Director of Outreach, The Actors'
Gang and creator of The Actors'
Gang Prison Project

BALANCING BETWEEN CULTURE AND NATURE

An interdisciplinary team led by wHY has been selected to design an integrated landmark Pavilion, a visitor centre with café, outdoor performance spaces and improvements to the surrounding West Princes Street Gardens. Selected through an international competition, the \$33 million Ross Pavilion & Gardens project marks wHY's first major park design and first project in Europe. It is expected to commence construction in 2018.

West Princes Street Gardens form the boundary of the remarkable juxtaposition between the old and new towns. Strategically tucked into the landscape, the Ross Pavilion and Gardens is a transformative introduction that rejuvenates and revitalizes the heritage landscape with new elements of design. wHY's landscape masterplan respectfully transforms the use of the gardens into something that connects people, the city and nature. Along the length of West Princes Street, a new network of accessible paths flow down the south slope through a landscape of native Scottish plantings.

The new Visitor Centre, embedded into this steep embankment and programmatically broken into multiple layers, is integrated into the ramp network. At West Princes Street, the sidewalk pushes into the park, creating a new viewing platform that maximizes views across the grounds to the Castle. A series of ramps flow down the embankment while defining the roof contours of the Visitor Centre.

The Butterfly Pavilion designed for indoor and outdoor performances is integrated with the landscape via a green roof and organic lines, blending the structure within the whole park. The Pavilion is both a beautiful structure and a bridge that encourages flow across the rail cut from the north. An oculus in the roof both brings natural light into stage enhancing the performers experience while movable walls and a flexible stage can accommodate events that range in scale from intimate to grand. It is an elegant and simple representation of a complex and flexible architecture program.

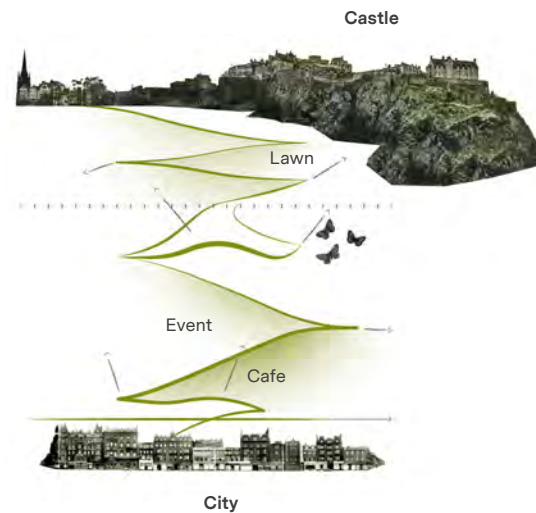

POSITIVE CONTRIBUTION TO SETTING, PLACE-MAKING AND CONTEXT

wHY's finalist entry for Pershing Square in Los Angeles was based on a reading of the lost topography of the city and its underground parking structure in the city of cars. The understanding of both the historic and modern context of the plaza, shaped a new ground of rolling urban hills that housed new spaces for program and activities in the city.

wHY's Design Director, Mark Thomann, similarly explored the relationship between the movement of people, river and the cultural forms of the Guggenheim Bilbao for the Campa de los Ingleses Park in Bilbao. The park has spaces for events and kiosks, activating the city, making it accessible and providing a green lung.



Mark Thomann,
Director with ©Balmori Associates

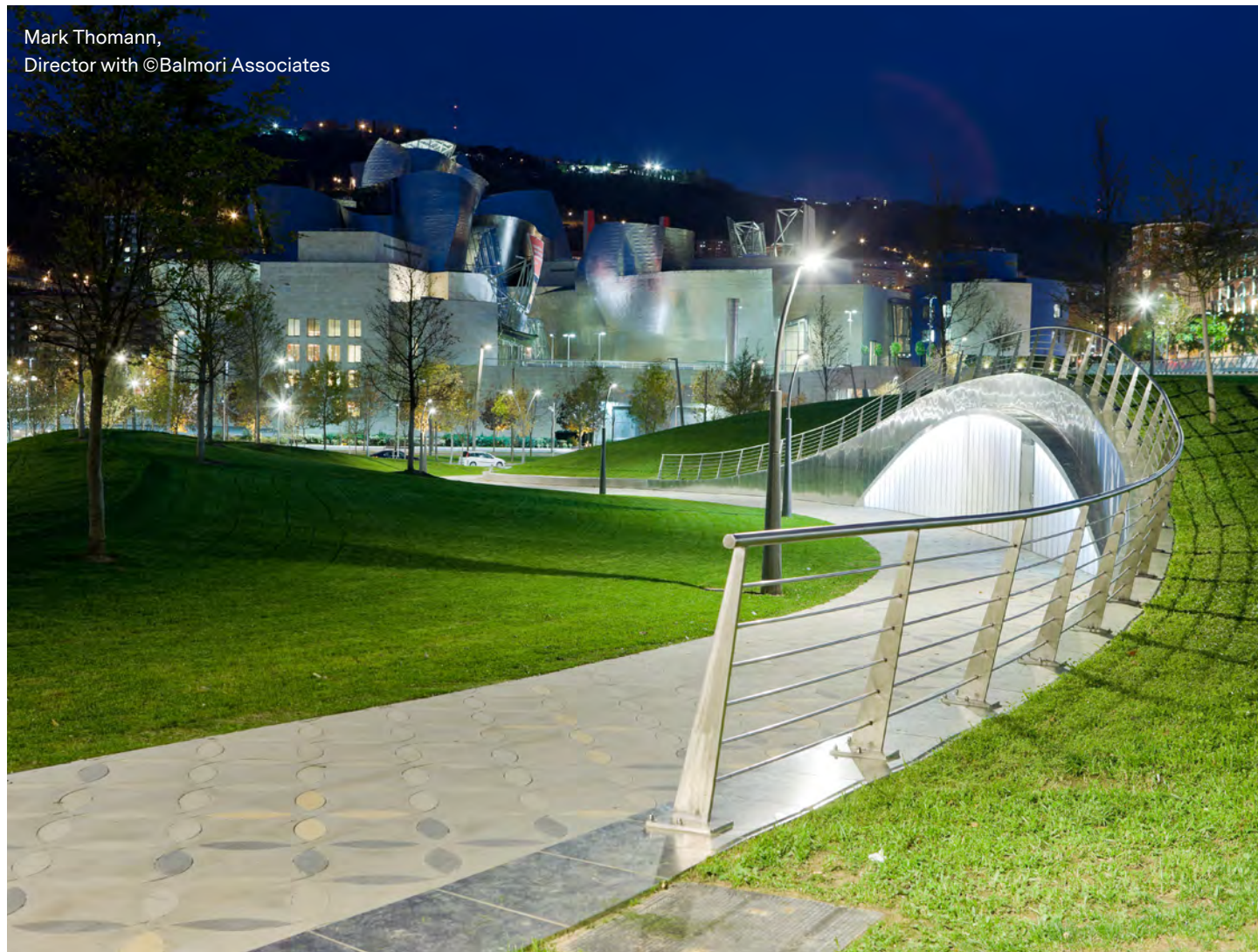

POSITIVE CONTRIBUTION TO SETTING, PLACE-MAKING AND CONTEXT

Jackson Park is the southern anchor to Chicago's 7-mile green necklace along Lake Michigan and site of the 1893 World's Fair, designed by the renowned landscape architects Daniel Burnham and Frederick Law Olmsted. Following decades of neglect, demolition and fires, wHY is leading an initiative to re-design and activate the 500+ acre urban park, incorporating many of the original master plan ideas.

The master plan is the first phase in unlocking the potential of the park and creating an exciting place where people can experience art, culture and science within a naturally beautiful setting. Design constraints are manifold, requiring a sensitivity to the ecological challenges and history of the park while re-activating it with programs and elements that will attract a diverse group of visitors. Among the catalysts are a new Wishing Garden designed in collaboration with the Japanese artist and peace activist Yoko Ono, as well the construction of a new multi-functional pavilion for performances, events and exhibitions.

Due to the rich history of the park and diversity of the neighborhood, the project has required substantial involvement and engagement with the public to gain support for its future development.



UNDERSTANDING SPATIAL NEEDS OF CONTEMPORARY USERS & IMPACT ON DESIGN & FUNCTION

The village-like open, porous nature of the architecture of wHY's Pomona Studio Art Hall encourages collaboration among art majors as well as non-art majors with program elements arranged around a central courtyard that itself is part of a prominent diagonal path through campus. Accomplished through semi-public, collaborative 'Grey Spaces,' the building maximizes the intersection between students, faculty and staff as they move through the studios and public areas.

A strategic, non-hierarchical stacking of studio spaces (mediums) fuels an openness and unrestricted approach to art. The expansive use of glass provides students with transparency to the whole — insights into the creative processes of their peers and faculty members in multiple disciplines

"The Studio Art Hall reflects a different ethos and different way of thinking about art. The building is beautiful and imaginative and really meets the needs of our community."

- Michael O'Malley, associate professor of art



EXPERIENCE CREATING SPACES FOR ART

The Marciano Art Foundation project integrates contemporary design into a historic building and urban context. For the grounds and parking in the rear, a contemporary reinterpretation of the historic landscape — a process closely involving the planning commission and other agencies of the City of Los Angeles — gives it a dynamic street presence and urban life.

Once inside, visitors feel transported back in time as a result of the meticulously restored historic architecture — its original features, motifs and details. At the same time, a fresh and vibrant ambiance is created through the introduction of new walls, ceilings and lighting systems, designed to make perfect spaces for contemporary art. A variety of exhibition spaces, from the very large featuring exposed structure to the more intimate, provide the Foundation with a flexible environment for exhibitions of a single artist's work, numerous exhibitions at one time, or special events. wHY's strategic design synthesizes the variety of spaces throughout with the final addition of a wHY-designed café/lounge and bookshelves.

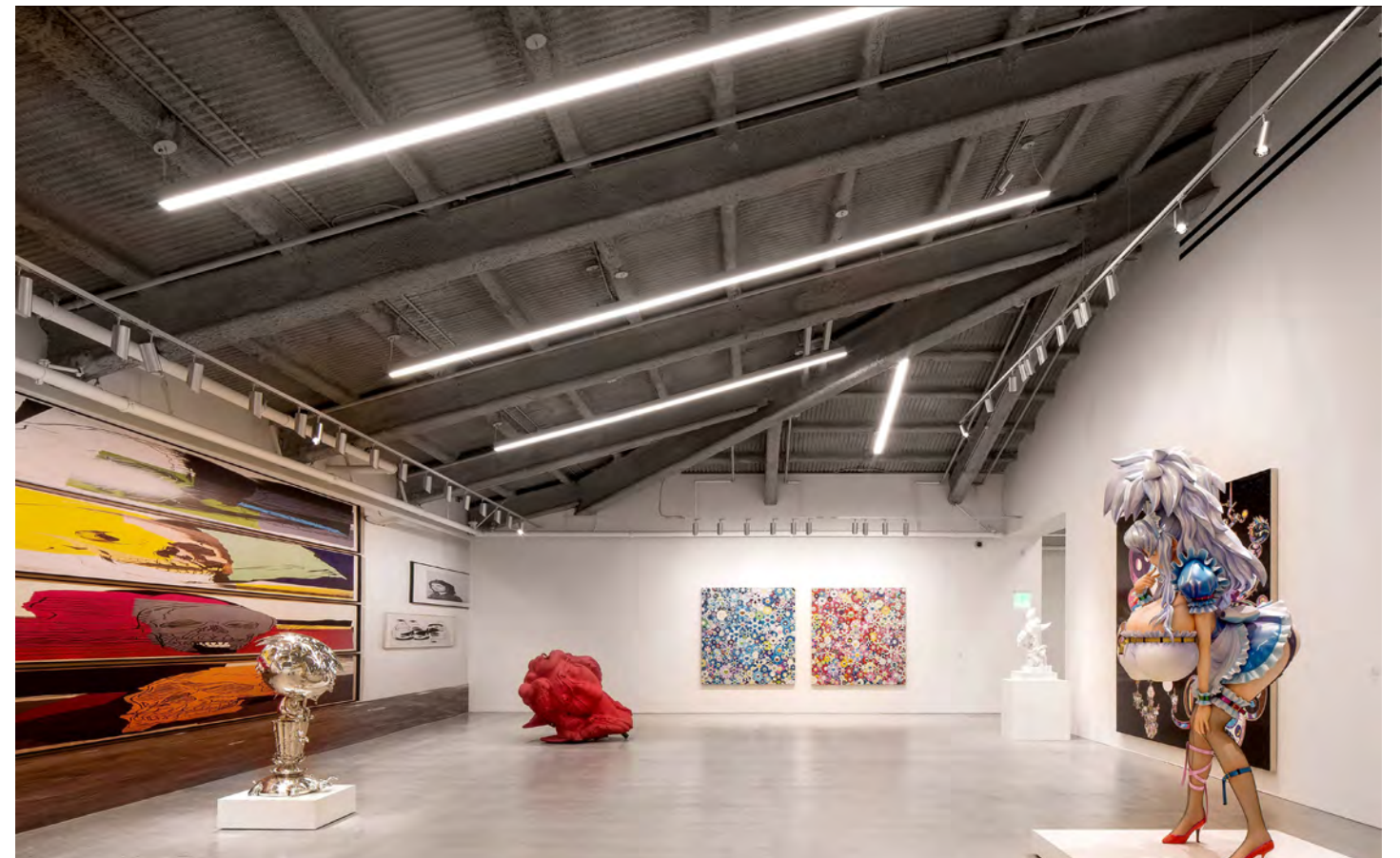

EXPERIENCE WORKING WITH ARTISTS

wHY served as the architect of record for SKY LANDING, Yoko Ono's first permanent public art work in the Americas. It is a marker of her place as an artist of profound international influence and of her lifelong mission for world peace.

The idea for a site-specific piece emerged from Yoko Ono's initial visit to the site during the cherry blossom tree installation in 2013. "I recall being immediately connected to the powerful site and feeling the tension between the sky and the ground," explains Yoko Ono. She already had a very special connection to the city of Chicago. When she first visited in the 1970's, she stayed at a hotel overlooking Lake Michigan and later went back home to New York where she began to compose her hit song 'Walking on Thin Ice.'

SKYLANDING brings her personal sense of hopefulness to the public realm and the intention is that visitors will feel a communal connection to Earth and Sky when experiencing the work. "I wanted the Sky to land here, to cool it, and make it well again," remarked Ono when asked about the inspiration for her piece named, SKYLANDING.

SKYLANDING is a spatial experience that emerges from the past based upon universal order. The lotus composition is strong, elegant, approachable - part of a natural order and beautiful. Extraneous detail is eliminated. It is honest and true to itself. Layers of visual dynamism show space expanding and an alignment of visualize form, space, and light.



CREATIVE LANDSCAPE DESIGN SOLUTIONS

Mark Thomann's work in Bilbao as the Director of Balmori Associates, was a multi year and multi project effort to regenerate the former port and railyards along the Nervion River and the Guggenheim Bilbao Museum. The new urban district is a sustainable model of urban landscape design that connects, inspires and brings the city alive.

The series of parks and gardens, builds upon the energy of the community from old town to the university and provides a ground from which new residences, shops and offices emerge. The projects bring color, activate the senses and incorporate river flooding. The paving even cleans the air- through special design and add-mixtures.

Mark Thomann,
Director with ©Balmori Associates (all images)

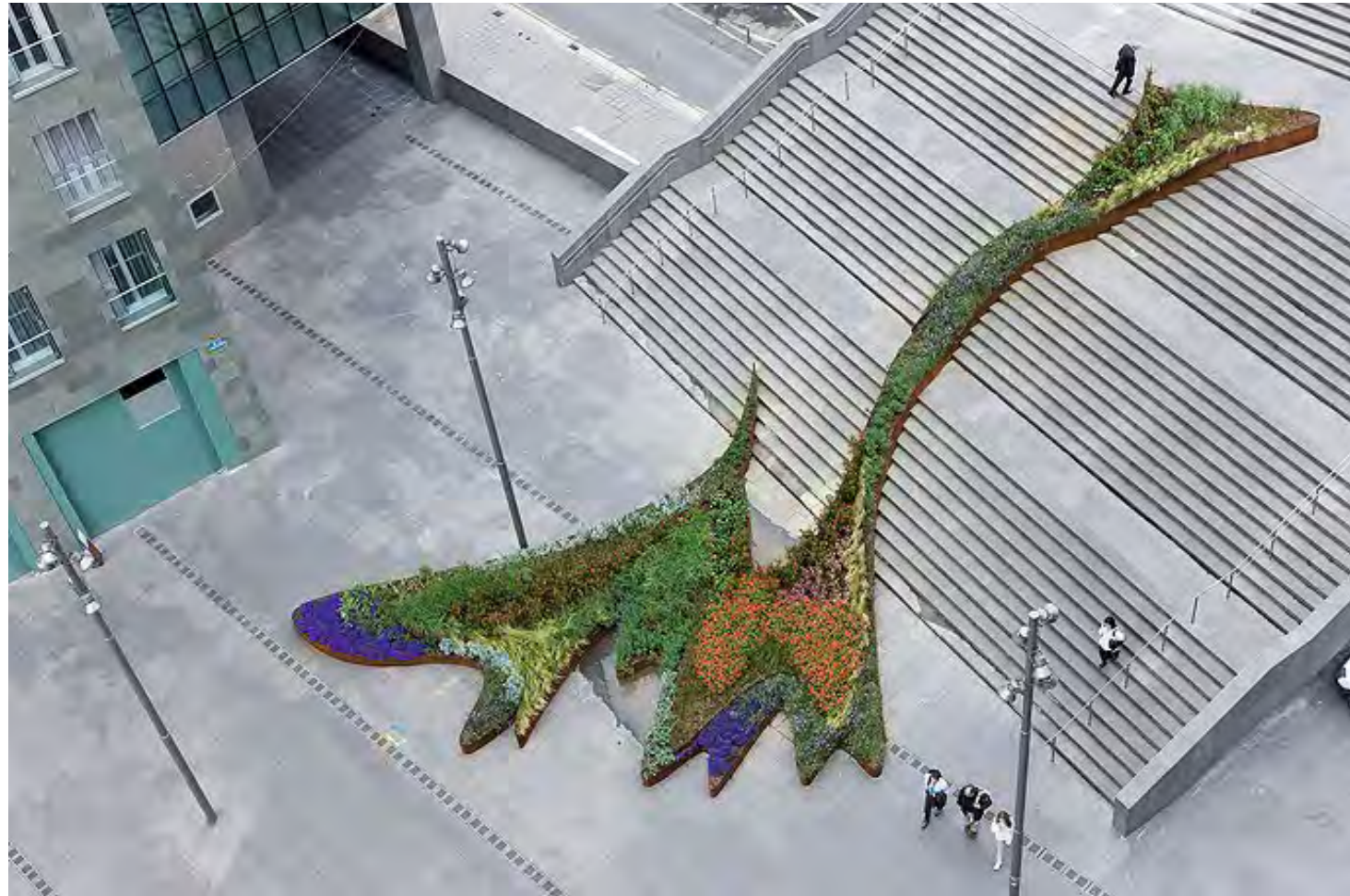

SUSTAINABILITY IN DESIGN, CONSTRUCTION AND USE

Sustainability is measured through efficiency of design and ecological innovation.

The Speed Museum came in under budget due to quality control and management protocols at wHY. We worked closely with engineers and construction managers to identify complexities surrounding materials and construction techniques. We are capable of BIM modeling to maintain the complete integration of all consultants throughout the building process.

The Speed Museum used innovative frit systems to allow for an open and transparent building skin. The Grand Rapids Art Museum, the first LEED Gold Museum in the world, was a combination of visionary design with close collaboration between architect and engineering teams.



BALANCING BUDGET, QUALITY AND PROGRAM THROUGH DESIGN PROCESS



No matter the scale of the project, the interdisciplinary structure of wHY and the process of close collaboration and engagement with consultants and stakeholders allows wHY to be strategic and test ideas efficiently.

Another underlying principle of wHY's process is that of urban acupuncture and acupuncture architecture. We approach each project and ask why? This process helps identify specific solutions and strategies. This acupuncture strategy is very effective and resourceful for the design team and the client and through the process of asking why - we reveal exciting new possibilities.

These strategic points of intervention are checked against cost models and design reviews that are creative engineering as opposed to value engineering.

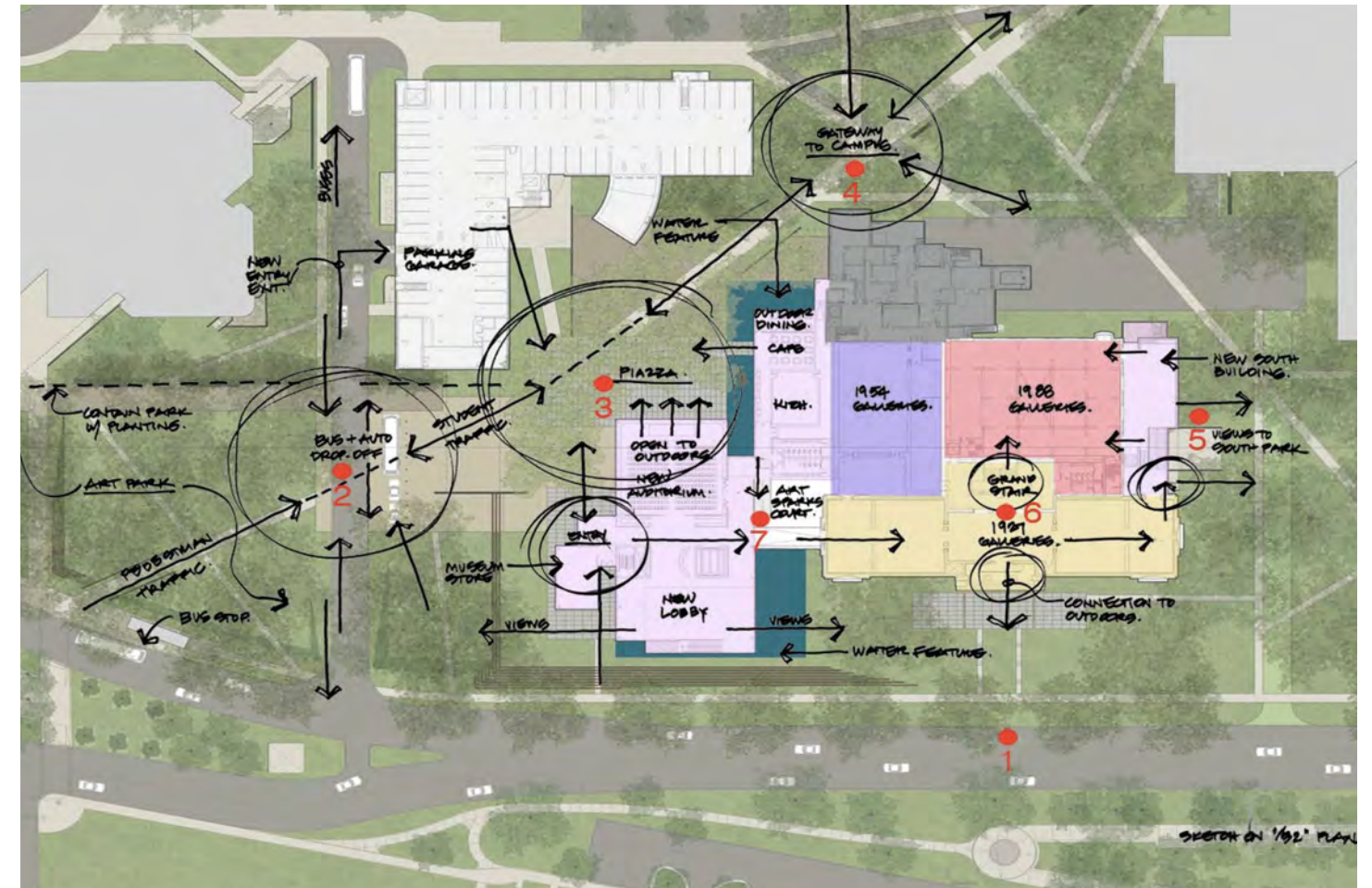

HUDSON YARDS

LOCATION

New York, NY

CLIENT

Related Partners

DESIGN PARTNERS

KPF Associates

Nelson Byrd Woltz

Landscape Architects

SIZE

7 Acres

STATUS

Construction Phase

PROJECT TYPE

21st Century Park



A rendering of the proposed Hudson Yards development.

New York Penn Station, the Hudson River, Amtrak and the High Line are a few of the landmarks next to and below the Hudson Yards East development on the west side of New York City, Sherwood's latest project involvement on the East Coast. Early site preparation work has just started on one of the largest private development underway in Manhattan, including numerous skyscrapers and over 7-acres of new public open space. The open space element is our focus, supporting the landscape architecture team to provide a stormwater management and water reuse plan that enhances the landscape vision for the space. At the same time we are carefully navigating the various constraints associated with building over an existing 60 plus track rail yard and ensuring that the stormwater system above does not impact the operations of the trains or the rail workers during and after construction.



LOCATION

San Jose, California

CLIENT

Lowe Enterprises

DESIGN PARTNERS

Gensler, SWA Group

SIZE

43 Acres

STATUS

Design Phase

PROJECT TYPE

Green Building

Institution & Commercial

NORTH FIRST STREET

Sherwood worked with Gensler on the eco-district campus design of this LEED-ND multi-building development in urban San Jose. The campus has been master-planned with sustainability integrated into the project design. The site incorporates landscape forms that function as gathering spaces, stormwater treatment zones and reestablished local ecosystems. Through the balance of five principal elements: Water, Energy, Ecology, Material and Community, Sherwood and the design team have maximized the opportunity for resource stewardship and community connectivity. Central to the site development is the integration and restoration of ecological systems. The project serves to be a model for cutting-edge corporate campus development worldwide.

A rendering of North First Street Plaza design.



ALTA LAGUNA

LOCATION

San Francisco, California

CLIENT

Wood Partners

DESIGN PARTNERS

BAR Architects
 Meyer + Silberberg Landscape
 Architects

SIZE

4.35 Acres

STATUS

Phase I Completed 2016

PROJECT TYPE

Sustainable Residential Design



Partially completed construction of Alta Laguna.

Sherwood worked closely with Wood Partners, BAR Architects and Meyer+Silberberg Landscape Architects on this 330-unit, multi-block LEED-ND project in the heart of San Francisco's burgeoning Hayes Valley. In addition to leading the civil design of the project, Sherwood took a deeply collaborative approach to the integration of stormwater management systems within this complex urban site. The development of a stormwater compliance strategy from project start informed site layout and design. Sherwood also designed streetscape improvements along entire frontage of development, including managing and tracking permitting process, and compliance with SFPUC Stormwater Guidelines.



LOCATION

Berkeley, California

CLIENT

University of California, Berkeley

DESIGN PARTNERS

Moore Ruble Yudell
 Architects & Planners

SIZE

1.2 Acres

STATUS

Completed 2015

PROJECT TYPE

Sustainable Institutional
 Infrastructure

UC BERKELEY LOWER SPROUL REDEVELOPEMENT PROJECT



Illustrative of the proposed site. Left: Completion of the NW stair to Lower Sproul Plaza & ruingarden.

For one of the largest redevelopment projects on the campus, Sherwood joined as Civil Engineer with a high-powered design team to re-envision the main entrance and social corridor to UC Berkeley. In addition to the redesign of Lower Sproul Plaza, the project includes complete redesign and replacement of the existing Eshleman Hall, renovation of Martin Luther King Student Union Center, and Chavez Student Center. To build upon the progress made during the masterplanning phase, Sherwood developed grading plans, utility infrastructure, rainwater harvesting, water reuse and stormwater treatment and infiltration strategies. These innovative civil engineering documents strive to exceed the sustainability, programming, and social goals established during multiple visioning meetings between the design team and the University.

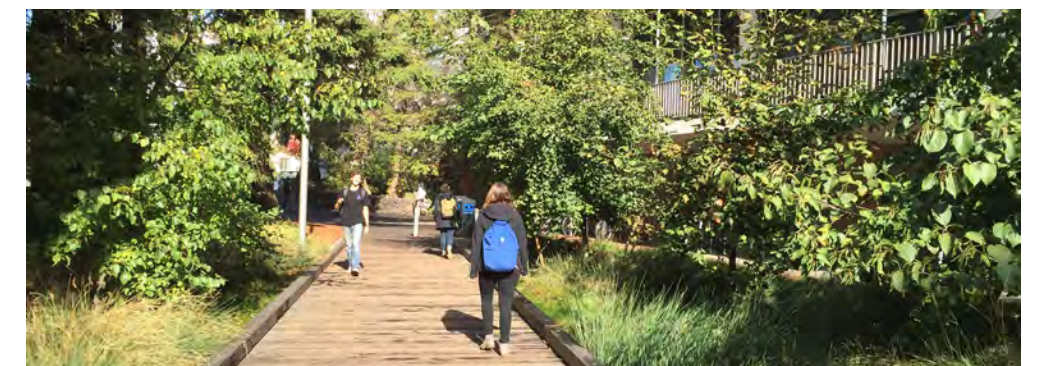
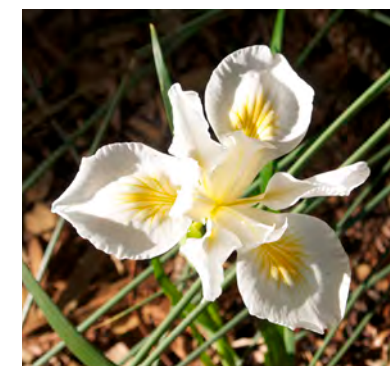

Questionnaire / Response to Scope of Services

A. Company and General Information

1. Firm Name and Address

wHY Los Angeles
9520 Jefferson Boulevard
Culver City, California 90232
o: 310.839.5106

Sherwood Design Engineers
58 Maiden Lane
San Francisco, CA 94108
415-677-7300

2. Letter of transmittal signed by an individual authorized to bind the firm, stating that the firm has read and will comply with all terms and conditions of this RFP

Please see attachment

3. General information about the primary contact who is able to answer questions about the proposal. Include name, title, telephone number and email address of the individual.

Mark Thomann
wHY, Grounds Workshop Director
473 West Broadway, Unit 3
New York, NY 10012
(646) 682-9280
(m) 917.208.2263
mark@why-site.com

Josiah Cain,
Director of Innovation
58 Maiden Lane, FL 3, San Francisco, CA 94108
jcain@sherwoodengineers.com
415-685-4423

B. Qualifications and Experience of the Firm

1.Describe your firm’s history and organizational structure. Include the size of the firm, location of offices, years in business, organizational chart, name(s) of owner(s) and principal parties, and number and position titles of staff.

Founded in 2004, wHY is a team of 30 creative designers with offices in LA & NYC, with a focus on cultural, museum and gallery architecture, exhibition design and landscape design. In 2014, wHY

reorganized to better reflect the approach and offerings of the practice, as well as the interdisciplinary nature of design in the 21st century. An Ecology of Disciplines, wHY’s four workshops are engaged in every project at different levels, depending upon the scope and requirements. We have expertise in feasibility studies to transform historic sites and buildings for cultural use for clients looking for innovative and cost-effective design. We work closely with artists, and are currently collaborating on projects with Yoko Ono and Doug Aitken.

In less than ten years, with many international collaborations, we have built the world’s first new LEED Gold art museum; expanded with the international art market by designing outposts for prominent galleries; explored the intersection of climate, landscape and architecture via an arts education facility for one of the nation’s top colleges; and re-presented important art collections for America’s top institutions.

Our goal is to connect people and programs with their environment, while making the greatest impact with the least physical presence.

wHY’s Grounds, our landscape studio, collaborates with landscape architects, urban planners, and artists worldwide to develop and program open space. Through the seamless integration of building, landscape and urban environments, the workshop enables art and function, nature and structure to coexist.

Our business practice itself reflects these design priorities. We believe that strong partnerships and client collaborations create design solutions that are simultaneously beautiful and highly functional. Our analytical and graphical approach to design development and our experience working on buildings on three continents enables us to smoothly integrate complex teams and to communicate vividly with our clients and partners – a performative approach to design collaboration.

Founded in 2002, Sherwood Design Engineers is a site civil engineering practice committed to the optimal integration of ecology, infrastructure, and design. Sherwood has over sixty employees with four offices nationwide, San Francisco, New York, Atlanta, and Houston. We specialize in water management strategies, green building design, and urban planning. We document site infrastructure as well as master plan engineering solutions at a campus, neighborhood, and district scale. Important to our engineering practice is our ability to span building and landscape. Our recommendations minimize the consumption of all site resources— carbon, energy, water, and waste. Sherwood works





collaboratively with project teams to find ways to maximize efficiencies through an integrated and ecological approach that results in high performance buildings and landscapes recognized for function as well as aesthetics and user experience.

List of partner of the firm:
• S. Bry Sarté, P.E., LEED AP, Founding Partner
• John Leys, P.E., LEED AP, Partner

2. What is the primary business of the parent company and /or affiliates?

The primary business of wHY is Architectural Design
Sherwood Design Engineer is the parent company, and the primary business is site civil engineering.

3. Which office(s) of your organization will have primary responsibility for managing this account? List the members of your team who will be responsible for providing the services and for ongoing support.

The **wHY Los Angeles** office will have primary responsibility for managing the account.

List of team members responsible:

Kulapat Yantrasast, Creative Director
Mark Thomann, Director, wHY Grounds
Gregory Fischer, Ideas & Design Director
Kira Appelhans, Landscape Architect

The **Sherwood San Francisco** office will have primary responsibility for managing the account. Josiah Cain and Jimmy Galvez will be responsible for providing the services and for ongoing support.

List of staff members responsible:

• Josiah Cain, Principal
• Jimmy Galvez, P.E., Project Manager

4. What is your firm’s experience conducting the services requested? Describe comparable projects performed by your firm in the last five years, including the number of projects, scope of service, and their status.

The Ross Pavilion International Design Competition, Edinburgh (Scotland)
Winner

An interdisciplinary team led by wHY has been selected to design an integrated landmark Pavilion, a visitor centre with café, outdoor performance spaces and improvements to the surrounding West Princes Street Gardens. Selected through an international competition, the \$33 million Ross Pavilion & Gardens project marks wHY’s first major park design and first project in Europe. It is expected to commence construction in 2018.

Pershing Square Design Competition in Los Angeles
International Competition Finalist, 2015-2016
Master Planner and Urban/Landscape Designer

In 2015, wHY was one of four international firms shortlisted to redesign Pershing Square, a historic central park (5 acres) located in downtown Los Angeles. Following the announcement, wHY assembled a multidisciplinary advisory board and teamed with the landscape architecture firm Civitas.

Jackson Park, Chicago
Master Plan, Design Architect, Landscape Architecture, Engagement, Fundraising

Jackson Park is the southern anchor to Chicago’s 7-mile green necklace along Lake Michigan and site of the 1893 World’s Fair, designed by the renowned landscape architects Daniel Burnham and Frederick Law Olmsted. wHY is leading an initiative to re-design and activate the 500+ acre urban park, incorporating many of the original master plan ideas.

Pomona College Studio Art Hall, Pomona
Design & Executive Architect, Landscape Architecture. Engagement, Fundraising Interior Architecture, Furnishings, Fixtures

The Studio Art Hall, a LEED Gold building, brings art making, art appreciation, and art interaction together as a series of pavilions under one roof to re-imagine the program and site as a vital center of daily campus activities. Exposure to the studio arts is a critical part of the College’s mission, and the Studio Art Hall creates an environment where an appreciation for the creative art process can be born and enhanced.

Speed Art Museum
Master Plan, Design Architect, Landscape Architecture, Engagement
wHY’s design for the new Speed Art Museum encompasses a thorough re-design of the original 1927 neoclassical building plus two additions and a sculpture park. It is Kentucky’s oldest and largest art museum, and the region’s leading cultural repository.

Sherwood has five comparable projects performed by our firm in the last five years. Some of the projects include the following:

Alta Laguna Project

Sherwood worked closely with Wood Partners, BAR Architects and Meyer+Silberberg Landscape Architects on this 330-unit, multi-block LEED-ND project in the heart of San Francisco's burgeoning Hayes Valley. The development of a stormwater compliance strategy from project start informed site layout and design. Sherwood also designed streetscape improvements along entire frontage of development,

50 Park Place

A renovation of the property located at 50 Park Place to serve as the new home of the Brisbane City Hall was already under way when this project won a Demonstration Project Grant from the SMCWPPP. Sherwood Design Engineers collaborated with landscape architects Nevue Ngan & Associates to retrofit the main parking lot with a rain garden to treat runoff from that parking lot and back half of the building rooftop. This project was completed in 2012.

Hudson Yards

Early site preparation for the Hudson Yards work has just started on one of the largest private development underway in Manhattan, including numerous skyscrapers and over 7-acres of new public open space. The open space element is our focus, supporting the landscape architecture team to provide a stormwater management and water reuse plan that enhances the landscape vision for the space. This project is currently in the construction phase.

Sherwood worked with Gensler on the North First Street eco-district campus design of this LEED-ND multi-building development in urban San Jose. The campus has been master-planned with sustainability integrated into the project design. The site incorporates landscape forms that function as gathering spaces, stormwater treatment zones and reestablished local ecosystems. The project serves to be a model for cutting-edge corporate campus development worldwide. This project is currently in the design phase.

UC Berkeley Lower Sproul Redevelopment

Sherwood joined the UC Berkeley Lower Sproul Redevelopment Project as Civil Engineer with a high-powered design team to re-envision the main entrance and social corridor to UC Berkeley. Sherwood developed grading plans, utility infrastructure, rainwater harvesting, water reuse and storm water treatment and infiltration strategies. These innovative civil engineering documents strive to exceed the sustainability, programming, and social goals established during multiple visioning meetings between the design team and the University. This project was completed in 2015.

5. Comment on other areas that may make your firm different from your competitors.

why is diverse, inclusive, and inquisitive in our DNA: we are structured as an Ecology of Disciplines, with architecture, landscape,

product design, and design strategy in one collaborative workshop. This Ecology of Disciplines opens up a plethora of possibilities rooted in interdisciplinary and environmental design. Through our IDEAS Workshop, we identify and reframe issues to capture new opportunities to advance our clients' objectives. We use design to help our clients discover and transform the intangible (ideas, stories, identity, history, aspiration) into actionable plans and actual places.

why starts by listening to the stories; stories of the place, stories of the city and stories of the characters. Through series of conversations and design tests, the stories are subtly incorporated into the presentation of the project, weaving into one consistent and engaging experience.

The design process is a truly collaborative process utilizing the team's expertise on the ideas, experience, and narratives and why's expertise with the variety of tools we use to conceptualize, ideate, and visualize the possibilities.

Sherwood Design Engineers is a full service civil engineering firm providing analysis, planning, design, entitlements, and construction documents. Our six services set us apart from other civil engineering firms. Services include:

- Green site civil engineering
- Sustainable infrastructure planning and engineering
- Water resource planning and engineering
- Ecological systems planning and engineering
- Land analysis and planning

Sherwood has pioneered the intersection of infrastructure with ecological and urban design on hundreds of leading international engineering projects in more than 20 countries.

Our work is often the first-of-its kind applying green infrastructure systems, strategies and concepts to a spectrum of planning, engineering and construction projects.

Sherwood specializes in water management strategies, green building design, and urban planning.





C. Qualifications and Experience of Proposed Project Team

1. Describe the qualifications of the firm's staff who are assigned to complete each of the scope of services, their position(s) in the firm, and types and amount of equivalent experience. Be sure to include any municipal agencies they have worked with in the past five years and their level of involvement. A description of how overall supervision will be provided should be included.

Kulapat Yantrasast is the founder and creative director of wHY. He was born in Bangkok, Thailand, where he graduated with honors from Chulalongkorn University (1990), Kulapat received both his M.Arch. and Ph.D. degrees in Architecture from the University of Tokyo (1993/1996), under a Japanese Government scholarship. Upon graduating, Kulapat worked as Tadao Ando's close associate for more than seven years in Japan, leading several award-winning projects including the Pulitzer Foundation for the Arts in St. Louis, Missouri, Fondation Francois Pinault pour l'Art Contemporain in Paris, and Tom Ford's 'House in the Desert' in Santa Fe, New Mexico.

Regarded as a new generation architect, Kulapat's interdisciplinary approach to architecture and design is largely shaped and inspired by his passion for food and society, viewing each project as a mix of ingredients that yields its own unique recipe. To this end, wHY is structured as four workshops – Ideas, Buildings, Objects, Grounds – with one cohesive team capable of taking on all aspects of a project, from the planning and landscape design to architecture and furniture.

His approach and philosophy provides a purity of structure and clarity of thought with an openness and desire for creating dynamic environments, earning him numerous honors and awards over the years. In 2012, he was named one of the art world's 100 Most Powerful People and in 2009, Kulapat was the first architect to receive the Silpathorn Award for Design from Thailand's Ministry of Culture.

In 2014, he was the subject of numerous profiles in leading international publications – Artforum, W, PIN-UP, Cultured – on the occasion of completing three major projects – Pomona College Studio Art Hall, Harvard Art Museums (with Renzo Piano Building Workshop), and Kordansky Gallery. Additionally, wHY's projects have recently received coverage in WSJ Magazine, The Los Angeles Times, NPR, Christie's Art News and The Boston Globe.

He is a frequent public speaker at leading institutions and organizations and has served on the Artists' Committee of the Americans for the Arts, the United States' oldest organization for support of the arts in the society, since 2005. In 2015, he was

appointed a board member of the Pulitzer Foundation for the Arts, and he is an active member of the Design Council for Collective Design.

Specific municipal agency experience includes:

City of Chicago
New York City
Los Angeles City
City of San Francisco
City of Santa Monica
City of Grand Rapids
City of Louisville, KY
City of Worcester
City of East Palo Alto
State of California
Army Corp of Engineers
City of Pasadena
State of New York
City of Dallas
Chicago Park District

Mark Thomann is the director of wHY grounds, a landscape design studio. Prior to joining wHY, Mark was a partner and landscape design director with Balmori Associates and landscape director with Work Architecture Company, leading numerous international award winning projects and strategic plans, including the Campa de los Ingleses Park at the Guggenheim Museum in Bilbao, Spain, the Master plan and vision for Public Administration Town, a new administrative city of Sejong, Korea, the Gabon Conference Center and gardens in Gabon, Africa with Work Architecture Company, as well as the winning Rebuild By Design competition project "Resist, Delay, Store, Discharge" with OMA for a comprehensive strategy for a resilient and sustainable Hoboken, NJ. His works also reveals the collaborative potential of landscape, ecology and art in Skid Rows; Queens Museum Artist Gardens, 2005 with Brian Tolle and the construction and interpretation of Robert Smithson's Floating Island; 2005 for Minetta Brook and the Whitney Museum.

Specific municipal agency experience includes:

City of Chicago
New York City
City of Los Angeles
City of Louisville, KY
City of Worcester

State of California
Army Corp of Engineers
Chicago Park District
GSA
NCPC
Washington, D
NYC DDC
NYC DEC
NYC DPR
NYC EDC
City of Hoboken
NJ DEP
Miami DOT
City of Memphis
City of New Haven

Gregory Fischer leads the WHY IDEAS Workshop and the Los Angeles office, guiding teams through the design process by uncovering and framing opportunities, and - together with Kulapat – aligning the four design workshops with the project vision.

Since joining WHY in 2012, Gregory works closely with Kulapat and workshop leaders to shape and deliver design dialogues for all aspects of WHY’s work. His breadth of knowledge coupled with his ability to think at different scales of abstraction enables Gregory to discern a project’s driving factors and synthesize the design team’s responses into successful solutions for clients. He is typically involved from the early project planning stages onward, ensuring quality and commitment to design throughout the entire process.

Specific municipal agency experience includes:

LA City Bureau of Engineering
California Administrative Office of the Courts
General Services Administration
Department of Water and Power

Josiah Cain serves as Sherwood Design Engineers’ Director of Innovation. In addition to managing Sherwood’s Innovation Program, Josiah provides strategic design on a variety of influential projects, with a focus on campus and large-scale urban projects. His project credits include the design of on-site wastewater treatment wetlands and water reuse systems for a high-density corporate campus as well as living architecture applications at the California Academy of Sciences, University of California, and Duke University.

Specific municipal experience includes the following:

Campus Landscape Masterplan for Sonoma County Water Agency
Ground Water Resource Evaluation for Beverly Hills Department of Public Works
Public Workshop Facilitation/Green Streets Project for the City of Santa Monica

Interviewing with WHY architects next week to design Culver City’s City Hall facility.

Jimmy Galvez serves as a project Manager, and has a depth of design experience on projects at the institutional / higher-education campus scale, neighborhood district-scale, and streetscape city-scale for clients in public and private sectors. He has been responsible for the preparation of plans for land development projects, including site design, relevant calculations and project specifications; he has served as project lead in coordination with government agencies, outside consultants, office team members and contractors; and led the preparation of cost and bond estimates for private improvement projects. At the city-scale, Jimmy designs cost-effective and innovative land development plans that drill down into detailed site design. In his role as project manager, he coordinates stakeholders such as government agencies, outside consultants, office team members and contractors. He has also directed cost and bond estimates for private improvement projects.

Specific municipal agency experience includes:

CalTrans
Alameda County
Alameda County Flood Control
Contra Costa County
Central Contra Costa Sanitary District
Ironhouse Sanitary District
Diablo Water District
East Bay Municipal Utilities District
Dublin San Ramon Services District
Pacific Gas & Electric
City of Berkeley
City of San Ramon
City of Redwood City
City of Hayward
City of Richmond
City of Alameda
City of Menlo Park
City of Vallejo
City of Concord
City of Pleasanton
City of Dublin
City of Pleasant Hill
City of San Francisco
San Francisco Public Utilities Commission
Harris County
Harris County Flood Control
City of Houston
City of Pearland
Clear Lake City Water Authority



2. Identify and provide the resume(s) of the staff who will be assigned to complete the scope of services.

Please refer to pages 44-49

D. Response to Scope of Services

1. Describe the methods by which your firm will complete the services requested in the Scope of Services.

The Culver City City Hall Centennial Gardens project represents an opportunity to make a significant daily positive contribution to civic and economic life in Culver City. As a City founded on business opportunity, family, and the arts, we believe the new incarnation of the plaza at City Hall should reflect and support that rich identity.

We have prepared an illustration of our team's thoughts on the opportunities at this point, however, we believe a more rigorous discovery process – together with you, stakeholders, and outside creative advisors – will yield several benefits:

- Achieve a better understanding of the diverse range of desired activities that could be supported through the project. With this understanding, the design can be tuned so that each intervention accomplishes multiple objectives.
- In line with the motto we have adopted on behalf of our clients, 'nothing about us without us,' this process creates a sense of civic pride and ownership in the project.
- Establish and align project goals with the City's broader economic, social, and cultural goals and initiatives.
- Formulate a meaningful phasing strategy that rather than relying on a large chunk of resources to accomplish a grand goal, identifies and organizes improvement and intervention opportunities in a series of synergizing projects, each one enhancing the other.

During this process, the core of our effort will remain a baseline internal assessment on two fronts: establishing impactful project goals in parallel with a 'nuts-n-bolts' assessment of the physical infrastructure. This creative process is backed by a successful history of application on a range of projects, from public spaces and initiatives, to learning centers and cultural institutions, over which we have continually refined efficient workflow and milestone meetings

with our clients for successful project definition and delivery.

Sherwood's design process is firmly rooted in interdisciplinary design collaboration. Taking a holistic approach to the development with all design team members working together from an early stage will produce a well-developed, integrated design on an efficient schedule. The cost-benefits and efficiencies of this collaborative process are clear. Key to Sherwood's process is the ability of our team to understand the Architect's intent and our genuine desire to support their design process and be part of the successful implementation of the design.

Our process begins with the evaluation of an existing site and associated buildings to set a baseline. Site based strategies are developed for stormwater management in an effort to improve water quality, reduce O&M requirements, and improve the local ecology. Building and utility based strategies are developed to reduce demand, improve efficiency, and incorporate reuse where prudent. One of the challenges of water reuse is to match the supply and quality of water with appropriate uses ranging from non-potable reuse to indirect potable reuse. Sherwood's overall approach is to match water quality with its highest and best use to ensure that reuse water is neither undertreated nor over treated for the intended use.

2. Provide a statement of those service(s) that differentiate your firm from competing firms.

Our process is fun and exploratory, guiding clients to think afresh, discovering and seizing new opportunities, often from resources already at their disposal. As a result of our process, clients and users often characterize our work as environments that create a strong identity without being overtly iconic or self-residential. Stripped of design world ego, our work is liberated to be innovative, pragmatic, contextual, and even invisible as necessary.

Sherwood Design Engineers is a recognized leader in sustainable water resource engineering at institutions, from planning through documentation. Sherwood covers all aspects of a site's water cycle including site stormwater management, potable water systems, non-potable water systems, storage, and treatment. With an underlying focus on sustainability, Sherwood's work for education institutions considers system efficiency, return on investment, public health, education, and overall environmental impact.

E. Fees

Our fee for the initial Vision, Masterplan and Concept Design exercise will be \$60,000.

Given that the full scope and budget of the overall project is yet to be defined, for planning purposes, wHY’s fee for Landscape Architecture, Civil Engineering, and Horticulture (not including survey) on a project with a \$600,000 construction budget, would be 15%.

Provide staff titles and their associated hourly billing rates.

- Kulapat Yantrasast, Creative Director, \$325.00
- Mark Thomann, Director, wHY Grounds, \$265.00
- Gregory Fischer, Ideas & Design Director, \$265.00
- Kira Appelhans, Landscape Architect, \$185.00

- Josiah Cain, Director of Innovation, \$225
- Jimmy Galvez, Project Manager, \$175

F. References

Robert Karr, President
Project 120
203 North LaSalle Street, Suite 2500
Chicago, IL 60601
info@project120chicago.org

Jamie G. Manné, Director
MARCIANO ART FOUNDATION
4357 Wilshire Boulevard
Los Angeles, CA 90010
424 204 7542
jamie@marcianoartfoundation.org

Steven Lavine, President (former)
CalArts
Student Center and Café
24700 McBean Pkwy
Valencia, CA 91355
(661) 255-1050
slavine@calarts.edu

Beth Piatnitzza, Senior Programs Manager,
University of California San Francisco
UC Berkeley Lower Sproul Plaza Redevelopment Project
Former Associate Director, University of California, Berkeley
415 370 5942
beth.piatnitzza@ucsf.edu

Lower Sproul: Sherwood joined the UC Berkeley Lower Sproul Redevelopment Project as Civil Engineer with a high-powered design

team to re-envision the main entrance and social corridor to UC Berkeley. The project started in 2010 and was completed in 2015.

G. Implementation Schedule

The process consists of three phases:

Immerse & Engage (4 weeks):

We begin by assessing the multiple facets that contribute to Culver City’s civic identity and public space opportunities in tandem with an assessment of the physical constraints and the City’s fiscal and operational objectives.

Common feasibility studies for existing facilities assess an institution’s physical state, quantify the institutional objectives, and match test the two against a budget. To make assessment and eventual growth more relevant, wHY has evolved a process that is inclusive, participatory, and unique.

The core of our effort remains a thorough baseline internal assessment on two fronts. Here we work closely with key Culver City staff to examine current programming objectives and deficiencies, as well as any new ideas they want to incorporate. At the same time, we will conduct a ‘nuts and bolts’ assessment of the physical infrastructure, with an eye on improving sustainability, accessibility, and efficiency.

Our team will also conduct an external assessment, through an informal survey and outreach campaign concurrent with meetings with key civic, business and cultural leaders. As the City’s main public space, the new Gardens should be an alignment of these needs and aspirations. It is important to understand this survey not only a means both gather data: it is a way to garner support and awareness for the campaign.

Finally, like the baseline internal assessment, we will assess the project at an urban scale. Here we will review the urban aspects (social, cultural, economic) that shape the Garden’s physical context with an eye on potential impacts and opportunities. Simultaneously, we will look at City vision plans and long-range development plans as well as cultural institutions and programs for strategic engagement opportunities.

Analyze & Synthesize (6-8 weeks):

Here we put everything on the table that we learned from the previous phase: the needs and aspirations of the City, the people, partner institutions, and the quantitative understanding of the physical environment that supports them.

We align the results of the external assessment to determine

relevancy and accessibility of the Garden - what people think or hope as well as how they want to engage with the place - and arrive at a plan for the Garden as the people’s space.

We match-test the outcome of the internal assessment of the City’s vision and reality by cross-checking the identified vision of programs and services with the surveyed efficiency and sustainability of the physical context.

Finally, the urban assessment merges to become a valuable tool for understanding potentials for connectivity and growth. By researching urban-scale transformations occurring within the downtown and in broader city-wide area, we identify the directions or connections that the Gardens should engage for synergies and layer these potentials with the latest sustainable development technologies, including high performance landscape and storm water solutions.

Envision (6 weeks):

Armed with these three tools, we will determine, with you, a celebratory, inclusive, versatile, sustainable, and much-loved new City Hall Centennial Gardens for Culver City: An Un-Masterplan that integrates the vision of the People with the pragmatics of the site. This Un-Masterplan will guide the team’s design for a new Garden as a

world-class public plaza: a social destination and a fertile ground for civic engagement, expression, art, music, ecological innovation, flora and experimentation.

This comprehensive awareness will serve as a base for the phased masterplan and future work. This exercise will result in a clear concept design expressed as a menu of strategies, presented in actionable form, ready for Culver City to engage straight away.

H. Certificate of Insurance

Please see attachments

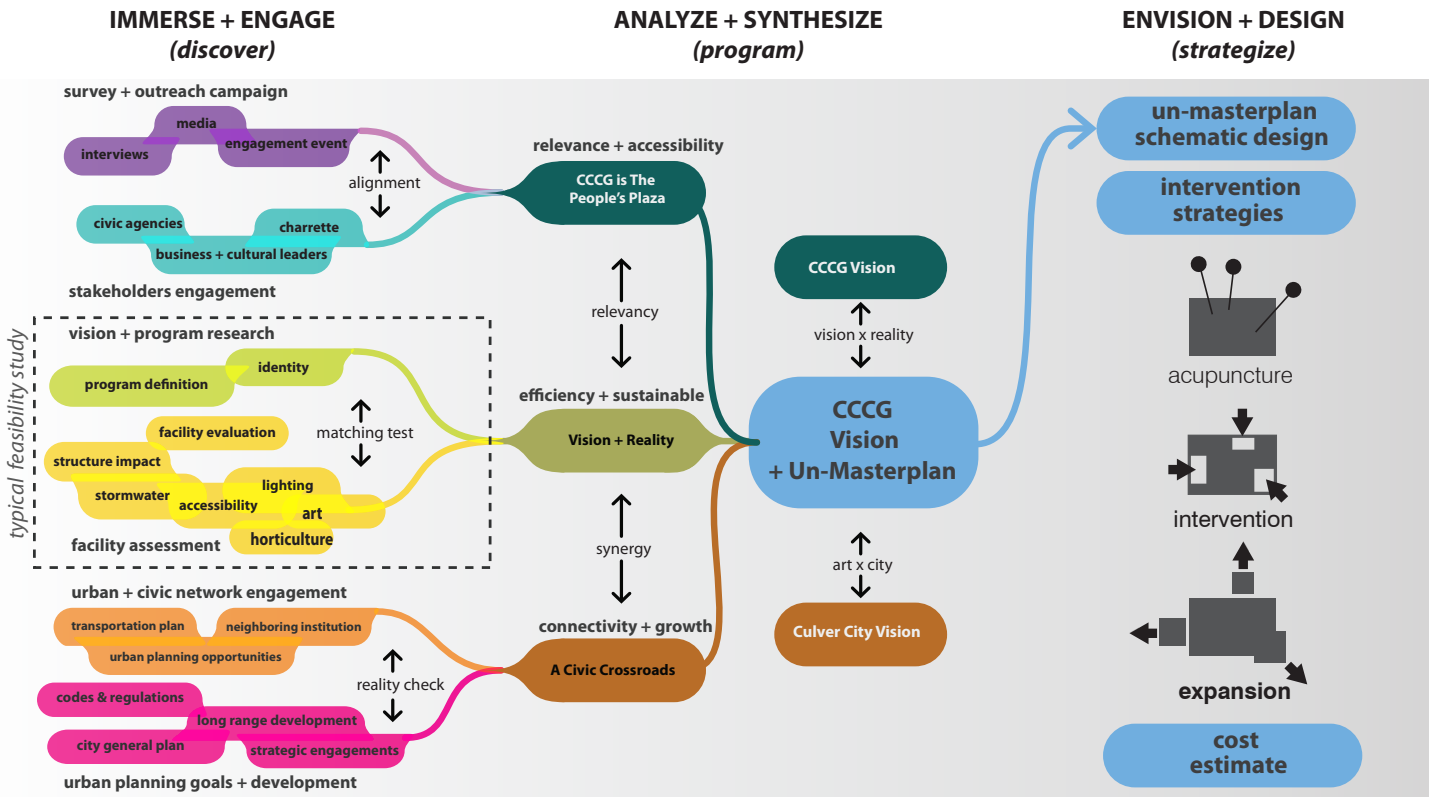



KULAPAT YANTRASAST
CREATIVE DIRECTOR

Born in Bangkok, Thailand, where he graduated with honors from Chulalongkorn University (1990), Kulapat received both his M.Arch. and Ph.D. degrees in Architecture from the University of Tokyo (1993/1996), under a Japanese Government scholarship. Upon graduating, Kulapat worked as Tadao Ando’s close associate for more than seven years in Japan, leading several award-winning projects including the Pulitzer Foundation for the Arts in St. Louis, Missouri, Fondation Francois Pinault pour l’Art Contemporain in Paris, and Tom Ford’s ‘House in the Desert’ in Santa Fe, New Mexico.

Regarded as a new generation architect, Kulapat’s interdisciplinary approach to architecture and design is largely shaped and inspired by his passion for food and society, viewing each project as a mix of ingredients that yields its own unique recipe. To this end, wHY is structured as four workshops – Ideas, Buildings, Objects, Grounds – with one cohesive team capable of taking on all aspects of a project, from the planning and landscape design to architecture and furniture.

His approach and philosophy provides a purity of structure and clarity of thought with an openness and desire for creating dynamic environments, earning him numerous honors and awards over the years. In 2012, he was named one of the art world’s 100 Most Powerful People and in 2009, Kulapat was the first architect to receive the Silpathorn Award for Design from Thailand’s Ministry of Culture.

In 2014, he was the subject of numerous profiles in leading international publications – Artforum, W, PIN-UP, Cultured – on the occasion of completing three major projects – Pomona College Studio Art Hall, Harvard Art Museums (with Renzo Piano Building Workshop), and Kordansky Gallery. Additionally, wHY’s projects have recently received coverage in WSJ Magazine, The Los Angeles Times, NPR, Christie’s Art News and The Boston Globe.

He is a frequent public speaker at leading institutions and organizations and has served on the Artists’ Committee of the Americans for the Arts, the United States’ oldest organization for support of the arts in the society, since 2005. In 2015, he was appointed a board member of the Pulitzer Foundation for the Arts, and he is an active member of the Design Council for Collective Design.

PROFESSIONAL EXPERIENCE

wHY, Founder and Creative Director, Los Angeles & New York 2004 - Present

- Speed Art Museum, 200,000 sf, Louisville, KY
- Project120 Chicago Master Plan & Music Pavilion, Chicago, IL
- Worcester Art Museum Master Plan, 180,000 sf, Worcester, MA
- Grand Rapids Art Museum, 127,000 sf, Grand Rapids, MI
- Museum of Italian Judaism and the Shoah, 110,000 sf, Ferrara, Italy
- Marciano Art Foundation, 100,000 sf, Los Angeles, CA
- Harvard Art Museums Galleries & Interior, 46,000sf, Cambridge, MA
- Art Institute of Chicago Galleries, 46,000 sf, Chicago, IL
- Tyler Museum of Art, 40,000 sf, Tyler, TX
- Pomona College Studio Art Hall, 35,000 sf, Claremont, CA
- CalArts Student Center, 14,000 sf, Valencia, CA
- Kordansky Gallery, 13,000 sf, Los Angeles, CA
- House on the River Ping, 8,000 sf, Chiang Mai, Thailand
- Phuket House, 8,000 sf, Phuket, Thailand
- Perry Rubenstein Hollywood, 7,400 sf, Hollywood, CA
- Venice Beach House, 4,000 sf, Venice, CA
- Hollywood Sign House, 4,000 sf, Hollywood, CA
- LA River Art Bridge, 120 ft span / 1,200 sf, Los Angeles, CA

Tadao Ando Associates, Project Architect, Tokyo, Japan, 1996 - 2004

- Clark Art Institute, Williamstown, MA
- Modern Art Museum, Fort Worth, TX
- Pulitzer Foundation for the Arts, St. Louis, MO
- Fondation Francois Pinault pour l’Art Contemporain, Paris, France
- House in the Desert for Tom Ford, Santa Fe, NM
- Armani/Teatro, Milan, Italy

Awards & Engagements

Artists’ Committee, Americans for the Arts, Since 2005
Silpathorn Award for Design, Ministry of Culture, Thailand, 2009
100 Most Powerful People in the Art World, Art + Auction, 2012
Design Council, Collective Design, Since 2013
Selected, Asian Art Museum Invited Qualifications Process, 2015
CORE Design Award, Notable Honor in the Built Environment, 2015
Board Member, Pulitzer Foundation for the Arts, Since 2015
“Top Emerging Architect” in the US, Architectural Review, 2015



MARK THOMANN
GROUNDS WORKSHOP DESIGN DIRECTOR

Mark is the director of wHY grounds, a landscape design studio. The Grounds Workshop is an imaginative landscape and urban design studio that collaborates with architects, urban planners, and artists worldwide to cultivate and program future ecologies and open space. The goal is to connect people and lifestyles to a vision of healthy and resilient cities and environments through the seamless integration of building, landscape and urban environments. The workshop enables art, function, nature and structure to beautifully coexist. Current initiatives include Project 120: a framework plan for a 542 acre park in Chicago, a competition for a school campus in Irkutsk, Russia, The Worcester Art Museum Master Plan, and a finalist in the International competition for Pershing Square in Los Angeles.

Prior to joining wHY, Mark was a partner and landscape design director with Balmori Associates and landscape director with Work Architecture Company, leading numerous international award winning projects and strategic plans, including the Campa de los Ingleses Park at the Guggenheim Museum in Bilbao, Spain, the Master plan and vision for Public Administration Town, a new administrative city of Sejong, Korea, the Gabon Conference Center and gardens in Gabon, Africa with Work Architecture Company, as well as the winning Rebuild By Design competition project “Resist, Delay, Store, Discharge” with OMA for a comprehensive strategy for a resilient and sustainable Hoboken, NJ. His works also reveals the collaborative potential of landscape, ecology and art in Skid Rows; Queens Museum Artist Gardens, 2005 with Brian Tolle and the construction and interpretation of Robert Smithson’s Floating Island; 2005 for Minetta Brook and the Whitney Museum.

Mark studied politics and conflict studies before pursuing a greater social good and received his MLA in Landscape Architecture and Regional Design from the University of Pennsylvania (1999). He teaches design studios that explore our ecological future and has been a studio critic, guest reviewer and lecturer at the University of Pennsylvania, Yale University, University of Toronto, Cornell University, Columbia University, Princeton University, the ASLA Awards, and Mildred’s Lane. He is an invited juror for several international competitions abroad and in China. He is the author of Master Plan for the Sejong Public Administration Town; Topos; 60, 2007 and Forum and Institute for Urban Design publication, Next New York, which highlights forty proposals imagining rebuilt infrastructure, an animated public realm for New York City.

PROFESSIONAL EXPERIENCE

wHY, Grounds Workshop Design Director, New York, NY

- Asian Art Museum - San Francisco, CA - 2017
- Paristown Pointe Master Plan, Louisville, KY, 2017
- Skylanding with Yoko Ono Chicago, IL - 2016
- Pershing Green, Los Angeles, CA - 2016
- Tower Hill Botanic Garden Boylston, MA - 2016
- Smart School Campus w/ WORKac, Irkutsk, Siberia - 2015
- Jackson Park Master plan, Chicago, IL - 2014
- Kordansky Gallery, Los Angeles, CA - 2014

Work Architecture Company, Landscape Director, New York, NY

- L’Assemblée Radieuse, Libreville, Gabon, 2014

Balmori Associates, Partner/Design Director, New York, NY

- Beale Street Landing, Memphis, TN - 2015
- New York Police Academy w/ Perkins+Will, New York, NY - 2014
- Sejong City Master plan, Sejong, South Korea - 2014
- Campa de los Ingleses Park, Bilbao, Spain - 2011
- Plaza Euskadi, Bilbao, Spain - 2011
- U.S. Institute for Peace Washington, D.C. - 2010
- Garden that Climbs the Stairs, Bilbao, Spain - 2009
- Hua Qiang Bei Road w/ WorkAC, Shenzhen, China - 2009
- Hudson Yards Master plan w/ WorkAC, New York, NY - 2008
- UC Dublin Master plan w/ Zaha Hadid, Dublin, Ireland - 2007
- Robert Smithson’s Floating Island, New York, NY - 2006
- The High Line w/ Zaha Hadid, New York, NY - 2004
- Shenzhen Park w/ MAD Architects, Shenzhen, China - 2003

Awards & Engagements

- Faculty, University of Pennsylvania, School of Design, 2010-17
- Columbia University, GSAPP, Adjunct Associate Professor, 2012-15
- ASLA - American Society of Landscape Architects Member
- Fellow, Magic Grant. Brown Institute for Media Innovation, Columbia University Graduate School of Journalism, 2015-17



GREGORY FISCHER
IDEAS WORKSHOP&
DESIGN DIRECTOR

Gregory Fischer leads the wHY IDEAS Workshop and the Los Angeles office, guiding teams through the design process by uncovering and framing opportunities, and - together with Kulapat – aligning the four design workshops with the project vision.

Since joining wHY in 2012, Gregory works closely with Kulapat and workshop leaders to shape and deliver design dialogues for all aspects of wHY’s work. His breadth of knowledge coupled with his ability to think at different scales of abstraction enables Gregory to discern a project’s driving factors and synthesize the design team’s responses into successful solutions for clients. He is typically involved from the early project planning stages onward, ensuring quality and commitment to design throughout the entire process.

PROFESSIONAL EXPERIENCE

wHY, Design Director, 2012 - Present

- Marciano Art Foundation, Los Angeles, CA, 2017
- Institute of Contemporary Art, Los Angeles, CA
- East Palo Alto Center for the Arts, East Palo Alto, CA
- Spring Place Mixed Use Cultural & Commercial Complex, Los Angeles
 - Arts District, CA
- Christie’s Flagship Gallery, Los Angeles, CA
- IBID Gallery, Los Angeles, CA, 2016
- Kordansky Gallery, Los Angeles, CA
- Pershing Square Renew, Los Angeles, CA, 2016
- Latvia Museum of Contemporary Art, Riga, Latvia, 2016
- Gagosian Gallery, San Francisco, CA
- Glendower Residence, Los Angeles, CA
- Amoroso Residence, Venice, CA, 2016
- CalArts Student Center, Valencia, CA, 2015
- Bonhill Residence, Los Angeles, CA
- ‘To Live and Dine in LA,’ Library Foundation of Los Angeles, 2015
- Birmingham Museum of Art Master Plan, Birmingham, AL, 2015
- Broad Restaurant and Market, Los Angeles, CA, 2013

Yazdani Studio of Cannon Design, Vice President, Studio Leader, 2010-2012

- Caffè Bene Experience Center
- University of Oregon, School of Architecture and the Allied Arts Master Plan
- Museum of Tolerance, Los Angeles, CA

SPF:architects, Studio Director, 1999-2010

- National Music Centre of Canada, Calgary, AB
- LACMA West, Los Angeles, CA
- UCLA Center for Embedded Network Sensing, Los Angeles, CA
- Wildwood Middle School, Los Angeles, CA
- Wildwood Middle School, Los Angeles, CA
- Nike Santa Monica Flagship Store: Santa Monica, CA
- Greek Theater, Masterplan & Renovation, Los Angeles, CA

Academic Instruction & Professional Activities

- University of Oregon, AAP: Visiting Critic, 2011
- Art Center College of Design: Guest Critic, 2008
- USC Marshal School of Business: Visiting Critic, 2005
- University of Buffalo School of Architecture: Adjunct Professor, 1998

Education & Credentials

- Bachelor of Architecture, Cornell University College of Architecture Art and Planning, 1995



KIRA APPELHANS
LANDSCAPE ARCHITECT

PROFESSIONAL EXPERIENCE

wHY, Designer, New York, NY

- Ross Pavilion, Edinburgh, UK, 2017
- Asian Art Museum - San Francisco, CA - 2017
- Paristown Pointe Master Plan, Louisville, KY, 2017
- *Skylanding* with Yoko Ono Chicago, IL - 2016
- Pershing Green, Los Angeles, CA - 2016
- Project 120 — Reimagining Jackson Park, Chicago, IL, 2013

Hawkins Partner, Inc., Senior Designer, Nashville, Tennessee
Edmondson Park - Nashville, Tennessee

MoMA Rising Currents, New York, NY

Balmori Associates, New York, NY

- American Revolution Center, Calley Forge, PA
- Campa de los Ingeles, Bilbao, Spain
- Teaching Experience
- 60 Studio, University of Pennsylvania
- Waterlogged, Parsons, School of Design Strategies
- Design and Visual Studies in Landscape Arch III, Univesrity of Texas
- Workshop I: Ecological Systems, University of Pennsylvania

Education & Credentials

- University of Pennsylvania, Philadelphia, PA, Master of Landscape Architecture
- Colorado State University, Cort Collins, CO, B.S in Landscape Horticulture with concentration in design and construction

Residencies, Awards, Competitions

- MacDowell Colony: printmaking and design
- ASLA Student Honor Award: smartPARK
- 1st Prize, Grand Plaza International ideas competition, Caracas, Venezuela
- Publications
- “Birmingham Railroad Park, Topos 73, City Regeneration 2011: 16
- “smartPARK”, A + T, In Common III Spring 2006 Issue 27: 112 - 125
- 1st Prize, Grand Plaza International ideas competition, Caracas, Venezuela

Exhibitions

- Shifting Ground - solo show, University of Manitoba, Winnipeg
- MoMA Rising Currents, Museum of Modern Art, NY



JOSIAH CAIN
DIRECTOR OF INNOVATION

Josiah Cain serves as Sherwood Design Engineers’ Director of Innovation. A student of design, ecology, and technology, his deep sustainable design experience and multi-disciplinary approach provide insight and opportunities for optimization of site and structure. His inherent drive for enhanced systems performance and integration has led to first of a kind permits in over a dozen jurisdictions; his work has provided advancement in the areas of rain harvesting, graywater, blackwater reuse, living roofs and walls, native plants, sustainable stormwater management, food systems, and sustainable materials.

In addition to his efforts managing Sherwood’s Innovation Program, Josiah provides strategic design on a variety of influential projects, with a focus on campus and large-scale urban projects. His project credits include the design of on-site wastewater treatment wetlands and water reuse systems for a high-density corporate campus as well as living architecture applications at the California Academy of Sciences, University of California, and Duke University.

Josiah is a licensed landscape architect with over 20 years of direct experience in the sustainable design industry. Known as a visionary ecological integration strategist, he regularly presents at universities and conferences addressing building ecology, green infrastructure, and sustainable site development. He is highly sought after for sustainable design innovation, integrated water management, and high performance building ecology.

In support of his extensive experience, Josiah holds degrees from both UC Davis and the Harvard Graduate School of Design. He occasionally teaches courses and workshops in green roof design, landscape architecture, sustainable stormwater, permaculture, integrated water management, and advanced sustainable design.

- EDUCATION
- Harvard Graduate School of Design
Master of Design Studies (MDesS)
Design, Technology & Environment

University of California, Davis
Bachelor of Science, Sustainable
Community Planning, Landscape
Architecture (BSLA)

Green Roofs for Healthy Cities
Green Roof Design Certificate

Humboldt State University
Constructed Wetlands Workshop
Graduate

Permaculture Institute of
Northern California, Permaculture
Design Certificate, wOccidental

- PROFESSIONAL
REGISTRATION
- Registered Landscape Architect
Professional Affiliations
American Society of Landscape
Architects



JIMMY GALVEZ, P.E.
PROJECT MANAGER

Jimmy Galvez has a depth of design experience on projects at the institutional / higher-education campus scale, neighborhood district-scale, and streetscape city-scale for clients in public and private sectors. He has been responsible for the preparation of plans for land development projects, including site design, relevant calculations and project specifications; he has served as project lead in coordination with government agencies, outside consultants, office team members and contractors; and led the preparation of cost and bond estimates for private improvement projects.

At the institutional level, Jimmy has worked on a number of Sherwood’s leading-edge sustainable campus projects including the UC Berkeley Lower Sproul Redevelopment Project in Berkeley, California and Spirit Rock Center in Woodacre, California. In both projects, he completed site grading, relocation of existing utilities, design of new utilities, storm water treatment design, and coordination between civil design and architectural/landscape architectural design.

At the city-scale, Jimmy designs cost-effective and innovative land development plans that drill down into detailed site design. In his role as project manager, he coordinates stakeholders such as government agencies, outside consultants, office team members and contractors. He has also directed cost and bond estimates for private improvement projects.

Jimmy’s diverse experience applying technical innovation and solid engineering to projects at all scales result in outcomes that save time and resources and exceed the expectations of stakeholders.

- EDUCATION
- California Polytechnic State University
Bachelor of Science in Civil Engineering
- PROFESSIONAL
REGISTRATION
- Registered Professional Engineer
State of California
- PROFESSIONAL
AFFILIATION
- American Society of Civil Engineers,
Member
Society of Hispanic Professional
Engineers, Houston Chapter President



**‘Harry Culver
looked through the
sagebrush and
imagined Culver
City’ –**



ATTACHMENTS



August 23, 2017

CITY OF CULVER CITY
9770 CULVER BOULEVARD
CULVER CITY, CA 90232-0507

RE: TRANSMITTAL FOR RFP-1654 CITY HALL LANDSCAPING
REPLACEMENT AND CENTENNIAL GARDEN PROJECT

Attn: CITY CLERK

wHY thanks the City of Culver City for the opportunity to submit a bid
for RFP-1654 City Hall Landscaping Replacement and Centennial
Garden Project. wHY recognizes that the firm has read and will
comply with all terms and conditions of this RFP.

Sincerely,

Misa Lund
Managing Principal, wHY

wHY Los Angeles
9520 Jefferson Boulevard
Culver City, California 90232
310.839.5106

wHY New York
473 W. Broadway, Unit 3
New York, New York 10012
646.682.9280

www.why-site.com



CERTIFICATE OF LIABILITY INSURANCE

DATE (MM/DD/YYYY)

6/26/2017

THIS CERTIFICATE IS ISSUED AS A MATTER OF INFORMATION ONLY AND CONFERS NO RIGHTS UPON THE CERTIFICATE HOLDER. THIS CERTIFICATE DOES NOT AFFIRMATIVELY OR NEGATIVELY AMEND, EXTEND OR ALTER THE COVERAGE AFFORDED BY THE POLICIES BELOW. THIS CERTIFICATE OF INSURANCE DOES NOT CONSTITUTE A CONTRACT BETWEEN THE ISSUING INSURER(S), AUTHORIZED REPRESENTATIVE OR PRODUCER, AND THE CERTIFICATE HOLDER.

IMPORTANT: If the certificate holder is an ADDITIONAL INSURED, the policy(ies) must have ADDITIONAL INSURED provisions or be endorsed. If SUBROGATION IS WAIVED, subject to the terms and conditions of the policy, certain policies may require an endorsement. A statement on this certificate does not confer rights to the certificate holder in lieu of such endorsement(s).

PRODUCER License # 0E67768 IOA Insurance Services 3875 Hopyard Road Suite 240 Pleasanton, CA 94588	CONTACT NAME: David Sifuentes	
	PHONE (A/C, No, Ext): 50027	FAX (A/C, No): (925) 416-7869
INSURED wHY Architecture Workshop Inc. 9520 Jefferson Blvd, Suite C Culver City, CA 90232	E-MAIL ADDRESS: David.Sifuentes@ioausa.com	
	INSURER(S) AFFORDING COVERAGE	
	INSURER A : RLI Insurance Company	
	INSURER B : Travelers Casualty & Surety Company of America	
	INSURER C : Fireman's Fund Insurance Company	
	INSURER D : INSURER E : INSURER F :	

COVERAGES		CERTIFICATE NUMBER:CL16101706994		REVISION NUMBER:			
THIS IS TO CERTIFY THAT THE POLICIES OF INSURANCE LISTED BELOW HAVE BEEN ISSUED TO THE INSURED NAMED ABOVE FOR THE POLICY PERIOD INDICATED. NOTWITHSTANDING ANY REQUIREMENT, TERM OR CONDITION OF ANY CONTRACT OR OTHER DOCUMENT WITH RESPECT TO WHICH THIS CERTIFICATE MAY BE ISSUED OR MAY PERTAIN, THE INSURANCE AFFORDED BY THE POLICIES DESCRIBED HEREIN IS SUBJECT TO ALL THE TERMS, EXCLUSIONS AND CONDITIONS OF SUCH POLICIES. LIMITS SHOWN MAY HAVE BEEN REDUCED BY PAID CLAIMS.							
INSR LTR	TYPE OF INSURANCE	ADDL INSD	SUBR WVD	POLICY NUMBER	POLICY EFF (MM/DD/YYYY)	POLICY EXP (MM/DD/YYYY)	LIMITS
C	<input checked="" type="checkbox"/> COMMERCIAL GENERAL LIABILITY	X		AZC80907048	10/21/2016	10/21/2017	EACH OCCURRENCE \$ 2,000,000
	<input type="checkbox"/> CLAIMS-MADE <input checked="" type="checkbox"/> OCCUR						DAMAGE TO RENTED PREMISES (Ea occurrence) \$ 100,000
							MED EXP (Any one person) \$ 10,000
							PERSONAL & ADV INJURY \$ 2,000,000
	GEN'L AGGREGATE LIMIT APPLIES PER:						GENERAL AGGREGATE \$ 4,000,000
	<input checked="" type="checkbox"/> POLICY <input type="checkbox"/> PROJECT <input type="checkbox"/> LOC						PRODUCTS - COMP/OP AGG \$ 4,000,000
	OTHER:						\$
C	AUTOMOBILE LIABILITY			AZC80907048	10/21/2016	10/21/2017	COMBINED SINGLE LIMIT (Ea accident) \$ 1,000,000
	<input checked="" type="checkbox"/> ANY AUTO OWNED AUTOS ONLY <input type="checkbox"/> SCHEDULED AUTOS	BODILY INJURY (Per person) \$ 1,000,000					
	<input type="checkbox"/> HIRED AUTOS ONLY <input type="checkbox"/> NON-OWNED AUTOS ONLY	BODILY INJURY (Per accident) \$ 1,000,000					
		PROPERTY DAMAGE (Per accident) \$ 1,000,000					
						\$	
C	<input checked="" type="checkbox"/> UMBRELLA LIAB			AS3AZC80890266	10/21/2016	10/21/2017	EACH OCCURRENCE \$ 10,000,000
	<input type="checkbox"/> EXCESS LIAB	<input type="checkbox"/> CLAIMS-MADE	AGGREGATE \$ 10,000,000				
	DED	RETENTION \$	\$				
A	WORKERS COMPENSATION AND EMPLOYERS' LIABILITY			PSW0003828	02/01/2017	02/01/2018	<input checked="" type="checkbox"/> PER STATUTE <input type="checkbox"/> OTH-ER
	ANY PROPRIETOR/PARTNER/EXECUTIVE OFFICER/MEMBER EXCLUDED? (Mandatory in NH)	Y/N <input checked="" type="checkbox"/> Y	N/A				E.L. EACH ACCIDENT \$ 1,000,000
	If yes, describe under DESCRIPTION OF OPERATIONS below						E.L. DISEASE - EA EMPLOYEE \$ 1,000,000
							E.L. DISEASE - POLICY LIMIT \$ 1,000,000
B	Professional Liab.		X	106276600	04/03/2017	04/03/2018	Each Claim 2,000,000
B	Professional Liab.		X	106276600	04/03/2017	04/03/2018	Aggregate 4,000,000

DESCRIPTION OF OPERATIONS / LOCATIONS / VEHICLES (ACORD 101, Additional Remarks Schedule, may be attached if more space is required)

CERTIFICATE HOLDER	CANCELLATION
wHY Architecture Workshop Inc. 9520 Jefferson Blvd, Suite C Culver City, CA 90232	SHOULD ANY OF THE ABOVE DESCRIBED POLICIES BE CANCELLED BEFORE THE EXPIRATION DATE THEREOF, NOTICE WILL BE DELIVERED IN ACCORDANCE WITH THE POLICY PROVISIONS.
	AUTHORIZED REPRESENTATIVE

THIS CERTIFICATE IS ISSUED AS A MATTER OF INFORMATION ONLY AND CONFERS NO RIGHTS UPON THE CERTIFICATE HOLDER. THIS CERTIFICATE DOES NOT AFFIRMATIVELY OR NEGATIVELY AMEND, EXTEND OR ALTER THE COVERAGE AFFORDED BY THE POLICIES BELOW. THIS CERTIFICATE OF INSURANCE DOES NOT CONSTITUTE A CONTRACT BETWEEN THE ISSUING INSURER(S), AUTHORIZED REPRESENTATIVE OR PRODUCER, AND THE CERTIFICATE HOLDER.

IMPORTANT: If the certificate holder is an ADDITIONAL INSURED, the policy(ies) must be endorsed. If SUBROGATION IS WAIVED, subject to the terms and conditions of the policy, certain policies may require an endorsement. A statement on this certificate does not confer rights to the certificate holder in lieu of such endorsement(s).

PRODUCER

Salsbury & Associates Insuranc
3155 Kearney Street, #240
Fremont, CA 94538
Allen E. Salsbury

CONTACT NAME: Allen E. Salsbury

PHONE (A/C, No, Ext): 510-413-0270

FAX (A/C, No):

E-MAIL ADDRESS:

INSURER(S) AFFORDING COVERAGE

INSURER A : The Travelers PropCas Group

INSURER B :

INSURER C :

INSURER D :

INSURER E :

INSURER F :

NAIC #
25674

INSURED
Sherwood Design Engineers, Ltd
58 Maiden Lane
San Francisco, CA 94108

COVERAGES				CERTIFICATE NUMBER:		REVISION NUMBER:				
THIS IS TO CERTIFY THAT THE POLICIES OF INSURANCE LISTED BELOW HAVE BEEN ISSUED TO THE INSURED NAMED ABOVE FOR THE POLICY PERIOD INDICATED. NOTWITHSTANDING ANY REQUIREMENT, TERM OR CONDITION OF ANY CONTRACT OR OTHER DOCUMENT WITH RESPECT TO WHICH THIS CERTIFICATE MAY BE ISSUED OR MAY PERTAIN, THE INSURANCE AFFORDED BY THE POLICIES DESCRIBED HEREIN IS SUBJECT TO ALL THE TERMS, EXCLUSIONS AND CONDITIONS OF SUCH POLICIES. LIMITS SHOWN MAY HAVE BEEN REDUCED BY PAID CLAIMS.										
INSR LTR	TYPE OF INSURANCE			ADDL INSD	SUBR WVD	POLICY NUMBER	POLICY EFF (MM/DD/YYYY)	POLICY EXP (MM/DD/YYYY)	LIMITS	
A	X	COMMERCIAL GENERAL LIABILITY				6802C149311(CA) 6801H85599016(NY) 6801H98121416(TX)	09/01/2016 09/01/2016 09/01/2016	09/01/2017 09/01/2017 09/01/2017	EACH OCCURRENCE	\$ 1,000,000
		CLAIMS-MADE	OCCUR		DAMAGE TO RENTED PREMISES (Ea occurrence)				\$ 300,000	
					MED EXP (Any one person)				\$ 10,000	
					PERSONAL & ADV INJURY				\$ 1,000,000	
					GENERAL AGGREGATE				\$ 2,000,000	
	GEN'L AGGREGATE LIMIT APPLIES PER:									
	X	POLICY	PRO-JECT	LOC					PRODUCTS - COMP/OP AGG	\$ 2,000,000
	OTHER:									\$
A	AUTOMOBILE LIABILITY					BA5H12665516	09/01/2016	09/01/2017	COMBINED SINGLE LIMIT (Ea accident)	\$ 1,000,000
		ANY AUTO		SCHEDULED AUTOS	BODILY INJURY (Per person)				\$	
		ALL OWNED AUTOS		NON-OWNED AUTOS	BODILY INJURY (Per accident)				\$	
	X	HIRED AUTOS	X		PROPERTY DAMAGE (Per accident)				\$	
									\$	
A	X	UMBRELLA LIAB	X	OCCUR		CUP2C14987016	09/01/2016	09/01/2017	EACH OCCURRENCE	\$ 5,000,000
		EXCESS LIAB		CLAIMS-MADE					AGGREGATE	\$
		DED	X	RETENTION \$	0					\$
	WORKERS COMPENSATION AND EMPLOYERS' LIABILITY									PER STATUTE
	ANY PROPRIETOR/PARTNER/EXECUTIVE OFFICER/MEMBER EXCLUDED? (Mandatory in NH)								E.L. EACH ACCIDENT	\$
	If yes, describe under DESCRIPTION OF OPERATIONS below								E.L. DISEASE - EA EMPLOYEE	\$
									E.L. DISEASE - POLICY LIMIT	\$

DESCRIPTION OF OPERATIONS / LOCATIONS / VEHICLES (ACORD 101, Additional Remarks Schedule, may be attached if more space is required)

Proof of Insurance.

CERTIFICATE HOLDER

SAMPLEC

SAMPLE CERTIFICATE

CANCELLATION

SHOULD ANY OF THE ABOVE DESCRIBED POLICIES BE CANCELLED BEFORE THE EXPIRATION DATE THEREOF, NOTICE WILL BE DELIVERED IN ACCORDANCE WITH THE POLICY PROVISIONS.

AUTHORIZED REPRESENTATIVE

THIS CERTIFICATE IS ISSUED AS A MATTER OF INFORMATION ONLY AND CONFERS NO RIGHTS UPON THE CERTIFICATE HOLDER. THIS CERTIFICATE DOES NOT AFFIRMATIVELY OR NEGATIVELY AMEND, EXTEND OR ALTER THE COVERAGE AFFORDED BY THE POLICIES BELOW. THIS CERTIFICATE OF INSURANCE DOES NOT CONSTITUTE A CONTRACT BETWEEN THE ISSUING INSURER(S), AUTHORIZED REPRESENTATIVE OR PRODUCER, AND THE CERTIFICATE HOLDER.

IMPORTANT: If the certificate holder is an ADDITIONAL INSURED, the policy(ies) must be endorsed. If SUBROGATION IS WAIVED, subject to the terms and conditions of the policy, certain policies may require an endorsement. A statement on this certificate does not confer rights to the certificate holder in lieu of such endorsement(s).

PRODUCER

Hall & Company
A/E Insurance Services
19660 10th Ave NE
Poulsbo WA 98370

CONTACT NAME: Allison Andrus License #0K93926

PHONE (A/C, No, Ext): 360-626-2007

FAX (A/C, No): 360-598-3703

E-MAIL ADDRESS: aandrus@hallandcompany.com

INSURER(S) AFFORDING COVERAGE

INSURER A :Atlantic Specialty Insurance Compan

INSURER B :

INSURER C :

INSURER D :

INSURER E :

INSURER F :

NAIC #
27154

INSURED
7881
Sherwood Design Engineers Ltd
58 Maiden Lane, 3rd Floor
San Francisco CA 94108

COVERAGES				CERTIFICATE NUMBER: 1095060991		REVISION NUMBER:									
THIS IS TO CERTIFY THAT THE POLICIES OF INSURANCE LISTED BELOW HAVE BEEN ISSUED TO THE INSURED NAMED ABOVE FOR THE POLICY PERIOD INDICATED. NOTWITHSTANDING ANY REQUIREMENT, TERM OR CONDITION OF ANY CONTRACT OR OTHER DOCUMENT WITH RESPECT TO WHICH THIS CERTIFICATE MAY BE ISSUED OR MAY PERTAIN, THE INSURANCE AFFORDED BY THE POLICIES DESCRIBED HEREIN IS SUBJECT TO ALL THE TERMS, EXCLUSIONS AND CONDITIONS OF SUCH POLICIES. LIMITS SHOWN MAY HAVE BEEN REDUCED BY PAID CLAIMS.															
INSR LTR	TYPE OF INSURANCE		ADDL INSR	SUBR WVD	POLICY NUMBER	POLICY EFF (MM/DD/YYYY)	POLICY EXP (MM/DD/YYYY)	LIMITS							
	GENERAL LIABILITY							EACH OCCURRENCE	\$						
	<input type="checkbox"/> COMMERCIAL GENERAL LIABILITY	DAMAGE TO RENTED PREMISES (Ea occurrence)						\$							
	<input type="checkbox"/> CLAIMS-MADE <input type="checkbox"/> OCCUR	MED EXP (Any one person)						\$							
		PERSONAL & ADV INJURY						\$							
		GENERAL AGGREGATE						\$							
		PRODUCTS - COMP/OP AGG						\$							
								\$							
	AUTOMOBILE LIABILITY							COMBINED SINGLE LIMIT (Ea accident)	\$						
	<input type="checkbox"/> ANY AUTO	<input type="checkbox"/> SCHEDULED AUTOS <input type="checkbox"/> NON-OWNED AUTOS						BODILY INJURY (Per person)	\$						
	<input type="checkbox"/> ALL OWNED AUTOS							BODILY INJURY (Per accident)	\$						
	<input type="checkbox"/> HIRED AUTOS							PROPERTY DAMAGE (Per accident)	\$						
									\$						
		UMBRELLA LIAB						<input type="checkbox"/> OCCUR						EACH OCCURRENCE	\$
		EXCESS LIAB						<input type="checkbox"/> CLAIMS-MADE						AGGREGATE	\$
DED <input type="checkbox"/>		RETENTION \$		\$											
	WORKERS COMPENSATION AND EMPLOYERS' LIABILITY							<input type="checkbox"/> WC STATU-TORY LIMITS	<input type="checkbox"/> OTH-ER						
	ANY PROPRIETOR/PARTNER/EXECUTIVE OFFICER/MEMBER EXCLUDED? (Mandatory in NH)							E.L. EACH ACCIDENT	\$						
	If yes, describe under DESCRIPTION OF OPERATIONS below							E.L. DISEASE - EA EMPLOYEE	\$						
								E.L. DISEASE - POLICY LIMIT	\$						
A	Professional Liab: Claims Made				DPL609516	12/1/2016	12/1/2017	\$5,000,000 Per Claim \$5,000,000 Aggregate							

DESCRIPTION OF OPERATIONS / LOCATIONS / VEHICLES (Attach ACORD 101, Additional Remarks Schedule, if more space is required)

CERTIFICATE HOLDER

For Your Information

CANCELLATION

SHOULD ANY OF THE ABOVE DESCRIBED POLICIES BE CANCELLED BEFORE THE EXPIRATION DATE THEREOF, NOTICE WILL BE DELIVERED IN ACCORDANCE WITH THE POLICY PROVISIONS.

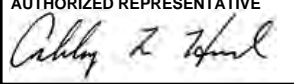
AUTHORIZED REPRESENTATIVE

CERTIFICATE OF LIABILITY INSURANCE

DATE (MM/DD/YYYY)
04/05/17

THIS CERTIFICATE IS ISSUED AS A MATTER OF INFORMATION ONLY AND CONFERS NO RIGHTS UPON THE CERTIFICATE HOLDER. THIS CERTIFICATE DOES NOT AFFIRMATIVELY OR NEGATIVELY AMEND, EXTEND OR ALTER THE COVERAGE AFFORDED BY THE POLICIES BELOW. THIS CERTIFICATE OF INSURANCE DOES NOT CONSTITUTE A CONTRACT BETWEEN THE ISSUING INSURER(S), AUTHORIZED REPRESENTATIVE OR PRODUCER, AND THE CERTIFICATE HOLDER.

IMPORTANT: If the certificate holder is an ADDITIONAL INSURED, the policy(ies) must have ADDITIONAL INSURED provisions or be endorsed. If SUBROGATION IS WAIVED, subject to the terms and conditions of the policy, certain policies may require an endorsement. A statement on this certificate does not confer rights to the certificate holder in lieu of such endorsement(s).

PRODUCER Aon Risk Services, Inc of Florida 1001 Brickell Bay Drive, Suite #1100 Miami, FL 33131-4937	CONTACT NAME: Aon Risk Services, Inc of Florida	
	PHONE (A/C, No, Ext): 800-743-8130	FAX (A/C, No): 800-522-7514
	EMAIL ADDRESS: ADP.COI.Center@Aon.com	
	INSURER(S) AFFORDING COVERAGE	NAIC #
	INSURER A : American Home Assurance Co.	19380
INSURED ADP TotalSource FL XVI, Inc. 10200 Sunset Drive Miami, FL 33173 L/C/F Sherwood Design Engineers LTD 58 Maiden Lane 3rd Floor San Francisco, CA 94108	INSURER B :	
	INSURER C :	
	INSURER D :	
	INSURER E :	
	INSURER F :	

COVERAGES CERTIFICATE NUMBER: 1326145

REVISION NUMBER:

THIS IS TO CERTIFY THAT THE POLICIES OF INSURANCE LISTED BELOW HAVE BEEN ISSUED TO THE INSURED NAMED ABOVE FOR THE POLICY PERIOD INDICATED. NOTWITHSTANDING ANY REQUIREMENT, TERM OR CONDITION OF ANY CONTRACT OR OTHER DOCUMENT WITH RESPECT TO WHICH THIS CERTIFICATE MAY BE ISSUED OR MAY PERTAIN, THE INSURANCE AFFORDED BY THE POLICIES DESCRIBED HEREIN IS SUBJECT TO ALL THE TERMS, EXCLUSIONS AND CONDITIONS OF SUCH POLICIES. LIMITS SHOWN MAY HAVE BEEN REDUCED BY PAID CLAIMS. LIMITS SHOWN ARE AS REQUESTED.

INSR LTR	TYPE OF INSURANCE			ADDL INSR	SUBR WVD	POLICY NUMBER	POLICY EFF (MM/DD/YYYY)	POLICY EXP (MM/DD/YYYY)	LIMITS					
	COMMERCIAL GENERAL LIABILITY								EACH OCCURRENCE		\$			
		CLAIMS-MADE	OCCUR						DAMAGE TO RENTED PREMISES (Ea occurrence)		\$			
									MED EXP (Any one person)		\$			
									PERSONAL & ADV INJURY		\$			
	GEN'L AGGREGATE LIMIT APPLIES PER:								GENERAL AGGREGATE		\$			
		POLICY							PROJECT		LOC	PRODUCTS - COMP/OP AGG		\$
		OTHER									\$			
	AUTOMOBILE LIABILITY								COMBINED SINGLE LIMIT (Ea accident)		\$			
		ANY AUTO OWNED AUTOS ONLY							SCHEDULED AUTOS	BODILY INJURY (Per person)		\$		
										BODILY INJURY (Per accident)		\$		
		HIRED AUTOS ONLY							NON-OWNED AUTOS ONLY	PROPERTY DAMAGE (Per accident)		\$		
												\$		
											\$			
	UMBRELLA LIAB			OCCUR					EACH OCCURRENCE		\$			
	EXCESS LIAB									CLAIMS-MADE	AGGREGATE		\$	
	DEC		RETENTION \$											
	A	WORKERS COMPENSATION AND EMPLOYERS' LIABILITY							Y / N	N / A	WC 061140940 CA	07/01/16	07/01/17	X
ANY PROPRIETOR/PARTNER/PARTNER/EXECUTIVE OFFICER/MEMBER EXCLUDED? (Mandatory in NH)			E.L. EACH ACCIDENT		\$	2,000,000								
If yes, describe under DESCRIPTION OF OPERATIONS below			E.L. DISEASE - EA EMPLOYEE		\$	2,000,000								
			E.L. DISEASE - POLICY LIMIT		\$	2,000,000								

DESCRIPTION OF OPERATIONS / LOCATIONS / VEHICLES (ACORD 101, Additional Remarks Schedule, may be attached if more space is required)
All worksite employees working for SHERWOOD DESIGN ENGINEERS LTD, paid under ADP TOTALSOURCE, INC's payroll, are covered under the above stated policy.

CERTIFICATE HOLDER

CANCELLATION

Sherwood Design Engineers LTD 58 Maiden Lane 3rd Floor San Francisco, CA 94108	SHOULD ANY OF THE ABOVE DESCRIBED POLICIES BE CANCELLED BEFORE THE EXPIRATION DATE THEREOF, NOTICE WILL BE DELIVERED IN ACCORDANCE WITH THE POLICY PROVISIONS.
	AUTHORIZED REPRESENTATIVE Aon Risk Services, Inc of Florida

© 1988-2015 ACORD CORPORATION. All rights reserved.

CERTIFICATE OF LIABILITY INSURANCE

DATE (MM/DD/YYYY)
04/05/17

THIS CERTIFICATE IS ISSUED AS A MATTER OF INFORMATION ONLY AND CONFERS NO RIGHTS UPON THE CERTIFICATE HOLDER. THIS CERTIFICATE DOES NOT AFFIRMATIVELY OR NEGATIVELY AMEND, EXTEND OR ALTER THE COVERAGE AFFORDED BY THE POLICIES BELOW. THIS CERTIFICATE OF INSURANCE DOES NOT CONSTITUTE A CONTRACT BETWEEN THE ISSUING INSURER(S), AUTHORIZED REPRESENTATIVE OR PRODUCER, AND THE CERTIFICATE HOLDER.

IMPORTANT: If the certificate holder is an ADDITIONAL INSURED, the policy(ies) must have ADDITIONAL INSURED provisions or be endorsed. If SUBROGATION IS WAIVED, subject to the terms and conditions of the policy, certain policies may require an endorsement. A statement on this certificate does not confer rights to the certificate holder in lieu of such endorsement(s).

PRODUCER Aon Risk Services, Inc of Florida 1001 Brickell Bay Drive, Suite #1100 Miami, FL 33131-4937	CONTACT NAME: Aon Risk Services, Inc of Florida	
	PHONE (A/C, No, Ext): 800-743-8130	FAX (A/C, No): 800-522-7514
	EMAIL ADDRESS: ADP.COI.Center@Aon.com	
	INSURER(S) AFFORDING COVERAGE	NAIC #
	INSURER A : New Hampshire Ins Co	23841
INSURED ADP TotalSource FL XVI, Inc. 10200 Sunset Drive Miami, FL 33173 L/C/F Sherwood Design Engineers LTD 58 Maiden Lane 3rd Floor San Francisco, CA 94108	INSURER B :	
	INSURER C :	
	INSURER D :	
	INSURER E :	
	INSURER F :	

COVERAGES CERTIFICATE NUMBER: 1326146

REVISION NUMBER:

THIS IS TO CERTIFY THAT THE POLICIES OF INSURANCE LISTED BELOW HAVE BEEN ISSUED TO THE INSURED NAMED ABOVE FOR THE POLICY PERIOD INDICATED. NOTWITHSTANDING ANY REQUIREMENT, TERM OR CONDITION OF ANY CONTRACT OR OTHER DOCUMENT WITH RESPECT TO WHICH THIS CERTIFICATE MAY BE ISSUED OR MAY PERTAIN, THE INSURANCE AFFORDED BY THE POLICIES DESCRIBED HEREIN IS SUBJECT TO ALL THE TERMS, EXCLUSIONS AND CONDITIONS OF SUCH POLICIES. LIMITS SHOWN MAY HAVE BEEN REDUCED BY PAID CLAIMS. LIMITS SHOWN ARE AS REQUESTED.

INSR LTR	TYPE OF INSURANCE				ADDL INSR	SUBR WVD	POLICY NUMBER	POLICY EFF (MM/DD/YYYY)	POLICY EXP (MM/DD/YYYY)	LIMITS				
	COMMERCIAL GENERAL LIABILITY									EACH OCCURRENCE		\$		
	<div><div></div> CLAIMS-MADE<div></div> OCCUR</div>									DAMAGE TO RENTED PREMISES (Ea occurrence)		\$		
										MED EXP (Any one person)		\$		
										PERSONAL & ADV INJURY		\$		
	GEN'L AGGREGATE LIMIT APPLIES PER:									GENERAL AGGREGATE		\$		
	<div><div></div> POLICY<div></div> PROJECT<div></div> LOC</div>									PRODUCTS - COMP/OP AGG		\$		
	<div><div></div> OTHER</div>											\$		
	AUTOMOBILE LIABILITY									COMBINED SINGLE LIMIT (Ea accident)		\$		
	<div><div></div> ANY AUTO OWNED AUTOS ONLY<div></div> SCHEDULED AUTOS</div>									BODILY INJURY (Per person)		\$		
										BODILY INJURY (Per accident)		\$		
	<div><div></div> HIRED AUTOS ONLY<div></div> NON-OWNED AUTOS ONLY</div>									PROPERTY DAMAGE (Per accident)		\$		
												\$		
												\$		
	UMBRELLA LIAB									EACH OCCURRENCE		\$		
	EXCESS LIAB									AGGREGATE		\$		
	<div><div></div> DEC<div></div> RETENTION \$</div>													
A	WORKERS COMPENSATION AND EMPLOYERS' LIABILITY				Y / N <div></div>	N / A	WC 061149216 NY	07/01/16	07/01/17	<div><div>X</div></div>	PER STATUTE	<div><div></div></div>	OTH-ER	
	ANY PROPRIETOR/PARTNER/EXECUTIVE OFFICER/MEMBER EXCLUDED? (Mandatory in NH)									E.L. EACH ACCIDENT		\$	Unlimited	
	If yes, describe under DESCRIPTION OF OPERATIONS below									E.L. DISEASE - EA EMPLOYEE		\$	Unlimited	
										E.L. DISEASE - POLICY LIMIT		\$	Unlimited	

DESCRIPTION OF OPERATIONS / LOCATIONS / VEHICLES (ACORD 101, Additional Remarks Schedule, may be attached if more space is required)
All worksite employees working for SHERWOOD DESIGN ENGINEERS LTD, paid under ADP TOTALSOURCE, INC's payroll, are covered under the above stated policy.

CERTIFICATE HOLDER

CANCELLATION

Sherwood Design Engineers LTD 58 Maiden Lane 3rd Floor San Francisco, CA 94108	SHOULD ANY OF THE ABOVE DESCRIBED POLICIES BE CANCELLED BEFORE THE EXPIRATION DATE THEREOF, NOTICE WILL BE DELIVERED IN ACCORDANCE WITH THE POLICY PROVISIONS.
	AUTHORIZED REPRESENTATIVE Aon Risk Services, Inc of Florida

© 1988-2015 ACORD CORPORATION. All rights reserved.

CERTIFICATE OF LIABILITY INSURANCE

DATE (MM/DD/YYYY)
04/05/17

THIS CERTIFICATE IS ISSUED AS A MATTER OF INFORMATION ONLY AND CONFERS NO RIGHTS UPON THE CERTIFICATE HOLDER. THIS CERTIFICATE DOES NOT AFFIRMATIVELY OR NEGATIVELY AMEND, EXTEND OR ALTER THE COVERAGE AFFORDED BY THE POLICIES BELOW. THIS CERTIFICATE OF INSURANCE DOES NOT CONSTITUTE A CONTRACT BETWEEN THE ISSUING INSURER(S), AUTHORIZED REPRESENTATIVE OR PRODUCER, AND THE CERTIFICATE HOLDER.

IMPORTANT: If the certificate holder is an ADDITIONAL INSURED, the policy(ies) must have ADDITIONAL INSURED provisions or be endorsed. If SUBROGATION IS WAIVED, subject to the terms and conditions of the policy, certain policies may require an endorsement. A statement on this certificate does not confer rights to the certificate holder in lieu of such endorsement(s).

PRODUCER Aon Risk Services, Inc of Florida 1001 Brickell Bay Drive, Suite #1100 Miami, FL 33131-4937	CONTACT NAME: Aon Risk Services, Inc of Florida	
	PHONE (A/C, No, Ext): 800-743-8130	FAX (A/C, No): 800-522-7514
	EMAIL ADDRESS: ADP.COI.Center@Aon.com	
	INSURER(S) AFFORDING COVERAGE	NAIC #
	INSURER A : New Hampshire Ins Co	23841
INSURED ADP TotalSource FL XVI, Inc. 10200 Sunset Drive Miami, FL 33173 L/C/F Sherwood Design Engineers LTD 58 Maiden Lane 3rd Floor San Francisco, CA 94108	INSURER B :	
	INSURER C :	
	INSURER D :	
	INSURER E :	
	INSURER F :	

COVERAGES CERTIFICATE NUMBER: 1348700 REVISION NUMBER:

THIS IS TO CERTIFY THAT THE POLICIES OF INSURANCE LISTED BELOW HAVE BEEN ISSUED TO THE INSURED NAMED ABOVE FOR THE POLICY PERIOD INDICATED. NOTWITHSTANDING ANY REQUIREMENT, TERM OR CONDITION OF ANY CONTRACT OR OTHER DOCUMENT WITH RESPECT TO WHICH THIS CERTIFICATE MAY BE ISSUED OR MAY PERTAIN, THE INSURANCE AFFORDED BY THE POLICIES DESCRIBED HEREIN IS SUBJECT TO ALL THE TERMS, EXCLUSIONS AND CONDITIONS OF SUCH POLICIES. LIMITS SHOWN MAY HAVE BEEN REDUCED BY PAID CLAIMS. LIMITS SHOWN ARE AS REQUESTED.

INSR LTR	TYPE OF INSURANCE	ADDL INSR	SUBR WVD	POLICY NUMBER	POLICY EFF (MM/DD/YYYY)	POLICY EXP (MM/DD/YYYY)	LIMITS
	COMMERCIAL GENERAL LIABILITY						EACH OCCURRENCE \$
	CLAIMS-MADE OCCUR						DAMAGE TO RENTED PREMISES (Ea occurrence) \$
							MED EXP (Any one person) \$
							PERSONAL & ADV INJURY \$
	GEN'L AGGREGATE LIMIT APPLIES PER:						GENERAL AGGREGATE \$
	POLICY PROJECT LOC						PRODUCTS - COMP/OP AGG \$
	OTHER						\$
	AUTOMOBILE LIABILITY						COMBINED SINGLE LIMIT (Ea accident) \$
	ANY AUTO OWNED AUTOS ONLY						BODILY INJURY (Per person) \$
	HIRED AUTOS ONLY						BODILY INJURY (Per accident) \$
							PROPERTY DAMAGE (Per accident) \$
							\$
	UMBRELLA LIAB						EACH OCCURRENCE \$
	EXCESS LIAB						AGGREGATE \$
	DEC RETENTION \$						
A	WORKERS COMPENSATION AND EMPLOYERS' LIABILITY ANY PROPRIETOR/PARTNER/EXECUTIVE OFFICER/MEMBER EXCLUDED? (Mandatory in NH) If yes, describe under DESCRIPTION OF OPERATIONS below	Y / N	N / A	WC 061146323 NJ	07/01/16	07/01/17	X PER STATUTE OTH-ER E.L. EACH ACCIDENT \$ 2,000,000 E.L. DISEASE - EA EMPLOYEE \$ 2,000,000 E.L. DISEASE - POLICY LIMIT \$ 2,000,000

DESCRIPTION OF OPERATIONS / LOCATIONS / VEHICLES (ACORD 101, Additional Remarks Schedule, may be attached if more space is required)
All worksite employees working for SHERWOOD DESIGN ENGINEERS LTD, paid under ADP TOTALSOURCE, INC's payroll, are covered under the above stated policy.

CERTIFICATE HOLDER

CANCELLATION

Sherwood Design Engineers LTD 58 Maiden Lane 3rd Floor San Francisco, CA 94108	SHOULD ANY OF THE ABOVE DESCRIBED POLICIES BE CANCELLED BEFORE THE EXPIRATION DATE THEREOF, NOTICE WILL BE DELIVERED IN ACCORDANCE WITH THE POLICY PROVISIONS.
	AUTHORIZED REPRESENTATIVE <i>Aon Risk Services, Inc of Florida</i>

CERTIFICATE OF LIABILITY INSURANCE

DATE (MM/DD/YYYY)
04/05/17

THIS CERTIFICATE IS ISSUED AS A MATTER OF INFORMATION ONLY AND CONFERS NO RIGHTS UPON THE CERTIFICATE HOLDER. THIS CERTIFICATE DOES NOT AFFIRMATIVELY OR NEGATIVELY AMEND, EXTEND OR ALTER THE COVERAGE AFFORDED BY THE POLICIES BELOW. THIS CERTIFICATE OF INSURANCE DOES NOT CONSTITUTE A CONTRACT BETWEEN THE ISSUING INSURER(S), AUTHORIZED REPRESENTATIVE OR PRODUCER, AND THE CERTIFICATE HOLDER.

IMPORTANT: If the certificate holder is an ADDITIONAL INSURED, the policy(ies) must have ADDITIONAL INSURED provisions or be endorsed. If SUBROGATION IS WAIVED, subject to the terms and conditions of the policy, certain policies may require an endorsement. A statement on this certificate does not confer rights to the certificate holder in lieu of such endorsement(s).

PRODUCER Aon Risk Services, Inc of Florida 1001 Brickell Bay Drive, Suite #1100 Miami, FL 33131-4937	CONTACT NAME: Aon Risk Services, Inc of Florida	
	PHONE (A/C, No, Ext): 800-743-8130	FAX (A/C, No): 800-522-7514
	EMAIL ADDRESS: ADP.COI.Center@Aon.com	
	INSURER(S) AFFORDING COVERAGE	NAIC #
	INSURER A : New Hampshire Ins Co	23841
INSURED ADP TotalSource FL XVI, Inc. 10200 Sunset Drive Miami, FL 33173 ALTERNATE EMPLOYER Sherwood Design Engineers LTD 58 Maiden Lane 3rd Floor San Francisco, CA 94108	INSURER B :	
	INSURER C :	
	INSURER D :	
	INSURER E :	
	INSURER F :	

COVERAGES CERTIFICATE NUMBER: 1378606 REVISION NUMBER:

THIS IS TO CERTIFY THAT THE POLICIES OF INSURANCE LISTED BELOW HAVE BEEN ISSUED TO THE INSURED NAMED ABOVE FOR THE POLICY PERIOD INDICATED. NOTWITHSTANDING ANY REQUIREMENT, TERM OR CONDITION OF ANY CONTRACT OR OTHER DOCUMENT WITH RESPECT TO WHICH THIS CERTIFICATE MAY BE ISSUED OR MAY PERTAIN, THE INSURANCE AFFORDED BY THE POLICIES DESCRIBED HEREIN IS SUBJECT TO ALL THE TERMS, EXCLUSIONS AND CONDITIONS OF SUCH POLICIES. LIMITS SHOWN MAY HAVE BEEN REDUCED BY PAID CLAIMS. LIMITS SHOWN ARE AS REQUESTED.

INSR LTR	TYPE OF INSURANCE	ADDL INSR	SUBR WVD	POLICY NUMBER	POLICY EFF (MM/DD/YYYY)	POLICY EXP (MM/DD/YYYY)	LIMITS
	COMMERCIAL GENERAL LIABILITY						EACH OCCURRENCE \$
	CLAIMS-MADE OCCUR						DAMAGE TO RENTED PREMISES (Ea occurrence) \$
							MED EXP (Any one person) \$
							PERSONAL & ADV INJURY \$
	GEN'L AGGREGATE LIMIT APPLIES PER:						GENERAL AGGREGATE \$
	POLICY PROJECT LOC						PRODUCTS - COMP/OP AGG \$
	OTHER						\$
	AUTOMOBILE LIABILITY						COMBINED SINGLE LIMIT (Ea accident) \$
	ANY AUTO OWNED AUTOS ONLY						BODILY INJURY (Per person) \$
	HIRED AUTOS ONLY						BODILY INJURY (Per accident) \$
							PROPERTY DAMAGE (Per accident) \$
							\$
	UMBRELLA LIAB						EACH OCCURRENCE \$
	EXCESS LIAB						AGGREGATE \$
	DEC RETENTION \$						
A	WORKERS COMPENSATION AND EMPLOYERS' LIABILITY ANY PROPRIETOR/PARTNER/EXECUTIVE OFFICER/MEMBER EXCLUDED? (Mandatory in NH) If yes, describe under DESCRIPTION OF OPERATIONS below	Y / N	N / A	WC 061139721 TX	07/01/16	07/01/17	X PER STATUTE OTH-ER E.L. EACH ACCIDENT \$ 2,000,000 E.L. DISEASE - EA EMPLOYEE \$ 2,000,000 E.L. DISEASE - POLICY LIMIT \$ 2,000,000

DESCRIPTION OF OPERATIONS / LOCATIONS / VEHICLES (ACORD 101, Additional Remarks Schedule, may be attached if more space is required)
All worksite employees working for SHERWOOD DESIGN ENGINEERS LTD, paid under ADP TOTALSOURCE, INC.'s payroll, are covered under the above stated policy. SHERWOOD DESIGN ENGINEERS LTD is an alternate employer under this policy.

CERTIFICATE HOLDER

CANCELLATION

Sherwood Design Engineers LTD 58 Maiden Lane 3rd Floor San Francisco, CA 94108	SHOULD ANY OF THE ABOVE DESCRIBED POLICIES BE CANCELLED BEFORE THE EXPIRATION DATE THEREOF, NOTICE WILL BE DELIVERED IN ACCORDANCE WITH THE POLICY PROVISIONS.
	AUTHORIZED REPRESENTATIVE <i>Aon Risk Services, Inc of Florida</i>

CERTIFICATE OF LIABILITY INSURANCE

DATE (MM/DD/YYYY)
04/05/17

THIS CERTIFICATE IS ISSUED AS A MATTER OF INFORMATION ONLY AND CONFERS NO RIGHTS UPON THE CERTIFICATE HOLDER. THIS CERTIFICATE DOES NOT AFFIRMATIVELY OR NEGATIVELY AMEND, EXTEND OR ALTER THE COVERAGE AFFORDED BY THE POLICIES BELOW. THIS CERTIFICATE OF INSURANCE DOES NOT CONSTITUTE A CONTRACT BETWEEN THE ISSUING INSURER(S), AUTHORIZED REPRESENTATIVE OR PRODUCER, AND THE CERTIFICATE HOLDER.

IMPORTANT: If the certificate holder is an ADDITIONAL INSURED, the policy(ies) must have ADDITIONAL INSURED provisions or be endorsed. If SUBROGATION IS WAIVED, subject to the terms and conditions of the policy, certain policies may require an endorsement. A statement on this certificate does not confer rights to the certificate holder in lieu of such endorsement(s).

PRODUCER Aon Risk Services, Inc of Florida 1001 Brickell Bay Drive, Suite #1100 Miami, FL 33131-4937	CONTACT NAME: Aon Risk Services, Inc of Florida	
	PHONE (A/C, No, Ext): 800-743-8130	FAX (A/C, No): 800-522-7514
	EMAIL ADDRESS: ADP.COI.Center@Aon.com	
	INSURER(S) AFFORDING COVERAGE	
	NAIC #	
INSURER A : New Hampshire Ins Co		23841
INSURED ADP TotalSource FL XVI, Inc. 10200 Sunset Drive Miami, FL 33173 ALTERNATE EMPLOYER Sherwood Design Engineers LTD 58 Maiden Lane 3rd Floor San Francisco, CA 94108	INSURER B :	
	INSURER C :	
	INSURER D :	
	INSURER E :	
	INSURER F :	

COVERAGES CERTIFICATE NUMBER: 1460256

REVISION NUMBER:

THIS IS TO CERTIFY THAT THE POLICIES OF INSURANCE LISTED BELOW HAVE BEEN ISSUED TO THE INSURED NAMED ABOVE FOR THE POLICY PERIOD INDICATED. NOTWITHSTANDING ANY REQUIREMENT, TERM OR CONDITION OF ANY CONTRACT OR OTHER DOCUMENT WITH RESPECT TO WHICH THIS CERTIFICATE MAY BE ISSUED OR MAY PERTAIN, THE INSURANCE AFFORDED BY THE POLICIES DESCRIBED HEREIN IS SUBJECT TO ALL THE TERMS, EXCLUSIONS AND CONDITIONS OF SUCH POLICIES. LIMITS SHOWN MAY HAVE BEEN REDUCED BY PAID CLAIMS. LIMITS SHOWN ARE AS REQUESTED.

INSR LTR	TYPE OF INSURANCE	ADDL INSR	SUBR WVD	POLICY NUMBER	POLICY EFF (MM/DD/YYYY)	POLICY EXP (MM/DD/YYYY)	LIMITS
	COMMERCIAL GENERAL LIABILITY						EACH OCCURRENCE \$
	CLAIMS-MADE OCCUR						DAMAGE TO RENTED PREMISES (Ea occurrence) \$
							MED EXP (Any one person) \$
							PERSONAL & ADV INJURY \$
	GEN'L AGGREGATE LIMIT APPLIES PER:						GENERAL AGGREGATE \$
	POLICY PROJECT LOC						PRODUCTS - COMP/OP AGG \$
	OTHER						\$
	AUTOMOBILE LIABILITY						COMBINED SINGLE LIMIT (Ea accident) \$
	ANY AUTO OWNED AUTOS ONLY						BODILY INJURY (Per person) \$
	HIRED AUTOS ONLY						BODILY INJURY (Per accident) \$
							PROPERTY DAMAGE (Per accident) \$
							\$
	UMBRELLA LIAB						EACH OCCURRENCE \$
	EXCESS LIAB						AGGREGATE \$
	DEC RETENTION \$						
A	WORKERS COMPENSATION AND EMPLOYERS' LIABILITY ANY PROPRIETOR/PARTNER/EXECUTIVE OFFICER/MEMBER EXCLUDED? (Mandatory in NH) If yes, describe under DESCRIPTION OF OPERATIONS below	Y / N	N / A	WC 061139702 GA	07/06/16	07/01/17	X PER STATUTE OTH-ER E.L. EACH ACCIDENT \$ 2,000,000 E.L. DISEASE - EA EMPLOYEE \$ 2,000,000 E.L. DISEASE - POLICY LIMIT \$ 2,000,000

DESCRIPTION OF OPERATIONS / LOCATIONS / VEHICLES (ACORD 101, Additional Remarks Schedule, may be attached if more space is required)
All worksite employees working for SHERWOOD DESIGN ENGINEERS LTD, paid under ADP TOTALSOURCE, INC.'s payroll, are covered under the above stated policy. SHERWOOD DESIGN ENGINEERS LTD is an alternate employer under this policy.

CERTIFICATE HOLDER

CANCELLATION

Sherwood Design Engineers LTD 58 Maiden Lane 3rd Floor San Francisco, CA 94108	SHOULD ANY OF THE ABOVE DESCRIBED POLICIES BE CANCELLED BEFORE THE EXPIRATION DATE THEREOF, NOTICE WILL BE DELIVERED IN ACCORDANCE WITH THE POLICY PROVISIONS.
	AUTHORIZED REPRESENTATIVE Aon Risk Services, Inc of Florida

CERTIFICATE OF LIABILITY INSURANCE

DATE (MM/DD/YYYY)
04/05/17

THIS CERTIFICATE IS ISSUED AS A MATTER OF INFORMATION ONLY AND CONFERS NO RIGHTS UPON THE CERTIFICATE HOLDER. THIS CERTIFICATE DOES NOT AFFIRMATIVELY OR NEGATIVELY AMEND, EXTEND OR ALTER THE COVERAGE AFFORDED BY THE POLICIES BELOW. THIS CERTIFICATE OF INSURANCE DOES NOT CONSTITUTE A CONTRACT BETWEEN THE ISSUING INSURER(S), AUTHORIZED REPRESENTATIVE OR PRODUCER, AND THE CERTIFICATE HOLDER.

IMPORTANT: If the certificate holder is an ADDITIONAL INSURED, the policy(ies) must have ADDITIONAL INSURED provisions or be endorsed. If SUBROGATION IS WAIVED, subject to the terms and conditions of the policy, certain policies may require an endorsement. A statement on this certificate does not confer rights to the certificate holder in lieu of such endorsement(s).

PRODUCER Aon Risk Services, Inc of Florida 1001 Brickell Bay Drive, Suite #1100 Miami, FL 33131-4937	CONTACT NAME: Aon Risk Services, Inc of Florida	
	PHONE (A/C, No, Ext): 800-743-8130	FAX (A/C, No): 800-522-7514
	EMAIL ADDRESS: ADP.COI.Center@Aon.com	
	INSURER(S) AFFORDING COVERAGE	
	NAIC #	
INSURER A : New Hampshire Ins Co		23841
INSURED ADP TotalSource FL XVI, Inc. 10200 Sunset Drive Miami, FL 33173 L/C/F Sherwood Design Engineers LTD 58 Maiden Lane 3rd Floor San Francisco, CA 94108	INSURER B :	
	INSURER C :	
	INSURER D :	
	INSURER E :	
	INSURER F :	

COVERAGES CERTIFICATE NUMBER: 1536961

REVISION NUMBER:

THIS IS TO CERTIFY THAT THE POLICIES OF INSURANCE LISTED BELOW HAVE BEEN ISSUED TO THE INSURED NAMED ABOVE FOR THE POLICY PERIOD INDICATED. NOTWITHSTANDING ANY REQUIREMENT, TERM OR CONDITION OF ANY CONTRACT OR OTHER DOCUMENT WITH RESPECT TO WHICH THIS CERTIFICATE MAY BE ISSUED OR MAY PERTAIN, THE INSURANCE AFFORDED BY THE POLICIES DESCRIBED HEREIN IS SUBJECT TO ALL THE TERMS, EXCLUSIONS AND CONDITIONS OF SUCH POLICIES. LIMITS SHOWN MAY HAVE BEEN REDUCED BY PAID CLAIMS. LIMITS SHOWN ARE AS REQUESTED.

INSR LTR	TYPE OF INSURANCE	ADDL INSR	SUBR WVD	POLICY NUMBER	POLICY EFF (MM/DD/YYYY)	POLICY EXP (MM/DD/YYYY)	LIMITS
	COMMERCIAL GENERAL LIABILITY						EACH OCCURRENCE \$
	CLAIMS-MADE OCCUR						DAMAGE TO RENTED PREMISES (Ea occurrence) \$
							MED EXP (Any one person) \$
							PERSONAL & ADV INJURY \$
	GEN'L AGGREGATE LIMIT APPLIES PER:						GENERAL AGGREGATE \$
	POLICY PROJECT LOC						PRODUCTS - COMP/OP AGG \$
	OTHER						\$
	AUTOMOBILE LIABILITY						COMBINED SINGLE LIMIT (Ea accident) \$
	ANY AUTO OWNED AUTOS ONLY						BODILY INJURY (Per person) \$
	HIRED AUTOS ONLY						BODILY INJURY (Per accident) \$
							PROPERTY DAMAGE (Per accident) \$
							\$
	UMBRELLA LIAB						EACH OCCURRENCE \$
	EXCESS LIAB						AGGREGATE \$
	DEC RETENTION \$						
A	WORKERS COMPENSATION AND EMPLOYERS' LIABILITY ANY PROPRIETOR/PARTNER/EXECUTIVE OFFICER/MEMBER EXCLUDED? (Mandatory in NH) If yes, describe under DESCRIPTION OF OPERATIONS below	Y / N	N / A	WC 061159982 UT	02/21/17	07/01/17	X PER STATUTE OTH-ER E.L. EACH ACCIDENT \$ 2,000,000 E.L. DISEASE - EA EMPLOYEE \$ 2,000,000 E.L. DISEASE - POLICY LIMIT \$ 2,000,000

DESCRIPTION OF OPERATIONS / LOCATIONS / VEHICLES (ACORD 101, Additional Remarks Schedule, may be attached if more space is required)
All worksite employees working for SHERWOOD DESIGN ENGINEERS LTD, paid under ADP TOTALSOURCE, INC.'s payroll, are covered under the above stated policy.

CERTIFICATE HOLDER

CANCELLATION

Sherwood Design Engineers LTD 58 Maiden Lane 3rd Floor San Francisco, CA 94108	SHOULD ANY OF THE ABOVE DESCRIBED POLICIES BE CANCELLED BEFORE THE EXPIRATION DATE THEREOF, NOTICE WILL BE DELIVERED IN ACCORDANCE WITH THE POLICY PROVISIONS.
	AUTHORIZED REPRESENTATIVE Aon Risk Services, Inc of Florida



WHY