

City of Culver City



OWEN GROUP, INC.
www.owengroup.com

811 Wilshire Boulevard, Suite 1050 Los Angeles, CA 90017
213.873.4700 | July 31, 2017



VOLUME 1 TABLE OF CONTENTS

PART 1 – EXECUTIVE SUMMARY.....	1
1.1 Overview.....	1
1.2 Purpose.....	2
1.3 Legislative Requirements	3
1.4 Summary of this Report.....	5
1.5 City Profile.....	6
1.6 Methodology.....	6
1.7 Definitions.....	9
PART 2 – ADA SELF-EVALUATION.....	13
2.1 Introduction.....	13
2.2 General Recommendations	14
2.3 Evaluation of Services, Programs, and Activities – City-wide.....	16
2.3.1 Public Notice and Written Notifications	16
2.3.2 ADA Coordinator:	17
2.3.3 Grievance Procedures	18
2.3.4 Fees and Surcharges	19
2.3.5 Use of Consultants	19
2.3.6 Access to Programs, Services, and Activities	20
2.3.7 Modifications to Policies, Practices, or Procedures:	20
2.3.8 Public Meetings	21
2.3.9 Equally Effective Communication.....	22
2.3.10 Distribution of Publication	24



2.3.11 Website Accessibility	24
2.3.12 Printed Information	25
2.3.13 Telephones, Communication Devices, and Auxiliary Aids.....	26
2.3.14 Public Input and comments.....	26
2.4 Evaluation of Services, Programs, Activities – Departments	29
2.4.1 Administrative Services Department	29
2.4.2 Fire Department.....	34
2.4.3 Finance Department	38
2.4.4 Park, Recreation and Community Services	43
2.4.5 Police Department.....	48
2.4.6 Transportation Division.....	51
PART 3 – TRANSITION PLAN	56
3.1 Overview.....	56
3.1.1 Summary	56
3.2 Facilities Priorities.....	58
3.3 Sidewalk Assessment.....	60
3.3.1 Overview	60
3.3.2 Methodology	60
3.3.3 Sidewalk Priorities	62
3.3 Phasing and Expenditure Plan.....	63
3.4 Funding for Projects.....	64
3.5 Historical Structures	64
PART 4 – ADA TOOLKIT	65
4.1 Guidelines.....	65



Center for Accessible Technology (CforAT) http://www.cforat.org/	68
Access Board Section 508 guide	70
Section 508 on-line accessible software development training	70
ADA Pacific Center Website Accessibility Resources.....	70
National Organization on Disability (NOD) Resources on Emergency Preparedness.....	71
Earthquake Preparedness Guide for People with Disabilities	71
United States Department of Labor Emergency Preparedness for People with.....	71
Disabilities	71
Department of Labor - Preparing the Workplace for Everyone	71
National Center on Physical Activity and Disability http://www.ncpad.org.....	73



LIST OF APPENDICES

A	City Programs, and Public Questionnaires	Found in Volume 1
B	Facility Barrier Assessment Report	Found in Volume 2
C	PROWAG	Found in Volume 3
	Part 1 PROWAG Sidewalks Barrier Assessment Report	
	Part 2 PROWAG Sidewalks Barrier Assessment Photo Report	
	Part 3 City Maps	
D	Curb Ramps Barrier Assessment Report	Found in Volume 3
E	Intersections Barrier Assessment Report	Found in Volume 3
F	Bus Stops Barrier Assessment Report	Found in Volume 3
G	Policies and Procedures	Found in Volume 1
	Appendix G-1 Grievance Policies and Procedures	
	Appendix G-1: Notice under the Americans with Disabilities Act – ADA	
	Appendix G-2: Grievance Policies and Procedures	
	Appendix G-3: Sample Grievance Procedure	
	Appendix G-4: Assistive Listening Systems	
	Appendix G-5: Employment and ADA	
	Appendix G-6: Reasonable Accommodation Request Form	
	Appendix G-7: Public Meetings	
	Appendix G-8: Public Notice	
	Appendix G-9: Public Event Policy and Checklist	
H	Disability Etiquette	Found in Volume 1
I	Web Accessibility	Found in Volume 1
J	ADA Primer for State and Local Governments	Found in Volume 1
K	ADA Best Practices Toolkit: General Effective Communication Requirement and DOJ Statement on Effective Communication	Found in Volume 1
L	Commonly Asked Questions about the ADA and Law Enforcement	Found in Volume 1



LIST OF ABBREVIATIONS

ADA	Americans with Disabilities Act
ADAAG	Americans with Disabilities Act Accessibility Guidelines
AFF	Above finished floor
ASL	American Sign Language
CASP	Certified Access Specialist
CBC	California Building Code
CBC	California building code
CDBG	Community Development Block Grant
CFR	Code of Federal Regulations
DDS	California Department of Development Services
DF	Drinking fountain
DG	Decomposed granite
DOJ	Department of Justice
DSA	Division of the State Architect
E.V.	Electric vehicle
FE	Fire extinguisher
ft	Foot / Feet
GPS	Global Positioning System
HUD	Housing and Urban Development
I.D.	Identification
ICC	International Code Council
in	inch
ISA	International symbol of accessibility
O.C.	Off center



POT	Path of travel
PROWAG	Public Right of Way Accessibility Guidelines
PSI	Pounds per square inch
TPD	Toilet paper dispenser
TTY	Text telephone
TTY/TDD	Telecommunication Device for the Deaf/TeleTYpewriter
US	United States
WC	Water closet



PART 1 – EXECUTIVE SUMMARY

1.1 OVERVIEW

The City of Culver City is committed to providing their programs, services, and facilities accessible to all without discrimination, and also complying with the Americans with Disabilities Act (ADA) and other federal and state laws, codes and regulations, and Proposed Guidelines for Accessible Rights-of-Way (PROWAG).

Through this ADA Self-Evaluation and Transition Plan, programmatic and physical accessibility barriers were reviewed and identified. It is the intent of the City of Culver City to improve the City-wide and department-specific programmatic and physical accessibility barriers summarized in the following areas:

Polices and Procedures: Establish policies and practices that set City-wide general prohibitions against discrimination on the basis of disability. Refer to Appendix G for sample policies and procedures.

Outreach and Information: Notices, printed materials, televised and audiovisual information, City website, public telephones and communication devices need to be accessible to persons with disabilities. Notices and printed information need to include information on whom to contact to request ADA accommodations and be provided in alternate formats (e.g. large print, closed captioning etc.) upon request. City website needs modifications to meet accessibility guidelines per Appendix I.

Training and Staffing: Continue the mission of the Disability Advisory Committee but raise the current level of training and experience of City staff across City departments in their knowledge of the policies and procedures regarding providing equal access to individuals with disabilities.

Programs and Activities: Continue to provide accessibility in terms of program eligibility and admission, public meetings, tours and trips, transportation services, the use of consultants or contractors to provide City services. Provide emergency evacuation procedures, and perform evaluations of accessibility at special events on City property using the provided checklist in Appendix G-9.

Accessible/Adaptive Equipment: Make available automated electronic equipment and auxiliary aids to assist individuals with disabilities participate in City programs. Refer to the definitions section regarding Auxiliary Aids. Raise the level of awareness among City employees about the location and use of these equipment.

Removal of Physical Barriers: This report establishes a 10-year plan for the removal of physical barriers or obstacles that prevent or restrict the entrance or use of buildings, facilities, and public rights-of-way.

Culver City, California ADA Self Evaluation and Transition Plan

Facility Barrier Assessment Report

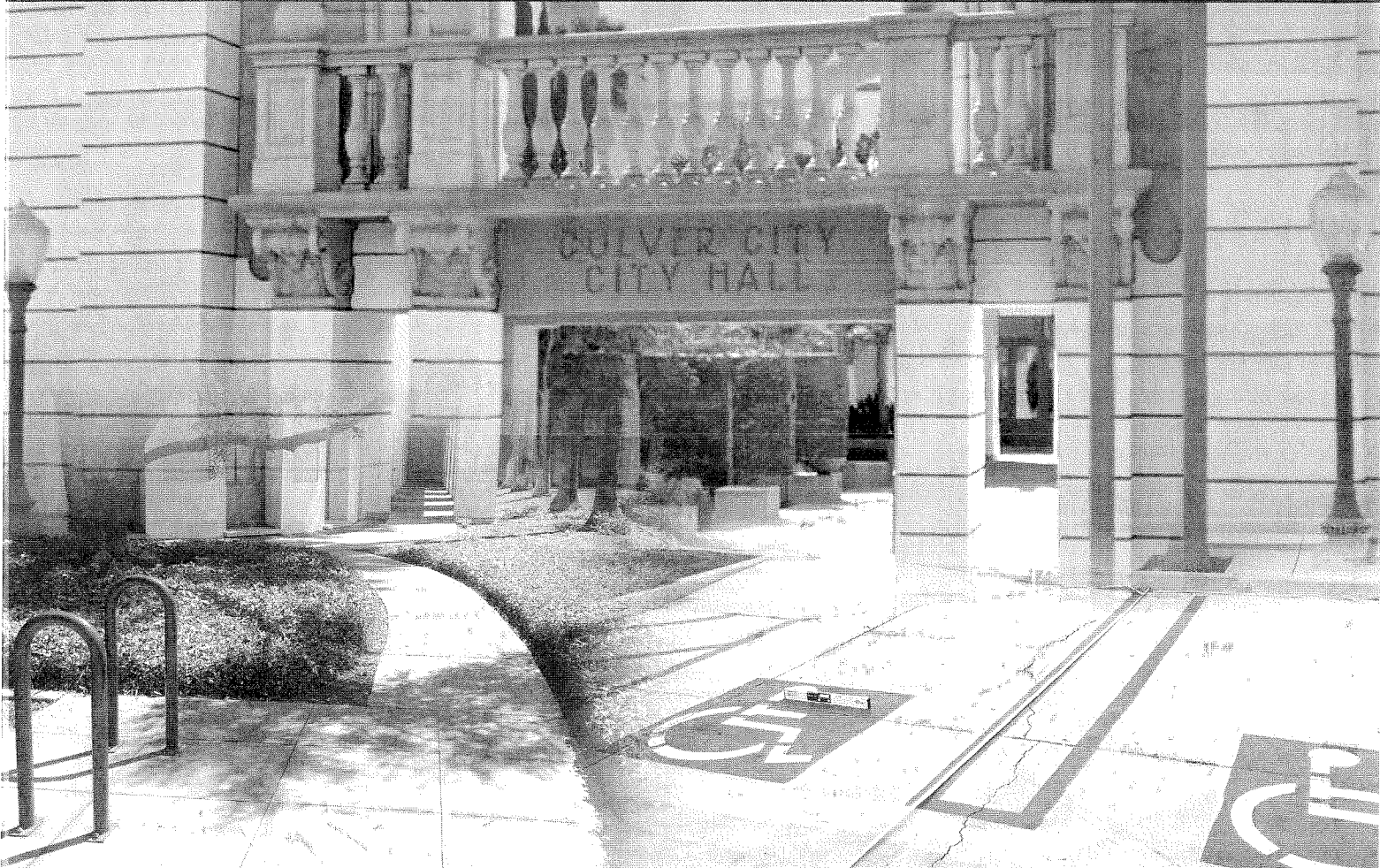

Prepared by:



811 Wilshire Boulevard, Suite 1050
Los Angeles, CA 90017
Tel: 213.873.4700

PRELIMINARY DRAFT

January, 2017

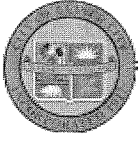
**Total Facility Cost Estimate Summary Table:**

	Estimated Direct Costs	Estimated Project Costs*
Priority 1	\$504,505	\$655,857
Priority 2	\$2,781,373	\$3,615,785
Priority 3	\$262,210	\$340,873
Total	\$3,548,088	\$4,612,514

*Includes 30% soft cost allowance, GC cost & fee, escalation and contingency

Total Facility Cost Estimate Summary Table by Facility:

Facility	Number of Deficiency Items	Estimated Direct Costs	Estimated Project Costs*	Percent of Total
Blair Hills Park	15	\$ 73,820	\$ 95,966	2.08%
Blanco Park	20	\$ 50,420	\$ 65,546	1.42%
Carlson Park	24	\$ 66,600	\$ 86,580	1.88%
City Hall	145	\$ 207,620	\$ 269,906	5.85%
City Yard/Env. Management	25	\$ 25,635	\$ 33,326	0.72%
Coombs Parkette	2	\$ 10,270	\$ 13,351	0.29%
Culver City Park	132	\$ 489,805	\$ 636,747	13.80%
Culver City West Park	71	\$ 108,705	\$ 141,317	3.06%
El Marino Park	28	\$ 60,115	\$ 78,150	1.69%
Fire Drill Yard	24	\$ 43,885	\$ 57,051	1.24%
Fire Station 1	17	\$ 8,080	\$ 10,504	0.23%
Fire Station 2	16	\$ 11,980	\$ 15,574	0.34%
Fire Station 3	10	\$ 8,220	\$ 10,686	0.23%
Fox Hills Park	60	\$ 631,683	\$ 821,188	17.80%
Fox Hills Parkette	4	\$ 65,875	\$ 85,638	1.86%
Ivy Station and Media Park	15	\$ 23,675	\$ 30,778	0.67%
Lindberg Park	70	\$ 180,040	\$ 234,052	5.07%
National Mini Park	1	\$ 2,250	\$ 2,925	0.06%
Paddle Tennis Park	12	\$ 20,440	\$ 26,572	0.58%
Police Department	67	\$ 96,365	\$ 125,275	2.72%
Senior Center	39	\$ 49,965	\$ 64,955	1.41%
Syd Kronenthal Park	79	\$ 219,700	\$ 285,610	6.19%
Teen Center	47	\$ 56,680	\$ 73,684	1.60%
Tellefson Park	12	\$ 9,720	\$ 12,636	0.27%
The Plunge	30	\$ 81,585	\$ 106,061	2.30%
Transfer Station	7	\$ 12,355	\$ 16,062	0.35%
Transportation/Purchasing	23	\$ 41,485	\$ 53,931	1.17%
Veterans Center	88	\$ 147,805	\$ 192,147	4.17%
Veteran's Memorial	112	\$ 626,895	\$ 814,964	17.67%
Veterans Park	34	\$ 116,415	\$ 151,340	3.28%
Grand Total	1229	\$ 3,548,088	\$ 4,612,514	100.00%

*Includes 30% soft cost allowance, GC cost & fee, escalation and contingency

1/17/2017



FACILITY: BLAIR HILLS PARK

Estimated Cost Summary Table:

	Estimated Direct Costs	Estimated Project Costs*
Priority 1	\$18,390	\$23,907
Priority 2	\$55,340	\$71,942
Priority 3	\$90	\$117
Total	\$73,820	\$95,966

*Includes 30% soft cost allowance, GC cost & fee, escalation and contingency

Comment **BHP-01** **Priority:2** **Estimated Direct Cost:** \$250 **Contractor**



Item Description: Approach and Entrance
Exterior Access Route
Width

Findings:

The route is less than 48 inches wide.

Recommendations:

Remove obstacles to create a minimum 48 inch wide circulation path.
Widen the gate posts.

Code References: CBC 11B-403.5.1

Facility: Blair Hills Park
Floor/Area: N/A
Room/Spot: Gate

Comment **BHP-02** **Priority:1** **Estimated Direct Cost:** \$90 **Maintenance**

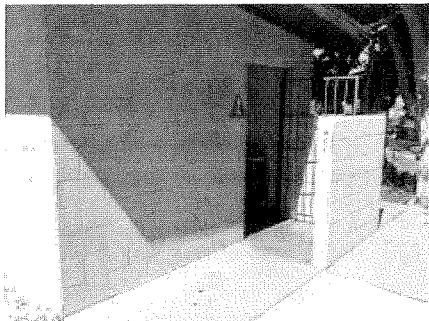

Item Description: Public Toilet Rooms
Signs
Tactile Sign

Findings:

A tactile wall sign, identifying the public restroom is not provided.

Recommendations:

Install new tactile wall sign providing raised character text and Braille.
Locate sign at latch side of door.

Code References: CBC 11B-703.1

Facility: Blair Hills Park
Floor/Area: N/A
Room/Spot: Men's Restrooms

**Total Estimated Cost Summary Table by Priority:**

	Estimated Direct Costs	Estimated Project Costs*
Priority 1	\$4,653,768	\$6,049,898
Priority 2	\$13,919,977	\$18,095,969
Priority 3	\$15,497,588	\$20,146,864
Total	\$34,071,332	\$44,292,731

*Includes 30% soft cost allowance, GC cost & fee, escalation and contingency

STREET NAME: ADAMS BLVD

Between Washington and Hines

Street ID: X0001 Type: Sidewalk Segment

Segment ID: SS-0001 Description: Compliant

Estimated Cost: \$0

Findings: Priority: N/A

Both the cross slope and the width of the sidewalk are compliant between the approximate GPS coordinates 34.032936, -118.372819 and 34.032540, -118.371775.

Recommendations:

No action is required for approximately 347 feet of sidewalk.

SS-0001 Total Cost Estimate: \$0

STREET NAME: AGUSTIN LN

Between Ballona Ln and Heritage

Street ID: X0002 Type: Sidewalk Segment

Segment ID: SS-0002 Description: Compliant

Estimated Cost: \$0

Findings: Priority: N/A

Both the cross slope and the width of the sidewalk are compliant between the approximate GPS coordinates 33.998569, -118.398576 and 33.998362, -118.397954.

Recommendations:

No action is required for approximately 203 feet of sidewalk.

SS-0002 Total Cost Estimate: \$0

STREET NAME: AGUSTIN LN

Between Heritage and Ballona Ln

Street ID: X0003 Type: Sidewalk Segment

Segment ID: SS-0003 Description: Unimproved

Estimated Cost: \$0

Findings: Priority: N/A

There is no pedestrian path of travel between the approximate GPS coordinates 33.998456, -118.397986 and 33.998619, -118.398418.

Recommendations:

No action is required for approximately 144 feet of sidewalk.

SS-0003 Total Cost Estimate: \$0

STREET NAME: ALBRIGHT AVE

Between City limits and Matteson

Street ID: X0004 Type: Sidewalk Segment

Segment ID: SS-0004 Description: Barrier Items (1)

Estimated Cost: \$0

Findings: Priority: 3

Both the cross slope and the width of the sidewalk are compliant between the approximate GPS coordinates 34.010748, -118.420407 and 34.009295, -118.419250 but has 1 barrier items.

Recommendations:

Correct the itemized access barriers (1) for approximately 635 feet of sidewalk.

Barrier ID: B-0006

Type: Driveway Landing

Estimated Costs: \$7,220

Priority: 3

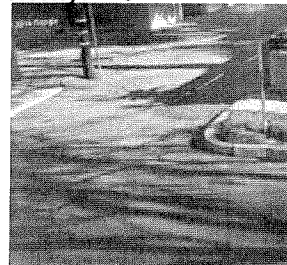
**Findings:**

Driveway is not ADA compliant and does not provide a level passing lane for pedestrian traffic.

Recommendations:

Remove and dispose of concrete. Replace with compliant driveway including a minimum 4 ft wide level passing lane for pedestrian right of way.

Street: Albright Ave

City limits

Between: Matteson

34.010545

GPS: -118.420244

SS-0004**\$7,220**

2/1/2017

**ALBRIGHT AVE
SIDEWALK BARRIERS**

STREET NAME: ALBRIGHT AVE

Between Washington blvd and

Herbert

Street ID: X0005 **Type:** Sidewalk Segment**Segment ID:** SS-0009 **Description:** Compliant**Estimated Cost:** \$0**Findings:** **Priority:** N/A

Both the cross slope and the width of the sidewalk are compliant between the approximate GPS coordinates 34.004356, -118.415860 and 34.003387, -118.415130.

Recommendations:

No action is required for approximately 417 feet of sidewalk.

Barrier ID: B-0005**Type:** Obstruction**Item:** Tree Roots**Estimated Costs:** \$3,330**Priority:** 1**Findings:**

Tree roots have raised sidewalk impeding the pedestrian access route.

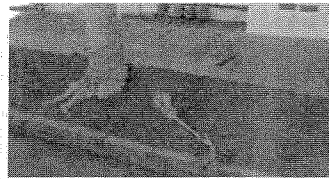
**Recommendations:**

Cut roots or remove tree as needed. Remove, dispose and replace damaged concrete.

Street: Albright Ave

Herbert

Between: Washington pl

34.006479

GPS: -118.417234**SS-0009 Total Cost Estimate:** \$0**SS-0006****\$62,510****STREET NAME: ALBRIGHT AVE**

Between Herbert and Washington pl

Street ID: X0006 **Type:** Sidewalk Segment**Segment ID:** SS-0006 **Description:** Cross Slope and Barrier Items (2)**Estimated Cost:** \$51,960**Findings:** **Priority:** 2

The cross slope exceeds the allowable 2% grade between the approximate GPS coordinates 34.004484, -118.416024 and 34.006588, -118.417353. Additional barrier items (2) were found.

Recommendations:

Remove and dispose of approximately 866 feet of sidewalk. Regrade and replace cement so that the new cross slope does not exceed the allowable 2% grade. Correct the itemized access barriers (2).

Barrier ID: B-0004**Type:** Driveway Landing**Estimated Costs:** \$7,220**Priority:** 2**Findings:**

Driveway is not ADA compliant and does not provide a level passing lane for pedestrian traffic.

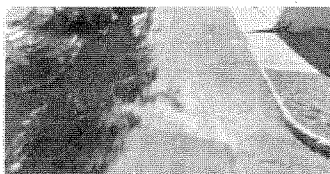
**Recommendations:**

Remove and dispose of concrete. Replace with compliant driveway including a minimum 4 ft wide level passing lane for pedestrian right of way.

Street: Albright Ave

Herbert

Between: Washington pl

34.006351

GPS: -118.417151**STREET NAME: ALBRIGHT AVE**

Between Washington pl and Herbert

Street ID: X0007 **Type:** Sidewalk Segment**Segment ID:** SS-0010 **Description:** Cross Slope and Barrier Items (1)**Estimated Cost:** \$52,320**Findings:** **Priority:** 2

The cross slope exceeds the allowable 2% grade between the approximate GPS coordinates 34.006648, -118.417226 and 34.004549, -118.415849. Additional barrier items (1) were found.

Recommendations:

Remove and dispose of approximately 872 feet of sidewalk. Regrade and replace cement so that the new cross slope does not exceed the allowable 2% grade. Correct the itemized access barriers (1).

Barrier ID: B-0001**Type:** Driveway Landing**Estimated Costs:** \$7,220**Priority:** 2**Findings:**

Driveway is not ADA compliant and does not provide a level passing lane for pedestrian traffic.

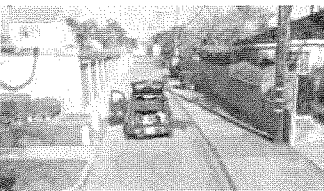
**Recommendations:**

Remove and dispose of concrete. Replace with compliant driveway including a minimum 4 ft wide level passing lane for pedestrian right of way.

Street: Albright Ave

Washington pl

Between: Herbert

34.006407

GPS: -118.417064**SS-0010****\$59,540****OWEN**

2/1/2017

**ALBRIGHT AVE
SIDEWALK BARRIERS**

STREET NAME: ALBRIGHT AVE

Between Herbert and Washington blvd

Street ID: X0008 **Type:** Sidewalk Segment**Segment ID:** SS-0005 **Description:** Barrier Items (2)**Estimated Cost:** \$0**Findings:** **Priority:** 2

Both the cross slope and the width of the sidewalk are compliant between the approximate GPS coordinates 34.004373, -118.415751 and 34.003886, -118.415452 but has 2 barrier items.

Recommendations:

Correct the itemized access barriers (2) for approximately 199 feet of sidewalk.

Barrier ID: B-0002
Type: Driveway Landing

Estimated Costs: \$7,220
Priority: 2



Street: Albright Ave
Between: Herbert
Washington blvd

Barrier ID: B-0003
Type: Obstruction
Item: Surface Discontinuity
Estimated Costs: \$240
Priority: 2

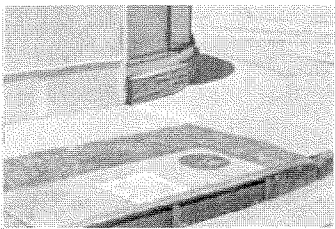

Street: Albright Ave
Between: Herbert
Washington blvd

SS-0005**Findings:**

Driveway is not ADA compliant and does not provide a level passing lane for pedestrian traffic.

Recommendations:

Remove and dispose of concrete. Replace with compliant driveway including a minimum 4 ft wide level passing lane for pedestrian right of way.

GPS: 34.003887
-118.415453

Findings:

The clear path of travel is either chipped, cracked or broken; obstructing the pedestrian access route.

Recommendations:

Remove and dispose of concrete. Regrade and replace path to provide a level, smooth and continuous surface for pedestrian right of way.

GPS: 34.003664
-118.415285

\$7,460**STREET NAME: ALBRIGHT AVE**

Between Matteson and Venice

Street ID: X0009 **Type:** Sidewalk Segment**Segment ID:** SS-0007 **Description:** Compliant**Estimated Cost:** \$0**Findings:** **Priority:** N/A

Both the cross slope and the width of the sidewalk are compliant between the approximate GPS coordinates 34.009067, -118.419110 and 34.010835, -118.420505.

Recommendations:

No action is required for approximately 771 feet of sidewalk.

SS-0007 Total Cost Estimate: \$0**STREET NAME: ALBRIGHT AVE**

Between Matteson and Washington pl

Street ID: X0010 **Type:** Sidewalk Segment**Segment ID:** SS-0008 **Description:** Cross Slope and Barrier Items (8)**Estimated Cost:** \$55,980**Findings:** **Priority:** 3

The cross slope exceeds the allowable 2% grade between the approximate GPS coordinates 34.009061, -118.419108 and 34.0069255, -118.4174123. Additional barrier items (8) were found.

Recommendations:

Remove and dispose of approximately 933 feet of sidewalk. Regrade and replace cement so that the new cross slope does not exceed the allowable 2% grade. Correct the itemized access barriers (8).

Barrier ID: B-0009
Type: Obstruction
Item: Surface Discontinuity
Estimated Costs: \$0
Priority: 3

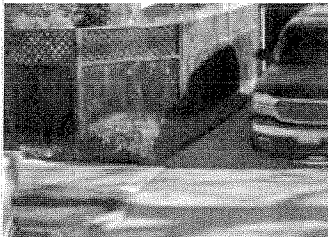

Street: Albright Ave
Between: Matteson
Washington pl

Findings:

The clear path of travel is either chipped, cracked or broken; obstructing the pedestrian access route.

Recommendations:

Costs for removal and replacement of concrete are included in Sidewalk Segment Estimated Costs. No additional action is necessary.

GPS: 34.008866
-118.418951

**Total Curb Ramp Cost Estimate Summary Table:**

	Estimated Direct Costs	Estimated Project Costs*
Priority 1	\$1,254,240	\$1,630,512
Priority 2	\$1,222,080	\$1,588,704
Total	\$2,476,320	\$3,219,216

*Includes 30% soft cost allowance, GC cost & fee, escalation and contingency

Ramp ID: R-001 **Priority: 2** **Estimated Direct Cost:** \$4,020 **Status:** Noncompliant



Ramp Landing 3 ft
Cross Slope 0.1 %
Running Slope 7.6 %
Ramp Width 4 ft

Reason for Noncompliance

A Detectable Warning Surface is Not Provided

Recommendation

Demolish and dispose of existing ramp and materials. Replace with ADA compliant curb ramp.

Street: A St
Cross Street: Irving Pl

GPS: 34.022604
-118.394322

Ramp ID: R-002 **Priority: 2** **Estimated Direct Cost:** \$4,020 **Status:** Noncompliant



Ramp Landing 4 ft
Cross Slope 0.2 %
Running Slope 7.9 %
Ramp Width 4 ft

Reason for Noncompliance

A Detectable Warning Surface is Not Provided

Recommendation

Demolish and dispose of existing ramp and materials. Replace with ADA compliant curb ramp.

Street: A St
Cross Street: Irving Pl

GPS: 34.022522
-118.394183



Ramp ID: R-003 Priority: 2 Estimated Direct Cost: \$4,020 Status: Noncompliant

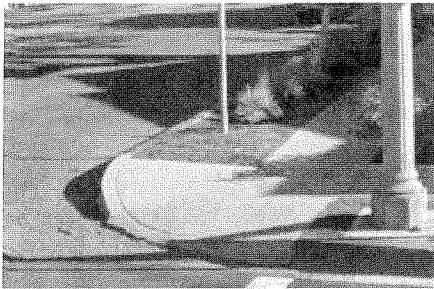

Ramp Landing 1 ft
Cross Slope 0.3 %
Running Slope 7.9 %
Ramp Width 4 ft

Reason for Noncompliance

A 3 ft Level Landing is Not Provided
A Detectable Warning Surface is Not Provided

Recommendation

Demolish and dispose of existing ramp and materials. Replace with ADA compliant curb ramp.

Street: Albright Ave
Cross Street: Matteson Ave

GPS: 34.009090
-118.419134

Ramp ID: R-004 Priority: 2 Estimated Direct Cost: \$4,020 Status: Noncompliant

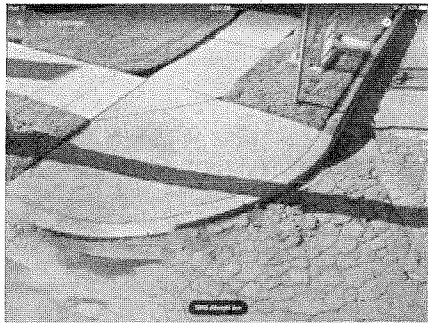

Ramp Landing 2 ft
Cross Slope 0.2 %
Running Slope 8.2 %
Ramp Width 4 ft

Reason for Noncompliance

A 3 ft Level Landing is Not Provided
A Detectable Warning Surface is Not Provided

Recommendation

Demolish and dispose of existing ramp and materials. Replace with ADA compliant curb ramp.

Street: Albright Ave
Cross Street: Matteson Ave

GPS: 34.0090181
-118.419283

Ramp ID: R-005 Priority: 1 Estimated Direct Cost: \$4,020 Status: Noncompliant

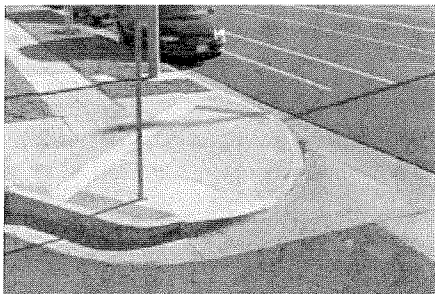

Ramp Landing 3 ft
Cross Slope 0.4 %
Running Slope 8.1 %
Ramp Width 4 ft

Reason for Noncompliance

A Detectable Warning Surface is Not Provided

Recommendation

Demolish and dispose of existing ramp and materials. Replace with ADA compliant curb ramp.

Street: Albright Ave
Cross Street: Washington Pl

GPS: 34.0068893
-118.417392



Ramp ID: R-006 Priority: 1

Estimated Direct Cost: \$4,020

Status: Noncompliant

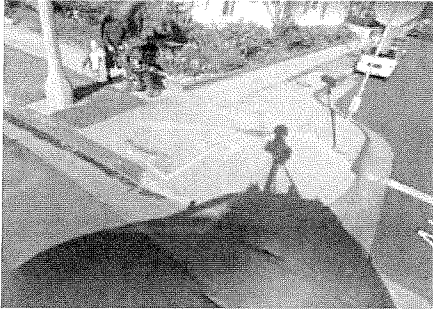

Ramp Landing 3 ft
Cross Slope 0.3 %
Running Slope 7.4 %
Ramp Width 4 ft

Reason for Noncompliance

A Detectable Warning Surface is Not Provided

Recommendation

Demolish and dispose of existing ramp and materials. Replace with ADA compliant curb ramp.

Street: Albright Ave
Cross Street: Washington Pl

GPS: 34.0068223
-118.41752

Ramp ID: R-007 Priority: 2

Estimated Direct Cost: \$4,020

Status: Noncompliant

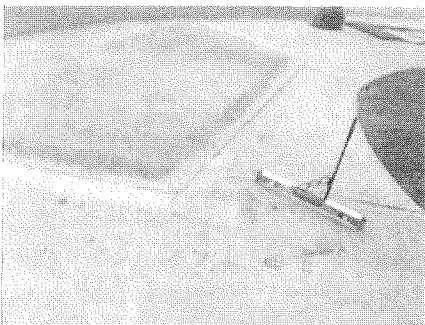

Ramp Landing 2 ft
Cross Slope 0.9 %
Running Slope 9.5 %
Ramp Width 4 ft

Reason for NoncomplianceThe Running Slope Exceeds 8.33% Grade
A 3 ft Level Landing is Not Provided**Recommendation**

Demolish and dispose of existing ramp and materials. Replace with ADA compliant curb ramp.

Street: Aletta Ave
Cross Street: Elenda St

GPS: 34.010611
-118.406706

Ramp ID: R-008 Priority: 2

Estimated Direct Cost: \$4,020

Status: Noncompliant



Ramp Landing 0 ft
Cross Slope 0.6 %
Running Slope 12.8 %
Ramp Width 4 ft

Reason for NoncomplianceThe Running Slope Exceeds 8.33% Grade
A 3 ft Level Landing is Not Provided**Recommendation**

Demolish and dispose of existing ramp and materials. Replace with ADA compliant curb ramp.

Street: Aletta Ave
Cross Street: Elenda St

GPS: +34.010538
-118.406585

**Total Intersection Cost Estimate Summary Table:**

Cross Streets	Number of Signalized	Estimated Direct Costs	Estimated Project Costs*	Percent of Total
Culver Blvd	11	\$ 138,250.00	\$ 179,725.00	14.22%
Duquesne Ave	2	\$ 33,920.00	\$ 44,096.00	3.49%
Elenda St	2	\$ 18,200.00	\$ 23,660.00	1.87%
Huron Ave	1	\$ 500.00	\$ 650.00	0.05%
Madison Ave	1	\$ 25,650.00	\$ 33,345.00	2.64%
Main St	1	\$ 25,560.00	\$ 33,228.00	2.63%
Motor Ave	1	\$ 25,560.00	\$ 33,228.00	2.63%
Overland Ave	1	\$ 500.00	\$ 650.00	0.05%
Sawtelle Blvd	1	\$ 8,360.00	\$ 10,868.00	0.86%
Sepulveda Blvd	1	\$ -	\$ -	0.00%
Hannum Ave	4	\$ 94,650.00	\$ 123,045.00	9.74%
Bristol Pkwy	1	\$ 25,650.00	\$ 33,345.00	2.64%
Buckingham Pkwy	1	\$ 25,650.00	\$ 33,345.00	2.64%
Fox Hills Dr	1	\$ 17,700.00	\$ 23,010.00	1.82%
Uplander Way	1	\$ 25,650.00	\$ 33,345.00	2.64%
Hayden Pl	2	\$ 26,060.00	\$ 33,878.00	2.68%
Higuera	1	\$ 17,700.00	\$ 23,010.00	1.82%
National Blvd	1	\$ 8,360.00	\$ 10,868.00	0.86%
Jefferson Blvd	10	\$ 188,850.00	\$ 245,505.00	19.43%
College Blvd	1	\$ 17,200.00	\$ 22,360.00	1.77%
Cota St	1	\$ 25,560.00	\$ 33,228.00	2.63%
Duquesne Ave	1	\$ 17,700.00	\$ 23,010.00	1.82%
Hetzler Rd	1	\$ -	\$ -	0.00%
Indian Wood	1	\$ 25,560.00	\$ 33,228.00	2.63%
Kinston Ave	1	\$ 25,560.00	\$ 33,228.00	2.63%
Machado Rd	1	\$ 17,700.00	\$ 23,010.00	1.82%
Overland Ave	1	\$ 8,360.00	\$ 10,868.00	0.86%
Raintree Cir	1	\$ 25,560.00	\$ 33,228.00	2.63%
Summertime Ln	1	\$ 25,650.00	\$ 33,345.00	2.64%
Overland Ave	10	\$ 181,490.00	\$ 235,937.00	18.67%
Braddock Dr	1	\$ 17,700.00	\$ 23,010.00	1.82%
Clarmon Pl	1	\$ 25,560.00	\$ 33,228.00	2.63%
Culver Blvd	1	\$ 500.00	\$ 650.00	0.05%
Farragut Dr	1	\$ 25,560.00	\$ 33,228.00	2.63%
Freshman Dr	1	\$ 17,200.00	\$ 22,360.00	1.77%
Jefferson Blvd	1	\$ 8,360.00	\$ 10,868.00	0.86%
Maytime Ln	1	\$ 17,700.00	\$ 23,010.00	1.82%
Palm Ct Way	1	\$ 25,560.00	\$ 33,228.00	2.63%
Sawtelle Blvd	1	\$ 17,700.00	\$ 23,010.00	1.82%
Virginia Ave	1	\$ 25,650.00	\$ 33,345.00	2.64%

**Total Intersection Cost Estimate Summary Table:**

Cross Streets	Number of Signalized	Estimated Direct Costs	Estimated Project Costs*	Percent of Total
Sepulveda Blvd	6	\$ 50,730.00	\$ 65,949.00	5.22%
Barryman Ave	1	\$ 25,650.00	\$ 33,345.00	2.64%
Green Valley Cir	1	\$ 8,360.00	\$ 10,868.00	0.86%
Jefferson Blvd	1	\$ -	\$ -	0.00%
Machado Rd	1	\$ 8,360.00	\$ 10,868.00	0.86%
Sawtelle Blvd	1	\$ -	\$ -	0.00%
Slauson Ave	1	\$ 8,360.00	\$ 10,868.00	0.86%
Slauson Ave	5	\$ 42,780.00	\$ 55,614.00	4.40%
Bristol Pkwy	1	\$ 8,360.00	\$ 10,868.00	0.86%
Buckingham Pkwy	1	\$ 500.00	\$ 650.00	0.05%
Hannum Ave	1	\$ -	\$ -	0.00%
Mall Entrance	1	\$ 8,360.00	\$ 10,868.00	0.86%
Marina Fwy	1	\$ 25,560.00	\$ 33,228.00	2.63%
Washington Blvd	23	\$ 249,190.00	\$ 323,947.00	25.64%
Adams Blvd /Comey Blvd	1	\$ 25,650.00	\$ 33,345.00	2.64%
Clairington Ave / Madison Ave	1	\$ 8,360.00	\$ 10,868.00	0.86%
Culver Blvd	1	\$ 17,200.00	\$ 22,360.00	1.77%
Culver Center	1	\$ 8,360.00	\$ 10,868.00	0.86%
Duquesne Ave	1	\$ 17,200.00	\$ 22,360.00	1.77%
Elenda Ave	1	\$ 8,360.00	\$ 10,868.00	0.86%
Fairfax Ave	1	\$ 17,700.00	\$ 23,010.00	1.82%
Girard Ave	1	\$ 8,360.00	\$ 10,868.00	0.86%
Harter Ave	1	\$ -	\$ -	0.00%
Helm Ave	1	\$ 25,650.00	\$ 33,345.00	2.64%
Higuera St	1	\$ -	\$ -	0.00%
Ince Blvd	1	\$ 500.00	\$ 650.00	0.05%
Jasmine Ave	1	\$ 25,650.00	\$ 33,345.00	2.64%
LaCienega Ave	1	\$ 17,200.00	\$ 22,360.00	1.77%
Landmark St	1	\$ -	\$ -	0.00%
McManus Ave	1	\$ 25,650.00	\$ 33,345.00	2.64%
National Blvd	1	\$ -	\$ -	0.00%
Overland Ave	2	\$ 42,850.00	\$ 55,705.00	4.41%
Sawtelle	1	\$ 500.00	\$ 650.00	0.05%
Sepulveda Blvd	1	\$ -	\$ -	0.00%
Tilden Ave	1	\$ -	\$ -	0.00%
Wesley St	1	\$ -	\$ -	0.00%
Wesley St	1	\$ -	\$ -	0.00%
National Blvd	1	\$ -	\$ -	0.00%
Grand Total	72	\$ 972,000.00	\$ 1,263,600.00	100.00%

*Includes 30% Soft cost allowance, GC cost and fee, escalation and contingency

**Street:** Culver Blvd**Cost Estimate Total:** \$138,250**Intersection ID:** I-17**Priority:** 1**Estimated Direct Cost:** \$25,560**Status:** Noncompliant**Striping:** Faded**Findings:**Faded Crosswalk Stripe
Wrong Push Button**Ramp
Landing:** = 48 in**Recommendations:**

Repaint the crosswalk lines to provide a minimum 48 inch landing space at the base of each curb ramp. Remove and replace crosswalk push buttons with ADA Compliant push buttons.

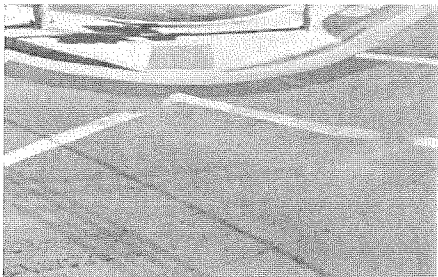
**Push
Button:** Noncompliant**Street:** Culver Blvd**Latitude:** 34.0169841**Cross Street:** Motor Ave**Longitude:** -118.400240**Intersection ID:** I-21**Priority:** 1**Estimated Direct Cost:** \$8,360**Status:** Noncompliant**Striping:** Faded**Findings:**

Faded Crosswalk Stripe

**Ramp
Landing:** = 48 in**Recommendations:**

Repaint the crosswalk lines to provide a minimum 48 inch landing space at the base of each curb ramp.

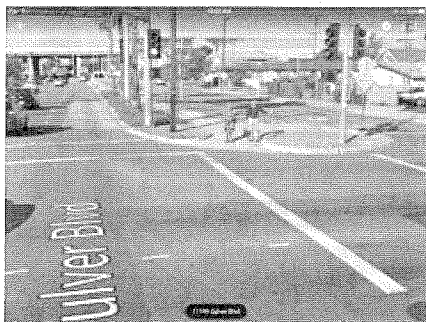
**Push
Button:** Compliant**Street:** Culver Blvd**Latitude:** +34.002390**Cross Street:** Sawtelle Blvd**Longitude:** -118.411812**Intersection ID:** I-22**Priority:** 1**Estimated Direct Cost:** \$0**Status:** Compliant**Striping:** Visible**Findings:**

N/A

**Ramp
Landing:** = 48 in**Recommendations:**

N/A

**Push
Button:** Compliant**Street:** Culver Blvd**Latitude:** +34.004709**Cross Street:** Sepulveda Blvd**Longitude:** -118.409994