

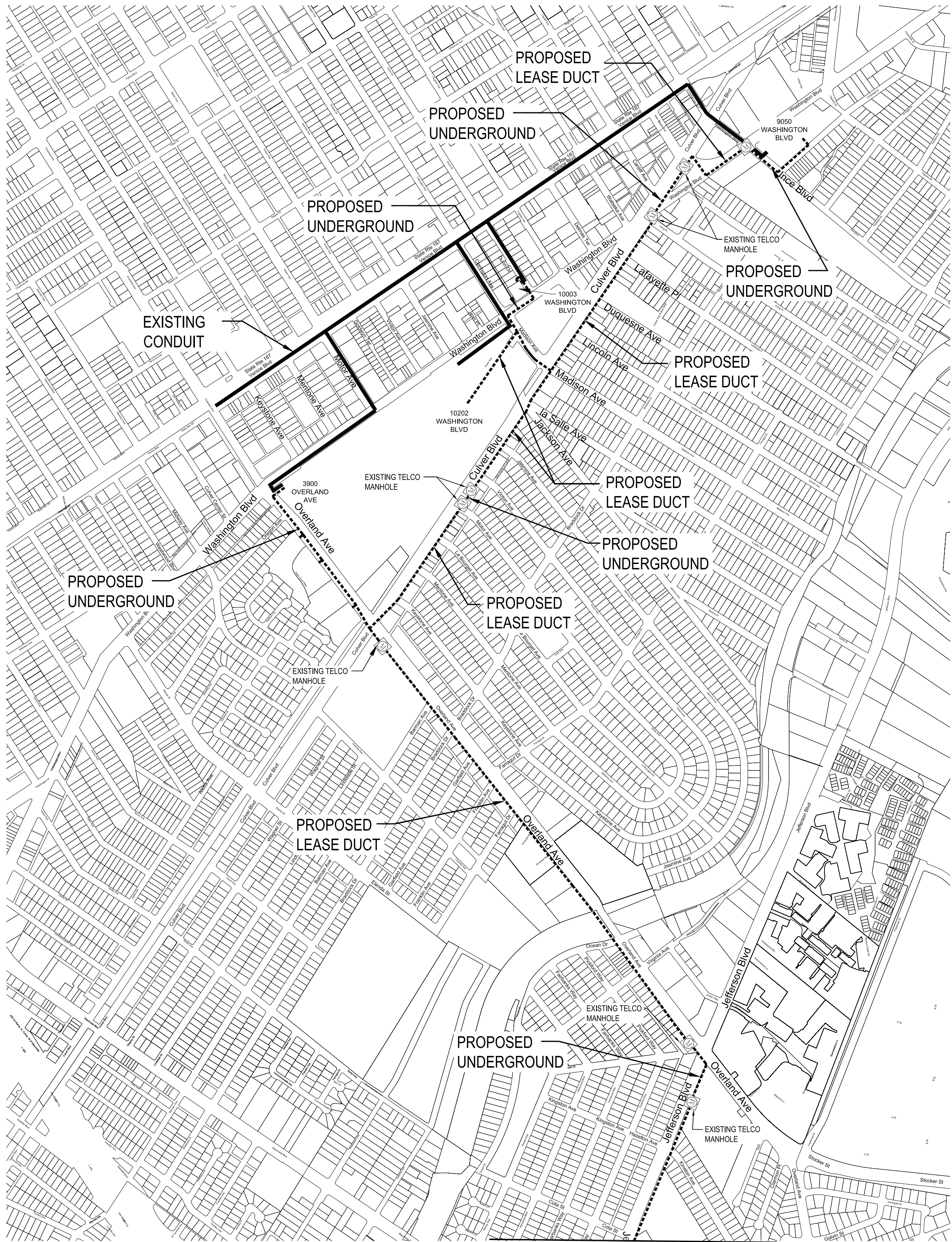

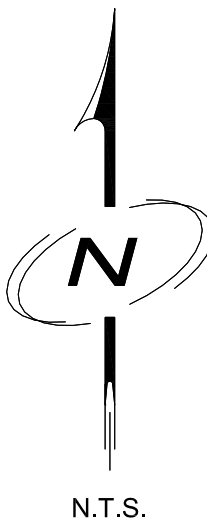

ZAYO  
KEY MAP  
SONY STUDIOS

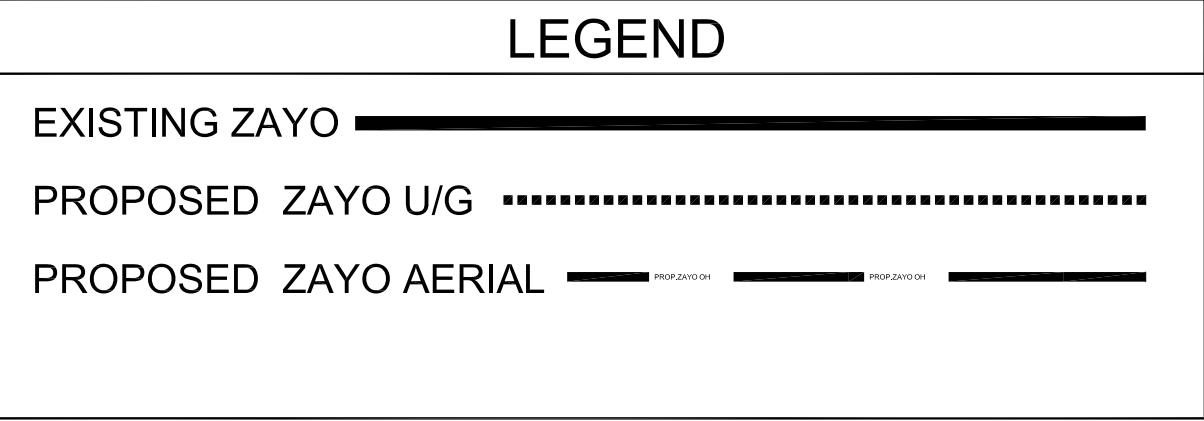
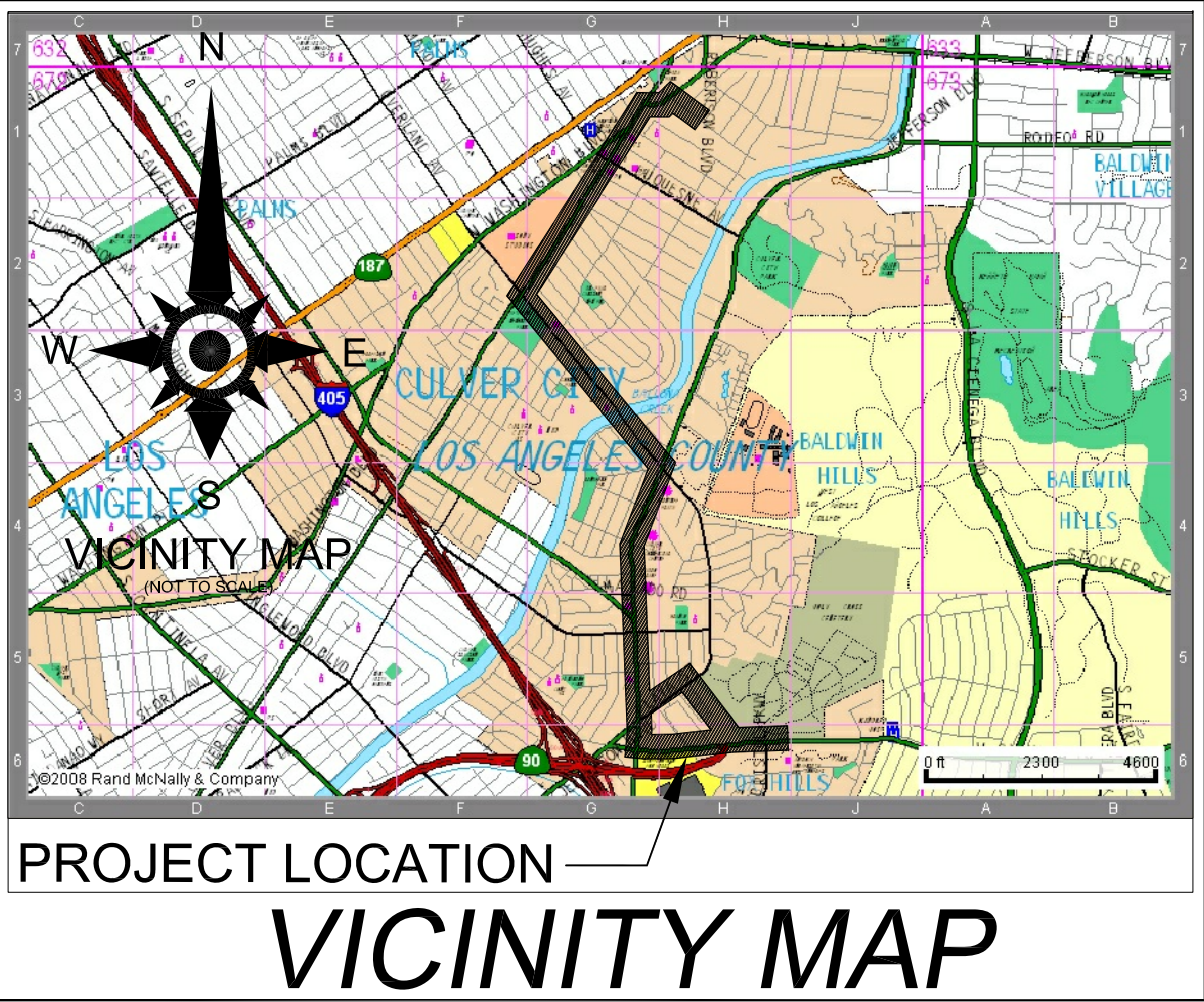
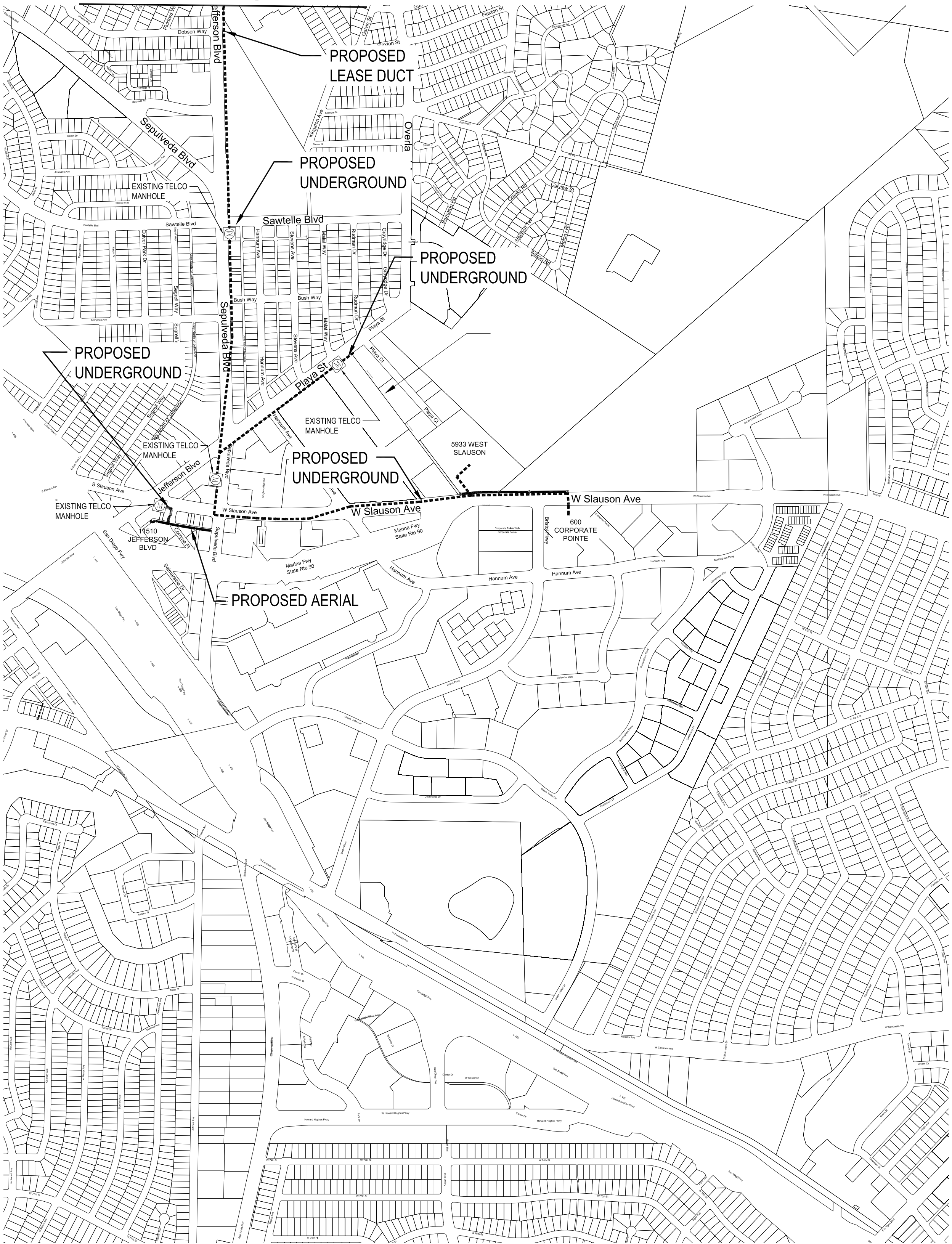

MATCHLINE @ A-A  
SEE ABOVE RIGHT

SEE BELOW LEFT  
MATCHLINE @ A-A

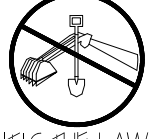

<b>DESIGNED BY.....</b>		<b>PLAN REVISIONS:</b>	
	290 CORPORATE TERRACE CIRCLE STE. 200, CORONA, CA 92879	REV #	DATE
	WWW.KBENG.NET TEL. 951-808-9501 FAX. 951-808-9518	DESCRIPTION	INT
		<b>DIGALERT</b> CALL TOLL FREE 48 HOURS BEFORE YOU DIG UNDERGROUND SERVICE ALERT PHONE NO. 811	
		<b>CITY OF CULVER</b>	
		<b>EXHIBIT</b>	



**SEE SHEET 3  
MATCHLINE A-A**

**5933 WEST SLAUSON**

PROPOSED STUB TO PROPERTY

**9'± PROPOSED NEW UC**

PROPOSED 2'X3' ZAYO PULLBOX

**315'± PROPOSED NEW AERIAL**

PROP. ZAYO AERIAL

PROPOSED AERIAL (CULVER CITY RW)

**250'± PROPOSED NEW AERIAL**

PROP. ZAYO AERIAL

PROPOSED RISER TO EXISTING POLE

**300'± PROPOSED NEW AERIAL**

PROP. ZAYO AERIAL

**8'± PROPOSED NEW UC**

PROPOSED 2'X3' ZAYO PULLBOX

**108'± PROPOSED NEW UC**

**8'± PROPOSED NEW UC**

**W Slauson Ave**

**242'± PROPOSED NEW UG**

**100'± PROPOSED NEW UC**

**502'± PROPOSED NEW UG**

**329'± PROPOSED NEW UC**

**289'± PROPOSED NEW UC**

**Bristol Pkwy**

**Corporate Pointe Walk**

**Corporate Pointe**

PROPOSED UNDERGROUND

**200'± PROPOSED NEW UC**

PROPOSED 2'X3' ZAYO PULLBOX

**35'± PROPOSED NEW UC**

PROPOSED ZAYO MANHOLE

PROPOSED 2'X3' ZAYO PULLBOX

**10'± PROPOSED NEW UC**

PROPOSED ZAYO MANHOLE

BILL OF MATERIAL			
NO.	MATERIAL	QUANTITY	FOOTAGE
1	2 - 1 1/4" HDPE/MDPE CONDUIT	—	1,847' ±
2	AERIAL FIBER (CULVER CITY RW)	—	865' ±
3	PULLBOX	5	N/A
4	MANHOLE	2	N/A



TEL. 951-808-9501

TEL. 951-808-9501  
FAX. 951-808-9518

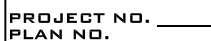

**PROJECT DESCRIPTION:**  
PLACING HDPE CONDUIT UNDERGROUND, STRAND AND  
FIBER AERIAL, AND LEASE DUCT FIBER IN VARIOUS  
LOCATIONS IN CULVER CITY. ROUTE COVERS STREETS AS  
FOLLOWS: W. SLAUSON AVE, BRISTOL PKWY, SEPULVEDA  
BLVD, PLAYA ST, OVERLAND AVE, SAWTELLE BLVD,  
JEFFERSON BLVD, CULVER BLVD, MADISON AVE, W  
WASHINGTON BLVD, INCE BLVD, AND LINDBLADE ST.  
EXCLUDING PORTIONS OF THIS PROJECT SITUATED ON  
PRIVATE PROPERTY.

**SHEET NO.**  
**2 OF 19**

SEE SHEET 6  
MATCHLINE E-E

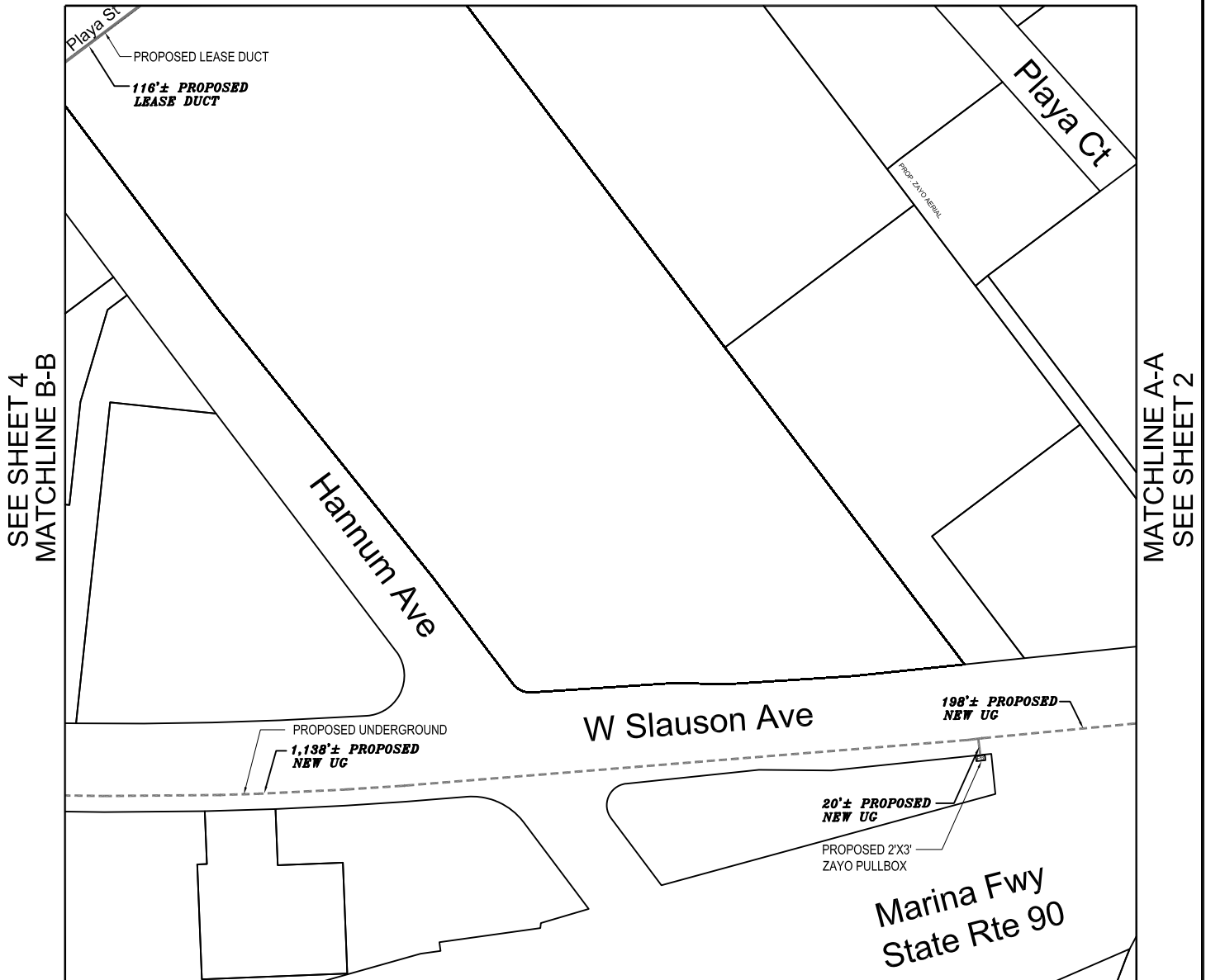

# BILL OF MATERIAL

NO.	MATERIAL	QUANTITY	FOOTAGE
1	2 - 1 1/4" HDPE/MDPE CONDUIT	—	1,336' ±
2	LEASE DUCT	—	116' ±
3	PULLBOX	1	N/A

SCALE 1:200

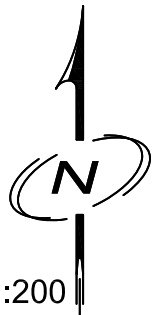

DRAFTED BY.....



290 CORPORATE TERRACE CIRCLE  
STE. 200, CORONA, CA 92879

WWW.KBENG.NET

TEL. 951-808-9501  
FAX. 951-808-9518

CONSULTANT ENGINEER  
INFORMATION

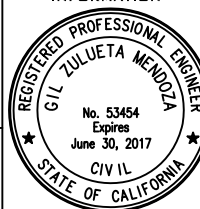

PROJECT NO. \_\_\_\_\_  
PLAN NO. \_\_\_\_\_

PROJECT NAME: SONY RING  
LOCATION: CULVER CITY

PROJECT DESCRIPTION:  
PLACING HDPE CONDUIT UNDERGROUND, STRAND AND FIBER AERIAL, AND LEASE DUCT FIBER IN VARIOUS LOCATIONS IN CULVER CITY. ROUTE COVERS STREETS AS FOLLOWS: W. SLAUSON AVE, BRISTOL PKWY, SEPULVEDA BLVD, PLAYA ST, OVERLAND AVE, SAWTELLE BLVD, JEFFERSON BLVD, CULVER BLVD, MADISON AVE, W WASHINGTON BLVD, INCE BLVD, AND LINDBLADE ST. EXCLUDING PORTIONS OF THIS PROJECT SITUATED ON PRIVATE PROPERTY.

SYSTEM EXHIBIT OPTION 1

SHEET NO.  
3 OF 19

SEE SHEET 5  
MATCHLINE C-C

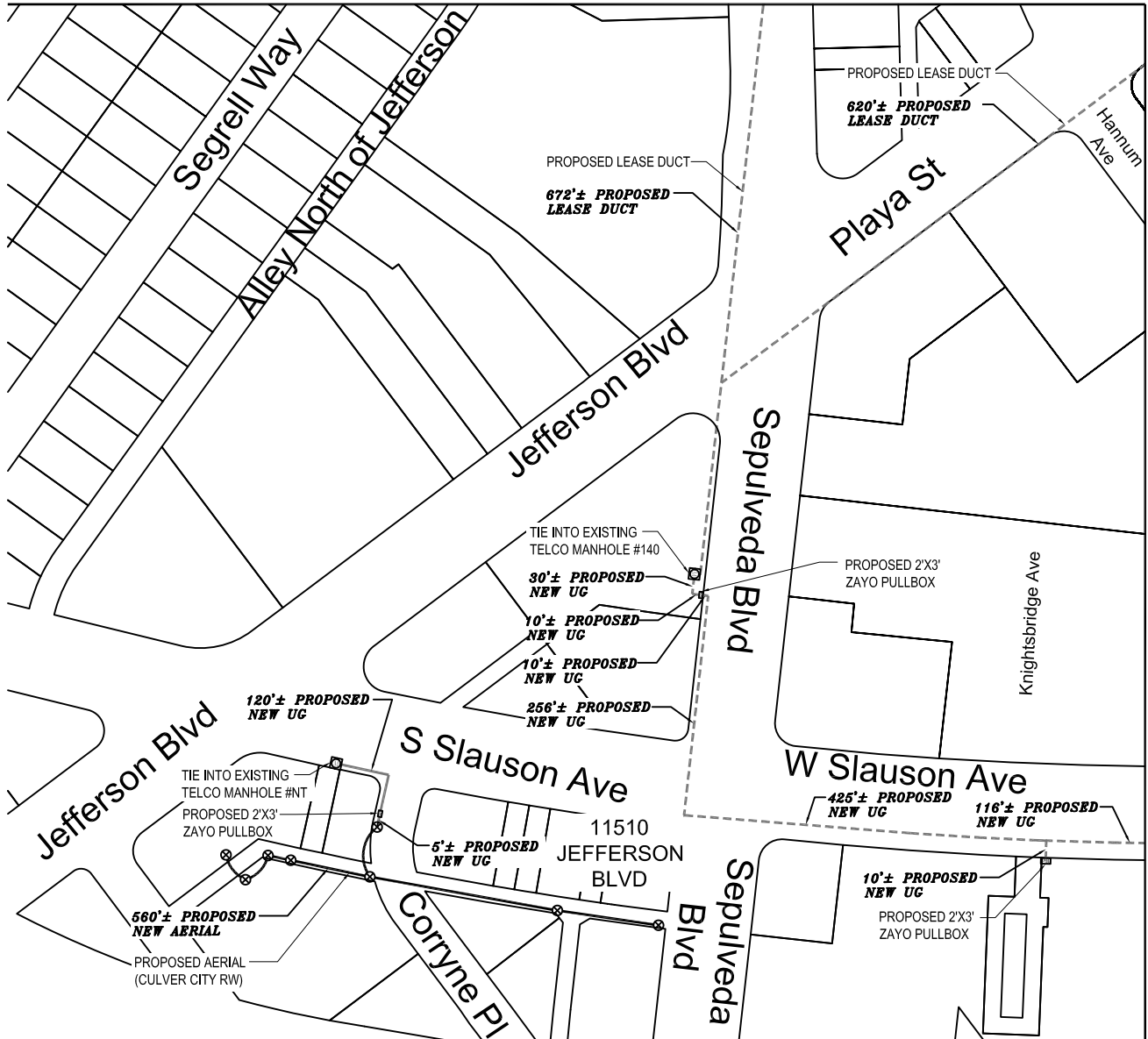

MATCHLINE B-B  
SEE SHEET 3

# BILL OF MATERIAL

NO.	MATERIAL	QUANTITY	FOOTAGE
1	2 - 1 1/4" HDPE/MDPE CONDUIT	—	882' ±
2	1-4" HDPE CONDUIT	—	150' ±
3	LEASE DUCT	—	1,292' ±
4	PULLBOX	3	N/A

SCALE 1:200

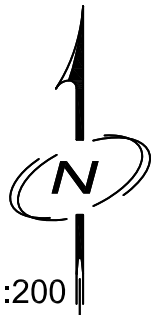

**zayo**  
GROUP

DRAFTED BY.....

**KB**  
ENGINEERING

290 CORPORATE TERRACE CIRCLE  
STE. 200, CORONA, CA 92879

WWW.KBENG.NET

TEL. 951-808-9501  
FAX. 951-808-9518

CONSULTANT ENGINEER  
INFORMATION

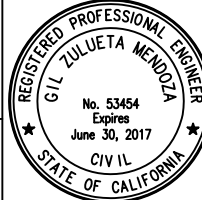

PROJECT NO. \_\_\_\_\_  
PLAN NO. \_\_\_\_\_

PROJECT NAME: SONY RING  
LOCATION: CULVER CITY

PROJECT DESCRIPTION:  
PLACING HDPE CONDUIT UNDERGROUND, STRAND AND FIBER AERIAL, AND LEASE DUCT FIBER IN VARIOUS LOCATIONS IN CULVER CITY. ROUTE COVERS STREETS AS FOLLOWS: W. SLAUSON AVE, BRISTOL PKWY, SEPULVEDA BLVD, PLAYA ST, OVERLAND AVE, SAWTELLE BLVD, JEFFERSON BLVD, CULVER BLVD, MADISON AVE, W WASHINGTON BLVD, INCE BLVD, AND LINDBLADE ST. EXCLUDING PORTIONS OF THIS PROJECT SITUATED ON PRIVATE PROPERTY.

SYSTEM EXHIBIT OPTION 1

SHEET NO.  
4 OF 19

SEE SHEET 7  
MATCHLINE F-F



MATCHLINE C-C  
SEE SHEET 4

MATCHLINE D-D  
SEE SHEET 6

# BILL OF MATERIAL

NO.	MATERIAL	QUANTITY	FOOTAGE
1	LEASE DUCT	—	1,221' ±

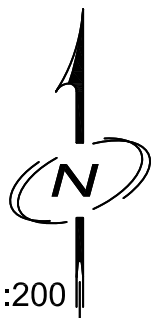

SCALE 1:200

**zayo**  
GROUP

DRAFTED BY.....

**KB**  
ENGINEERING

290 CORPORATE TERRACE CIRCLE  
STE. 200, CORONA, CA 92879

WWW.KBENG.NET

TEL. 951-808-9501  
FAX. 951-808-9518

CONSULTANT ENGINEER  
INFORMATION



PROJECT NO. \_\_\_\_\_  
PLAN NO. \_\_\_\_\_

PROJECT NAME: SONY RING  
LOCATION: CULVER CITY

PROJECT DESCRIPTION:  
PLACING HDPE CONDUIT UNDERGROUND, STRAND AND FIBER AERIAL, AND LEASE DUCT FIBER IN VARIOUS LOCATIONS IN CULVER CITY. ROUTE COVERS STREETS AS FOLLOWS: W. SLAUSON AVE, BRISTOL PKWY, SEPULVEDA BLVD, PLAYA ST, OVERLAND AVE, SAWTELLE BLVD, JEFFERSON BLVD, CULVER BLVD, MADISON AVE, W WASHINGTON BLVD, INCE BLVD, AND LINDBLADE ST. EXCLUDING PORTIONS OF THIS PROJECT SITUATED ON PRIVATE PROPERTY.

SYSTEM EXHIBIT OPTION 1

SHEET NO.  
5 OF 19



MATCHLINE E-E  
SEE SHEET 3

# BILL OF MATERIAL

NO.	MATERIAL	QUANTITY	FOOTAGE
1	1-4" HDPE/MDPE CONDUIT	—	232' ±
2	LEASE DUCT	—	402' ±

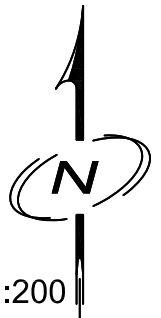

**zayo**  
GROUP

DRAFTED BY.....

**KB**  
ENGINEERING

290 CORPORATE TERRACE CIRCLE  
STE. 200, CORONA, CA 92879

WWW.KBENG.NET

TEL. 951-808-9501  
FAX. 951-808-9518

CONSULTANT ENGINEER  
INFORMATION



PROJECT NO. \_\_\_\_\_  
PLAN NO. \_\_\_\_\_

PROJECT NAME: SONY RING  
LOCATION: CULVER CITY

PROJECT DESCRIPTION:  
PLACING HDPE CONDUIT UNDERGROUND, STRAND AND FIBER AERIAL, AND LEASE DUCT FIBER IN VARIOUS LOCATIONS IN CULVER CITY. ROUTE COVERS STREETS AS FOLLOWS: W. SLAUSON AVE, BRISTOL PKWY, SEPULVEDA BLVD, PLAYA ST, OVERLAND AVE, SAWTELLE BLVD, JEFFERSON BLVD, CULVER BLVD, MADISON AVE, W WASHINGTON BLVD, INCE BLVD, AND LINDBLADE ST. EXCLUDING PORTIONS OF THIS PROJECT SITUATED ON PRIVATE PROPERTY.

SYSTEM EXHIBIT OPTION 1

SHEET NO.  
6 OF 19

SEE SHEET 8  
MATCHLINE G-G



# BILL OF MATERIAL

NO.	MATERIAL	QUANTITY	FOOTAGE
1	2 - 1 1/4" HDPE/MDPE CONDUIT	—	355' ±
2	1-4" HDPE/MDPE CONDUIT	—	10' ±
3	AERIAL FIBER (CULVER CITY RW)	—	229' ±
4	LEASE DUCT	—	1,215' ±
5	PULLBOX	2	N/A

MATCHLINE F-F  
SEE SHEET 5

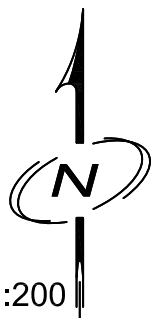

DRAFTED BY.....



290 CORPORATE TERRACE CIRCLE  
STE. 200, CORONA, CA 92879

WWW.KBENG.NET

TEL. 951-808-9501  
FAX. 951-808-9518

CONSULTANT ENGINEER  
INFORMATION

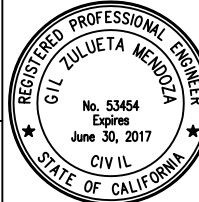

PROJECT NO. \_\_\_\_\_  
PLAN NO. \_\_\_\_\_

PROJECT NAME: SONY RING  
LOCATION: CULVER CITY

PROJECT DESCRIPTION:  
PLACING HDPE CONDUIT UNDERGROUND, STRAND AND FIBER AERIAL, AND LEASE DUCT FIBER IN VARIOUS LOCATIONS IN CULVER CITY. ROUTE COVERS STREETS AS FOLLOWS: W. SLAUSON AVE, BRISTOL PKWY, SEPULVEDA BLVD, PLAYA ST, OVERLAND AVE, SAWTELLE BLVD, JEFFERSON BLVD, CULVER BLVD, MADISON AVE, W WASHINGTON BLVD, INCE BLVD, AND LINDBLADE ST. EXCLUDING PORTIONS OF THIS PROJECT SITUATED ON PRIVATE PROPERTY.

SYSTEM EXHIBIT OPTION 1

SHEET NO.  
7 OF 19

SEE SHEET 9  
MATCHLINE H-H



MATCHLINE G-G  
SEE SHEET 7

**BILL OF MATERIAL**

NO.	MATERIAL	QUANTITY	FOOTAGE
1	LEASE DUCT	—	1274' ±

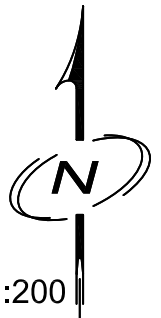

SCALE 1:200



DRAFTED BY.....



290 CORPORATE TERRACE CIRCLE  
STE. 200, CORONA, CA 92879

WWW.KBENG.NET

TEL. 951-808-9501  
FAX. 951-808-9518

CONSULTANT ENGINEER  
INFORMATION



PROJECT NO. \_\_\_\_\_  
PLAN NO. \_\_\_\_\_

PROJECT NAME: SONY RING  
LOCATION: CULVER CITY

**PROJECT DESCRIPTION:**  
PLACING HDPE CONDUIT UNDERGROUND, STRAND AND FIBER AERIAL, AND LEASE DUCT FIBER IN VARIOUS LOCATIONS IN CULVER CITY. ROUTE COVERS STREETS AS FOLLOWS: W. SLAUSON AVE, BRISTOL PKWY, SEPULVEDA BLVD, PLAYA ST, OVERLAND AVE, SAWTELLE BLVD, JEFFERSON BLVD, CULVER BLVD, MADISON AVE, W WASHINGTON BLVD, INCE BLVD, AND LINDBLADE ST. EXCLUDING PORTIONS OF THIS PROJECT SITUATED ON PRIVATE PROPERTY.

**SYSTEM EXHIBIT OPTION 1**

**SHEET NO.**  
**8 OF 19**



SEE SHEET 10  
MATCHLINE I-I

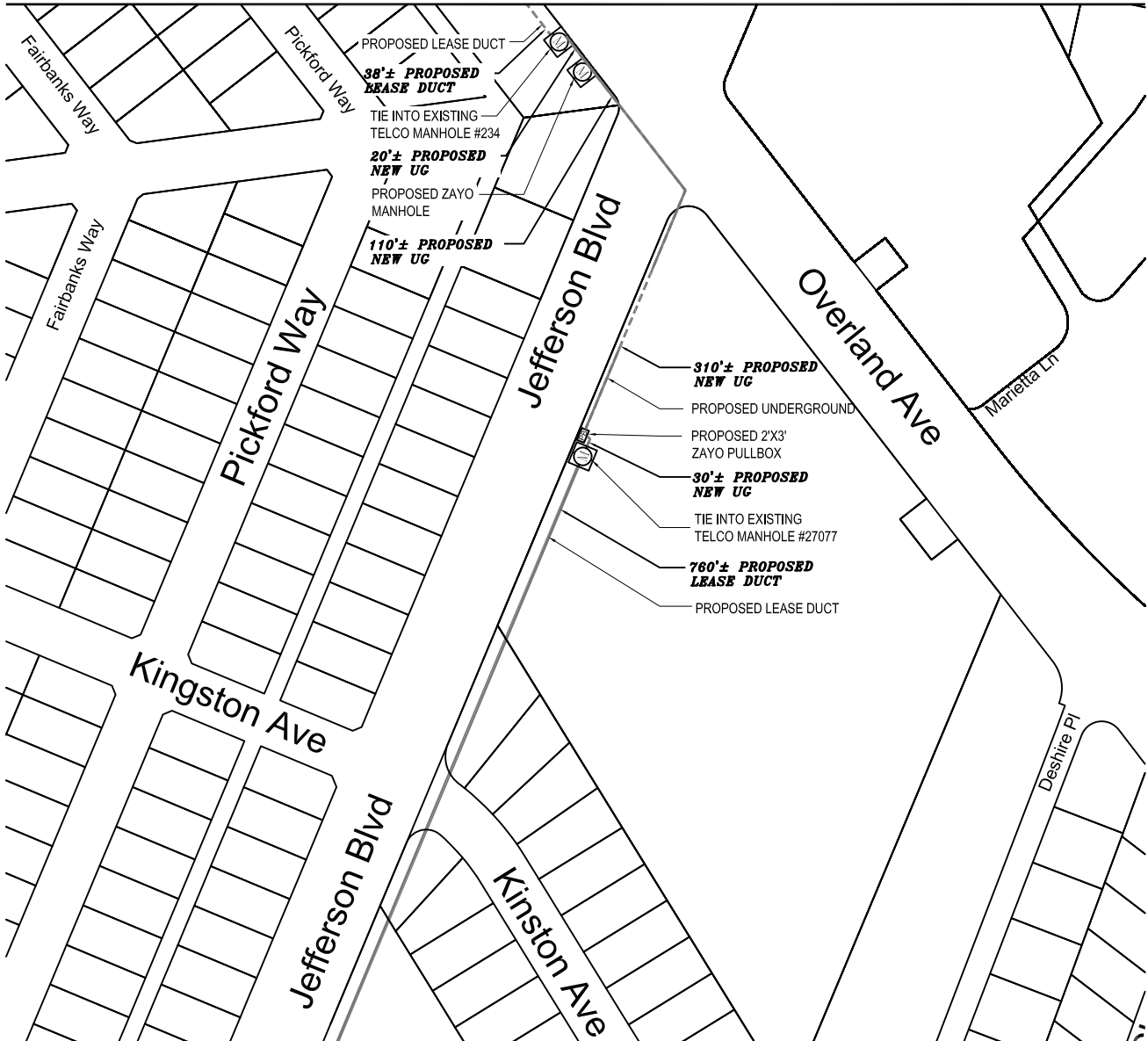

MATCHLINE H-H  
SEE SHEET 8

# BILL OF MATERIAL

NO.	MATERIAL	QUANTITY	FOOTAGE
1	1 -4" HDPE/MDPE CONDUIT	—	470' ±
2	LEASE DUCT	—	798' ±
3	PULLBOX	1	N/A
4	MANHOLE	1	N/A

SCALE 1:200

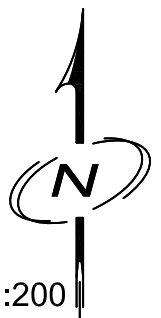

**zayo**  
GROUP

DRAFTED BY.....

**KB**  
ENGINEERING

290 CORPORATE TERRACE CIRCLE  
STE. 200, CORONA, CA 92879

WWW.KBENG.NET

TEL. 951-808-9501  
FAX. 951-808-9518

CONSULTANT ENGINEER  
INFORMATION

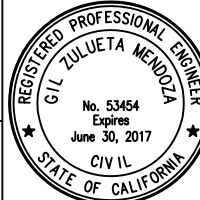

PROJECT NO. \_\_\_\_\_  
PLAN NO. \_\_\_\_\_

PROJECT NAME: SONY RING  
LOCATION: CULVER CITY

PROJECT DESCRIPTION:  
PLACING HDPE CONDUIT UNDERGROUND, STRAND AND FIBER AERIAL, AND LEASE DUCT FIBER IN VARIOUS LOCATIONS IN CULVER CITY. ROUTE COVERS STREETS AS FOLLOWS: W. SLAUSON AVE, BRISTOL PKWY, SEPULVEDA BLVD, PLAYA ST, OVERLAND AVE, SAWTELLE BLVD, JEFFERSON BLVD, CULVER BLVD, MADISON AVE, W WASHINGTON BLVD, INCE BLVD, AND LINDBLADE ST. EXCLUDING PORTIONS OF THIS PROJECT SITUATED ON PRIVATE PROPERTY.

SYSTEM EXHIBIT OPTION 1

SHEET NO.  
9 OF 19

SEE SHEET 11  
MATCHLINE J-J



MATCHLINE I-I  
SEE SHEET 9

# BILL OF MATERIAL

NO.	MATERIAL	QUANTITY	FOOTAGE
1	LEASE DUCT	—	1,506' ±

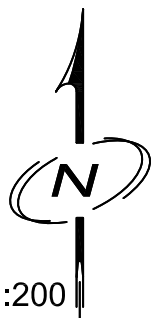

SCALE 1:200



DRAFTED BY.....



290 CORPORATE TERRACE CIRCLE  
STE. 200, CORONA, CA 92879

WWW.KBENG.NET

TEL. 951-808-9501  
FAX. 951-808-9518

## CONSULTANT ENGINEER INFORMATION



PROJECT NO. \_\_\_\_\_  
PLAN NO. \_\_\_\_\_

PROJECT NAME: SONY RING  
LOCATION: CULVER CITY

**PROJECT DESCRIPTION:**  
PLACING HDPE CONDUIT UNDERGROUND, STRAND AND FIBER AERIAL, AND LEASE DUCT FIBER IN VARIOUS LOCATIONS IN CULVER CITY. ROUTE COVERS STREETS AS FOLLOWS: W. SLAUSON AVE, BRISTOL PKWY, SEPULVEDA BLVD, PLAYA ST, OVERLAND AVE, SAWTELLE BLVD, JEFFERSON BLVD, CULVER BLVD, MADISON AVE, W WASHINGTON BLVD, INCE BLVD, AND LINDBLADE ST. EXCLUDING PORTIONS OF THIS PROJECT SITUATED ON PRIVATE PROPERTY.

**SYSTEM EXHIBIT OPTION 1**

SHEET NO.  
10 OF 19



SEE SHEET 12  
MATCHLINE K-K



MATCHLINE J-J  
SEE SHEET 10

# BILL OF MATERIAL

NO.	MATERIAL	QUANTITY	FOOTAGE
1	LEASE DUCT	—	1,552' ±

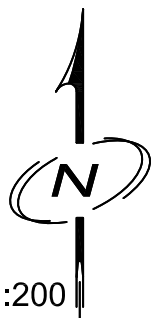

SCALE 1:200



DRAFTED BY.....



290 CORPORATE TERRACE CIRCLE  
STE. 200, CORONA, CA 92879

WWW.KBENG.NET

TEL. 951-808-9501  
FAX. 951-808-9518

CONSULTANT ENGINEER  
INFORMATION

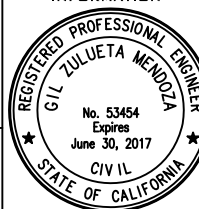

PROJECT NO. \_\_\_\_\_  
PLAN NO. \_\_\_\_\_

PROJECT NAME: SONY RING  
LOCATION: CULVER CITY

PROJECT DESCRIPTION:  
PLACING HDPE CONDUIT UNDERGROUND, STRAND AND  
FIBER AERIAL, AND LEASE DUCT FIBER IN VARIOUS  
LOCATIONS IN CULVER CITY. ROUTE COVERS STREETS AS  
FOLLOWS: W. SLAUSON AVE, BRISTOL PKWY, SEPULVEDA  
BLVD, PLAYA ST, OVERLAND AVE, SAWTELLE BLVD,  
JEFFERSON BLVD, CULVER BLVD, MADISON AVE, W  
WASHINGTON BLVD, INCE BLVD, AND LINDBLADE ST.  
EXCLUDING PORTIONS OF THIS PROJECT SITUATED ON  
PRIVATE PROPERTY.

SYSTEM EXHIBIT OPTION 1

SHEET NO.  
11 OF 19

SEE SHEET 15  
MATCHLINE N-N



MATCHLINE K-K  
SEE SHEET 11

**BILL OF MATERIAL**

NO.	MATERIAL	QUANTITY	FOOTAGE
1	LEASE DUCT	—	680' ±

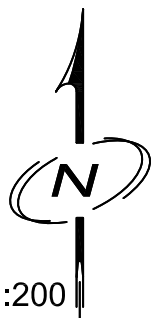

SCALE 1:200



DRAFTED BY.....



290 CORPORATE TERRACE CIRCLE  
STE. 200, CORONA, CA 92879

WWW.KBENG.NET

TEL. 951-808-9501  
FAX. 951-808-9518

CONSULTANT ENGINEER  
INFORMATION



PROJECT NO. \_\_\_\_\_  
PLAN NO. \_\_\_\_\_

PROJECT NAME: SONY RING  
LOCATION: CULVER CITY

**PROJECT DESCRIPTION:**  
PLACING HDPE CONDUIT UNDERGROUND, STRAND AND FIBER AERIAL, AND LEASE DUCT FIBER IN VARIOUS LOCATIONS IN CULVER CITY. ROUTE COVERS STREETS AS FOLLOWS: W. SLAUSON AVE, BRISTOL PKWY, SEPULVEDA BLVD, PLAYA ST, OVERLAND AVE, SAWTELLE BLVD, JEFFERSON BLVD, CULVER BLVD, MADISON AVE, W WASHINGTON BLVD, INCE BLVD, AND LINDBLADE ST. EXCLUDING PORTIONS OF THIS PROJECT SITUATED ON PRIVATE PROPERTY.

**SYSTEM EXHIBIT OPTION 1**

SHEET NO.  
12 OF 19



SEE SHEET 14  
MATCHLINE M-M

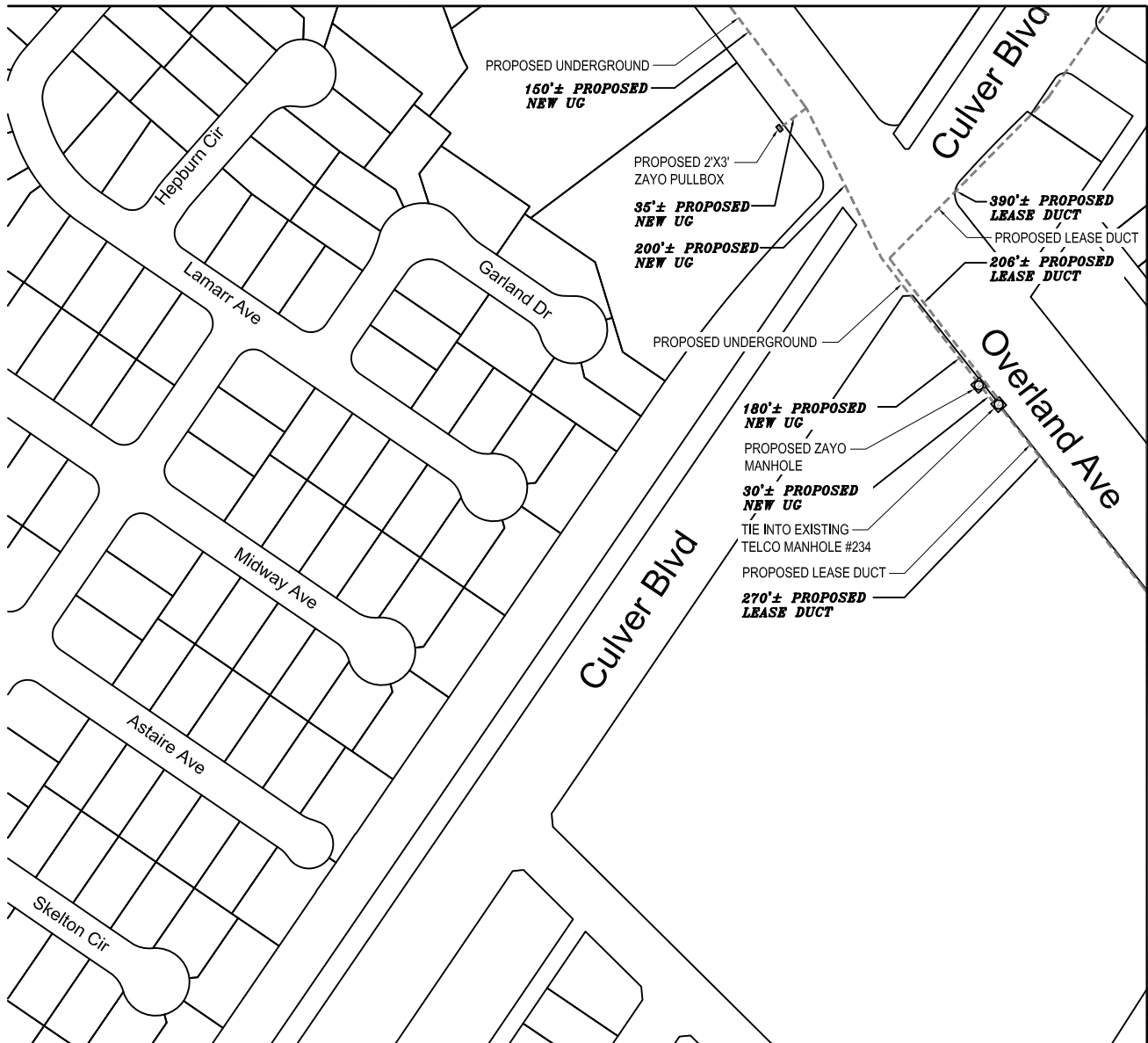

MATCHLINE L-L  
SEE SHEET 12

**BILL OF MATERIAL**

NO.	MATERIAL	QUANTITY	FOOTAGE
1	2 - 1 1/4" HDPE/MDPE CONDUIT	—	565' ±
2	1 - 4" HDPE/MDPE CONDUIT	—	30' ±
3	LEASE DUCT	—	866' ±
4	PULLBOX	1	N/A
5	MANHOLE	1	N/A

SCALE 1:200

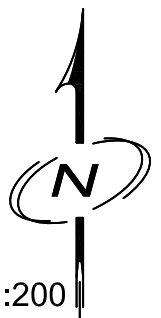

**zayo**  
GROUP

DRAFTED BY.....

**KB**  
ENGINEERING

290 CORPORATE TERRACE CIRCLE  
STE. 200, CORONA, CA 92879

WWW.KBENG.NET

TEL. 951-808-9501  
FAX. 951-808-9518

CONSULTANT ENGINEER  
INFORMATION

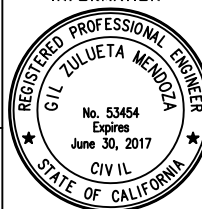

PROJECT NO. \_\_\_\_\_  
PLAN NO. \_\_\_\_\_

PROJECT NAME: SONY RING  
LOCATION: CULVER CITY

**PROJECT DESCRIPTION:**  
PLACING HDPE CONDUIT UNDERGROUND, STRAND AND FIBER AERIAL, AND LEASE DUCT FIBER IN VARIOUS LOCATIONS IN CULVER CITY. ROUTE COVERS STREETS AS FOLLOWS: W. SLAUSON AVE, BRISTOL PKWY, SEPULVEDA BLVD, PLAYA ST, OVERLAND AVE, SAWTELLE BLVD, JEFFERSON BLVD, CULVER BLVD, MADISON AVE, W WASHINGTON BLVD, INCE BLVD, AND LINDBLADE ST. EXCLUDING PORTIONS OF THIS PROJECT SITUATED ON PRIVATE PROPERTY.

**SYSTEM EXHIBIT OPTION 1**

SHEET NO.  
13 OF 19

MATCHLINE O-O  
SEE SHEET 15

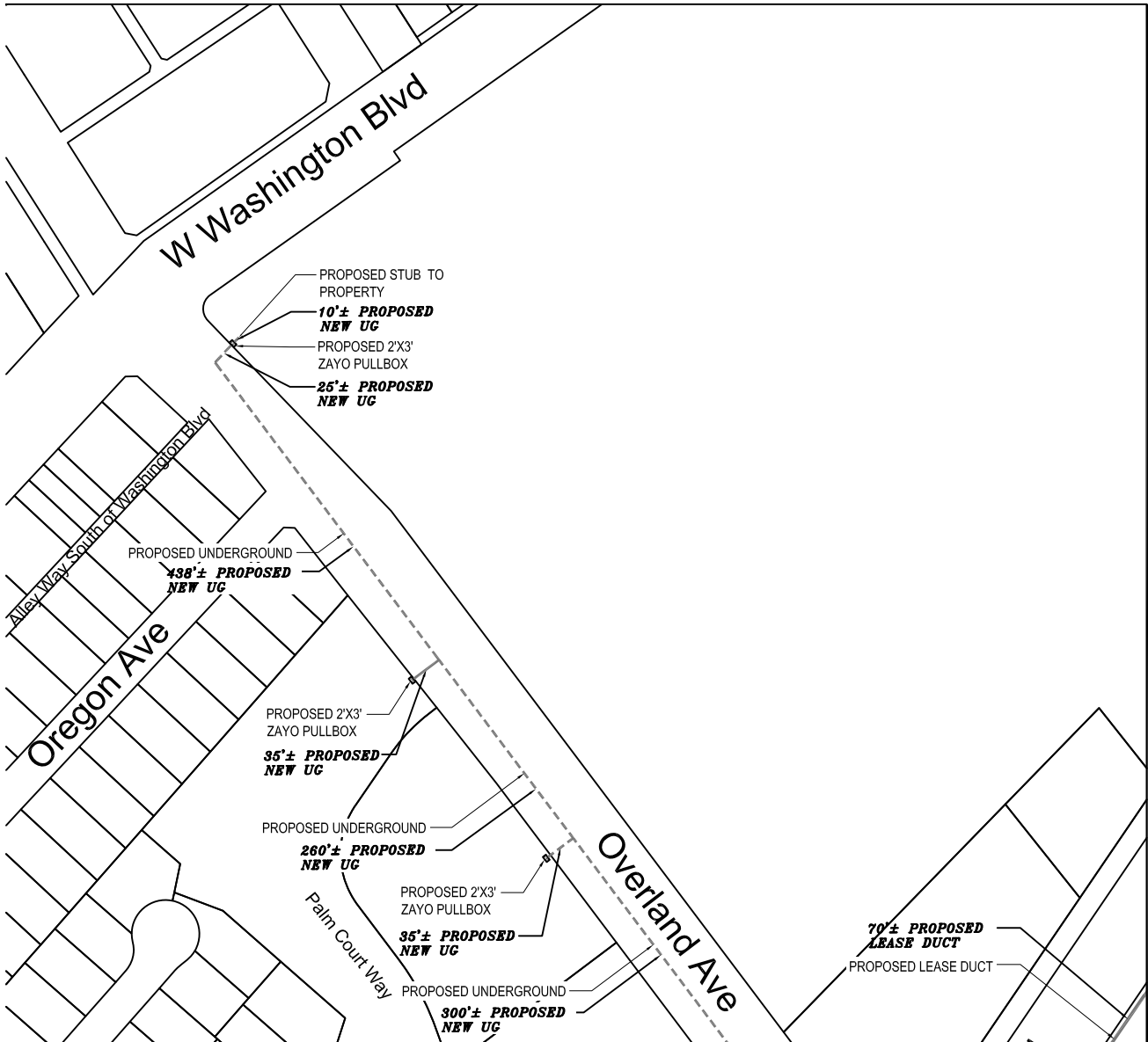

MATCHLINE M-M  
SEE SHEET 13

#### BILL OF MATERIAL

NO.	MATERIAL	QUANTITY	FOOTAGE
1	2 - 1 1/4" HDPE/MDPE CONDUIT	—	1,103' ±
2	LEASE DUCT	—	70' ±
3	PULLBOX	3	N/A

SCALE 1:200

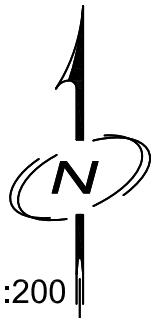

**zayo**  
GROUP

DRAFTED BY.....

**KB**  
ENGINEERING

290 CORPORATE TERRACE CIRCLE  
STE. 200, CORONA, CA 92879

WWW.KBENG.NET

TEL. 951-808-9501  
FAX. 951-808-9518

CONSULTANT ENGINEER  
INFORMATION



PROJECT NO. \_\_\_\_\_  
PLAN NO. \_\_\_\_\_

PROJECT NAME: SONY RING  
LOCATION: CULVER CITY

PROJECT DESCRIPTION:  
PLACING HDPE CONDUIT UNDERGROUND, STRAND AND FIBER AERIAL, AND LEASE DUCT FIBER IN VARIOUS LOCATIONS IN CULVER CITY. ROUTE COVERS STREETS AS FOLLOWS: W. SLAUSON AVE, BRISTOL PKWY, SEPULVEDA BLVD, PLAYA ST, OVERLAND AVE, SAWTELLE BLVD, JEFFERSON BLVD, CULVER BLVD, MADISON AVE, W WASHINGTON BLVD, INCE BLVD, AND LINDBLADE ST. EXCLUDING PORTIONS OF THIS PROJECT SITUATED ON PRIVATE PROPERTY.

SYSTEM EXHIBIT OPTION 1

SHEET NO.  
14 OF 19



SEE SHEET 16  
MATCHLINE P-P

SEE SHEET 14  
MATCHLINE O-O



# BILL OF MATERIAL

NO.	MATERIAL	QUANTITY	FOOTAGE
1	1-4" HDPE/MDPE CONDUIT	—	20' ±
2	LEASE DUCT	—	1,354' ±

SCALE 1:200

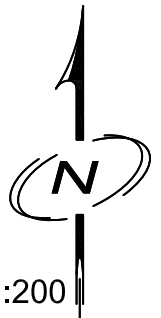

**zayo**  
GROUP

DRAFTED BY.....

**KB**  
ENGINEERING

290 CORPORATE TERRACE CIRCLE  
STE. 200, CORONA, CA 92879

WWW.KBENG.NET

TEL. 951-808-9501  
FAX. 951-808-9518

CONSULTANT ENGINEER  
INFORMATION



PROJECT NO. \_\_\_\_\_  
PLAN NO. \_\_\_\_\_

PROJECT NAME: SONY RING  
LOCATION: CULVER CITY

PROJECT DESCRIPTION:  
PLACING HDPE CONDUIT UNDERGROUND, STRAND AND FIBER AERIAL, AND LEASE DUCT FIBER IN VARIOUS LOCATIONS IN CULVER CITY. ROUTE COVERS STREETS AS FOLLOWS: W. SLAUSON AVE, BRISTOL PKWY, SEPULVEDA BLVD, PLAYA ST, OVERLAND AVE, SAWTELLE BLVD, JEFFERSON BLVD, CULVER BLVD, MADISON AVE, W WASHINGTON BLVD, INCE BLVD, AND LINDBLADE ST. EXCLUDING PORTIONS OF THIS PROJECT SITUATED ON PRIVATE PROPERTY.

SYSTEM EXHIBIT OPTION 1

SHEET NO.  
15 OF 19

SEE SHEET 17  
MATCHLINE Q-Q

SEE SHEET 18  
MATCHLINE R-R

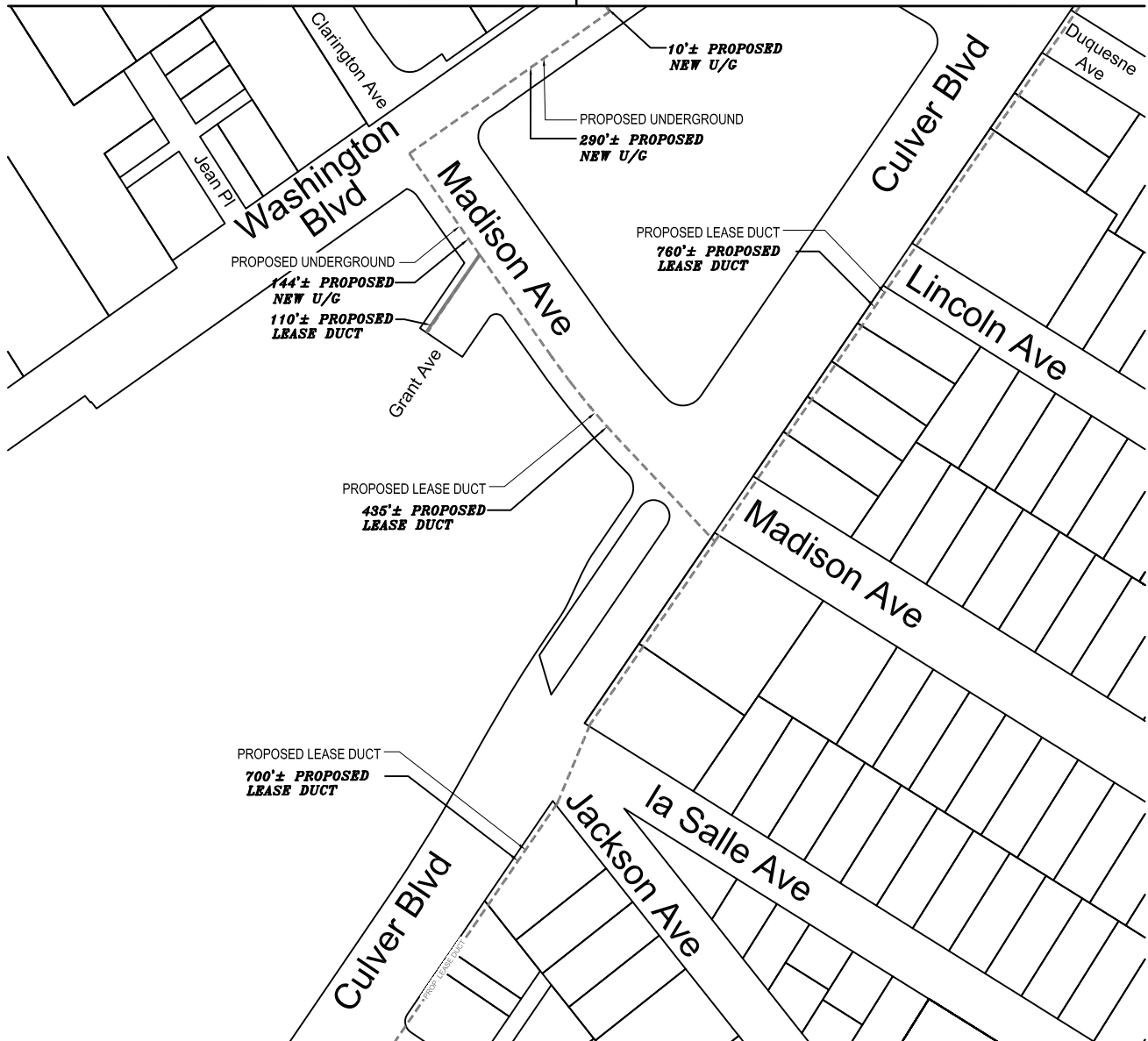

MATCHLINE P-P  
SEE SHEET 15

# BILL OF MATERIAL

NO.	MATERIAL	QUANTITY	FOOTAGE
1	1-4" HDPE/MDPE CONDUIT	—	444' ±
2	LEASE DUCT	—	2,005' ±

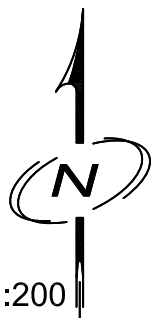

SCALE 1:200



DRAFTED BY.....



290 CORPORATE TERRACE CIRCLE  
STE. 200, CORONA, CA 92879

WWW.KBENG.NET

TEL. 951-808-9501  
FAX. 951-808-9518

CONSULTANT ENGINEER  
INFORMATION

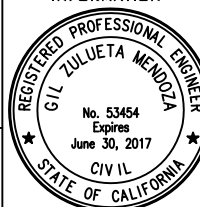

PROJECT NO. \_\_\_\_\_  
PLAN NO. \_\_\_\_\_

PROJECT NAME: SONY RING  
LOCATION: CULVER CITY

PROJECT DESCRIPTION:  
PLACING HDPE CONDUIT UNDERGROUND, STRAND AND FIBER AERIAL, AND LEASE DUCT FIBER IN VARIOUS LOCATIONS IN CULVER CITY. ROUTE COVERS STREETS AS FOLLOWS: W. SLAUSON AVE, BRISTOL PKWY, SEPULVEDA BLVD, PLAYA ST, OVERLAND AVE, SAWTELLE BLVD, JEFFERSON BLVD, CULVER BLVD, MADISON AVE, W WASHINGTON BLVD, INCE BLVD, AND LINDBLADE ST. EXCLUDING PORTIONS OF THIS PROJECT SITUATED ON PRIVATE PROPERTY.

SYSTEM EXHIBIT OPTION 1

SHEET NO.  
16 OF 19



MATCHLINE S-S  
SEE SHEET 18

MATCHLINE Q-Q  
SEE SHEET 16

# BILL OF MATERIAL

NO.	MATERIAL	QUANTITY	FOOTAGE
1	1-4" HDPE/MDPE CONDUIT	—	154' ±

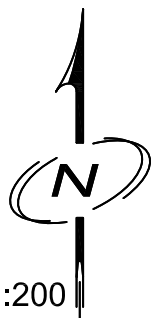

SCALE 1:200

**zayo**  
GROUP

DRAFTED BY.....

**KB**  
ENGINEERING

290 CORPORATE TERRACE CIRCLE  
STE. 200, CORONA, CA 92879

WWW.KBENG.NET

TEL. 951-808-9501  
FAX. 951-808-9518

CONSULTANT ENGINEER  
INFORMATION



PROJECT NO. \_\_\_\_\_  
PLAN NO. \_\_\_\_\_

PROJECT NAME: SONY RING  
LOCATION: CULVER CITY

PROJECT DESCRIPTION:  
PLACING HDPE CONDUIT UNDERGROUND, STRAND AND FIBER AERIAL, AND LEASE DUCT FIBER IN VARIOUS LOCATIONS IN CULVER CITY. ROUTE COVERS STREETS AS FOLLOWS: W. SLAUSON AVE, BRISTOL PKWY, SEPULVEDA BLVD, PLAYA ST, OVERLAND AVE, SAWTELLE BLVD, JEFFERSON BLVD, CULVER BLVD, MADISON AVE, W WASHINGTON BLVD, INCE BLVD, AND LINDBLADE ST. EXCLUDING PORTIONS OF THIS PROJECT SITUATED ON PRIVATE PROPERTY.

SYSTEM EXHIBIT OPTION 1

SHEET NO.  
17 OF 19



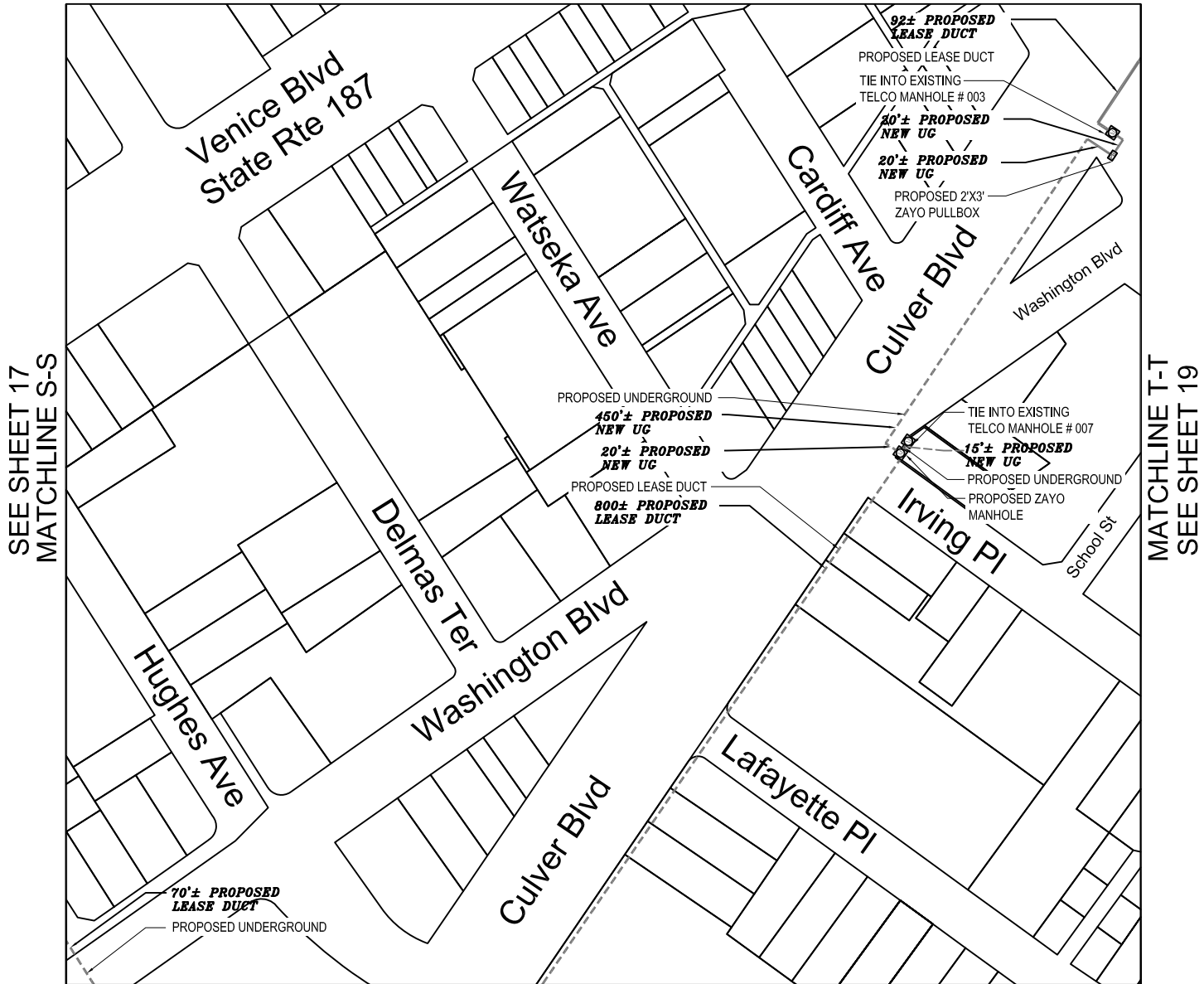

SEE SHEET 17  
MATCHLINE S-S

MATCHLINE T-T  
SEE SHEET 19

MATCHLINE R-R  
SEE SHEET 16

### BILL OF MATERIAL

NO.	MATERIAL	QUANTITY	FOOTAGE
1	1-4" HDPE/MDPE CONDUIT	—	525' ±
2	LEASE DUCT	—	892' ±
3	PULLBOX	1	N/A
4	MANHOLE	1	N/A

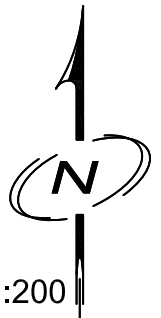

**zayo**  
GROUP

DRAFTED BY.....

**KB**  
ENGINEERING

290 CORPORATE TERRACE CIRCLE  
STE. 200, CORONA, CA 92879

WWW.KBENG.NET

TEL. 951-808-9501  
FAX. 951-808-9518

CONSULTANT ENGINEER  
INFORMATION



PROJECT NO. \_\_\_\_\_  
PLAN NO. \_\_\_\_\_

PROJECT NAME: SONY RING  
LOCATION: CULVER CITY

PROJECT DESCRIPTION:  
PLACING HDPE CONDUIT UNDERGROUND, STRAND AND FIBER AERIAL, AND LEASE DUCT FIBER IN VARIOUS LOCATIONS IN CULVER CITY. ROUTE COVERS STREETS AS FOLLOWS: W. SLAUSON AVE, BRISTOL PKWY, SEPULVEDA BLVD, PLAYA ST, OVERLAND AVE, SAWTELLE BLVD, JEFFERSON BLVD, CULVER BLVD, MADISON AVE, W WASHINGTON BLVD, INCE BLVD, AND LINDBLADE ST. EXCLUDING PORTIONS OF THIS PROJECT SITUATED ON PRIVATE PROPERTY.

SYSTEM EXHIBIT OPTION 1

SHEET NO.  
18 OF 19

SEE SHEET 18  
MATCHLINE T-T

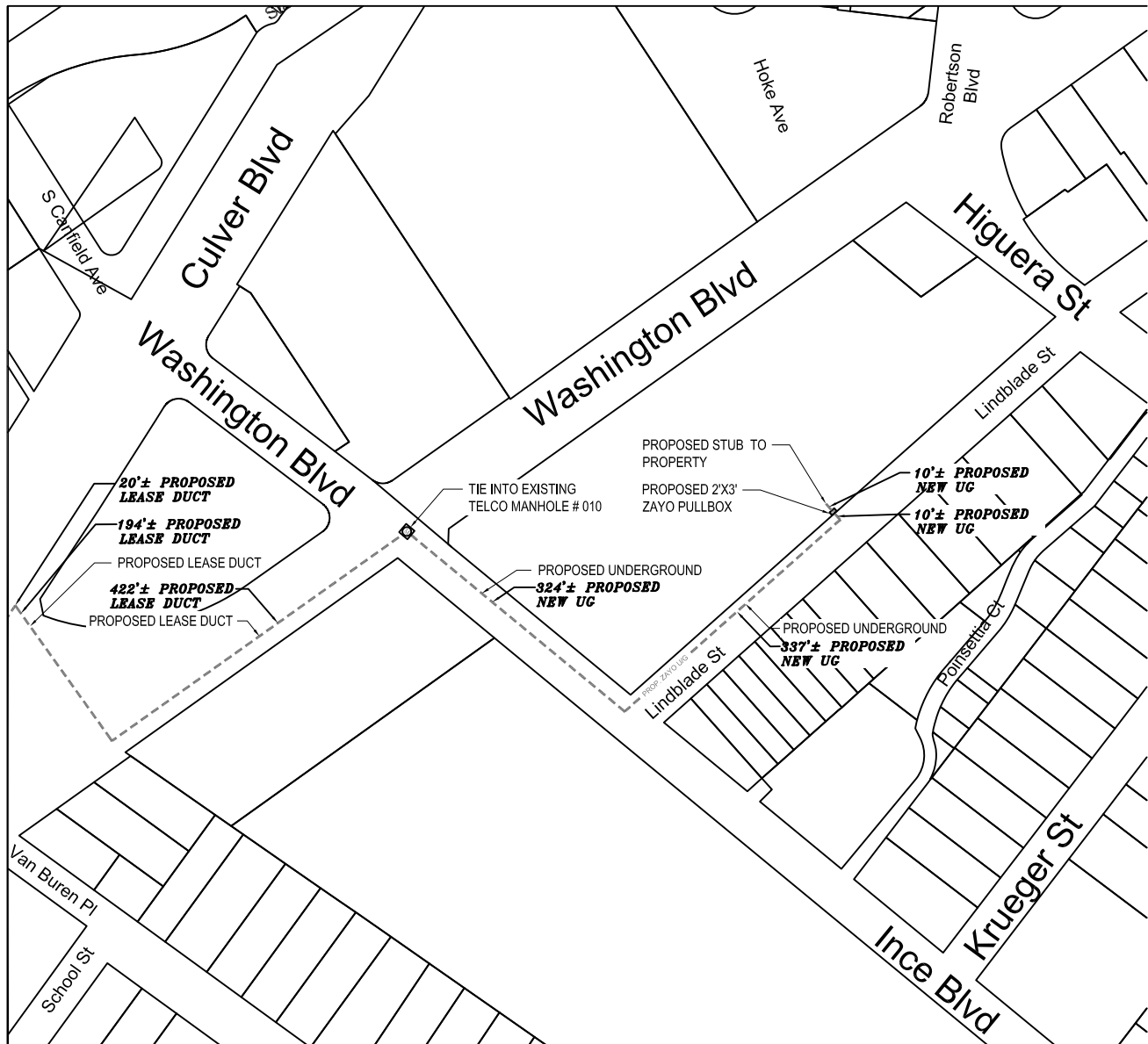

### BILL OF MATERIAL

NO.	MATERIAL	QUANTITY	FOOTAGE
1	2 - 1 1/4" HDPE/MDPE CONDUIT	—	10' ±
2	1 - 4" HDPE/MDPE CONDUIT	—	671' ±
3	LEASE DUCT	—	636' ±
3	PULLBOX	1	N/A

SCALE 1:200

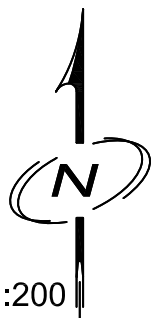

**zayo**  
GROUP

DRAFTED BY.....

**KB**  
ENGINEERING

290 CORPORATE TERRACE CIRCLE  
STE. 200, CORONA, CA 92879

WWW.KBENG.NET

TEL. 951-808-9501  
FAX. 951-808-9518

CONSULTANT ENGINEER  
INFORMATION



PROJECT NO. \_\_\_\_\_  
PLAN NO. \_\_\_\_\_

PROJECT NAME: SONY RING  
LOCATION: CULVER CITY

**PROJECT DESCRIPTION:**  
PLACING HDPE CONDUIT UNDERGROUND, STRAND AND FIBER AERIAL, AND LEASE DUCT FIBER IN VARIOUS LOCATIONS IN CULVER CITY. ROUTE COVERS STREETS AS FOLLOWS: W. SLAUSON AVE, BRISTOL PKWY, SEPULVEDA BLVD, PLAYA ST, OVERLAND AVE, SAWTELLE BLVD, JEFFERSON BLVD, CULVER BLVD, MADISON AVE, W WASHINGTON BLVD, INCE BLVD, AND LINDBLADE ST. EXCLUDING PORTIONS OF THIS PROJECT SITUATED ON PRIVATE PROPERTY.

**SYSTEM EXHIBIT OPTION 1**

SHEET NO.  
19 OF 19