

1. INSTALL STRIPING DETAIL AND/OR PAVEMENT MARKING AS SHOWN.
2. REMOVE CONFLICTING STOP BAR AND/OR STOP PAVEMENT MARKING IF ANY AND INSTALL 24" YELLOW HIGH VISIBILITY CONTINENTAL CROSSWALK PER DETAIL "A". CROSSWALK SHALL BE 12' IN WIDTH (INSIDE TO INSIDE) UNLESS OTHERWISE INDICATED.
3. REMOVE CONFLICTING STOP BAR AND/OR STOP PAVEMENT MARKING IF ANY AND INSTALL 24" WHITE HIGH VISIBILITY CONTINENTAL CROSSWALK PER DETAIL "A". CROSSWALK SHALL BE 12' IN WIDTH (INSIDE TO INSIDE) UNLESS OTHERWISE INDICATED.
4. INSTALL 12" WHITE LIMIT LINE.
5. INSTALL SIGN(S) AS NOTED.
6. INSTALL SIGN(S) AND POST AS NOTED.
7. INSTALL SHARED ROADWAY BICYCLE PAVEMENT MARKING PER DETAIL "C". PAVEMENT MARKINGS SHALL BE SPACED 250', UNLESS OTHERWISE NOTED.
8. INSTALL 4" WHITE LINE DIAGONAL LINES AT 5' OC AT 45 DEGREES AS SHOWN.
9. INSTALL CITY FURNISHED RUBBER WHEELS STOPS WITH WHITE STRIPE REFLECTORS AND OMEGAPOST WHITE DELINEATOR FROM "IMPACT RECOVERY SYSTEMS" PER DETAIL "D".
10. INSTALL TRUNCATED DOME.

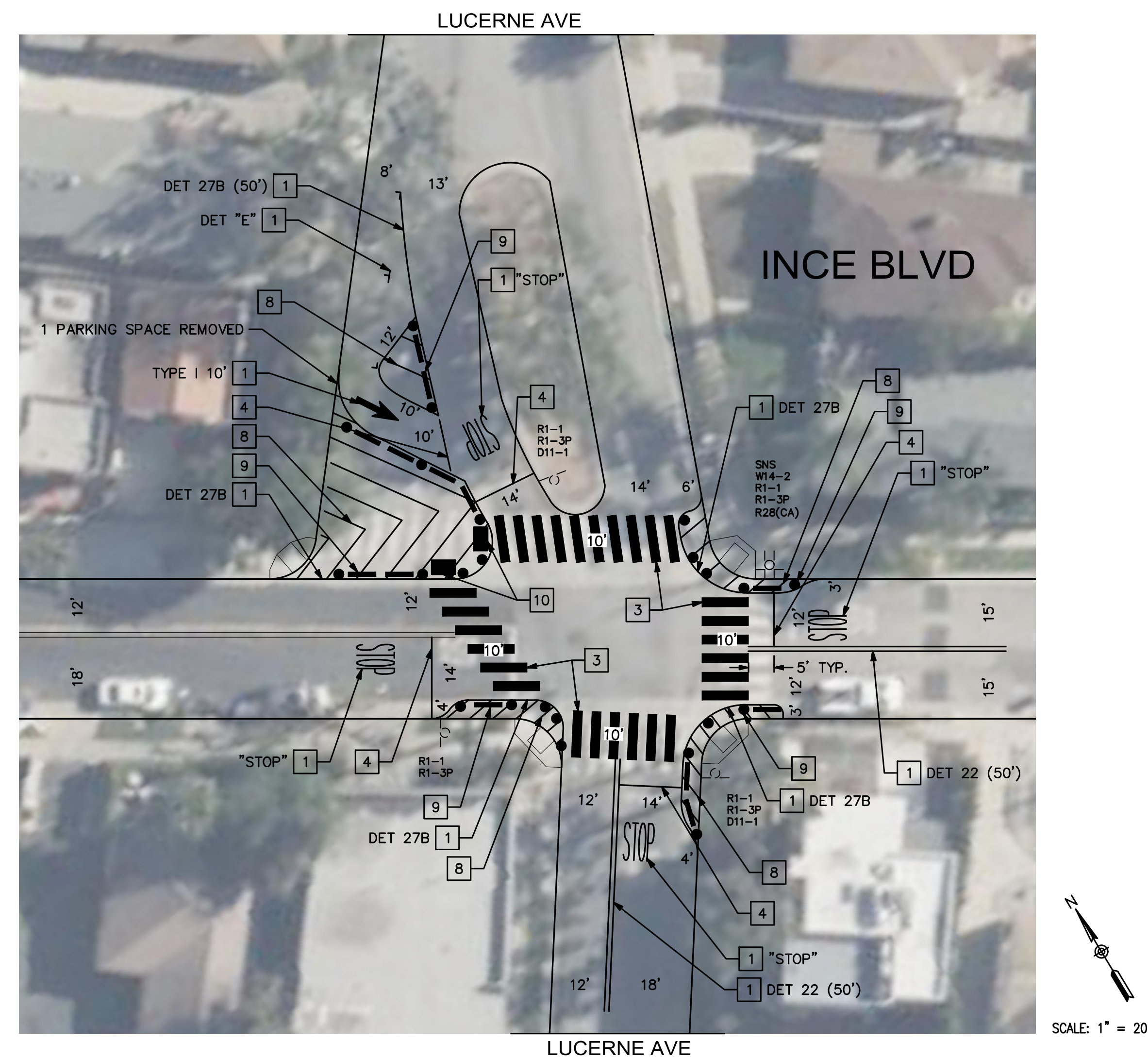

NO.

BY	APPR.	DATE
----	-------	------

Sheet 13 Of 13 Sheets

PLAN NO. C-12