

**Culver City Arts District
BID Proposed FY 2022-2023
Budget Considerations**

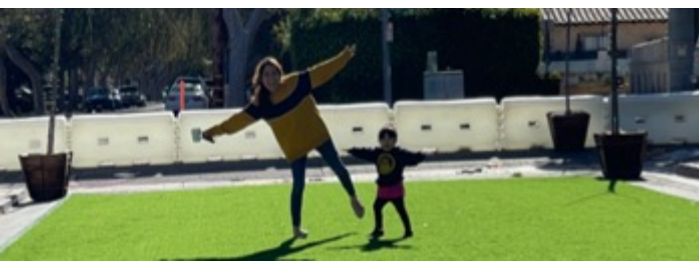



Culver City
ARTS DISTRICT

RIGHT
LANE
BUS
AND
BIKE
ONLY

FOR LEASE
MAUD
PROPERTIES
MAUDPROPERTIES.COM
(310) 553-5222

8553

Weekly Sweeping Needed
Inside Move Culver City Route



TOP

UARE

@adapperline

Stash Burger 17



LAMP STORE
WE DO NOT SELL GLASS...
WE MAKE ICE CREAM
NEXT DOOR → → → → →
PLEASE NO SOLICITING







Maintenance

String Lights



BIKE LANE
BEGIN

ARTS DISTRICT

NEW LEASE
NABD

25
MPH

A CITY

The image shows a street at night with a 'BIKE LANE BEGIN' sign in the foreground. The sign is white with a black border and features a bicycle icon above the text. The street is lined with trees decorated with vertical strings of warm white lights. A '25 MPH' speed limit sign is visible on the left side of the road. In the background, there are buildings, including one with a sign that says 'ARTS DISTRICT'. A 'NEW LEASE NABD' sign is also visible on a building. The street is illuminated by streetlights, and the overall atmosphere is festive and urban.

String Light Program Costs

PS= Per Strand

2.20.2020

Element	Description	Qty	Average Strands Per Tree	Bright (\$26 PS)	Brighter (\$30 PS)	Brightest (\$36 PS)
Jacaranda - Larger Multi Branch Trees	Lining the Median Center Islands - Wrap Every Tree to the Main Branches of Canopy.	74	20	\$38,480	\$44,400	\$53,280
Multi Branch Small	Lining the Median Center Islands - Wrap Every Tree to the Main Branches of Canopy.	28	10	\$7,280	\$8,400	\$10,080
Palm Tree w/ Decorative Fixture	Lining the North and South Bound Side Walk Palm Tree From the top of the Fixture to the very top of the palm Tree	53	22	\$30,316	\$34,980	\$41,976
Total		155		\$76,076	\$87,780	\$105,336
Jacaranda - Larger Multi Branch Trees	Lining the Median Center Islands - Wrap Every Tree to the Main Branches of Canopy.	37	20	\$19,240	\$22,200	\$26,640
Multi Branch Small			10	\$0	\$0	\$0
Palm Tree w/ Decorative Fixture	Lining the North and South Bound Side Walk Palm Tree From the top of the Fixture to the very top of the palm Tree	53	22	\$30,316	\$34,980	\$41,976
Total		90		\$49,556	\$57,180	\$68,616
Element	Description	Qty	Average Strands Per Tree	Bright (\$300 + \$243 Controllers)	Brighter (\$450 + \$243 Controllers)	Brightest (\$600 + \$243 Controllers)
Jacaranda - Larger Multi Branch Trees	RGB Tree Wrap - Two Trees Per Median - Strand Length 66'	28	6	\$57,204	\$82,404	\$107,604

Ballona Creek Monument



ARTS
DISTRICT

Culver CITY

↑ Hollywood Blvd
↓ Downtown

Ballona Creek

BALLONA CREEK





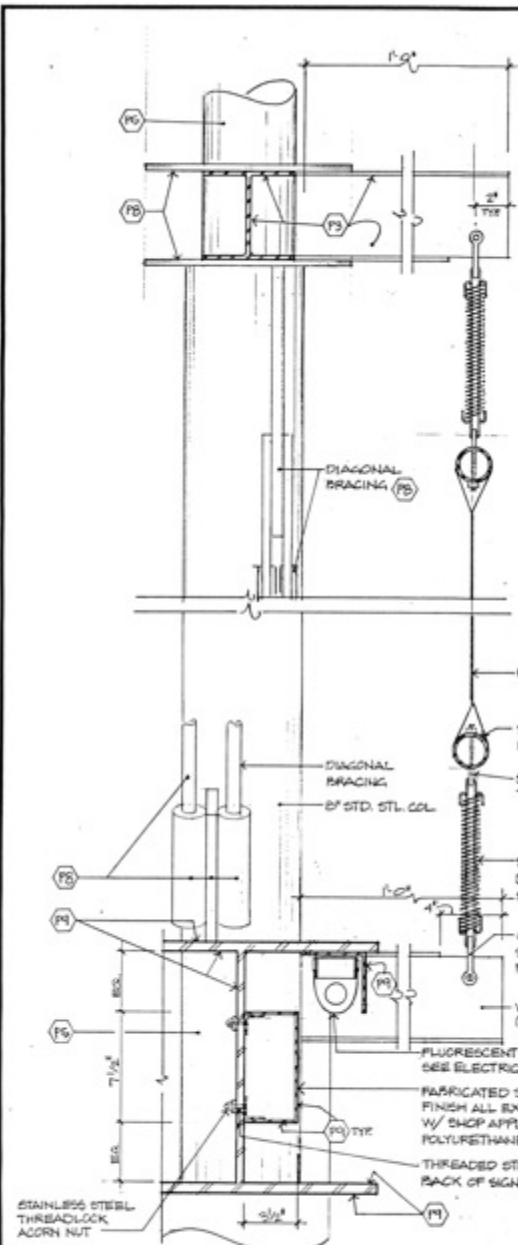

3 ELEVATION SHOWN FOR COLOR ONLY
1/2" = 1'-0"

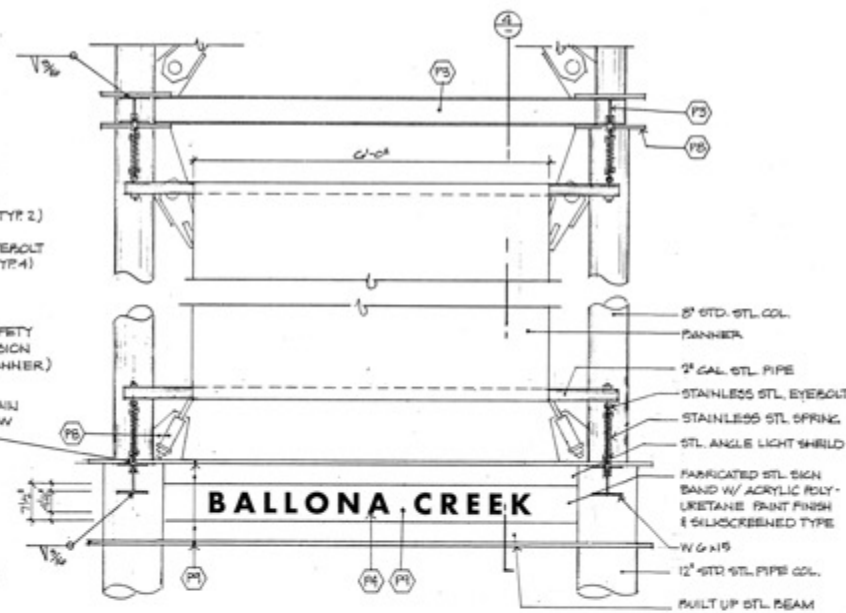
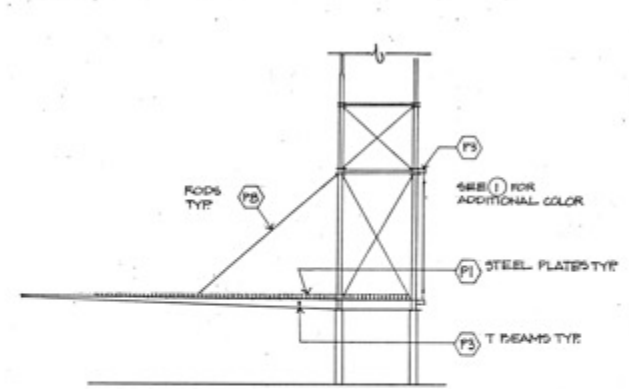

2 DETAIL ELEVATION
1" = 1'-0"

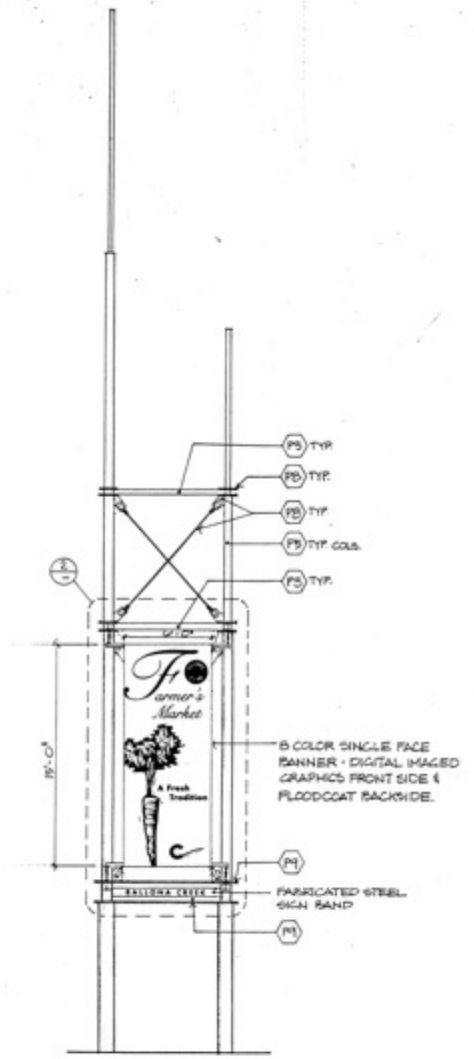

1 ELEVATION
1/4" = 1'-0"

RECORD DRAWING

NOTE: Q/P TO SUPPLY DIGITAL ARTWORK FOR SIGN & BANNER

CITY OF CULVER CITY	
ENGINEERING DIVISION	
EAST WASHINGTON BLVD. STREETScape	
BALLONA CREEK STRUCTURE	
SCALE: AS NOTED	DATE: 10-1-10
PROJECT: P-645	DESIGNED BY: [Signature]
NO. 36	REVISION
BY	APPR. DATE
Sheet 36 Of 78 Sheets	Plan No. 5043-125

Sussman/Projco & Company, Inc.
2940 Ince Blvd
Culver City
California 90232
310 534 3939 310 534 3940 FAX

A-7

PLATE NO. 5043-125

Monument Banner Program Costs

Quantity	Description	Unit Price	Amount
4	180"(h) x 72"(w) Vertical Balloon Creek Banners Printed on outdoor vinyl, Image on Front and Flood Coat on Back hem and grommets (4) Images- All 4 Color Process	895.00	3,580.00T
1	Installation and maintenance and repairs on existing frames. Maintenance includes normal wear & tear for 90 days (Maintenance due to any unforeseen circumstances will be charged extra).	850.00	850.00
1	Cost of supplies to repair the 2 missing springs	350.00	350.00

<p>Sales tax subject to change based on current sales tax rate at time of invoicing. Prices subject to change after review of supplied art. All claims for errors or allowances must be made in writing within 10 days from receipt of goods. No goods returnable without written consent.</p>	Sales Tax:	\$366.95
	TOTAL AMT. DUE	\$5,146.95

Melvil Parklet (Before)







Melvil Parklet (After)



Total Program Costs/Request

Culver City Arts District BID Proposed FY 2022-2023 Budget

Expense	Cost
Maintenance (Chrysalis)	
2 Sweepers & 1 Supervisor	Annual Cost \$80,000.00
Tree (String) Lighting	
155 Trees (Jacarandas, Medians & Palms)	\$105,000.00
Ballona Creek Gateway Monument Refurbishment	
Repair, Paint, Lighting and Banners	\$55,000.00
Melvil Parklet	
Programming (Cover by CCAD BID) & Maintenance	\$5,000.00
Total Funding Request	\$245,000.00

CCAD (assessments) will cover all administrative costs for the above projects.