

# EXHIBIT A

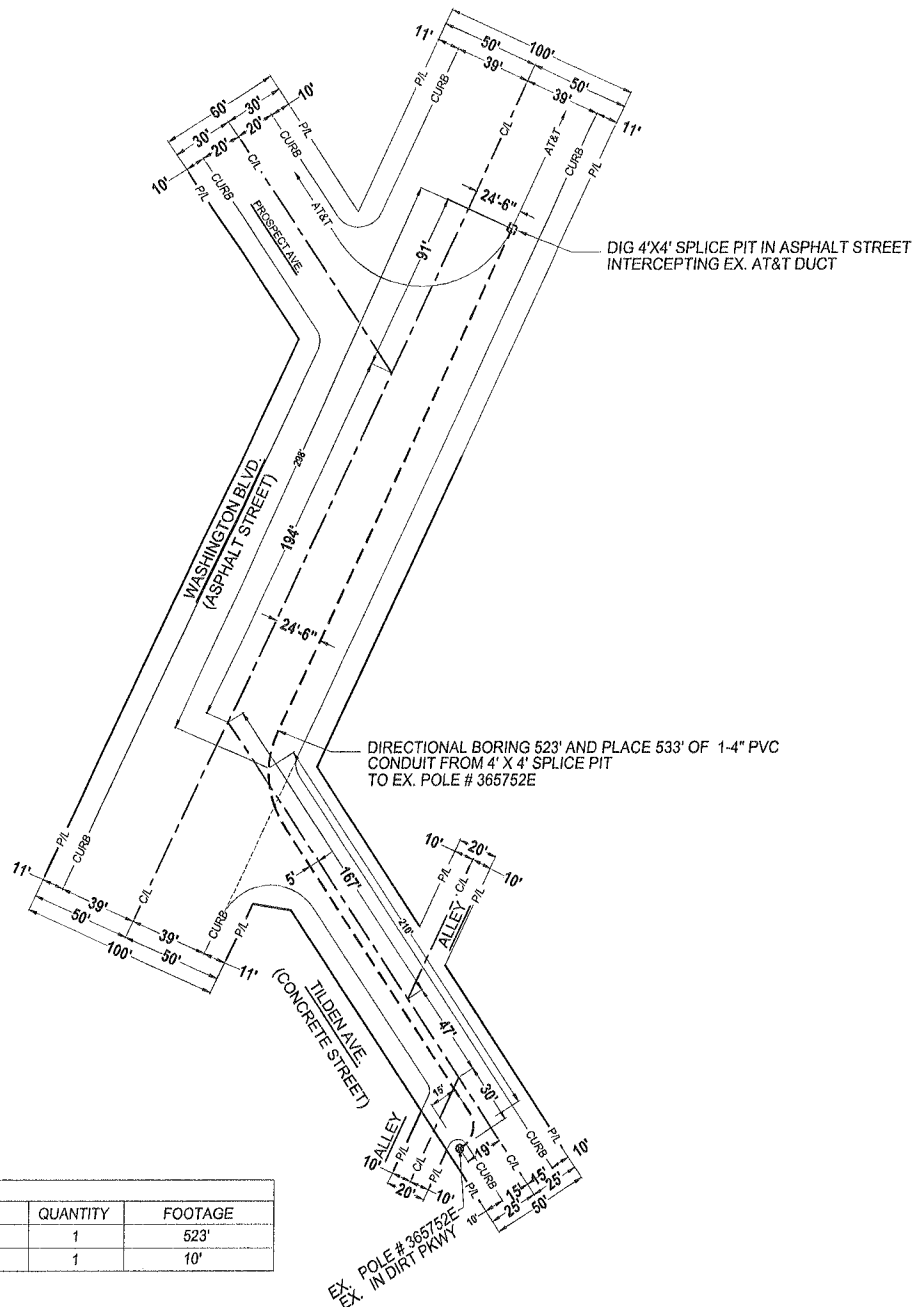

BILL OF MATERIAL			
NO.	MATERIAL	QUANTITY	FOOTAGE
1	4" PVC CONDUIT	1	523'
2	4" PVC RISER	1	10'

NO.	TYPE OF PLACEMENT	FOOTAGE
1	ASPHALT STREET SPLICE PIT	16 SQ. FT'
2	ASPHALT STREET LINEAR TRENCH	318'
3	CONCRETE STREET LINEAR TRENCH	205'

## LEGEND

PROPOSED U.G. — — — — —



OWNER / APPLICANT

OWNER : AT&T  
16201 RAYMER ST  
VAN NUYS, CA 91406

## DESCRIPTION::

AT&T is proposing to place 1-4" C-PC conduit from AT&T splice pit (located on the south side of Washington blvd. approximately 91 feet east of Prospect ave) to pole #365752E (located on the west side of the Tilden ave approximately 244 feet south of Washington blvd). Total directional boring and conduit placement should be approximately 523 feet of 4 inch conduit.

PROJECT # A00E8QH

SYSTEM EXHIBIT

