

Proposal for
City of Culver City

Prepared by



10-17-2025
Job # 115420-01

Culver West Alexander Park Playground Option 6A CPRS CWO



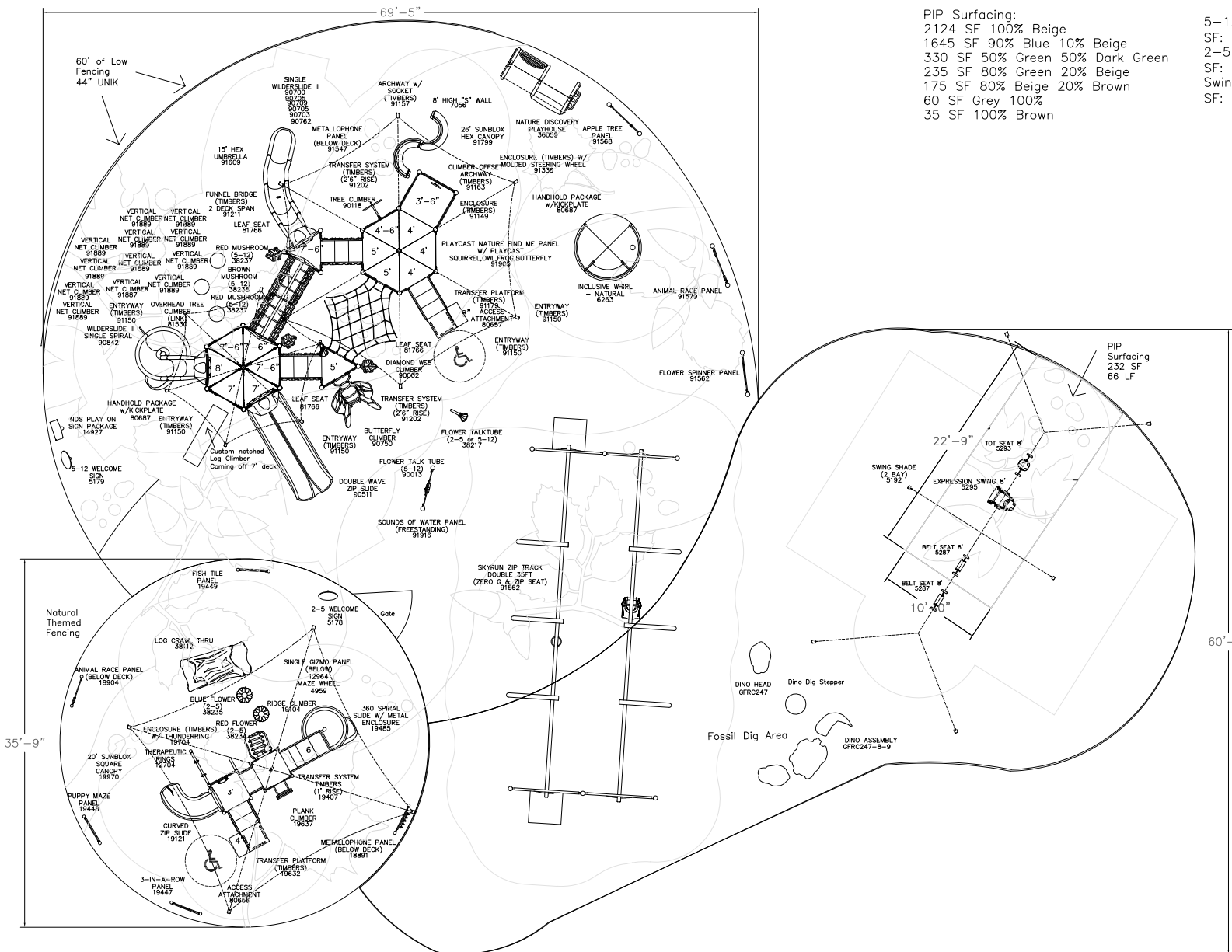

PIP Surfacing:
 2124 SF 100% Beige
 1645 SF 90% Blue 10% Beige
 330 SF 50% Green 50% Dark Green
 235 SF 80% Green 20% Beige
 175 SF 80% Beige 20% Brown
 60 SF Grey 100%
 35 SF 100% Brown

5-12 Area
 SF: 3,345/LF: 220
 2-5 Area
 SF: 1,004/LF:113
 Swing Pit:
 SF: 2,483/LF:222

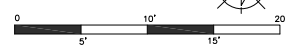
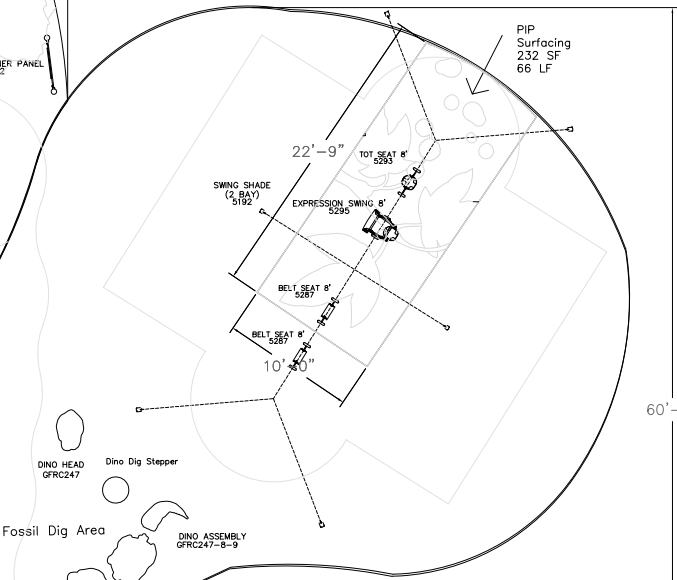
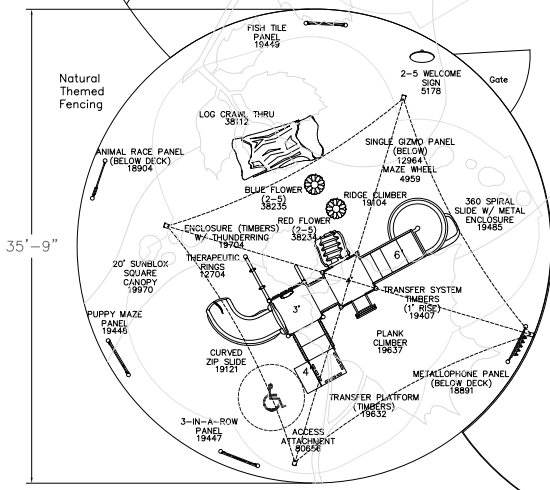

City of Culver City
 West Alexander Park Playgrounds
 Los Angeles, CA
 Representative
 Great Western Recreation

This Unit includes play events and
 SALES REP
 NATE YOUNKER
 858-344-0445
 NATE@GWPPARK.COM
 (representative of the AIAA (American
 with Disabilities Act)

Total Elevated Play Components	5/13	-	-
Total Elevated Play Components Accessible By Ramp	-	Required	-
Total Elevated Components Accessible By Transfer	5/13	Required	3/7
Total Accessible Ground Level Components Shown	10/28	Required	2/4
Total Different Types Of Ground Level Components	4/12	Required	2/3

This play equipment is recommended for children ages
 2-5/5 - 12

Minimum Area Required:
 -
 Scale: -
 This drawing can be scaled only when in an 18" x 24" format.

IMPORTANT: Soft resilient surfacing should be placed in the use zones of all equipment, as specified for each type of equipment, and at depths to meet the critical fall heights as specified by the U.S. consumer Product Safety Commission, ASTM standard F 1487 and Canadian Standard CAN/CSA-Z-614

Drawn By:
 VF
 Date:
 08/28/2025
 Drawing Name:
 115420-01-Opt 5



GameTime C/O Great Western Recreation
 P.O. Box 680121
 Fort Payne, AL 35967
 Office: 435-245-5055 Fax: 435-245-5057
 www.gwpark.com

10/17/2025
 Quote #
 115420-01-05

Culver West Alexander Park Playground Option 6A CPRS CWO

City of Culver City
 Attn: Ted Stevens
 4117 Overland Ave
 Culver City, CA 90232
 United States
 Phone: (310) 253-6650

Ship to Zip 90066

Quantity	Part #	Description	Unit Price	Amount
2-5 Playground Equipment				
1	RDU	GameTime - Custom 2-5 Playground-Reference Drawing 115420-01-Opt 5	\$44,465.00	\$44,465.00
1	RDU	GameTime - 2-5 Freestanding Equipment not Eligible for CPRS Grant Pricing-Reference Drawing 115420-01-Opt 5	\$27,707.00	\$27,707.00
1	5178	GameTime - Welcome Sign (2-5)	\$774.00	\$774.00
5-12 Playground Equipment				
1	RDU	GameTime - Custom 5-12 Playground-Reference Drawing 115420-01-Opt 5	\$179,155.00	\$179,155.00
1	RDU	GameTime - 5-12 Freestanding Equipment not Eligible for CPRS Grant Pricing-Reference Drawing 115420-01-Opt 5	\$47,876.00	\$47,876.00
1	5179	GameTime - Welcome Sign (5-12)	\$774.00	\$774.00
Freestanding Equipment Not Eligible for CPRS Grant Pricing				
1	91862	GameTime - SkyRun Zip Track 35 ft Zero G & Zip Db	\$32,069.00	\$32,069.00
1	6263	GameTime - Inclusive Whirl - Natural	\$16,933.00	\$16,933.00
1	601TSA	Landmark Design GFRC - Fossil Dig Steppers 5 pieces	\$14,200.00	\$14,200.00
1	602TSA	Landmark Design GFRC - Dino Fossil Dig 2 pieces	\$20,000.00	\$20,000.00
1	Log	Landmark Design GFRC - 7' Notched Log Climber	\$24,000.00	\$24,000.00
1	RDU	GameTime - Custom Swings-Reference Drawing 115420-01-Opt 5	\$2,983.00	\$2,983.00
1	5192	GT-Shade - Double Bay Swing Shade	\$14,072.00	\$14,072.00
1	14927	GameTime - NDS Play On Sign Package		
1	178749	GameTime - Owner's Kit	\$92.08	\$92.08





GameTime C/O Great Western Recreation
 P.O. Box 680121
 Fort Payne, AL 35967
 Office: 435-245-5055 Fax: 435-245-5057
 www.gwpark.com

10/17/2025
 Quote #
 115420-01-05

Culver West Alexander Park Playground Option 6A CPRS CWO

Quantity	Part #	Description	Unit Price	Amount
4605	PIP	GT-Impax - PIP Surfacing- <ul style="list-style-type: none"> • 1004 SF, 4' CFH • Quote includes a 1.5" cushion layer and a 0.5" wear layer • 3601 SF, 8' CFH • Quote includes a 3.25" cushion layer and a 0.5" wear layer • Includes (6) color mixes - see below for breakdown: <ul style="list-style-type: none"> ◦ 1645 SF with a color mix of 90% Blue & 10% Beige ◦ 330 SF with a color mix of 80% Green & 20% Beige ◦ 235 SF with a color mix of 50% Green & 50% Dark Green ◦ 35 SF with a color mix of 100% Brown ◦ 175 SF with a color mix of 80% Beige & 20% Brown ◦ 60 SF with a color mix of 100% Grey • Design includes a stream with stones, stems & leaves using the (6) colors listed above • Chunk Cushion • No TTA • Aliphatic Binder • Prevailing Wages 	\$23.72	\$109,230.60





GameTime C/O Great Western Recreation
 P.O. Box 680121
 Fort Payne, AL 35967
 Office: 435-245-5055 Fax: 435-245-5057
 www.gwpark.com

10/17/2025
 Quote #
 115420-01-05

Culver West Alexander Park Playground Option 6A CPRS CWO

Quantity	Part #	Description	Unit Price	Amount
1	Omega	OMEGA II - Omega Fencing- Includes: Qty 27 - C-DP1/84468ALBK; OMEGA UNIK PANEL 44" H X 67-3/4" L - REF. #9 COMPLEX C - ALUMINUM 1/8" THICK - SPECIAL COLOR Qty 2 - C-DP1/8ALPANDIV; OMEGA UNIK PANEL 44" H X LENGTH TBD - REF. #9 COMPLEX C - ALUMINUM 1/8" THICK - SPECIAL COLOR Qty 30 - C-POTDIV; OMEGA UNIK ANGLE FOLDED PLATE POST 3/16" X 46" H X ANGLE TBD - PREDRILLED HOLES FOR PANEL INSTALLATION – WITH 8"X8"X3/8" BASE PLATE – SPECIAL COLOR Qty 120 - C-DP5/16X1/4TAMPK; HARDWARE KIT FOR OMEGA UNIK PANELS Qty 1 - C-GDPDSP; DOUBLE DOOR OMEGA UNIK : 90" OPG X 44" H - PANEL REF. #9 COMPLEX C - SPECIAL COLOR **ABOVE GATE PRICE INCLUDES 4" FLANGED POSTS, CAPS, AND STANDARD HARDWARE. OMEGA RECOMMENDS INGROUND POSTS FOR GATES. THE CUSTOMER IS RESPONSIBLE TO ENSURE THE STABILITY OF THE GATE WITH BASE PLATED POSTS // OPENING TO BE CONFIRMED BY CUSTOMER. Qty 4 - C-PC5/16X3TAMPK; HARDWARE KIT FOR OMEGA UNIK 3" SQUARE POST Qty 2 - C-PFDP11GA3SP; OMEGA UNIK SQUARE POST 3" X 11GA X 46" H. - PRE-DRILLED - BASE PLATE 6" X 6" X 3/8" - SPECIAL COLOR Qty 2 - C-CAP3ALSP; POST CAP 3"x3"ALUMINUM SPECIAL COLOR Qty 1 - C-HDWGLDKSP; DOUBLE GATE HARDWARE KIT FOR OMEGA MAX, LOUVER AND UNIK GATE OPG MAX 12' – SPECIAL COLOR Special Color Fee included	\$60,261.58	\$60,261.58
1	TRF	OMEGA II - Tarif OMEGA - CAN 50	\$20,265.04	\$20,265.04
1	INSTALL	Install - Mobilization- <ul style="list-style-type: none"> Furnish 370 LF of Temp Fence Furnish site facilities for duration of project Furnish Container for duration of project Prevailing Wage. 	\$5,515.00	\$5,515.00
1	INSTALL	Install - Demo Existing Equipment- <ul style="list-style-type: none"> Remove and dispose of existing play equipment Remove and dispose of existing PIP – 4609 SF Remove and dispose of existing 42" high fence – 115 LF Includes all Labor & Material Includes Removal of all Trash and Spoil Prevailing Wage. 	\$41,965.00	\$41,965.00





GameTime C/O Great Western Recreation
 P.O. Box 680121
 Fort Payne, AL 35967
 Office: 435-245-5055 Fax: 435-245-5057
 www.gwpark.com

10/17/2025
 Quote #
 115420-01-05

Culver West Alexander Park Playground Option 6A CPRS CWO

Quantity	Part #	Description	Unit Price	Amount
1	INSTALL	Install - Equipment Install Per Drawing 115420-01-Opt 5- <ul style="list-style-type: none"> • Install GT Equipment • Install GFRC Fossil Pieces • Includes all Labor & Material • Includes Removal of all Trash and Spoil • Prevailing Wage. 	\$155,000.00	\$155,000.00
1	INSTALL	Install - Concrete for PIP- <ul style="list-style-type: none"> • Install 120 SF of Concrete to Expand Swing PIP Area • Includes all Labor & Material • Includes Removal of all Trash and Spoil • Prevailing Wage. 	\$3,675.00	\$3,675.00
1	INSTALL	Install - Fence- <ul style="list-style-type: none"> • Install new Omega II UNIK fence – 115 LF w/ one gate • SafePlay to Furnish Mounting Hardware • Includes all Labor & Material • Includes Removal of all Trash and Spoil • Prevailing Wage. 	\$11,510.00	\$11,510.00
Sub Total				\$832,522.30
Grant				(\$139,631.02)
GameTime Freight				\$17,234.06
GT-Shade Freight				\$2,715.89
Landmark Design GFRC Freight				\$5,540.00
OMEGA II Freight				\$4,670.00
Tax				\$36,301.72
Total				\$759,352.95





GameTime C/O Great Western Recreation
P.O. Box 680121
Fort Payne, AL 35967
Office: 435-245-5055 Fax: 435-245-5057
www.gwpark.com

10/17/2025
Quote #
115420-01-05

Culver West Alexander Park Playground Option 6A CPRS CWO

Comments

Your Sales Rep is Nate Younker. Please reach out to Nate at 858-344-0445 if you should have any questions regarding this quote.

Due to the volatility of freight costs, the freight pricing is subject to change at the time of order.

Pricing is subject to change. Request updated pricing when purchasing from quotes more than 30 days old.

***OPTIONAL-To include a Payment and Performance Bond, please add 11,596.

***Grant Cash with Order Pricing--order MUST be paid in full at time of order.

***Pricing is based on Grant 2025 pricing. Orders MUST be placed before October 25, 2025, and MUST be shipped by December 31, 2025 to qualify for Grant Pricing.

***Not all equipment is eligible for Grant Pricing.

Shipping to Site Address:

Arturo Gonzalez
323-812-7939
arturo@safeplayinc.com
4162 Wade St
Los Angeles, CA 90066

Owner's Kit:

Ted Stevens
Culver City Parks
Ted.Stevens@culvercity.org
(310) 253-6650
4117 Overland Ave
Culver City, CA 90230

*Freight charges are based on listed zip code and are subject to change if shipping information changes.

*Deposit may be required.

Permitting not included, unless otherwise noted.

Customer is responsible for offloading.

Prevailing wages.

Minimum Deposit of \$19,253.50 required for custom GFRC items





GameTime C/O Great Western Recreation
P.O. Box 680121
Fort Payne, AL 35967
Office: 435-245-5055 Fax: 435-245-5057
www.gwpark.com

10/17/2025
Quote #
115420-01-05

Culver West Alexander Park Playground Option 6A CPRS CWO

Remit Payment to:

GameTime
P.O. Box 680121
Fort Payne, AL 35968

Taxes:

All applicable taxes will be added at time of invoicing unless otherwise included or a tax-exempt certificate is provided.
If sales tax exempt, you must provide a copy of certificate to be considered exempt.

Prices:

FOB Factory.

Orders:

All orders shall be in writing by purchase order, contract, or similar document made out to PlayCore Wisconsin Inc., dba GameTime.
Standard GameTime equipment orders over \$100,000 may require a deposit of 25% at the time of order and an additional 25% at or before order ships.
Standard orders with equipment, installation and surfacing are requested to be split billed.
Equipment, Taxes & Freight as noted above
Installation and Surfacing billed as completed and Due Upon Receipt.

Terms:

Cash With Order Discount (CWO): Orders for GameTime equipment paid in full at time of order via check, Electronic Funds Transfer (ACH or wire) are eligible for a three percent (3%) cash with order discount.

Payment via credit card: If you elect to pay by credit card, GameTime charges a 2.50% processing fee that is assessed on the amount of your payment. This fee is shown as a separate line item and included in the total amount charged to your credit card. You have the option to pay by check, ACH or Wire without any additional fees.

Credit terms are Net 30 days, subject to approval by the GameTime Credit Manager. A completed credit application must be submitted and approved prior to the order being received. Please allow at minimum 2 days for the credit review process. GameTime may also require:

Completed Project Information Sheet (if applicable)

Copies of Payment and Performance Bonds (if applicable)

A 1.5% per month finance charge will be imposed on all past due invoices.

Retainage not accepted.

Orders under \$5,000 require payment with order.

Landmark Design GFRC:

Orders require a 50% deposit at the time of order.





GameTime C/O Great Western Recreation
P.O. Box 680121
Fort Payne, AL 35967
Office: 435-245-5055 Fax: 435-245-5057
www.gwpark.com

10/17/2025
Quote #
115420-01-05

Culver West Alexander Park Playground Option 6A CPRS CWO

ACCEPTANCE OF QUOTATION:

Billing and Shipping information will be as stated on quote unless indicated below.

Change billing information to:

Address: _____

Contact: _____

Change shipping information to:

Address: _____

Contact: _____

Colors: Per Renderings Yes or No

Palette _____

Per Submittals _____

Other Colors, please specify _____

Purchase Amount: **\$759,352.95**

Signature: _____ **Date:** _____

Printed Name: _____ **Title:** _____

Acceptance of this proposal indicates your agreement to the terms and conditions stated herein.

DIR# 1000015526 CSLB#855664





GameTime C/O Great Western Recreation
P.O. Box 680121
Fort Payne, AL 35967
Office: 435-245-5055 Fax: 435-245-5057
www.gwpark.com

10/17/2025
Quote #
115420-01-05

Culver West Alexander Park Playground Option 6A CPRS CWO

INSTALLATION CONDITIONS:

- **ACCESS:** Site should be clear, level and allow for unrestricted access of trucks and machinery.
- **STORAGE:** Customer is responsible for providing a secure location to off-load and store the equipment during the installation process. Once equipment has delivered to the site, the owner is responsible should theft or vandalism occur unless other arrangements are made and noted on the quotation.
- **FOOTER EXCAVATION:** Installation pricing is based on footer excavation through earth/soil only. Customer shall be responsible for unknown conditions such as buried utilities (public & private), tree stumps, rock, or any concealed materials or conditions that may result in additional labor or materials cost.
- **UTILITIES:** Owner is responsible for locating any private utilities.
- **ADDITIONAL COSTS:** Pricing is based on a single mobilization for installation unless otherwise noted. Price includes ONLY what is stated in this quotation. If additional site work or specialized equipment is required, pricing is subject to change.

