

Culver **CITY**
PARKS, RECREATION & COMMUNITY SERVICES

PARKS PLAN

PRCS Commission Meeting
September 2024



OLIN

Geosyntec, The Robert Group, Agora, Leland Saylor

TONIGHT'S TOPICS

PROJECT TIMELINE

**ENGAGEMENT
UPDATE &
PRELIMINARY
SURVEY RESULTS**

**PLANNING PROCESS
& ANALYSIS**

**DRAFT VISION,
MISSION, & GOALS**

STRATEGIES

**SITE-SPECIFIC
PARK IDEAS**

PROJECT TIMELINE

Meetings with interested partners, research, analysis, and review of planning documents

Generating design ideas and vision alternatives based on community input

Refining the selected alternative into a draft Parks Plan

Responding to comments and finalizing the Parks Plan

WE ARE HERE

2024

2025



COMPLETED COMMUNITY ENGAGEMENT EVENTS

MEETING PEOPLE WHERE THEY ARE

COMMUNITY MEETINGS

POP UPS

WEBSITE

SURVEY

YOUTH CAMP

SOCIAL MEDIA

DEPARTMENTAL MEETINGS

KEY GROUP MEETINGS

COMMISSION MEETINGS

COMPLETED COMMUNITY ENGAGEMENT EVENTS

MEETING PEOPLE WHERE THEY ARE

COMMUNITY MEETINGS

Community Meeting 1

May 1, 2024 (Syd Kronenthal Park)

Community Meeting 2

May 2, 2024 (Virtual)

Community Meeting 3

May 14, 2024 (El Marino Park)

Virtual Summer Community Meeting

May 14, 2024 (Virtual)

POP UPS & YOUTH CAMP

Dances for the Developmentally Disabled (DDD) and Socialites

June 14, 2024 (Senior Center)

Parks Plan Table at Culver West Alexander Park

May June 26, 2024 (Culver West Alexander Park)

Love Local x Helms Market

June 28, 2024 (Helms Walk)

Culver City Farmers Market

June 16, 2024 (Downtown Culver City)

PRCS Youth Camp

July 8, 2024 (Veterans Memorial Park)

Movies in the Park

July 20, 2024 (Fox Hills Park)

Culver City Senior Center

July 24, 2024 (Senior Center)

Culver City Farmers Market

July 30, 2024 (Downtown Culver City)

Fiesta La Ballona

August 24, 2024 (Veterans Memorial Park)

COMMUNITY MEETINGS

Welcome



Meeting 1: Syd Kronenthal Park
Image Source: OLIN, 2024.



Meeting 3: El Marino Park
Image Source: OLIN, 2024.



Meeting 1: Syd Kronenthal Park
Image Source: OLIN, 2024.

POP UPS



Dances for the Developmentally Disabled (DDD) and Socialites
Image Source: OLIN, 2024.



CULVER CITY PARKS PLAN | PRCS COMMISSION MEETING | SEPTEMBER 2024
DRAFT

Parks Plan Table at Culver West Alexander Park
Image Source: OLIN, 2024.



Love Local x Helms Market
Image Source: OLIN, 2024.

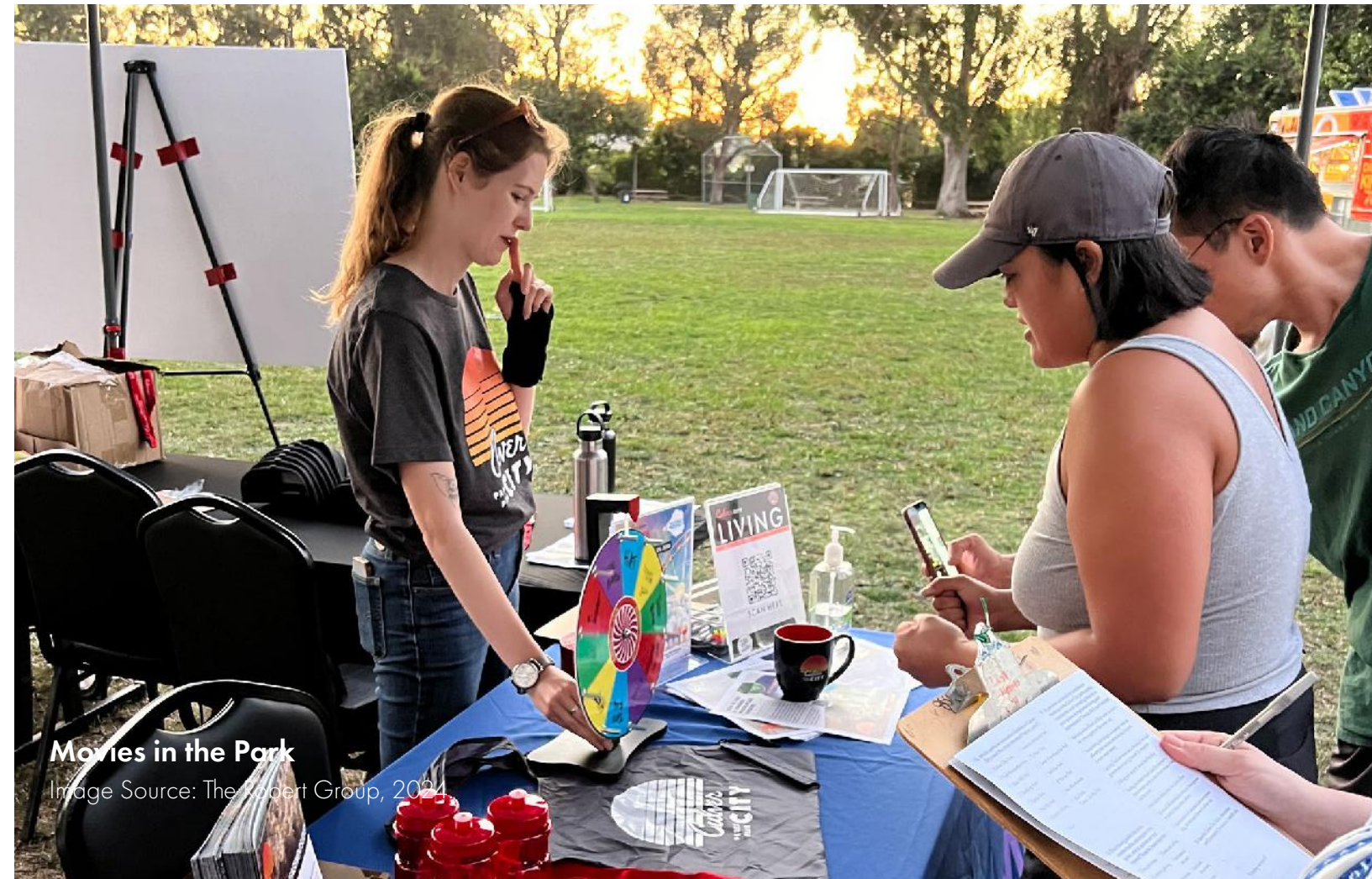

Movies in the Park
Image Source: The Robert Group, 2024.

POP UPS



Culver City Farmers Market
Image Source: The Robert Group, 2024.



Culver City Senior Center
Image Source: The Robert Group, 2024.



Fiesta La Ballona
Image Source: OLIN, 2024.



Fiesta La Ballona
Image Source: OLIN, 2024.

YOUTH CAMP



COMMUNITY ENGAGEMENT

ANALOG ENGAGEMENT



Mailers Sent to Every Culver City Household



English and Spanish Flyer Distribution at Community Gathering Spaces



Vinyl Banners Posted Throughout Culver City Parks

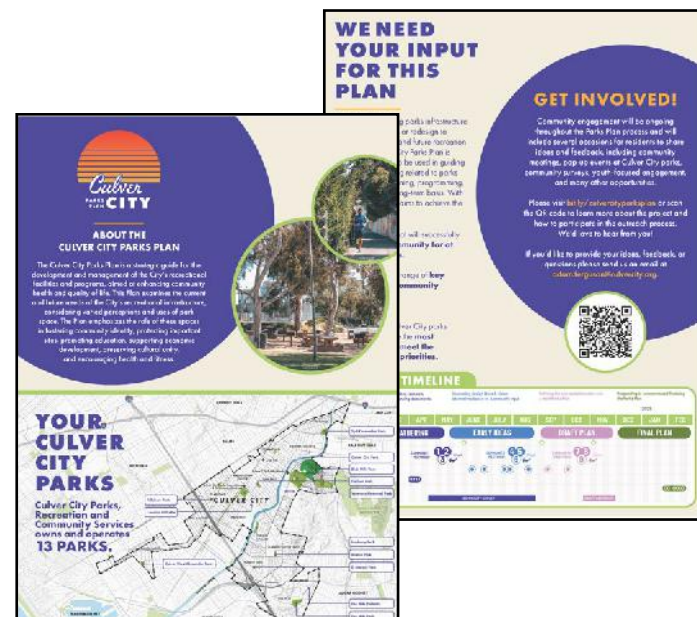

English and Spanish Fact Sheets

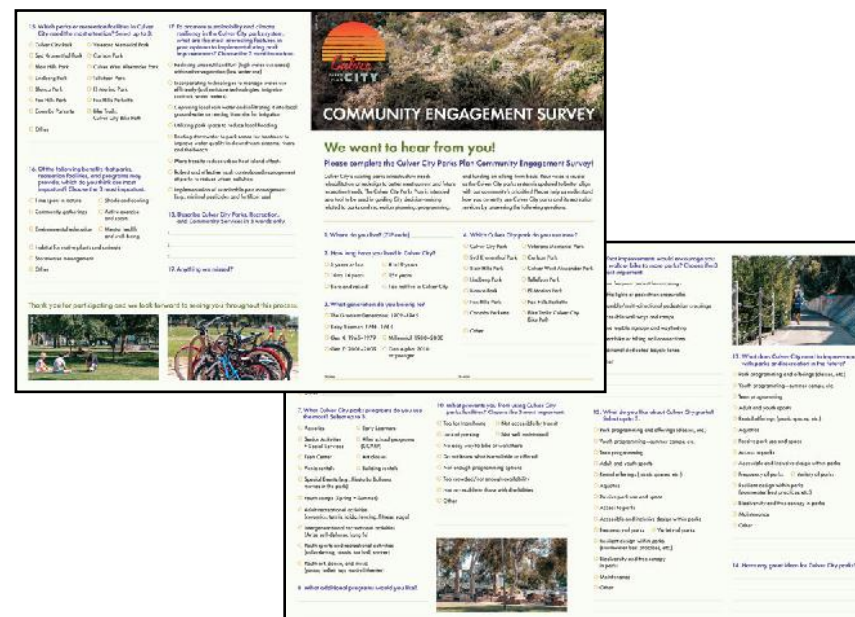

English and Spanish Paper Survey

COMMUNITY ENGAGEMENT

DIGITAL ENGAGEMENT

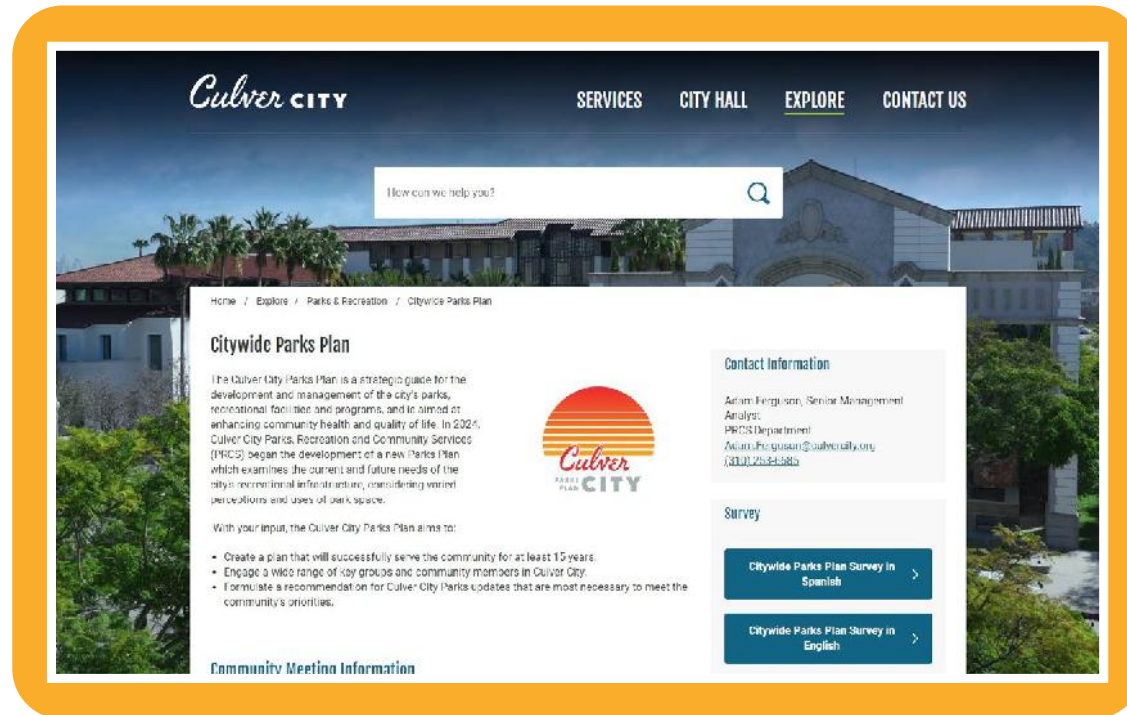

PRCS Landing Page

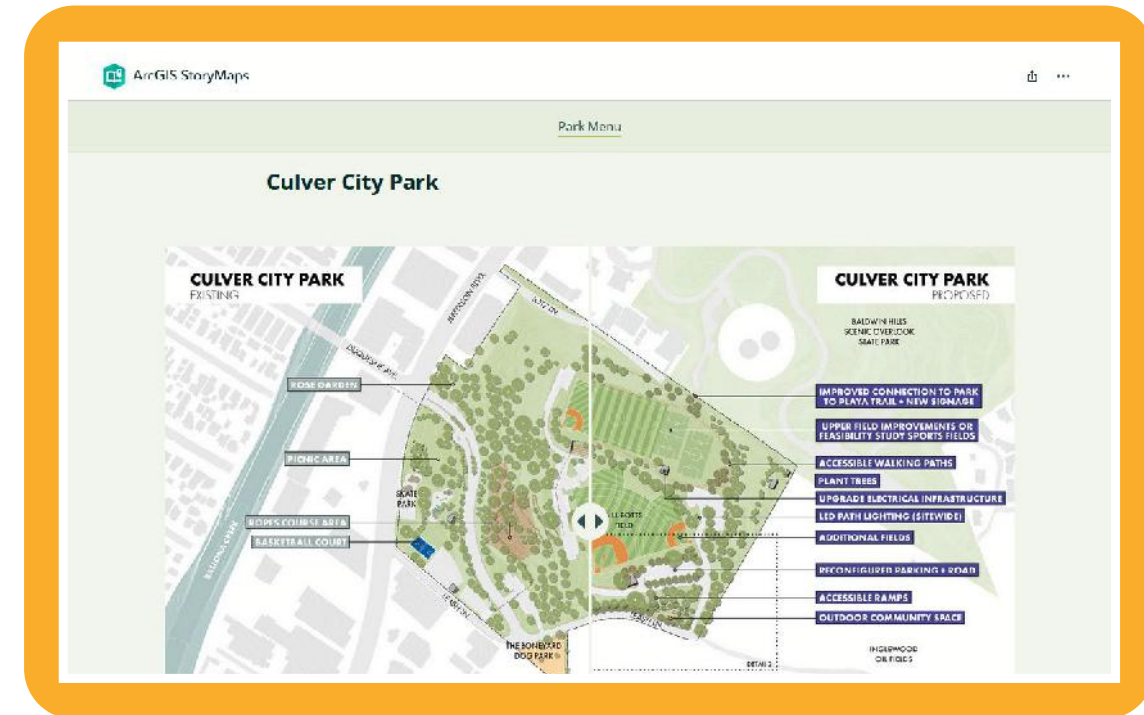

Story Map



Virtual Meeting Recording



English and Spanish Digital Survey

PROJECT COORDINATION

CITY DEPARTMENTS

PUBLIC WORKS

**DEPARTMENT
OF ADVANCED
PLANNING**

PRCS STAFF SUMMIT

INTERESTED PARTNER MEETINGS

**CULVER CITY ARTS
FOUNDATION**

**CCUSD
ENVIRONMENTAL
SUSTAINABILITY
COMMITTEE**

**DISABILITY ADVISORY
COMMITTEE**

SURVEY RESPONSES

COUNT AS OF 8/22/2024

718+

PRELIMINARY SURVEY RESULTS

WHERE ARE YOU FROM?

MAP LEGEND

Culver City Boundary

Culver City Parks

IN-PERSON RESPONSES

Where are you from?

SURVEY RESPONSES

Zipcode from Survey through 8/26/24

Didn't Answer: 39

**NOT ON THIS MAP?
PLACE A STICKER HERE!**



Map of community meeting responses to "Where are you from?" and survey responses to "Where do you live? (ZIP Code)"

Source: LA County GIS Data Portal, Countywide Parks and Open Space, Countywide Multi-Use Trails, LA County Bikeways, & Significant Ecological Area, 2022; Los Angeles Region Imagery Acquisition Consortium (LARIAC), 2016. OLIN, Community Meeting at Syd Kronenthal Park, May 1, 2024. OLIN, Community Meeting at El Marino Park, May 14, 2024. Culver City Community Engagement Survey, Data as of August 22, 2024 and online responses through August 26, 2024.

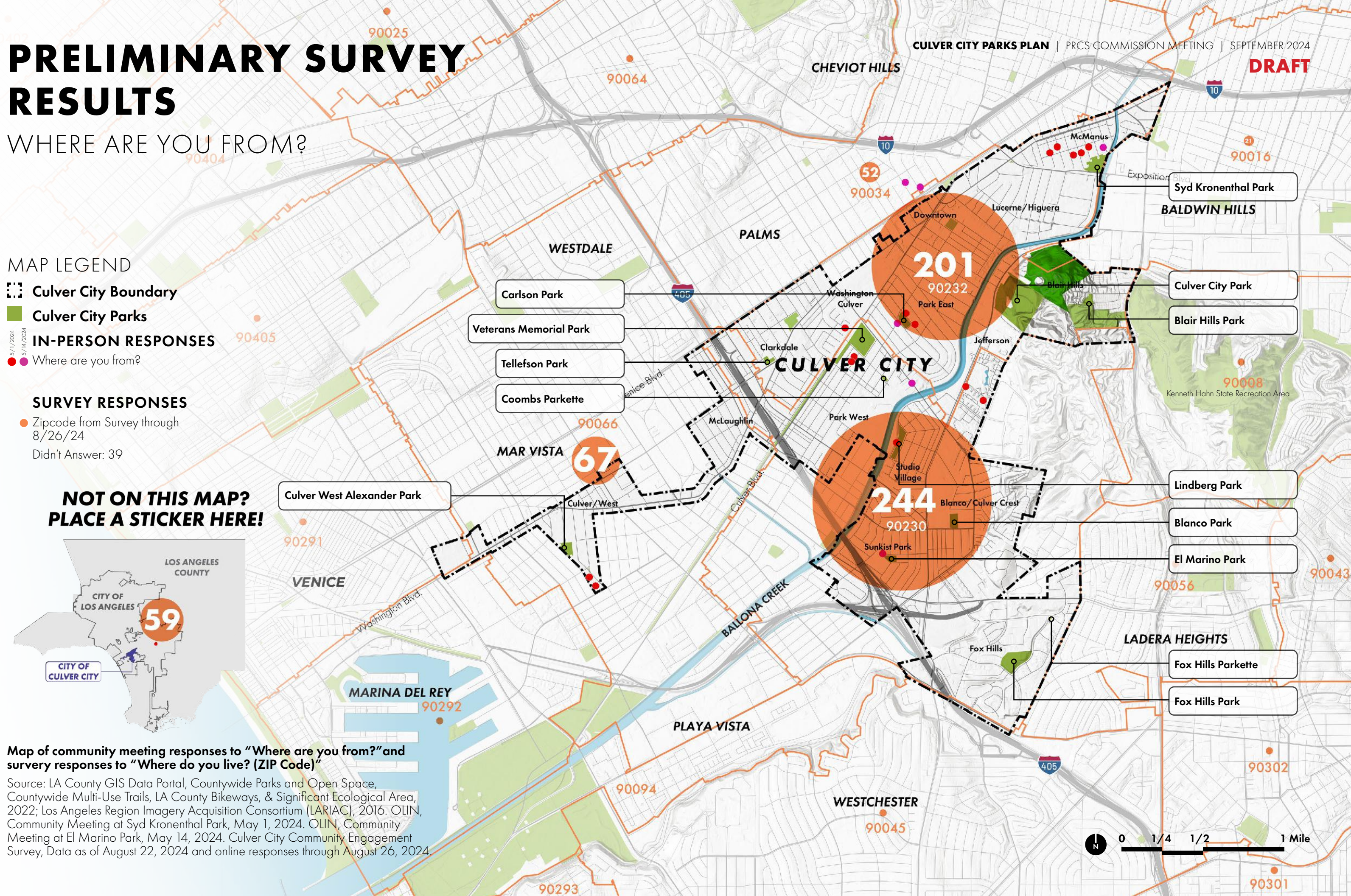

PRELIMINARY SURVEY RESULTS

SUMMARY

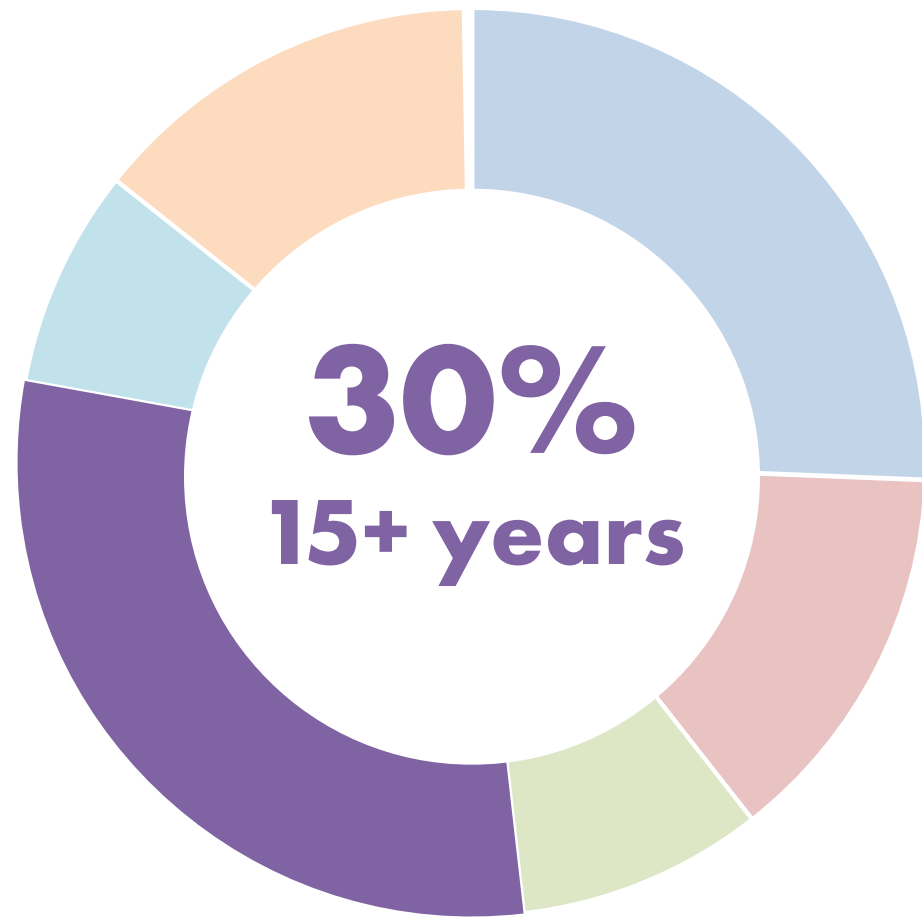

HOW LONG HAVE YOU LIVED IN CULVER CITY?

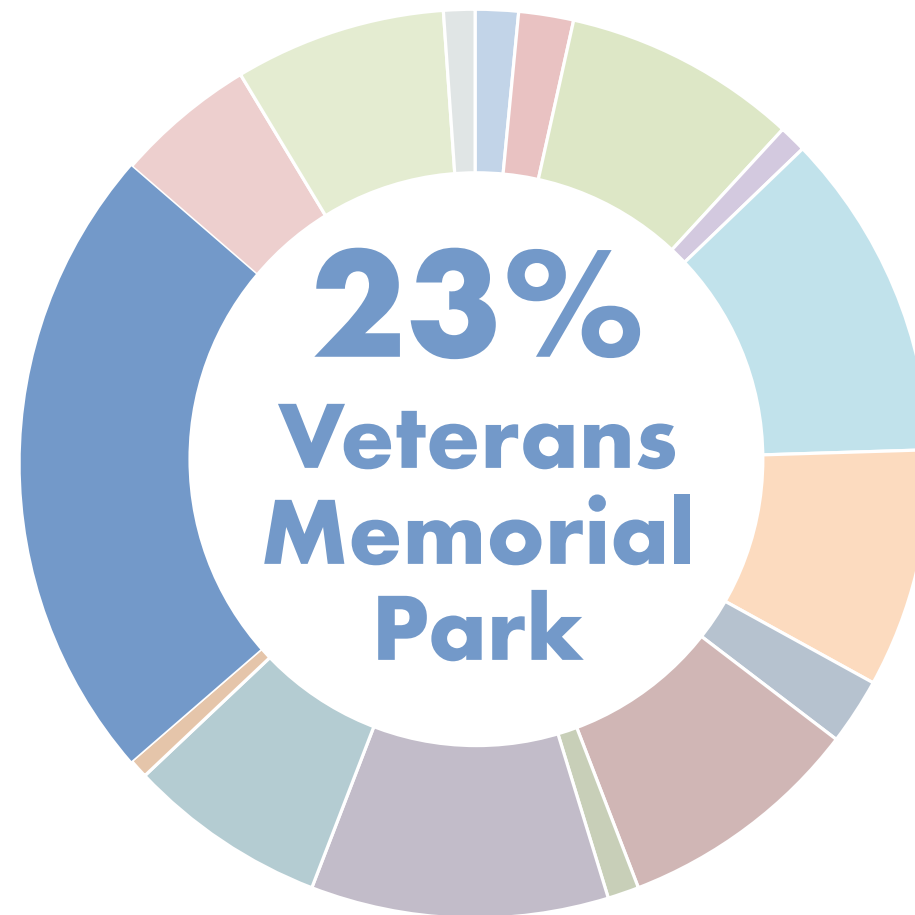

WHICH CULVER CITY PARK DO YOU USE THE MOST?

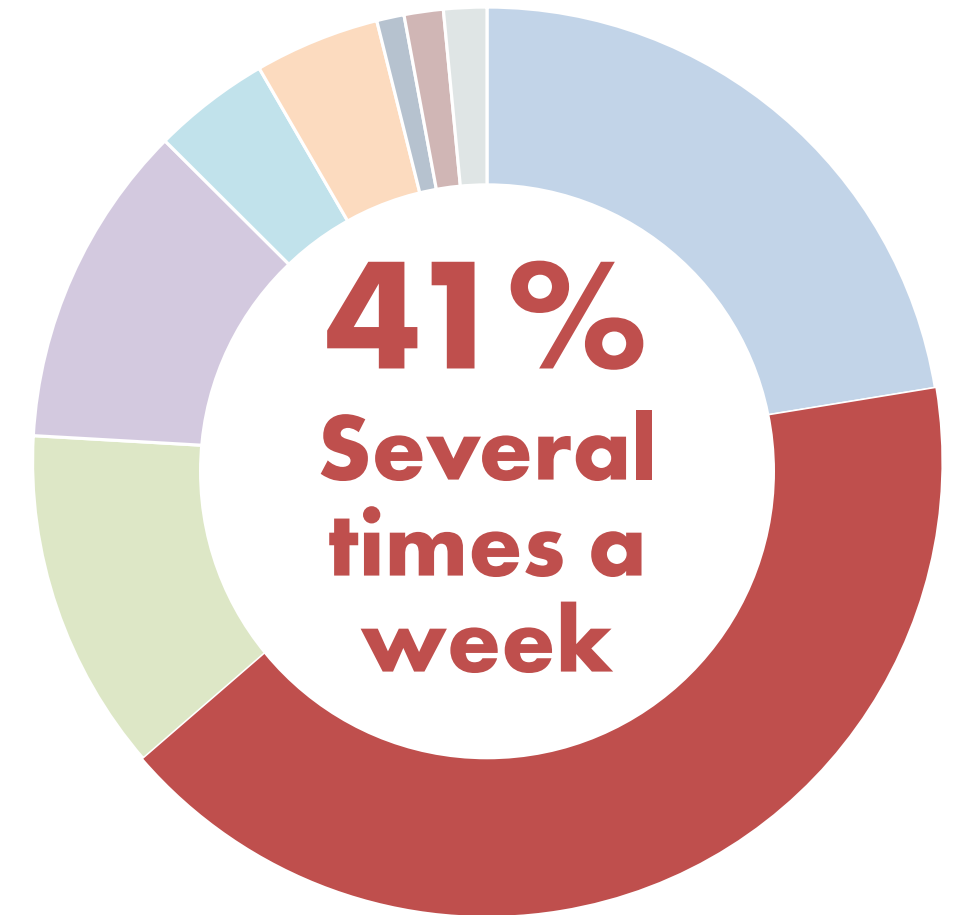

HOW FREQUENTLY DO YOU SPEND TIME IN CULVER CITY PARKS?

WHAT WE HEARD

QUOTES FROM SURVEY
OPEN ENDED RESULTS

“Love the idea of moving away from lawn to more dynamic waterwise spaces in underused areas.”

“Thank you for your work currently and for your efforts in expanding and improving our vital community parks.”

“Please make accessibility a priority so the parks can be utilized and enjoyed by ALL.”

“[I’d like to see] Senior programs and activities in all your parks.”

“Keep connecting with the community and provide transparency in all decision making.”

PLANNING PROCESS & ANALYSIS

NEEDS ANALYSIS

PLANNING PROCESS



OPPORTUNITY ANALYSIS

PLANNING PROCESS

Existing Parkland
Potential Acquisitions
Partnerships
Arts, Schools, Streetscapes



OPPORTUNITY

NEEDS + OPPORTUNITY OVERLAY

PLANNING PROCESS

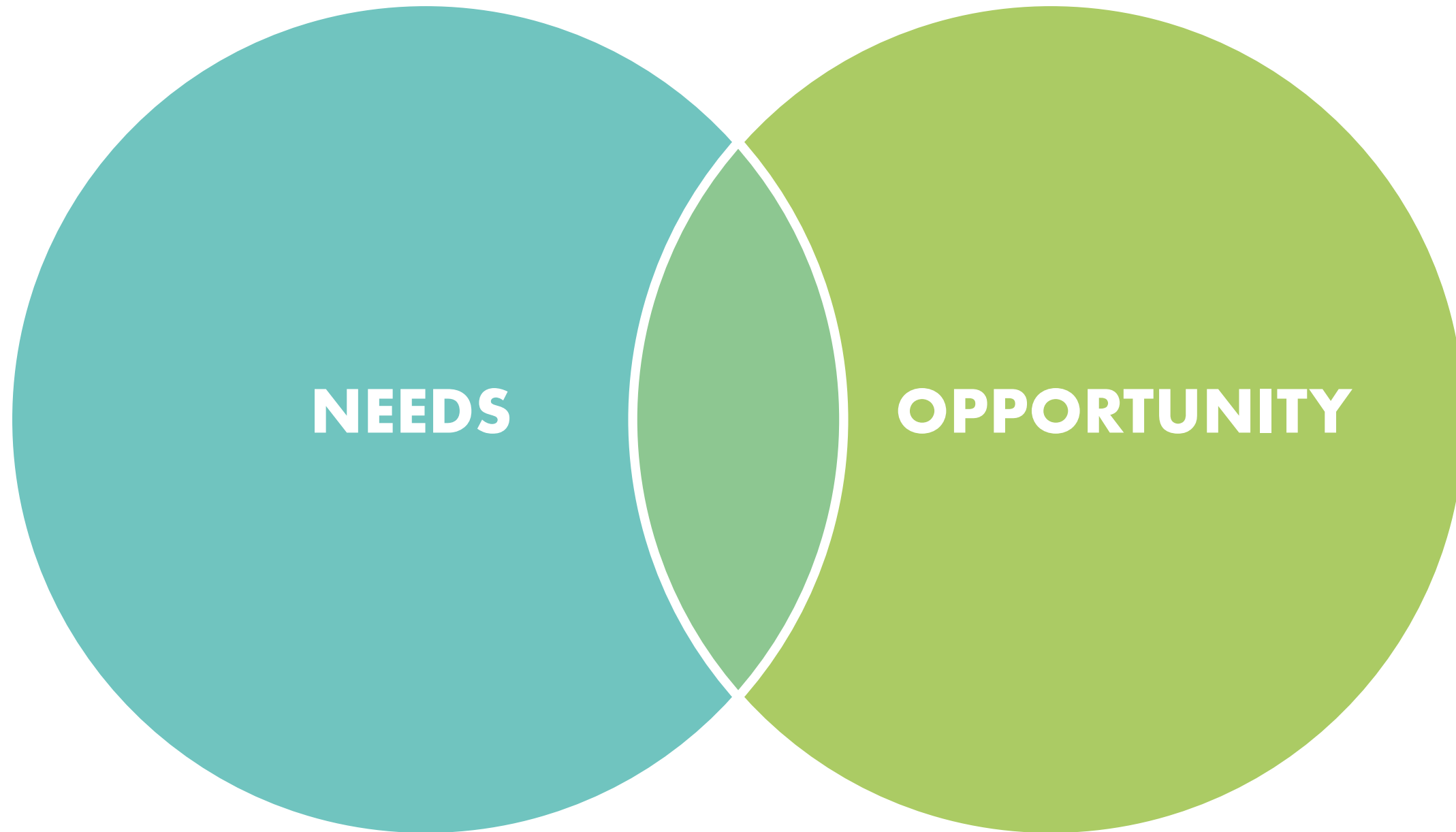

LENS OF EQUITY

PLANNING PROCESS



DEVELOPMENT OF PLAN RECOMMENDATIONS

PLANNING PROCESS

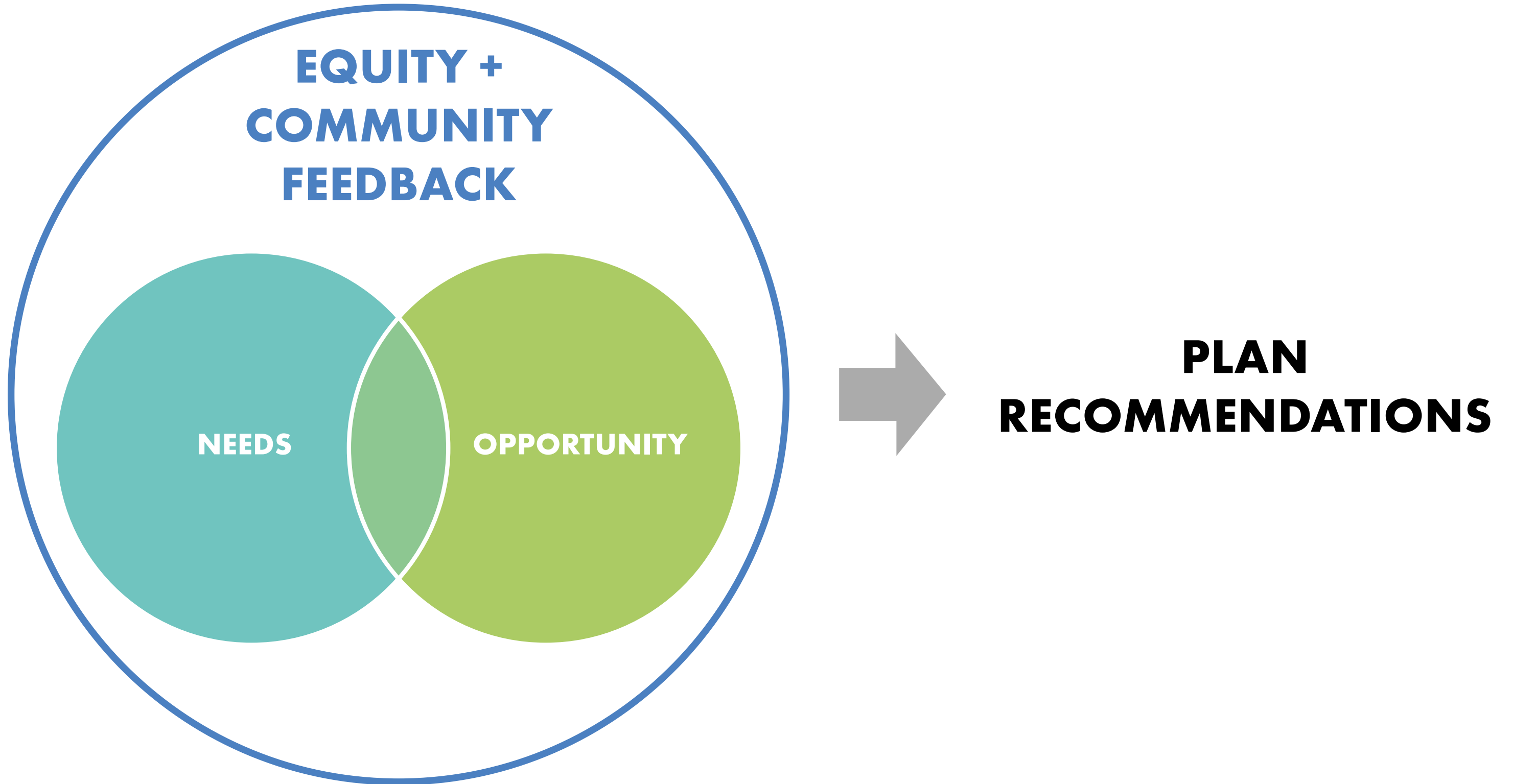

EARLY ANALYSIS FINDINGS

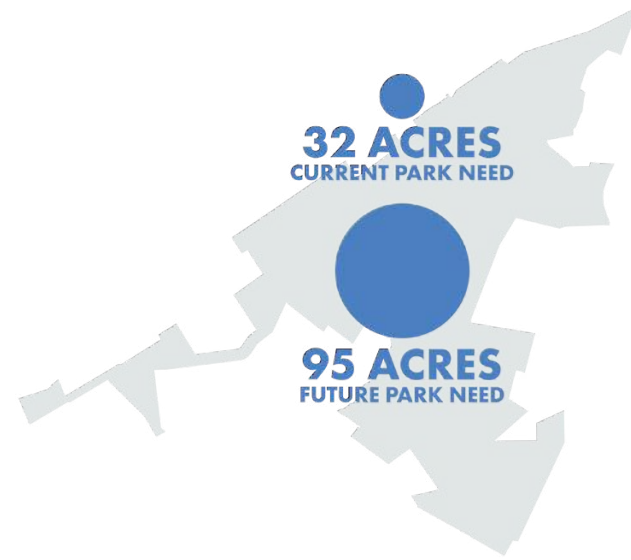

LOCAL PEERS AND NATIONAL STANDARD

BENCHMARKS



1 Source: OLIN, 2019

2 Source: OLIN, 2024..

3 Source: Aerial view of downtown Azusa, California. Matt Gush/Shutterstock.com. Accessed May 23, 2024.

4 Source: CA. divanov/Shutterstock.com. Accessed May, 17, 2024.

5 Source: Late afternoon in the streets of Inglewood. AbelDL/Shutterstock.com. Accessed May, 17, 2024.

OPPORTUNITY ZONES

GENERAL PLAN 2045

MAP LEGEND

 Culver City Boundary

PARKS AND OPEN SPACES

 Culver City Parks

 Water

TRANSIT

 Roads

 Freeways

 Opportunity Zones

 Inglewood Oil Field

 General Plan 2045 Development Neighborhoods

 Sites Being Investigated

 Schools + School Yards

Map of the 13 parks owned and operated by Culver City.

Source: LA County GIS Data Portal, Countywide Parks and Open Space, Countywide Multi-Use Trails, LA County Bikeways, & Significant Ecological Area, 2022; Los Angeles Region Imagery Acquisition Consortium (LARIAC), 2016.

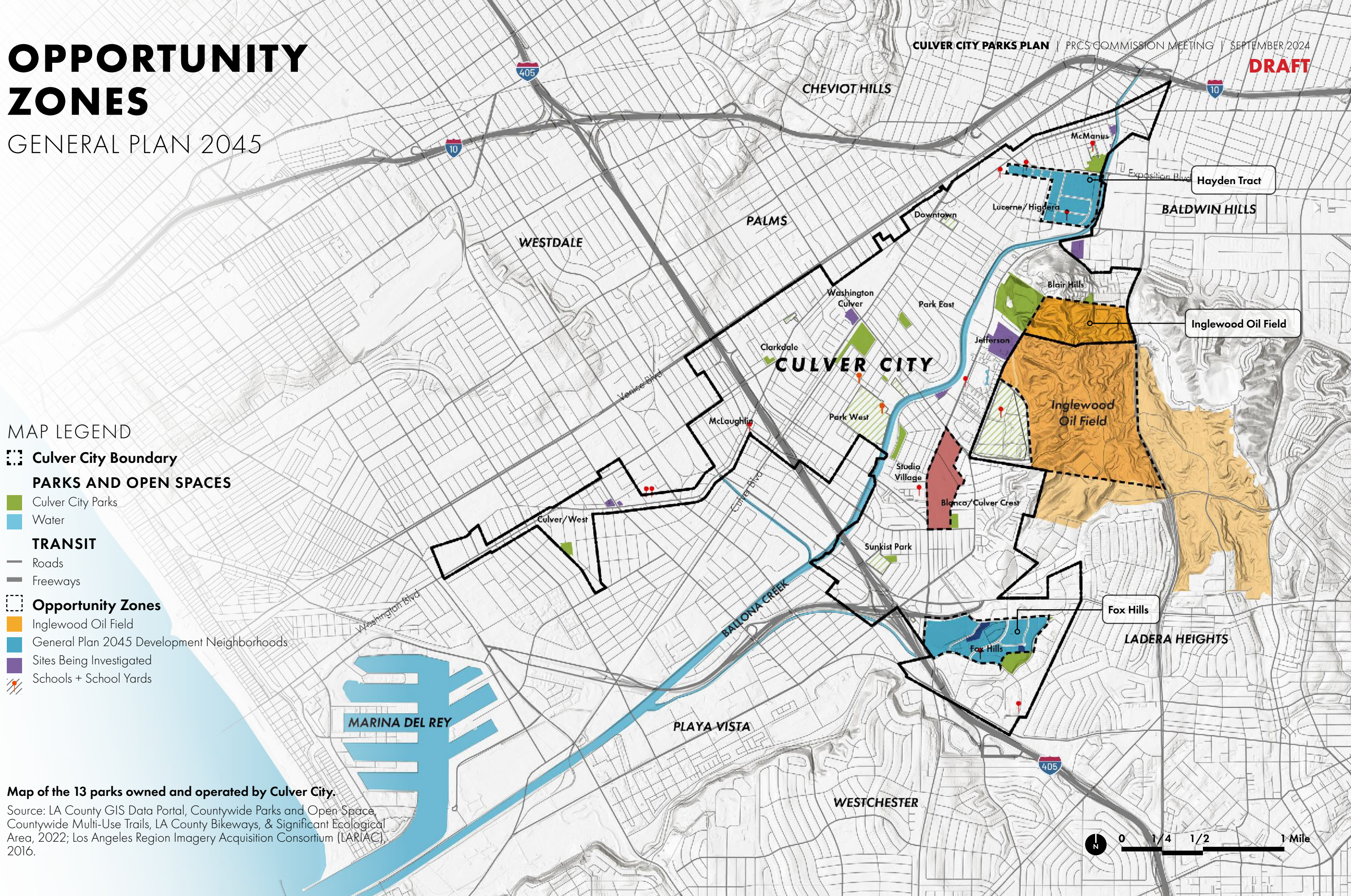

DRAFT VISION, MISSION, & GOALS

DRAFT VISION & MISSION

VISION: An aspirational statement of what the ideal future is like.

Parks are the heartbeat of Culver City, bringing together people of all ages and backgrounds to recharge and inspire joy in vibrant natural environments that honor our shared history and community.

MISSION: Defines what the organization does or stands for day to day.

To provide for the wellbeing of Culver City residents by supporting diverse, safe, and equitable opportunities for recreation, learning, and arts while protecting our most valued natural and cultural resources.

PARKS PLAN DRAFT GOALS

**PROVIDE EQUITABLE ACCESS TO
PARKS AND PARK FACILITIES.**

**INTEGRATE SUSTAINABILITY AND CLIMATE RESILIENCY INTO
PARKS MANAGEMENT, DESIGN, AND CONSTRUCTION.**

**STRENGTHEN RECREATIONAL, ARTS, AND
CULTURAL PROGRAMMING FOR ALL AGES.**

**PRESERVE AND ENHANCE NATURAL HABITATS BY
SUPPORTING BIODIVERSITY AND ECOSYSTEM CONNECTIVITY.**

**INCREASE CAPITAL BUDGET FUNDING
AND STAFF LONGEVITY.**

PARKS PLAN DRAFT GOALS

EXAMPLE GOAL & ACTIONS

GOAL 1: PROVIDE EQUITABLE ACCESS TO PARKS AND PARK FACILITIES.

ACTIONS

Add parkland and parkland access in areas with a focus on areas with park deficits and high park pressure.

Increase ADA access and inclusive elements at parks.

Continue to coordinate with other Culver City departments on active mobility strategies to make parks more accessible.

Continue to foster safe spaces for the community.

Enhance operations and maintenance of existing and future parks.

Invest in new facilities that meet current park needs.

PARKS PLAN DRAFT GOALS

EXAMPLE GOAL & ACTIONS

GOAL 1: PROVIDE EQUITABLE ACCESS TO PARKS AND PARK FACILITIES.

ACTIONS

Add parkland and parkland access in areas with a focus on areas with park deficits and high park pressure.

Increase ADA access and inclusive elements at parks.

Continue to coordinate with other Culver City departments on active mobility strategies to make parks more accessible.

Continue to foster safe spaces for the community.

Enhance operations and maintenance of existing and future parks.

Invest in new facilities that meet current park needs.

PARKS PLAN DRAFT GOALS

EXAMPLE ACTIONS & METHODS

GOAL 1: PROVIDE EQUITABLE ACCESS TO PARKS AND PARK FACILITIES.

ACTION: Increase ADA access and inclusive elements at parks.

METHODS

Add ADA access areas and ADA compliant walking paths around park site elements.

Add or update a minimum of three inclusive playgrounds within the city either in current parks or on opportunity sites.

Provide consistent, clear wayfinding, regulatory, and interpretive signage in city parks, recreational facilities, and public facilities to create a cohesive visual identity for the city through the parks system.

Develop uniform signage, wayfinding, and environmental graphics guidelines for the city's open spaces.

Create signature art gateways at entry thresholds throughout Culver City to build awareness of the city's boundaries.

STRATEGIES

GENERAL STRATEGIES

TURF REDUCTION AND REPLACEMENT

Image Source: Simone Hogan/Shutterstock.com

EFFICIENT AND SHIELDED LIGHTING

Image Source: IanChiu/Shutterstock.com

WASTE REDUCTION AND MANAGEMENT

Image Source: Inna Dodor/Shutterstock.com

ENERGY EFFICIENCY

Image Source: Aaron Finn/Shutterstock.com

GENERAL STRATEGIES

NATIVE PLANTING

Image Source: OLIN, 2024.

STORMWATER BEST MANAGEMENT PRACTICES

Image Source: Jahanne / Shutterstock.com

FACILITY AND AMENITY UPDATES

Image Source: OLIN, 2024.

ENHANCED COMMUNITY PROGRAMMING

Image Source: OLIN, 2024.

GENERAL STRATEGIES

ACCESSIBLE PATHS, RAMPS, AND SEATING

Image Source: OLIN, 2024.

IMPROVED PEDESTRIAN AND BICYCLE ACCESS

Image Source: OLIN, 2024.

WAYFINDING AND SIGNAGE

Image Source: OLIN, 2024. BILL BOOTS FIELD

INCLUSIVE PLAY EQUIPMENT AND GATHERING SPACES

Image Source: MONSTRUM Playgrounds / Connor Ryan, 2024.

PROGRAMMING & ARTS

PROGRAMMING OPPORTUNITY CATEGORIES



ARTS & CULTURE



FITNESS &
WELLNESS



HOBBIES &
NICHE INTERESTS



MARKETS &
FESTIVALS



LIVE
ENTERTAINMENT



EDUCATION

PROGRAMMING & ARTS

CREATING SUSTAINED &
SUSTAINABLE ACTIVITY



PROGRAMMING & ARTS

PROGRAMMING FOR
DISTINCT AUDIENCES

DRAFT

**AMENITIES VARY BY
TIME, WEEKDAY, AND
SEASON TO ATTRACT
DIFFERENT AUDIENCES.**

PROGRAMMING & ARTS

ARTS PROGRAMS & ORGANIZATIONS



Culver City Cultural Affairs Commission

Advises the City Council on matters related to arts and implements the city's public art program.



Culver City Arts Foundation

All-volunteer organization created to cast a wider net to obtain funding and connect with artists.



Art in Public Places Program

Program aimed at enhancing quality of life for residents and visitors through 100+ public artworks.

JOINT USE PRECEDENTS

SCHOOL YARDS

Culver City, CA



Blanco Park operates with a joint-use MOU between CCUSD and PRCS. Source: OLIN, 2024.

- To increase resident access to parks and open spaces, the city should revisit, revise, and formalize additional MOUs for joint use.
- Opportunities include El Marino Park and Syd Kronenthal Park which are directly adjacent to schools.

Houston, TX



Children playground activities in public park at sunset in Houston, Texas. Source: Trong Nguyen/Shutterstock.com

San Francisco, CA



People relax at Mission Dolores Park. Source: Tiago Pestana/Shutterstock.com

Seattle, WA



Seattle cityscape overlooking ball field. Source: Kaidum/Shutterstock.com

JOINT USE PRECEDENTS

SCHOOL YARDS



Public school playground in Houston, Texas. Source: Brett Hondow/Shutterstock.com

Houston, TX

Since 1983, SPARK has built over **200+ community parks** with **150+ currently active.**

SPARK Parks are available for public use after the school day (including after-school programs) has ended and on weekends and holidays.

JOINT USE PRECEDENTS

SCHOOL YARDS



People relax at Mission Dolores Park. Source: Tiago Pestana/Shutterstock.com

San Francisco, CA

The “Shared Schoolyards” program was created in 2007 and includes over **40 schoolyards**, adding almost **38 acres available** to the community every weekend.

SFUSD manages all aspects of the program, including outreach, contract management, and operations.

JOINT USE PRECEDENTS

SCHOOL YARDS



Seattle cityscape overlooking ball field. Source: Kaidum/Shutterstock.com

Seattle, WA

Since the 1920s, Seattle Public Schools and Parks and Rec have pooled their resources to create recreation opportunities.

Around **one-in-three public schools** adjoin **SPR's land** or facilities.

STORMWATER STRATEGIES

BEST MANAGEMENT PRACTICES (BMPS)



Biofiltration - Typical



Source: Enhanced Watershed Management Program for the Ballona Creek Watershed, January 2016

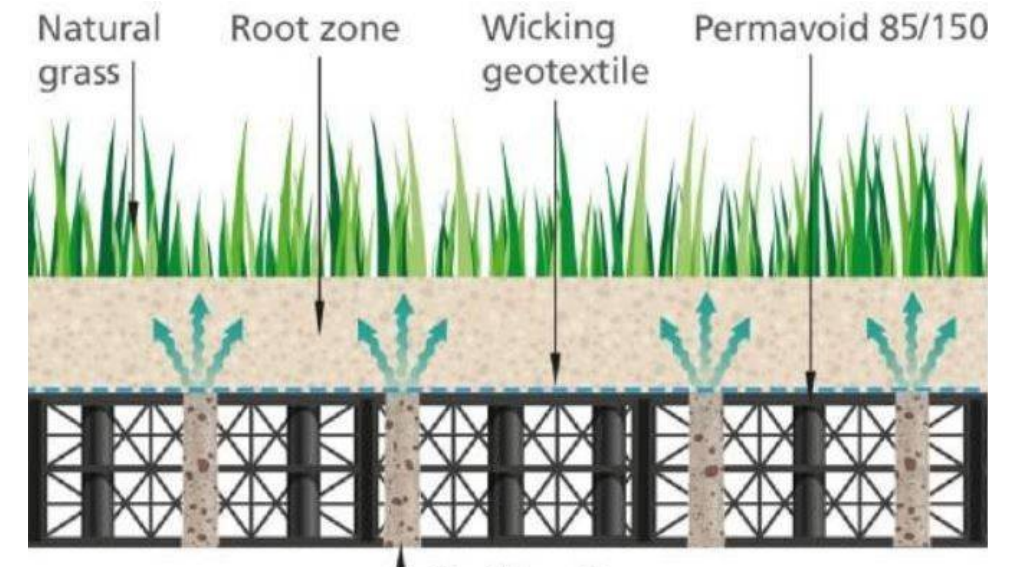

Regional Projects

Centralized facilities designed to receive large volumes of runoff such as large basins and underground vaults.



Green Street Projects

Distributed, small scale interventions such as bioretention and biofiltration areas along roadways.

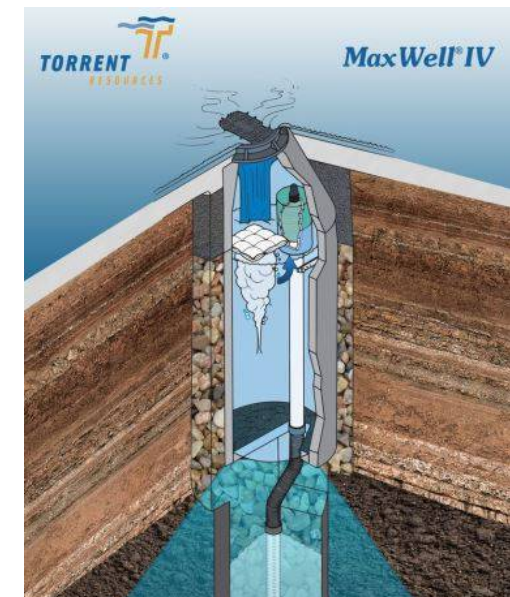

Low Impact Development (LID) Projects

Distributed, smaller scale interventions that infiltrate, harvest and use, or treat runoff on a parcel level such as rainwater cisterns, rain gardens, permeable pavement, and infiltration BMPs like dry wells.

Source: Culver City Stormwater Quality Master Plan, City of Culver City, 2021, pages 6-7.

Image Source: Culver City Stormwater Quality Master Plan, City of Culver City, 2021, pages 110, 118, 121, 133, 138.

STORMWATER STRATEGIES

NON-FUNCTIONAL TURF REQUIREMENTS

“Non-functional turf” is defined as:

SOLELY ORNAMENTAL

.....

IT DOES NOT INCLUDE SPORTS FIELDS & TURF THAT IS REGULARLY USED FOR HUMAN RECREATIONAL PURPOSES OR FOR CIVIC OR COMMUNITY EVENTS.

.....

CULVER CITY HAS BEGUN AN EVALUATION PROCESS TO REVIEW THESE AREAS WITHIN THE PARKS SYSTEMS.



ECOLOGY & RESILIENCE

URBAN FOREST CORRIDORS

The **Urban Forestry Master Plan** identifies street coordinators that would most benefit from improvements and additions to the urban forest. These corridors run through some of the neighborhoods with the lowest amount of tree canopy in Culver City.

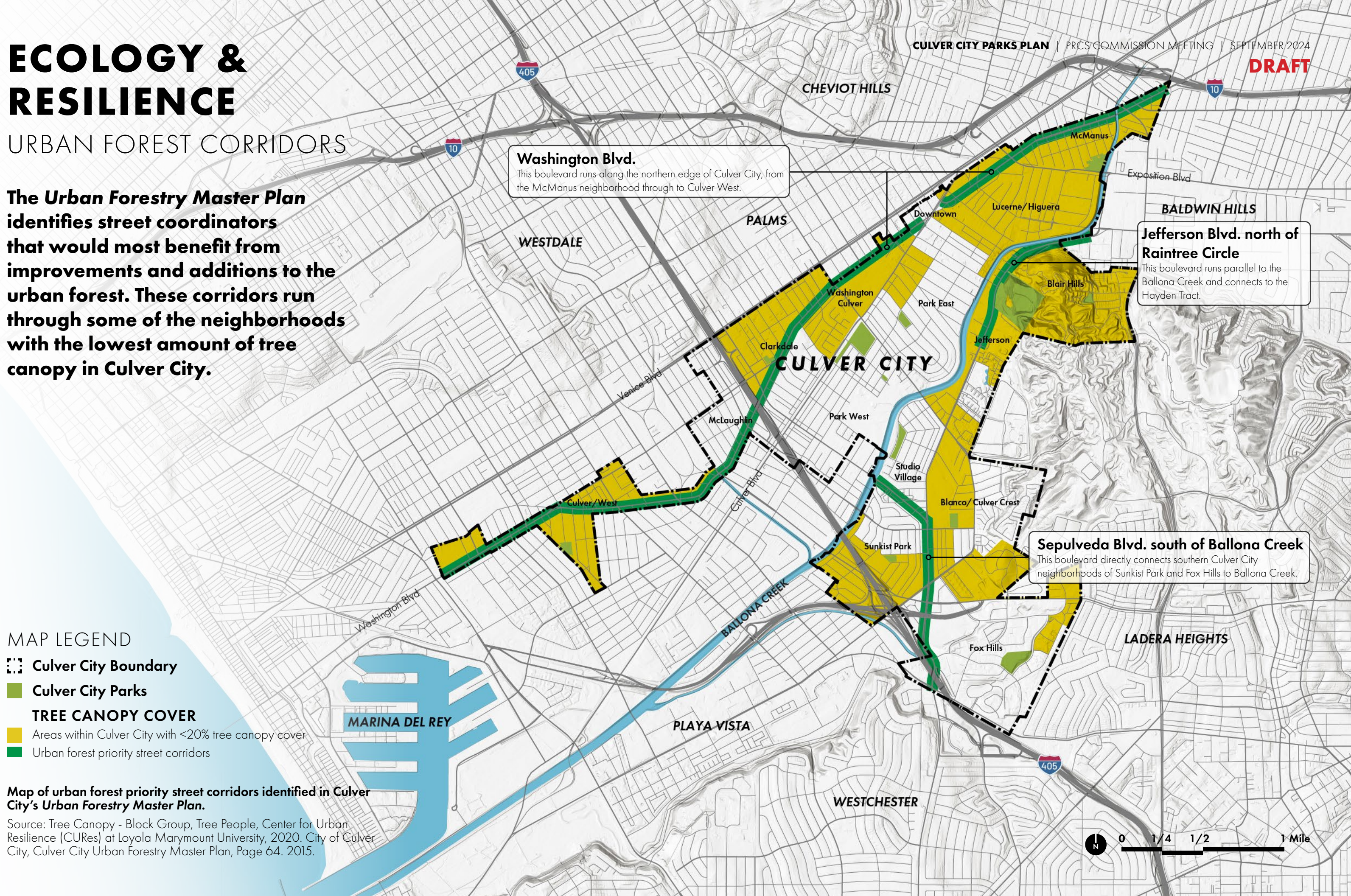

Washington Blvd.
This boulevard runs along the northern edge of Culver City, from the McManus neighborhood through to Culver West.

Jefferson Blvd. north of Raintree Circle
This boulevard runs parallel to the Ballona Creek and connects to the Hayden Tract.

Sepulveda Blvd. south of Ballona Creek
This boulevard directly connects southern Culver City neighborhoods of Sunkist Park and Fox Hills to Ballona Creek.

MAP LEGEND

- Culver City Boundary
- Culver City Parks
- TREE CANOPY COVER**
- Areas within Culver City with <20% tree canopy cover
- Urban forest priority street corridors

Map of urban forest priority street corridors identified in Culver City's Urban Forestry Master Plan.

Source: Tree Canopy - Block Group, Tree People, Center for Urban Resilience (CUREs) at Loyola Marymount University, 2020. City of Culver City, Culver City Urban Forestry Master Plan, Page 64. 2015.

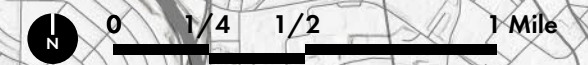

ECOLOGY & RESILIENCE

EXISTING TREE PALETTE



Heteromeles arbutifolia
TOYON
**CA native species*



Quercus agrifolia
COAST LIVE OAK
**CA native species*



Eucalyptus sideroxylon
RED IRONBARK



Eucalyptus globulus
TASMANIAN BLUEGUM



Erythrina caffra
COASTAL CORAL TREE



Ficus microcarpa 'Nitida'
INDIAN LAUREL FIG



Jacaranda mimosifolia
JACARANDA TREE



Juniperus chinensis 'Torulosa'
HOLLYWOOD JUNIPER



Liquidambar styraciflua
LIQUIDAMBAR / SWEET GUM

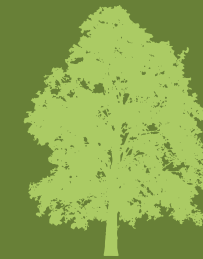

Magnolia grandiflora
SOUTHERN MAGNOLIA



Pinus canariensis
CANARY ISLAND PINE



Pinus pinea
STONE PINE



Platanus orientalis
ORIENTAL PLANE TREE



Ulmus parvifolia
CHINESE ELM



Washingtonia robusta
MEXICAN FAN PALM

NATIVE PLANTING

TREE CANOPY RECOMMENDATIONS

UPLAND SPECIES

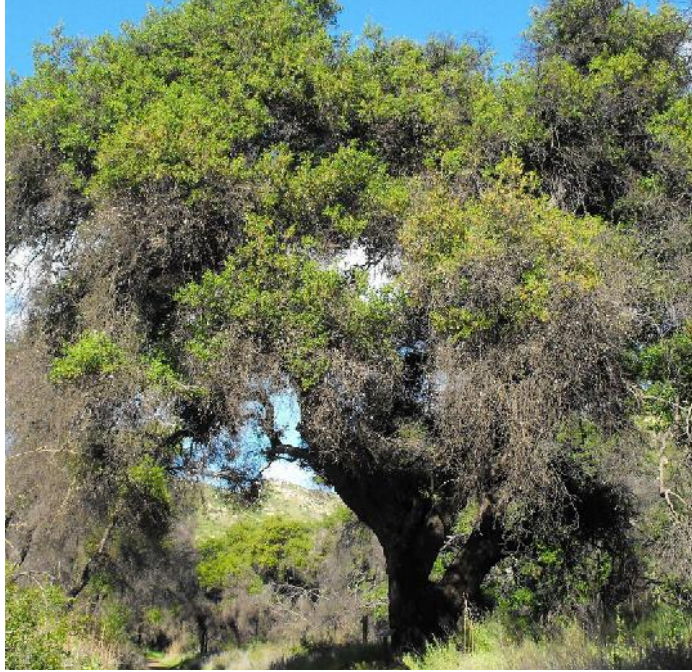

Quercus agrifolia
Coast live oak

Source: Stickpen, <https://commons.wikimedia.org/w/index.php?curid=9944130>.



Juglans californica
California walnut

Source: Consultaplantas, <https://commons.wikimedia.org/w/index.php?curid=44978241>.



Umbellularia californica
California bay laurel

Source: Krzysztof Ziarnek, Kenraiz, <https://commons.wikimedia.org/w/index.php?curid=54448438>.

RIPARIAN SPECIES



Platanus racemosa
Western sycamore

Source: Raffi Kojian, <http://www.gardenology.org>, <https://commons.wikimedia.org/w/index.php?curid=9705655>.



Populus fremontii
Fremont cottonwood

Source: CK Kelly, <https://www.inaturalist.org/photos/10765354>.



Fraxinus velutina var. coriacea
Velvet ash

Source: Kenraiz, <https://commons.wikimedia.org/w/index.php?curid=75992775>.

CLIMATE ADAPTED PLANTING

TREE CANOPY RECOMMENDATIONS



Metrosideros excelsa
NZ Christmas tree

Source: weta2000nz, Flickr, <https://www.flickr.com/photos/weta2000nz/45696079285>.



Tipuana tipu
Tipu tree

Source: Daniel Ventura, <https://commons.wikimedia.org/w/index.php?curid=2246165>.



Quillaja saponaria
Soapbark tree

Source: Daderot, <https://commons.wikimedia.org/w/index.php?curid=37387713>.



Brachychiton populneus
Bottle tree

Source: Leonora (Ellie) Enking, Flickr, <https://www.flickr.com/photos/33037982@N04/5242446150>



Cercidium 'Desert Museum'
Desert museum palo verde

Source: cultivar413, Flickr, <https://www.flickr.com/photos/131880272@N06/41675455925>.



Pinus torreyana
Torrey pine

Source: Stickpen, <https://commons.wikimedia.org/w/index.php?curid=9944130>.

CHECK OUT IDEAS FOR EACH PARK ONLINE!



PARKS PLAN WEBSITE



HOW TO USE THE EARLY IDEAS STORYMAP

EL MARINO PARK EXISTING

- RECREATION BUILDING
- CERAMICS HUT
- PLAY EQUIPMENT
- EL MARINO ELEMENTARY SCHOOL
- HANDBALL COURT
- BASKETBALL COURT

EL MARINO PARK PROPOSED

- PLANT TREES
- OUTDOOR CLASSROOM
- ACCESSIBLE WALKING PATH
- PASSIVE LAWN AREA
- PICNIC GROVES

Comments on El Marino Park

Submit

WHAT YOU'LL SEE:

EXISTING CONDITIONS

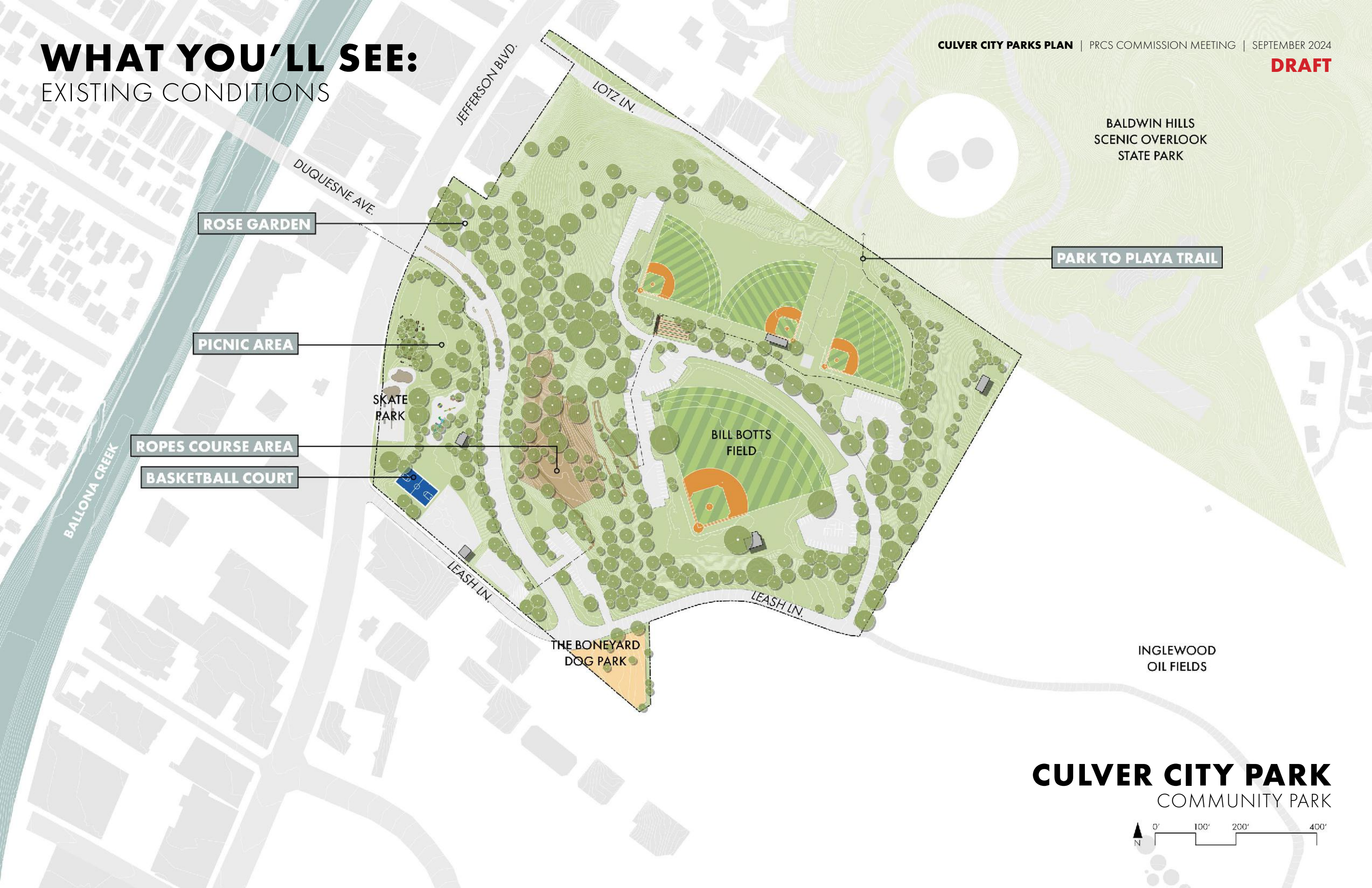

BALDWIN HILLS
SCENIC OVERLOOK
STATE PARK

PARK TO PLAYA TRAIL

ROSE GARDEN

PICNIC AREA

SKATE
PARK

ROPES COURSE AREA

BASKETBALL COURT

BILL BOTTS
FIELD

THE BONEYARD
DOG PARK

INGLEWOOD
OIL FIELDS

CULVER CITY PARK

COMMUNITY PARK

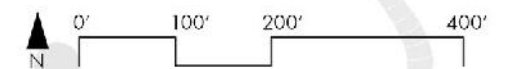

WHAT YOU'LL SEE:

IDEAS

DRAFT



CULVER CITY PARK COMMUNITY PARK

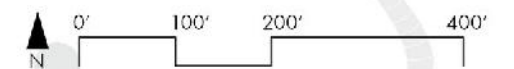

WHAT YOU'LL SEE:

IDEAS

SAND VOLLEYBALL COURT

PICNIC GROVE

ENHANCE BASKETBALL COURT

RACKET COURTS

CAFE SEATING

FOOD + BEVERAGE

PLANT TREES

ROPES COURSE AREA

OUTDOOR CLASSROOM

ADD HIKING TRAILS

ACCESSIBLE RAMPS

IMPROVE PARKING LOT

ENHANCE SIDEWALK

KEY PLAN

ENHANCE SIDEWALK

RACKET COURTS

BIKE STORAGE AREA

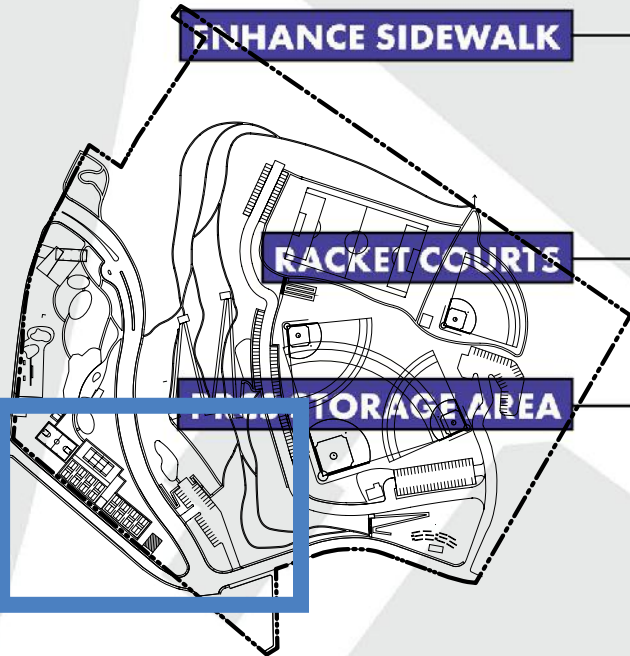

JEFFERSON BLVD.

DUQUESNE AVE.

LEASH LN.

LEASH LN.

CULVER CITY PARK COMMUNITY PARK



WHAT YOU'LL SEE:

IDEAS

DRAFT

BILL BOTTS
FIELD

PICNIC GROVE

RECONFIGURED
PARKING LOT

FOOD + BEVERAGE

ROAD REROUTED
AROUND FIELDS

STAIR TO BILL BOTTS

ACCESSIBLE RAMP
TO BILL BOTTS

PLANT TREES

LOG BENCH SEATING

ENHANCE SIDEWALK

OUTDOOR COMMUNITY SPACE

ACCESSIBLE PAVED SEATING

LEASH LN.

KEY PLAN

INGLEWOOD
OIL FIELDS

CULVER CITY PARK COMMUNITY PARK

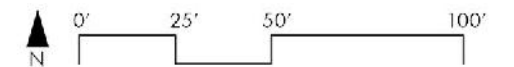

WHAT YOU'LL SEE:

IDEAS

DRAFT

BILL BOTTS
FIELD

PICNIC GROVE

RECONFIGURED
PARKING LOT

FOOD + BEVERAGE

ROAD REROUTED
AROUND FIELDS

STAIR TO BILL BOTTS

ACCESSIBLE RAMP
TO BILL BOTTS

PLANT TREES

LOG BENCH SEATING

ENHANCE SIDEWALK

OUTDOOR COMMUNITY SPACE

RELOCATED SCOUT HOUSE

DUQUESNE AVE.

KEY PLAN

INGLEWOOD
OIL FIELDS

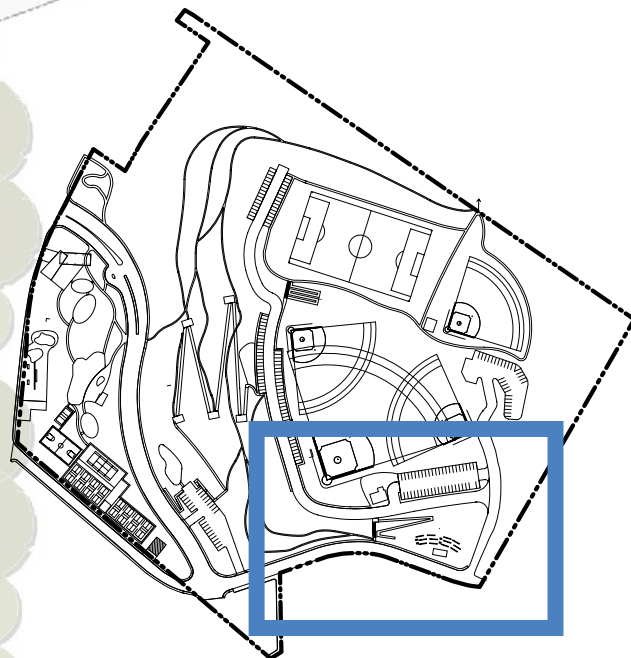

CULVER CITY PARK COMMUNITY PARK

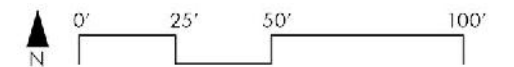

WHAT YOU'LL SEE:

EXISTING CONDITIONS



TELLEFSON PARK

NEIGHBORHOOD PARK



WHAT YOU'LL SEE:

IDEAS

DRAFT



TELLEFSON PARK NEIGHBORHOOD PARK



WHAT YOU'LL SEE:

EXISTING CONDITIONS



EL MARINO PARK

NEIGHBORHOOD PARK

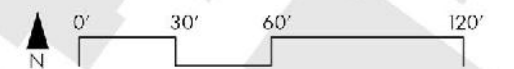

WHAT YOU'LL SEE:

IDEAS

DRAFT



EL MARINO PARK NEIGHBORHOOD PARK



WHAT YOU'LL SEE:

EXISTING CONDITIONS

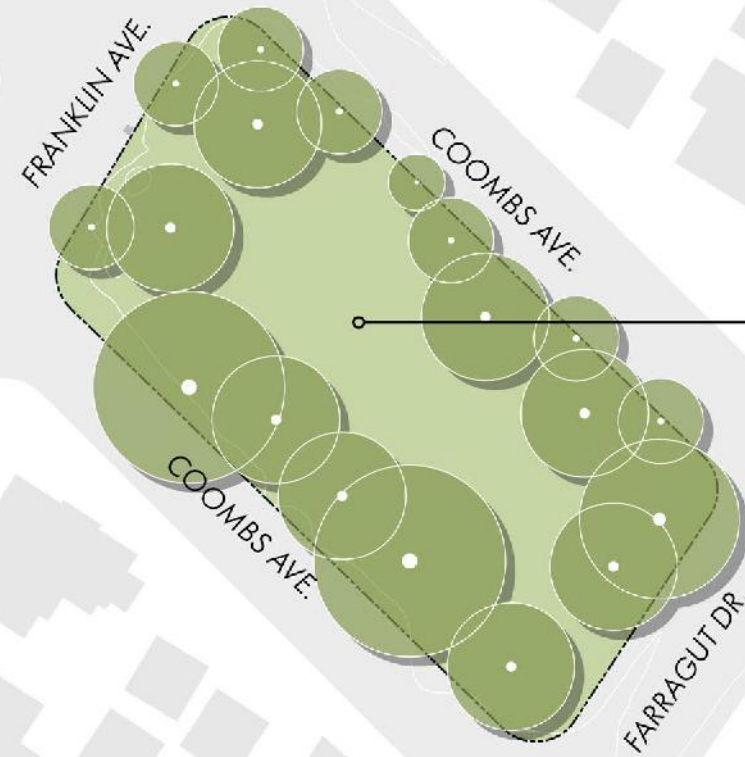

LAWN

FARRAGUT
ELEMENTARY
SCHOOL

COOMBS PARKETTE

PARKETTE/MINI PARK

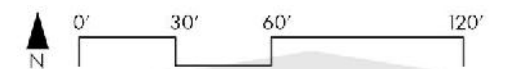

WHAT YOU'LL SEE:

IDEAS

ACCESSIBLE WALKING PATH

**SHADE-TOLERANT
NATIVE PLANTING**

LAWN

ADDITIONAL SEATING

**OUTDOOR
CLASSROOM**



FARRAGUT
ELEMENTARY
SCHOOL

COOMBS PARKETTE PARKETTE/MINI PARK

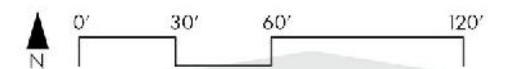

FUNDING OPPORTUNITIES

LOCAL OPPORTUNITIES

- Updated City Developer Fees
- City Parks Bond
- Stormwater Credit System
- Collaboration with Culver City Unified School District
- Revenue Generation

LA COUNTY FUNDING

- LA County Measure W: Safe, Clean, Water
- LA County Measure A
- LA County Measure M

STATE FUNDING

- State Climate Bond
- State Conservancy Partnerships
- Local Parks Grants Program, Arts in California Parks

FEDERAL FUNDING

- Reconnecting Communities Grants
- Invasive and Noxious Plant Management
- WaterSMART: Environmental Water Resources Projects

NON-GOVERNMENTAL GRANTS

- Competitive Grants

PHILANTHROPIC DONATIONS

- Naming Opportunities
- Fundraising

IMPORTANT UPCOMING DATES

Meetings with interested partners, research, analysis, and review of planning documents

Generating design ideas and vision alternatives based on community input

Refining the selected alternative into a draft Parks Plan

Responding to comments and finalizing the Parks Plan

WE ARE HERE

2024

2025



- Sept 24 Fall Community Meeting 1 (Culver West Alexander Park)
- Oct 2 Fall Community Meeting 2 (Lindberg Park)
- Oct 3 Fall Community Meeting 3 (Virtual)

VISIT OUR WEBSITE!

bit.ly/culvercityparksplan

Culver CITY

SERVICES

CITY HALL

EXPLORE

CONTACT US

How can we help you?



Home / Explore / Parks & Recreation / Citywide Parks Plan

Citywide Parks Plan

The Culver City Parks Plan is a strategic guide for the development and management of the city's parks, recreational facilities and programs, and is aimed at enhancing community health and quality of life. In 2024, Culver City Parks, Recreation and Community Services (PRCS) began the development of a new Parks Plan which examines the current and future needs of the city's recreational infrastructure, considering varied perceptions and uses of park space.



With your input, the Culver City Parks Plan aims to:

- Create a plan that will successfully serve the community for at least 15 years.
- Engage a wide range of key groups and community members in Culver City.
- Formulate a recommendation for Culver City Parks updates that are most necessary to meet the community's priorities.

Community Meeting Information

Contact Information

Adam Ferguson, Senior Management Analyst
PRCS Department
Adam.Ferguson@culvercity.org
(310) 253-6685

Survey

Citywide Parks Plan Survey in Spanish >

Citywide Parks Plan Survey in English >



PARKS PLAN WEBSITE